

M-99-47  
REV. B  
MAR. 2000

# INSTALLATION MANUAL

## **TUK-A-WAY®** LIFTGATE SERIES

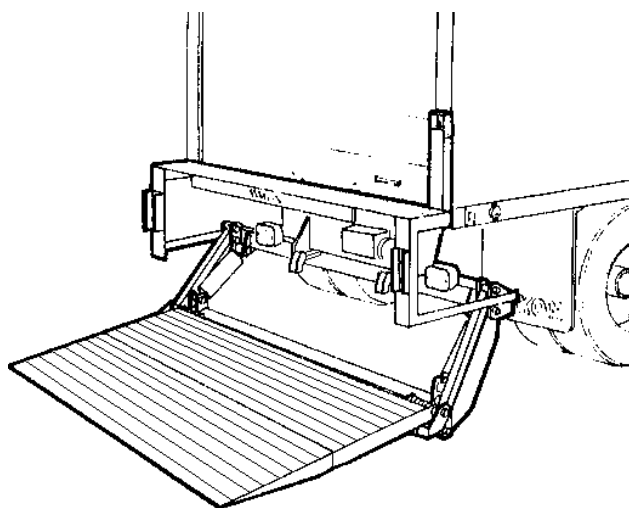
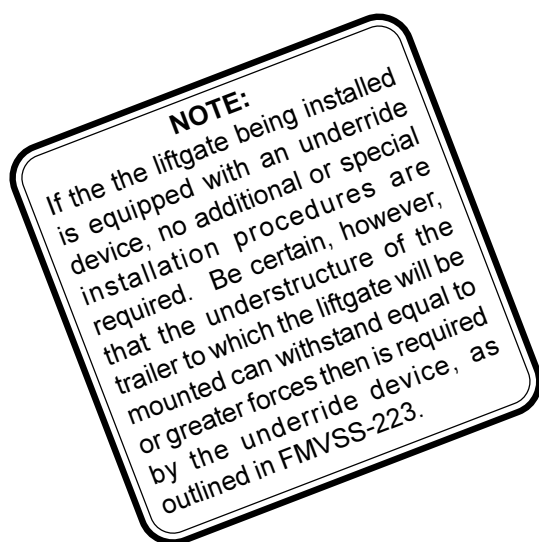

# 80-3LM, 80-4LM

**MAXON®**  
LIFT CORP.

11921 Slauson Avenue.  
Santa Fe Springs, CA. 90670  
(800) 227-4116

# **MAXON<sup>®</sup>**

## **LIFT CORP.**

**11921 Slauson Ave.  
Santa Fe Springs, CA. 90670**

### **CUSTOMER SERVICE:**

**(562) 464-0099**

**(800) 227-4116**

**FAX: (888) 771-7713**

### **TECHNICAL SERVICE:**

**(800) 8-MAXTEK (862-9835)**

**NOTE: Check with Customer Service Department for updated versions of Manuals on an annual basis.**

## **WARRANTY POLICY & PROCEDURE**

### **NEW LIFTGATE WARRANTY**

Term of Warranty: 2 Years from Date of In-Service

Type of Warranty: Full Parts and Labor

MAXON agrees to replace any components which are found to be defective during the first 2 years of service, and will reimburse for labor based on MAXON's Liftgate Warranty Flat Rate Labor Schedule. (Call MAXON Customer Service for a copy).

All claims for warranty must be received within 30 Days of the repair date, and include the following information:

1. Liftgate Model Number
2. Liftgate Serial Number
3. Description of Problem
4. Corrective Action Taken, and Date of Repair.
5. Parts used for Repair, Including MAXON Part Number(s).
6. MAXON R.G.A. # and/or Authorization # if applicable (see below).
7. Person contacted at MAXON if applicable.

### **PURCHASE PART WARRANTY**

Term of Warranty: 1 Year from Date of Purchase Type of Warranty: Part Replacement and Replacement Labor.

MAXON will guarantee all returned genuine replacement parts upon receipt, and inspection of parts and invoice. All Warranty repairs must be performed by an authorized MAXON warranty station.

For major repairs, MAXON's Warranty Department must be notified, and an "Authorization Number" received. Major repairs would generally be considered repairs made to the structural assembly of the liftgate and/or repairs not outlined in the MAXON Liftgate Warranty Flat Rate Schedule.

Major components (i.e. hydraulic pumps, cylinders, valves, or failed structural parts) must be returned, freight pre-paid, prior to the claim being processed. To ensure timely processing of these warranty claims, an R.G.A. (Returned Goods Authorization) number must be obtained from MAXON's Warranty Department prior to the return of any defective part. Defective Parts must be returned within 60 days of the claim date for consideration to:

**Warranty Department, MAXON Lift Corp.  
5920 Alameda St., Huntington Park, CA. 90255**

MAXON's warranty policy does not include the reimbursement for travel time; towing; vehicle rental; service calls; fabrication of parts which are available from MAXON; oil; defects due to misuse or abuse; loss of income due to downtime.

MAXON's Flat Rate Labor Schedule times takes into consideration time required for diagnosis of problem.

Warranty and Technical Information is available by calling MAXON's Customer Service Department.

# Table of Contents

INTRODUCTION .....	PAGE 4
CLEARANCE DIMENSIONS .....	PAGE 5
TRUCK FRAME CUT-OUT .....	PAGE 6
EXTENSION PLATE WELDING .....	PAGE 7
FLIPOVER INSTALLATION .....	PAGE 8
OPENING PLATFORM .....	PAGE 9
WELD LIFTGATE TO VEHICLE .....	PAGE 10
CONTROL SWITCH CHANNEL INSTALLATION .....	PAGE 12
CONTROL SWITCH GRAVITY DOWN .....	PAGE 14
FUSED POWER CABLE.....	PAGE 15
WIRE CONNECTIONS GRAVITY DOWN .....	PAGE 16
CONTROL SWITCH, POWER DOWN .....	PAGE 17
FUSED POWER CABLE.....	PAGE 18
WIRE CONNECTIONS, POWER DOWN .....	PAGE 19
HYD. HOSE ROUTING, GRAVITY DOWN .....	PAGE 20
HYD. HOSE ROUTING, POWER DOWN .....	PAGE 22
DECALS, 80 SERIES.....	PAGE 24
POWER CABLE INFORMATION .....	PAGE 25
PLATFORM OPENER .....	PAGE 26
SADDLE MOUNTING INSTRUCTIONS .....	PAGE 27
SUGGESTED REAR LIGHT INSTALLATION .....	PAGE 28
FINAL ADJUSTMENTS .....	PAGE 29
PLATFORM ADJUSTMENT .....	PAGE 30
HOOK INSTALLATION .....	PAGE 31
<b>ACCESSORIES SECTION .....</b>	<b>PAGE 32</b>
DOCK BUMPER ANGLES .....	PAGE 33
BUMPER INSTALLATION .....	PAGE 34
CIRCUIT BREAKER INSTALLATION .....	PAGE 35

# INTRODUCTION

This publication contains the information required to install the **80-3LM, 80-4LM**. If there is any doubt regarding the suitability of these lifts being installed on its intended vehicle, or any portion of these instructions that you do not understand, please contact the **MAXON Customer Service Department** for consultation.

Unauthorized modification to this equipment may cause premature failure or create hazards in its use that are not foreseen at the time of installation. These kinds of changes should be discussed with our Engineering Department before being undertaken.



## CAUTION!



1. When installing Taillight Systems, consult the Chassis or Trailer manufacturer's instructions for splicing into the vehicles lighting circuit.
2. **CONSPICUITY DECALS:** Federal Motor Vehicle Safety Standards call out for the placement of retro-reflective sheeting, or reflex reflectors on all vehicles prior to their being delivered. These decals or reflectors are not supplied with the lift gate. Refer to the standard for details.

### Before you start!

*The dimension of the open liftgate Platform length must be added to the body length when considering proper weight distribution on the truck chassis. In other words, be mindful of the possibility that a loaded liftgate could raise the front wheels off of the ground.*

### When all else fails, read the instructions.

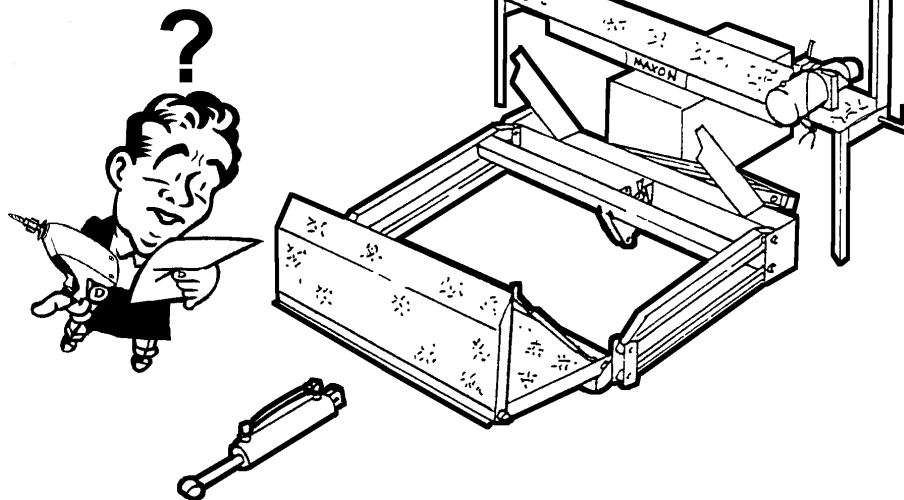

# CLEARANCE DIMENSIONS

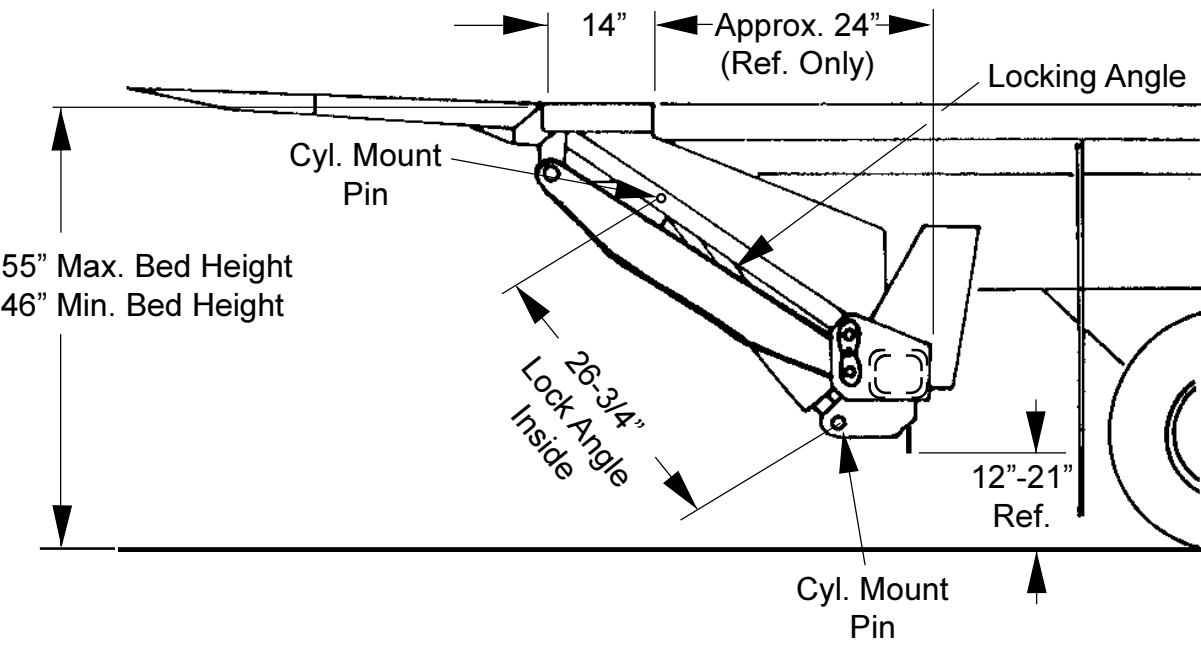

# TRUCK FRAME CUT-OUT

## 80-3LM, 80-4LM W/48"-54" PLATFORM

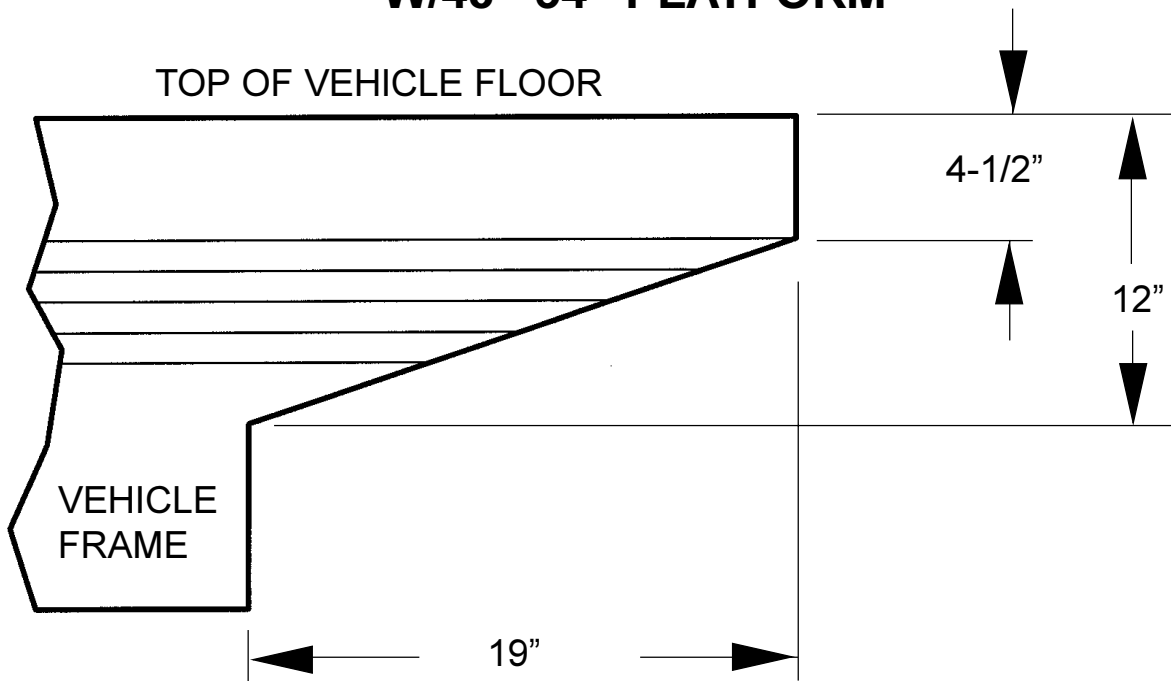

## 80-3LM, & 80-4LM W/60" PLATFORM

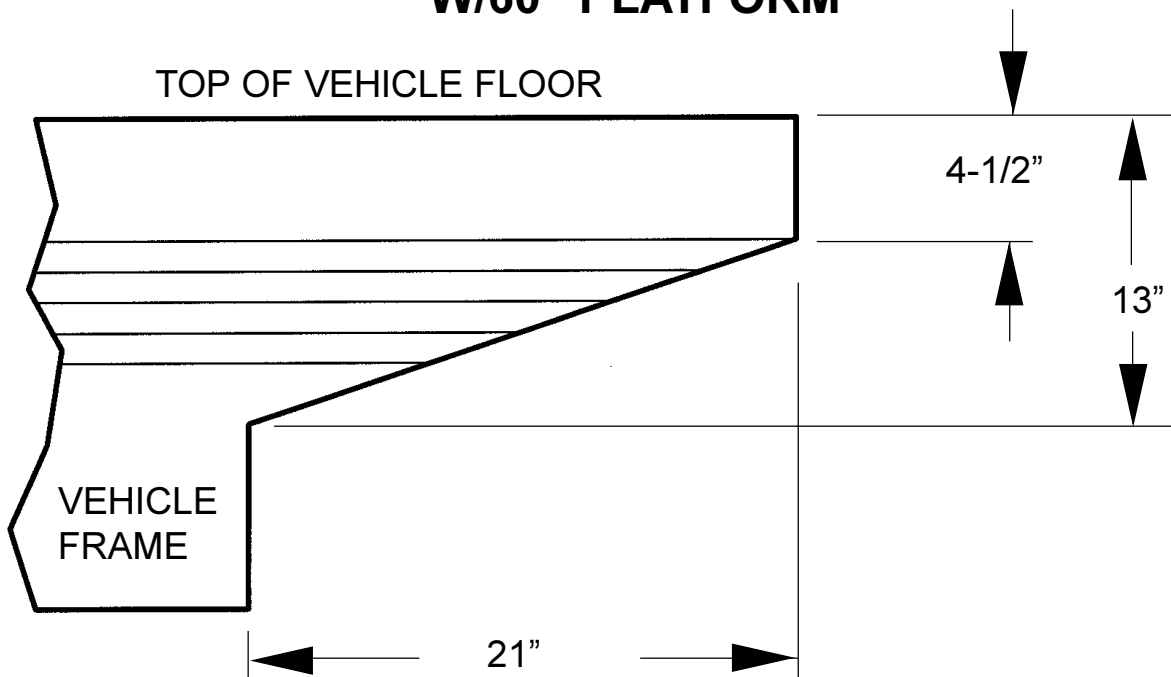

**MAXON®**

11921 Slauson Ave. Santa Fe Springs, CA. 90670 (800) 227-4116 FAX (888) 771-7713

# EXTENSION PLATE WELDING

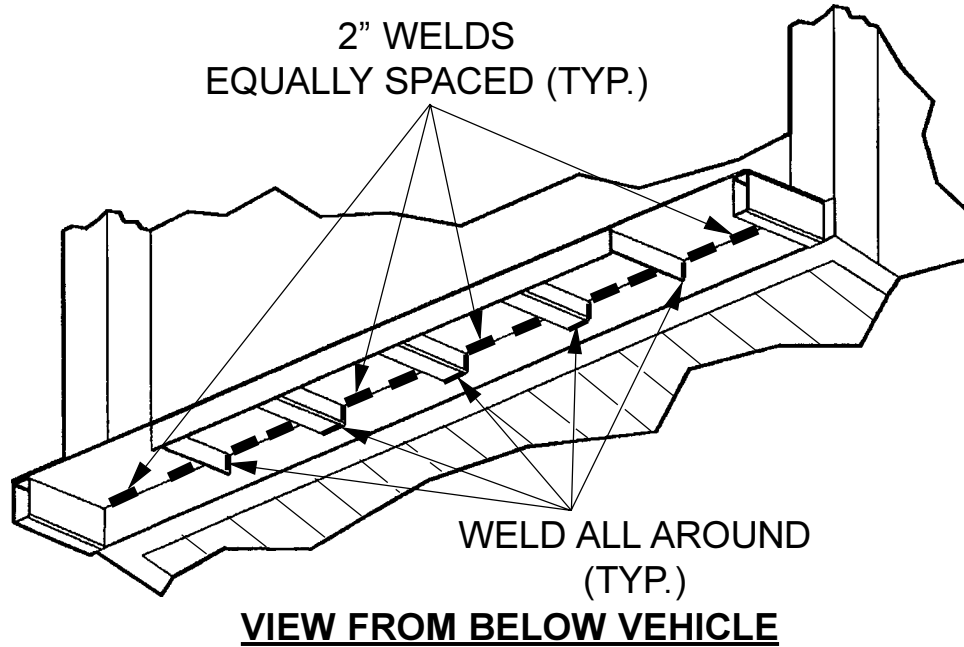

THESE WELDS ARE OVER THE RECTANGULAR  
TUBE LOCATED UNDER THE FLOORPLATE.

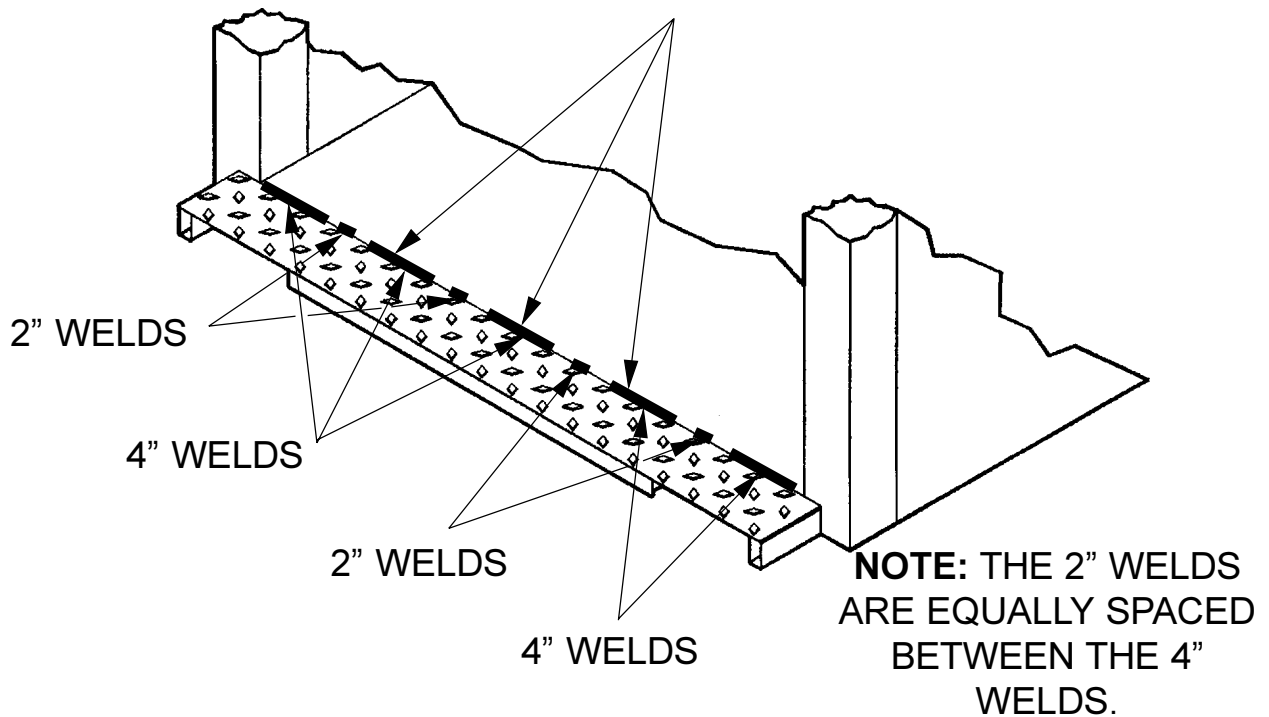

# FLIPOVER INSTALLATION

If not already assembled. Attach the Flipover Section to the Platform per the illustration below. This will be repeated on the other side.

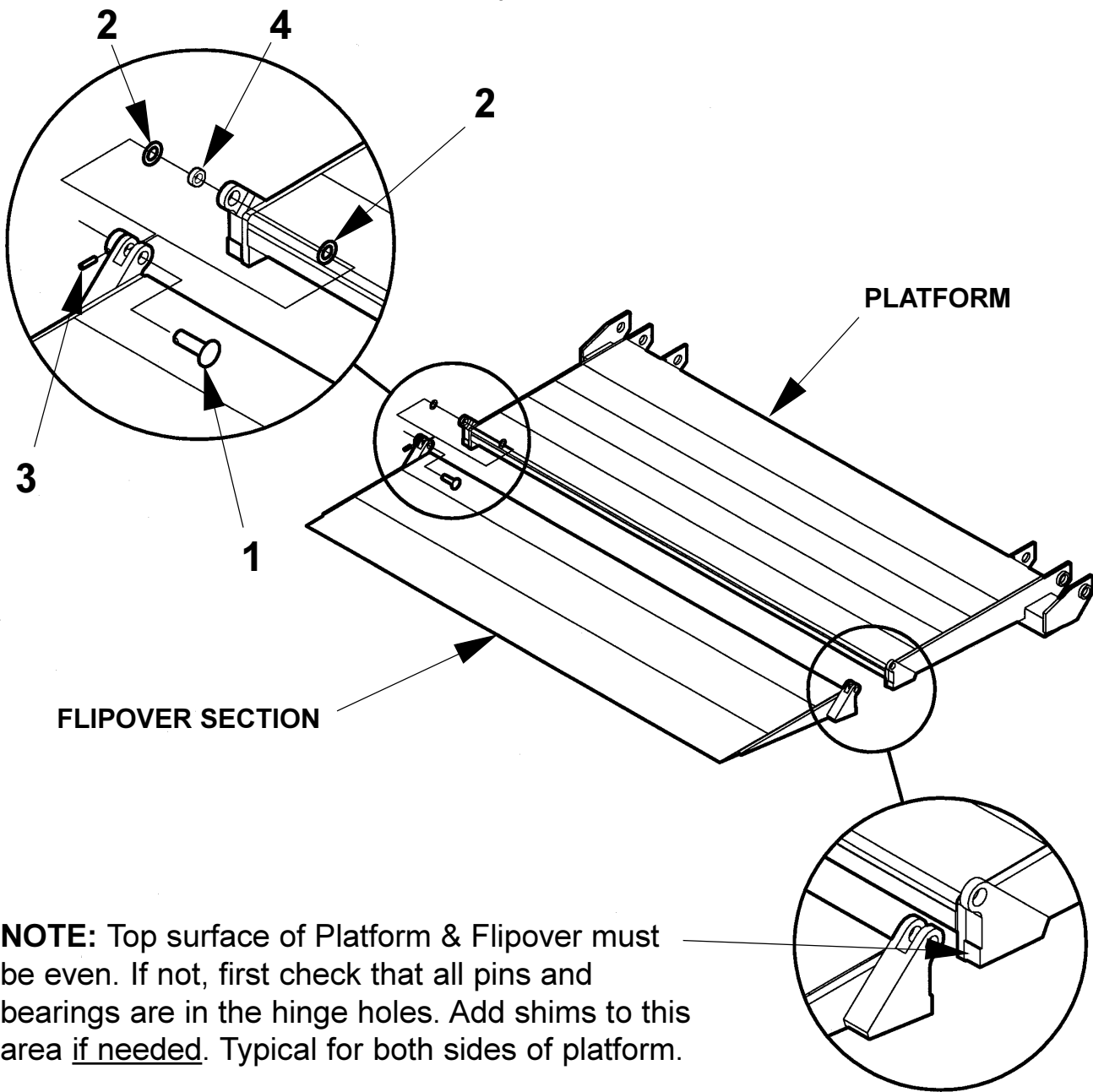

**NOTE:** Top surface of Platform & Flipover must be even. If not, first check that all pins and bearings are in the hinge holes. Add shims to this area if needed. Typical for both sides of platform.

ITEM	QTY.	PART NUMBER	DESCRIPTION
1	2	262258	PIN, HINGE WELDMENT
2	4	902020-1	WASHER, FLAT NYLON 1.317x .765x .062 THK.
3	2	905033-1	ROLLPIN, 1/4" DIA. x 1-1/4" LONG
4	2	260917-04	BEARING, FIBERGLIDE, 3/4" I.D. x 1/2" LONG

**MAXON®**

11921 Slauson Ave. Santa Fe Springs, CA. 90670 (800) 227-4116 FAX (888) 771-7713



## OPENING PLATFORM

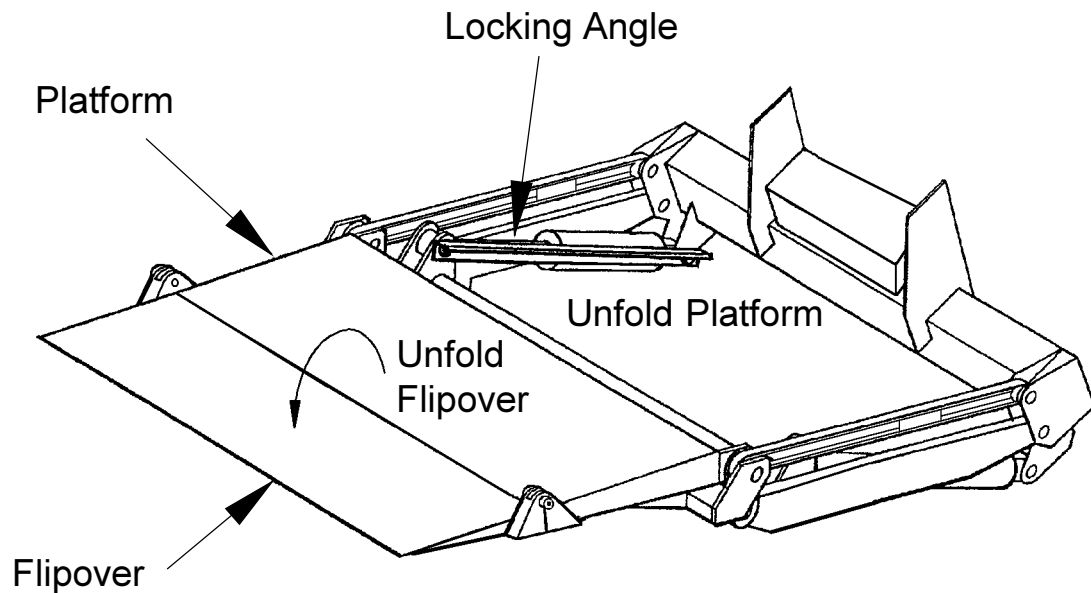

### **WARNING!**

Do not remove the Locking Angle until instructed to do so in this manual.

The Locking Angles on 80-3LM, & 80-4LM are located inside the Lifting Arms (Shown).

**Keep Feet Clear when Unfolding the Platform.**

# WELD LIFTGATE TO VEHICLE

Place a "C" Clamp on each side of the Platform as shown to prevent the Hoist Chain from slipping off of the Platform. Tack weld two (2) temporary support straps to the Extension Plate to align the Platform. Place chain entirely around the Platform, then hoist and jack the unit into position. The rear edge of the Platform must be flush with the Extension Plate. The Hinge Pins must be 90° to the vehicle bed.

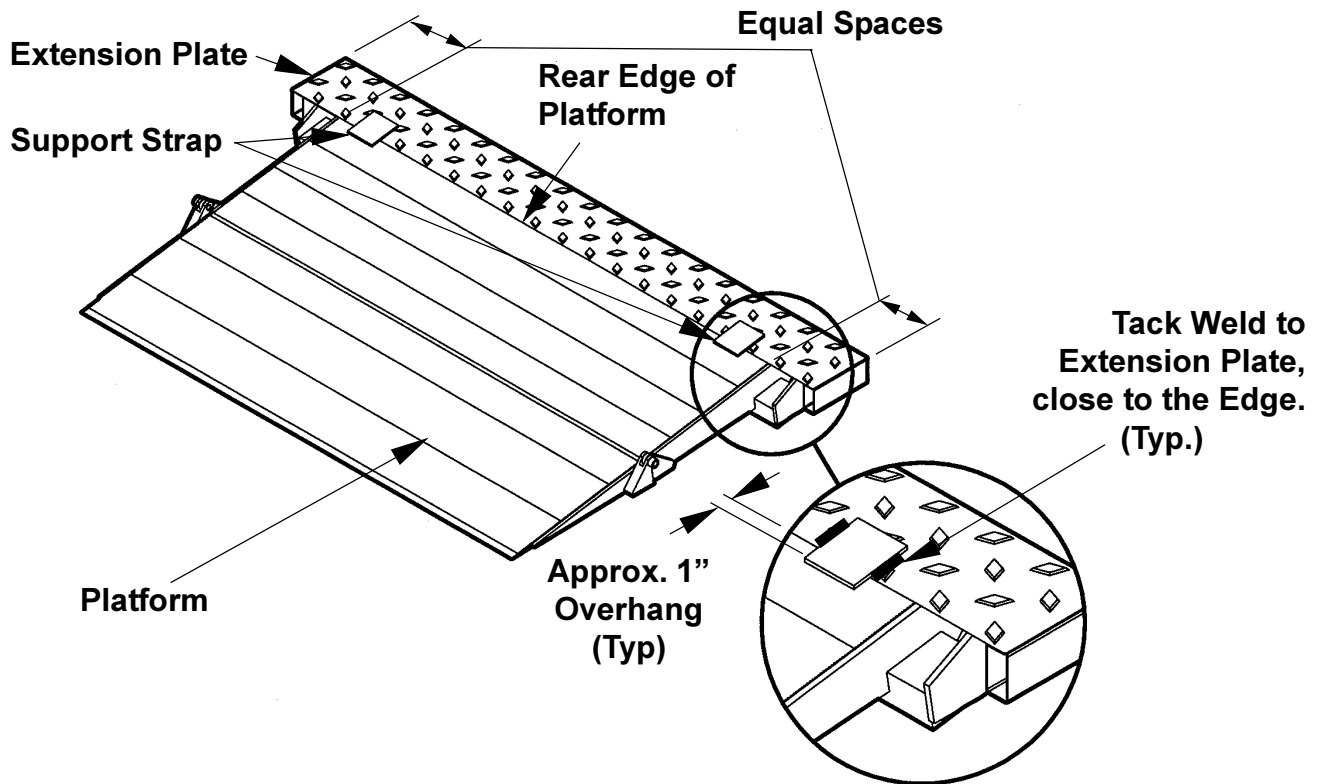
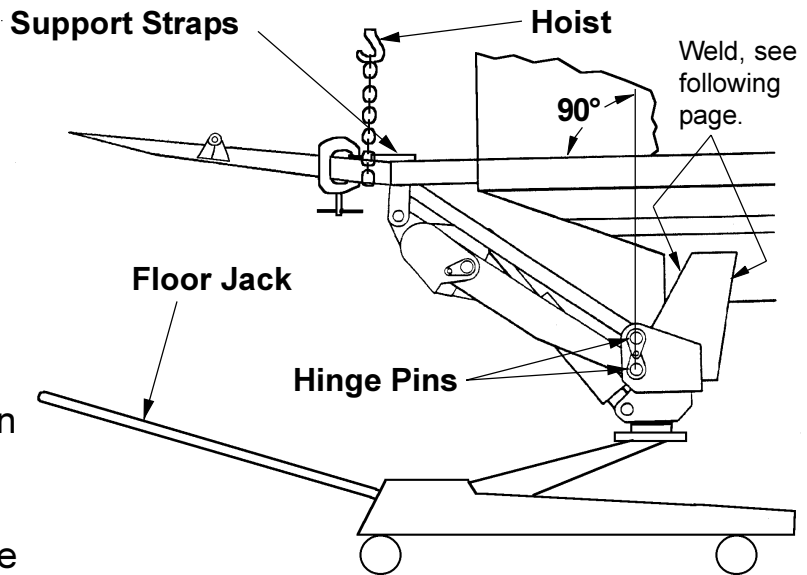

The rear edge of the Platform must be level with and flush against the Extension Plate. The edges of the Platform should be equally spaced inboard from the ends of the Extension Plate. Tack weld the two (2) temporary Extension Plate support straps to the Extension Plate.

**MAXON®**

11921 Slauson Ave. Santa Fe Springs, CA. 90670 (800) 227-4116 FAX (888) 771-7713

## WELD LIFTGATE TO VEHICLE

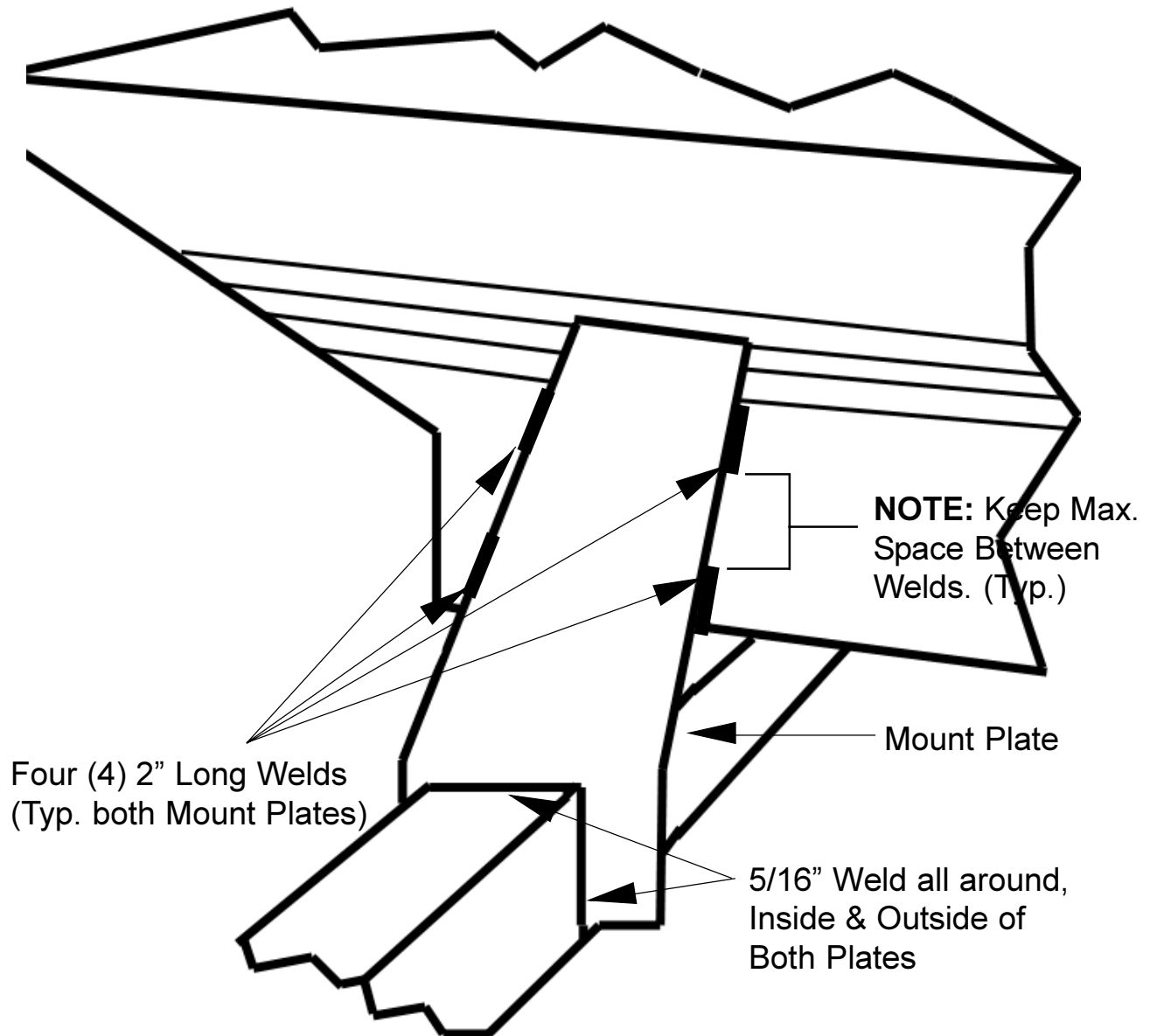

### IMPORTANT!



**Mount Plates are only tack welded when shipped from the factory. Complete the welds as shown before using.**

### NOTE!

After the Unit is welded to the Main Frame, install the Electrical System as shown on the following pages.

# CONTROL SWITCH CHANNEL INSTALLATION

Position Switch Channel with holes on top and resting on the Extension Plate. Leave a minimum of 1/2" clearance for cable at bottom, or drill 1/2" Dia. access hole through the Corner Post near the lower edge of Switch Channel.

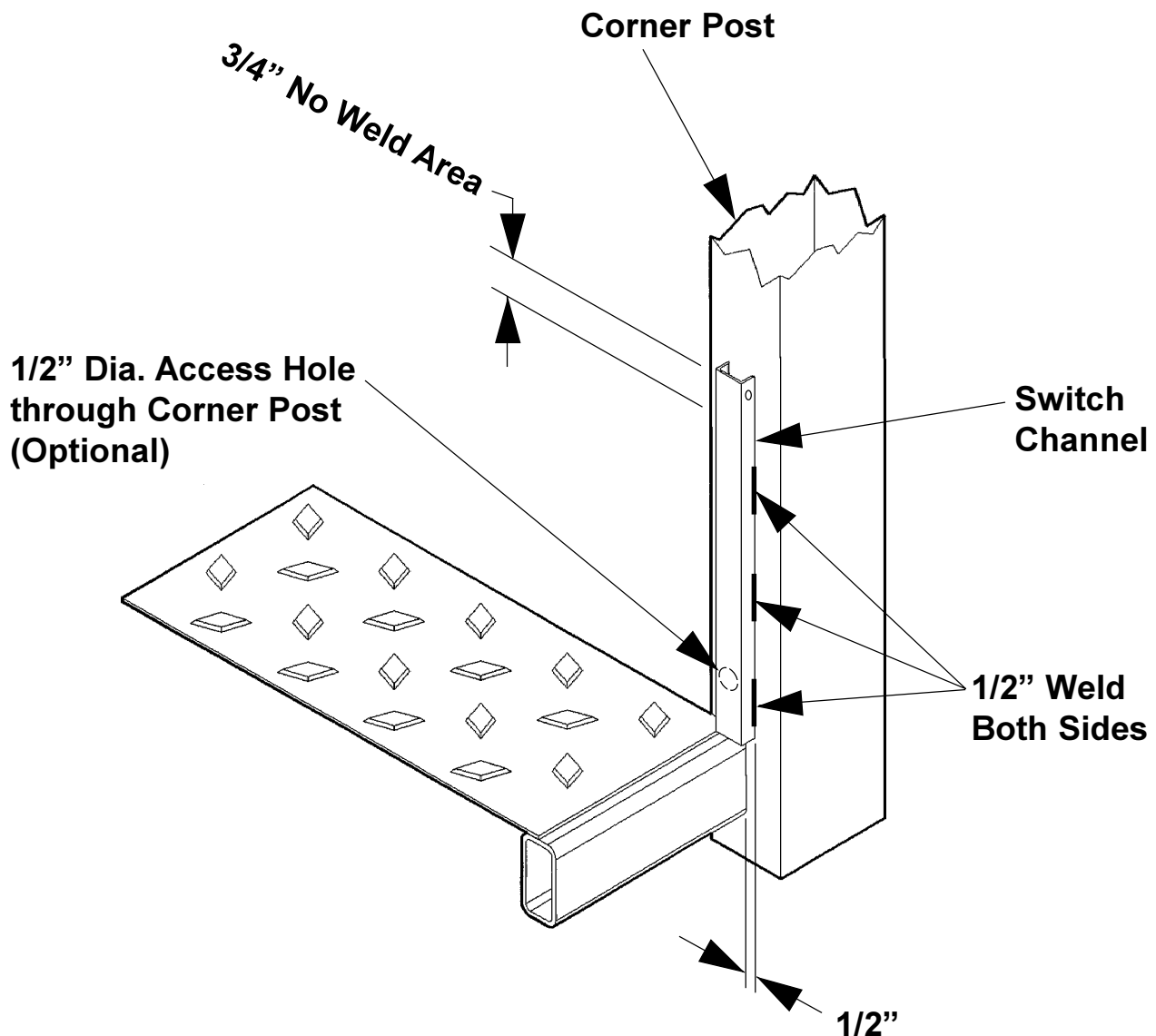

**MAXON®**

11921 Slauson Ave. Santa Fe Springs, CA. 90670 (800) 227-4116 FAX (888) 771-7713

# CONTROL SWITCH CHANNEL INSTALLATION

Some vehicles are equipped with rear tail lights mounted on the corner post. This will require modification of the switch channel. Drill a 1/2" Dia. access hole through the street side Corner Post, just above the light. With the Channel holes on top, cut the Channel length as required (2" Min.), and weld to the Corner Post (approximately 18" from top of Channel to the vehicle bed).

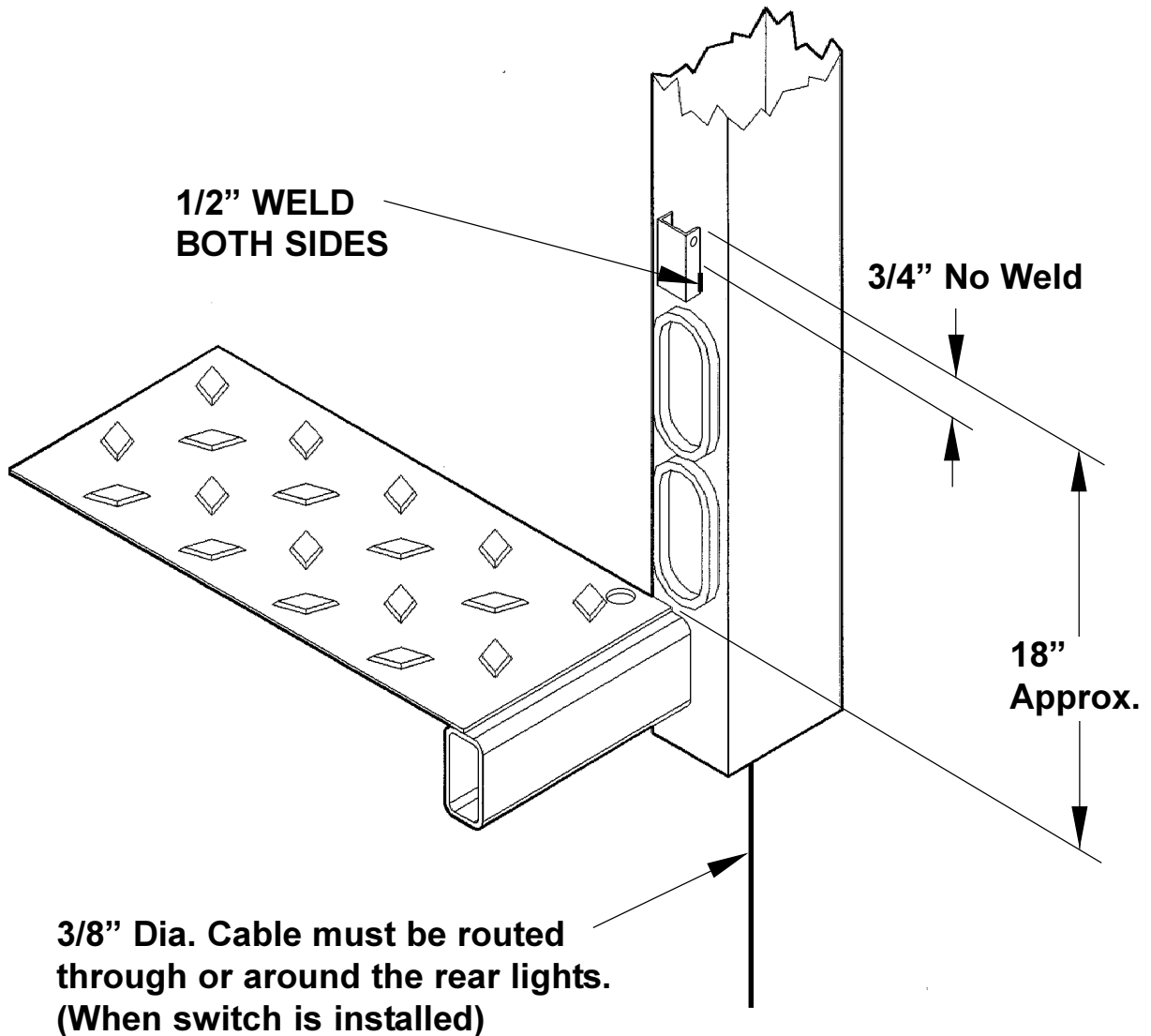

## CONTROL SWITCH GRAVITY DOWN

Assemble Switch in Mount Bracket as shown. When mounting the bracket to the Channel, note the location of the Wht. & Blk. wires to ensure proper wiring to match the "UP/DOWN" Decal.

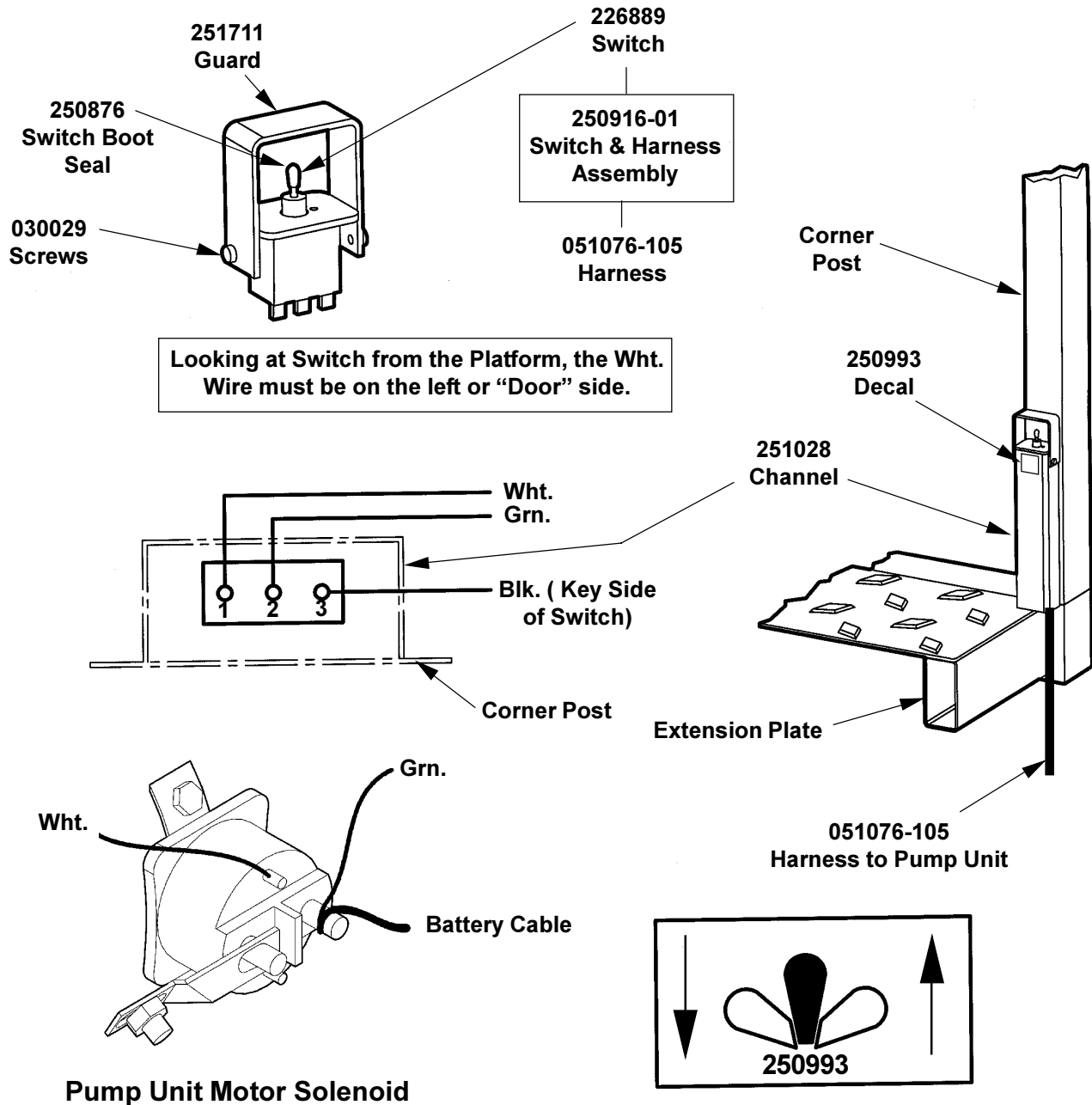

# FUSED POWER CABLE

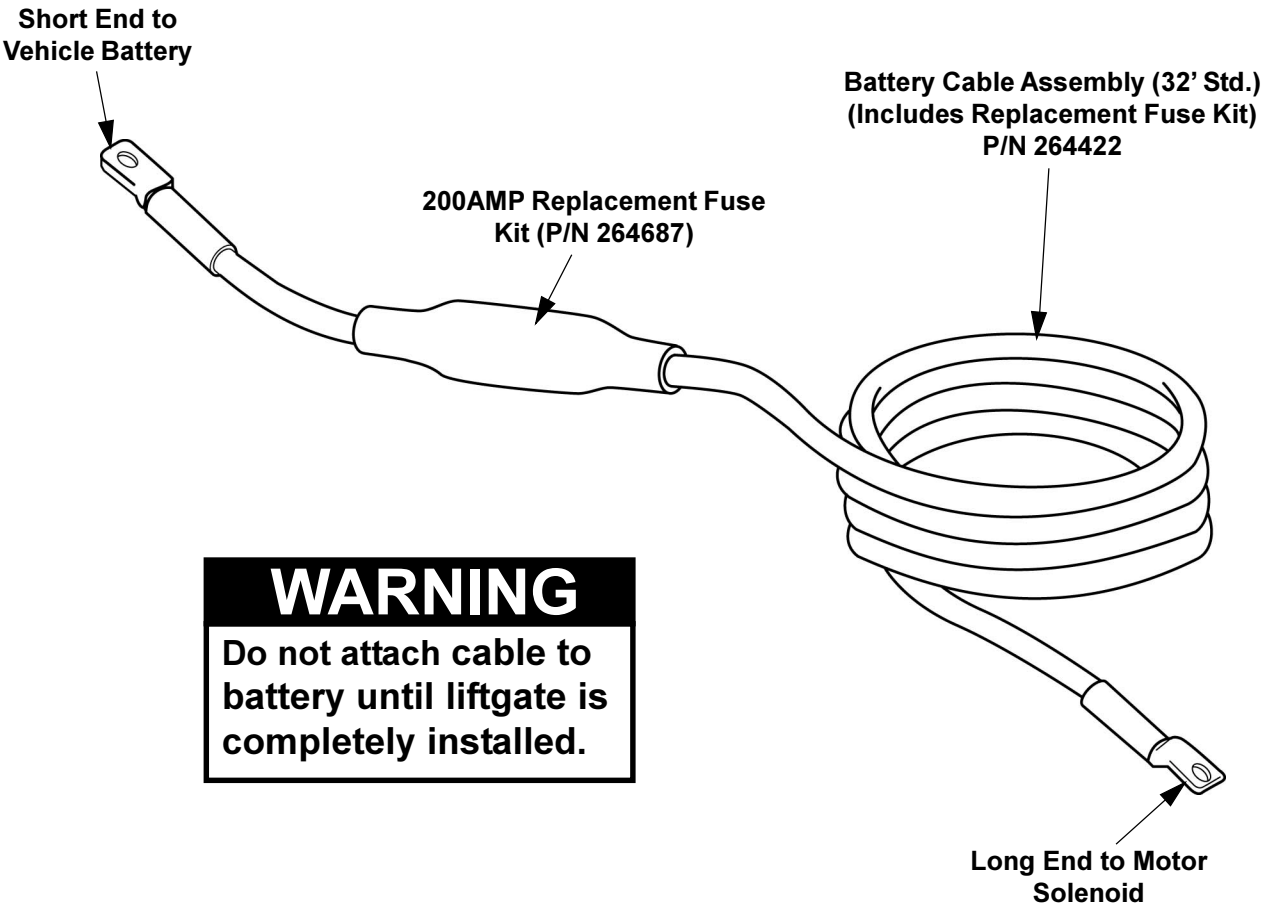

ADDITIONAL AVAILABLE BATTERY CABLE KITS		
	PART NUMBER	
40' CABLE ASSEMBLY	264848	<b>Cable Assembly</b> 
10' EXTENSION CABLE ASSEMBLY	264849	<b>Extension Cable Assembly</b> 

# WIRE CONNECTIONS GRAVITY DOWN

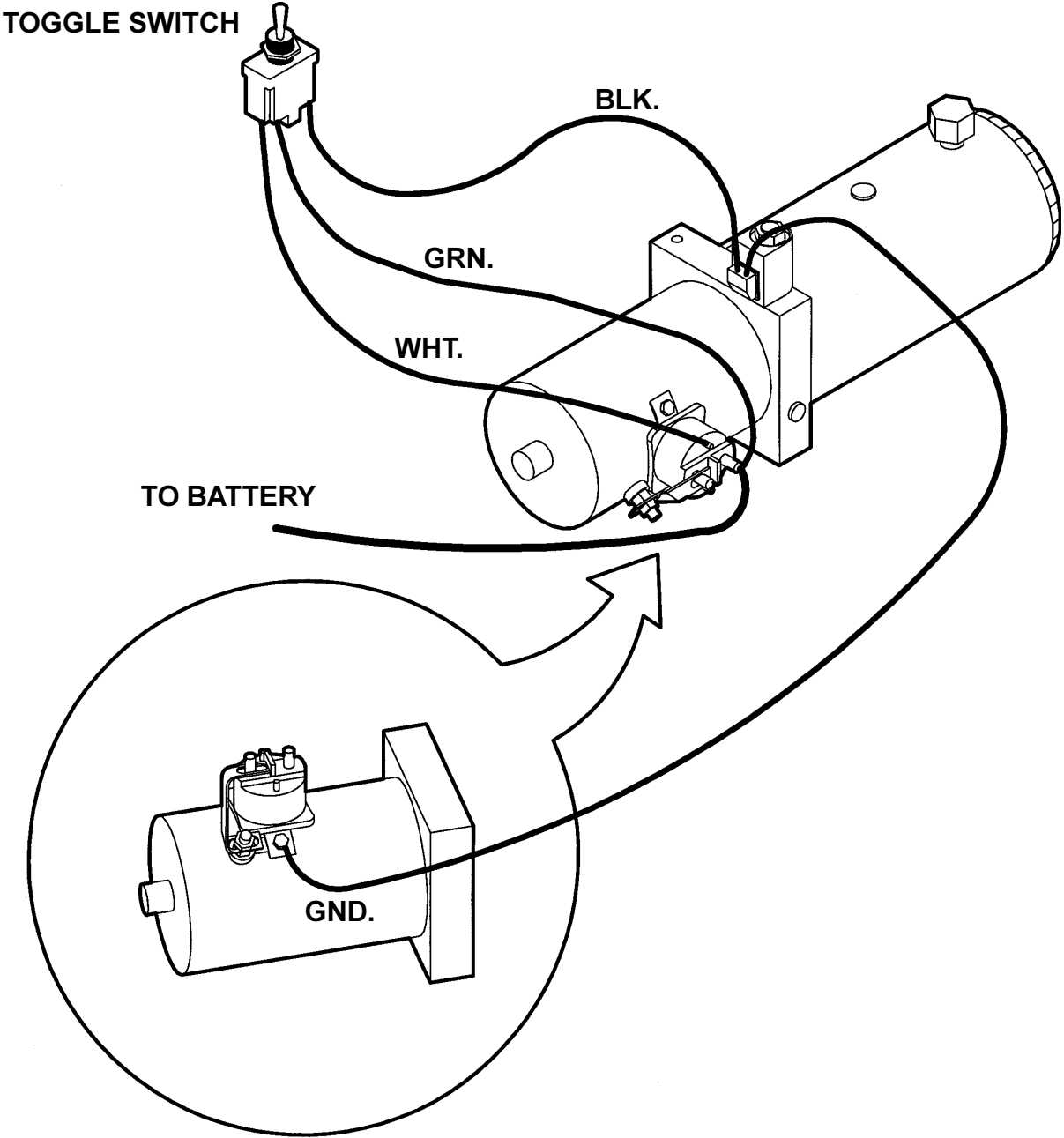

	POWER TO
UP	WHT.
DOWN	BLK.



# CONTROL SWITCH, POWER DOWN

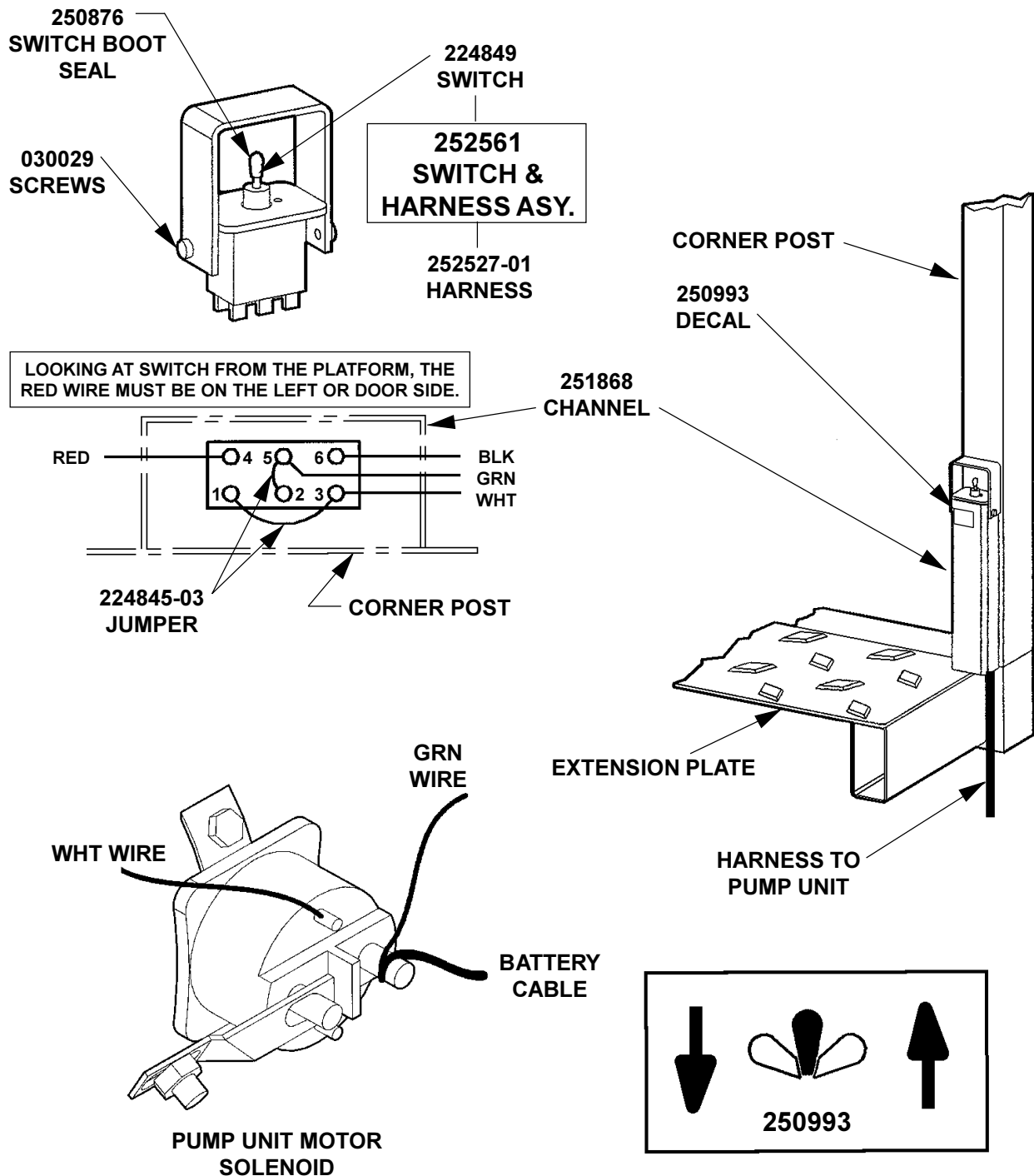

# FUSED POWER CABLE

Short End to  
Vehicle Battery

200AMP Replacement Fuse  
Kit (P/N 264687)



Battery Cable Assembly (32' Std.)  
(Includes Replacement Fuse Kit)  
P/N 264422

## WARNING

Do not attach cable to  
battery until liftgate is  
completely installed.

Long End to Motor  
Solenoid

### ADDITIONAL AVAILABLE BATTERY CABLE KITS

	PART NUMBER	
40' CABLE ASSEMBLY	264848	<b>Cable Assembly</b> 
10' EXTENSION CABLE ASSEMBLY	264849	<b>Extension Cable Assembly</b> 

**MAXON®**

11921 Slauson Ave. Santa Fe Springs, CA. 90670 (800) 227-4116 FAX (888) 771-7713

# WIRE CONNECTIONS, POWER DOWN

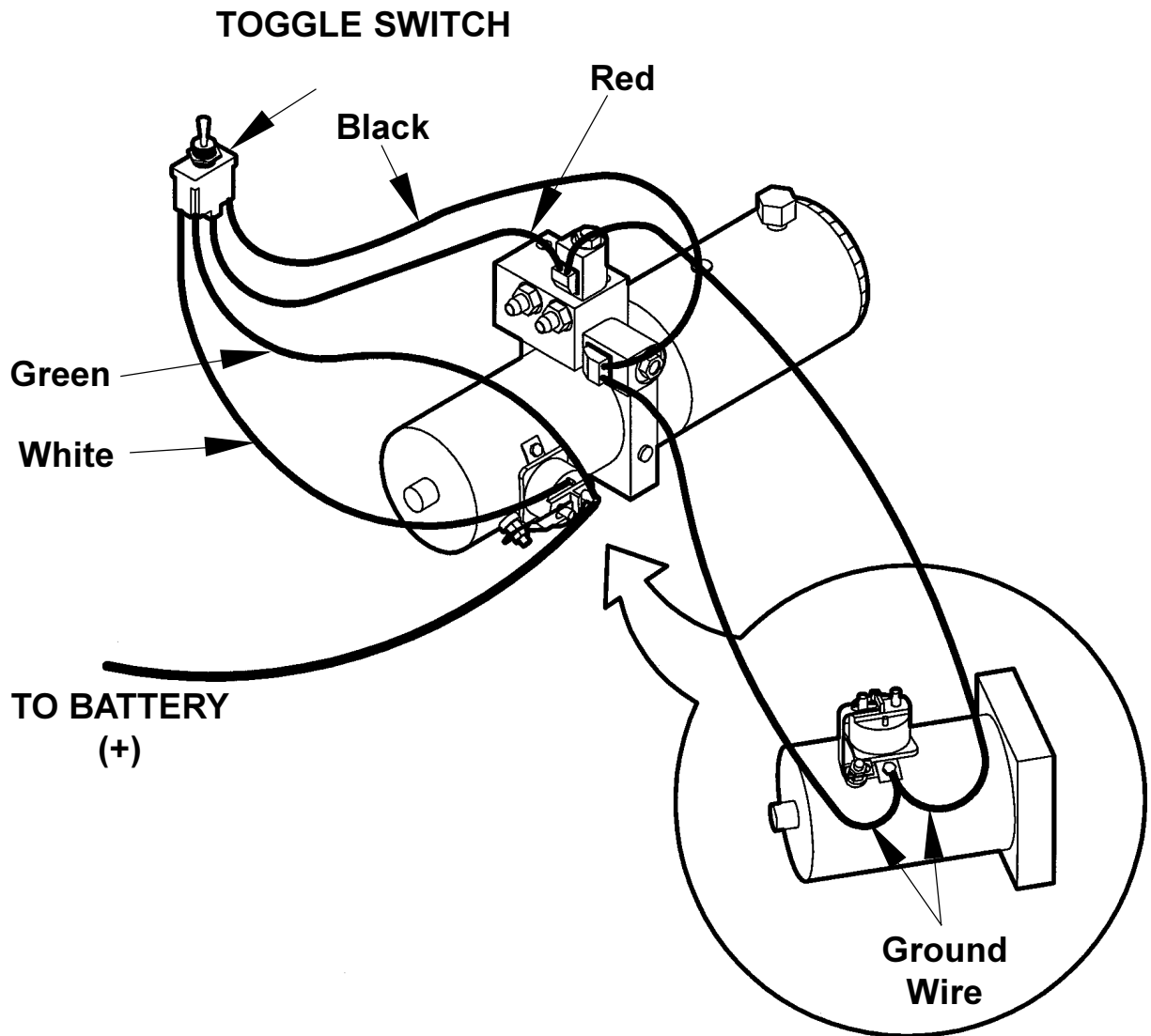

	POWER TO
UP	WHT, RED
DOWN	WHT, BLK

# HYD. HOSE ROUTING, GRAVITY DOWN

**MAXON®**

11921 Slauson Ave. Santa Fe Springs, CA. 90670 (800) 227-4116 FAX (888) 771-7713

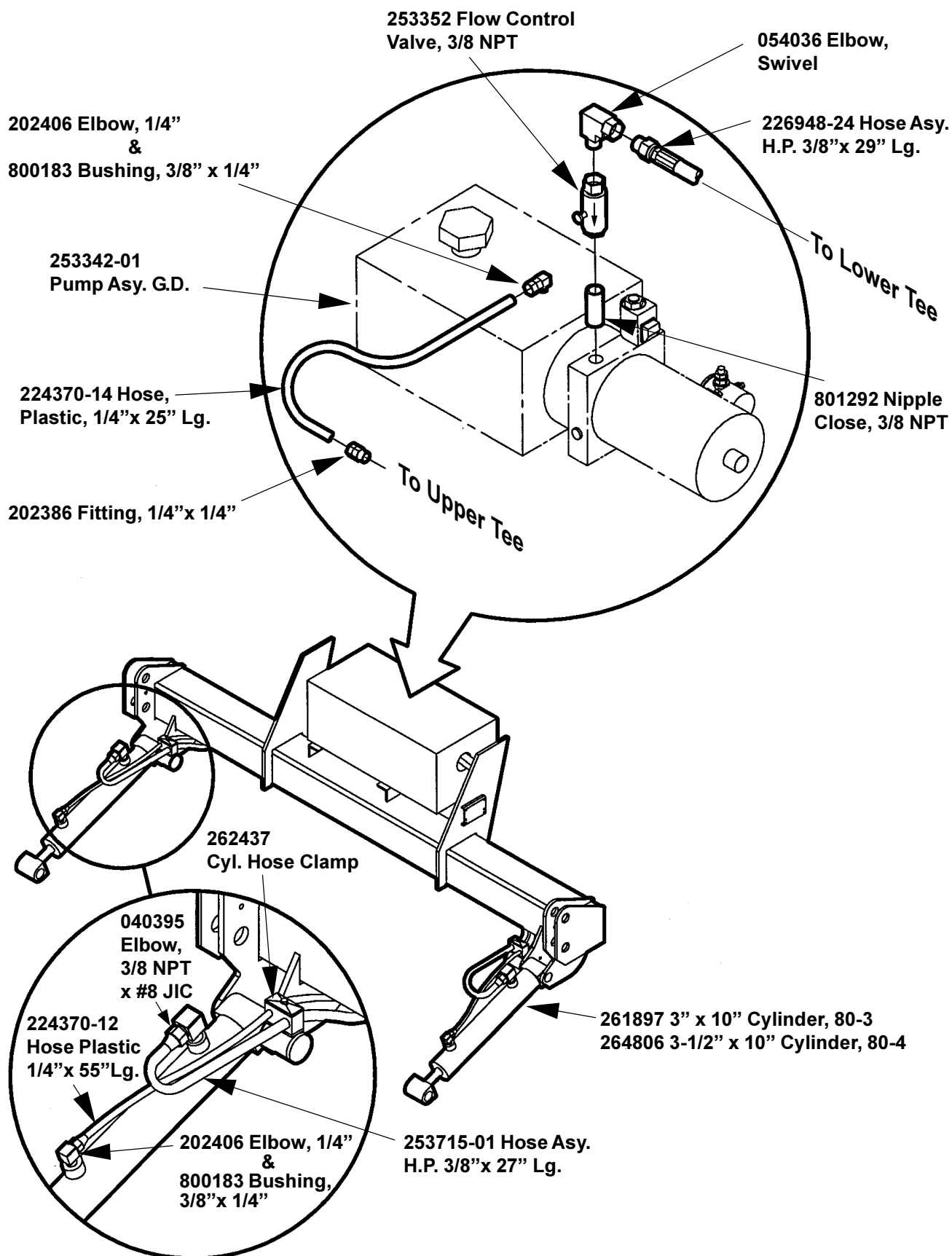

# HYD. HOSE ROUTING, GRAVITY DOWN

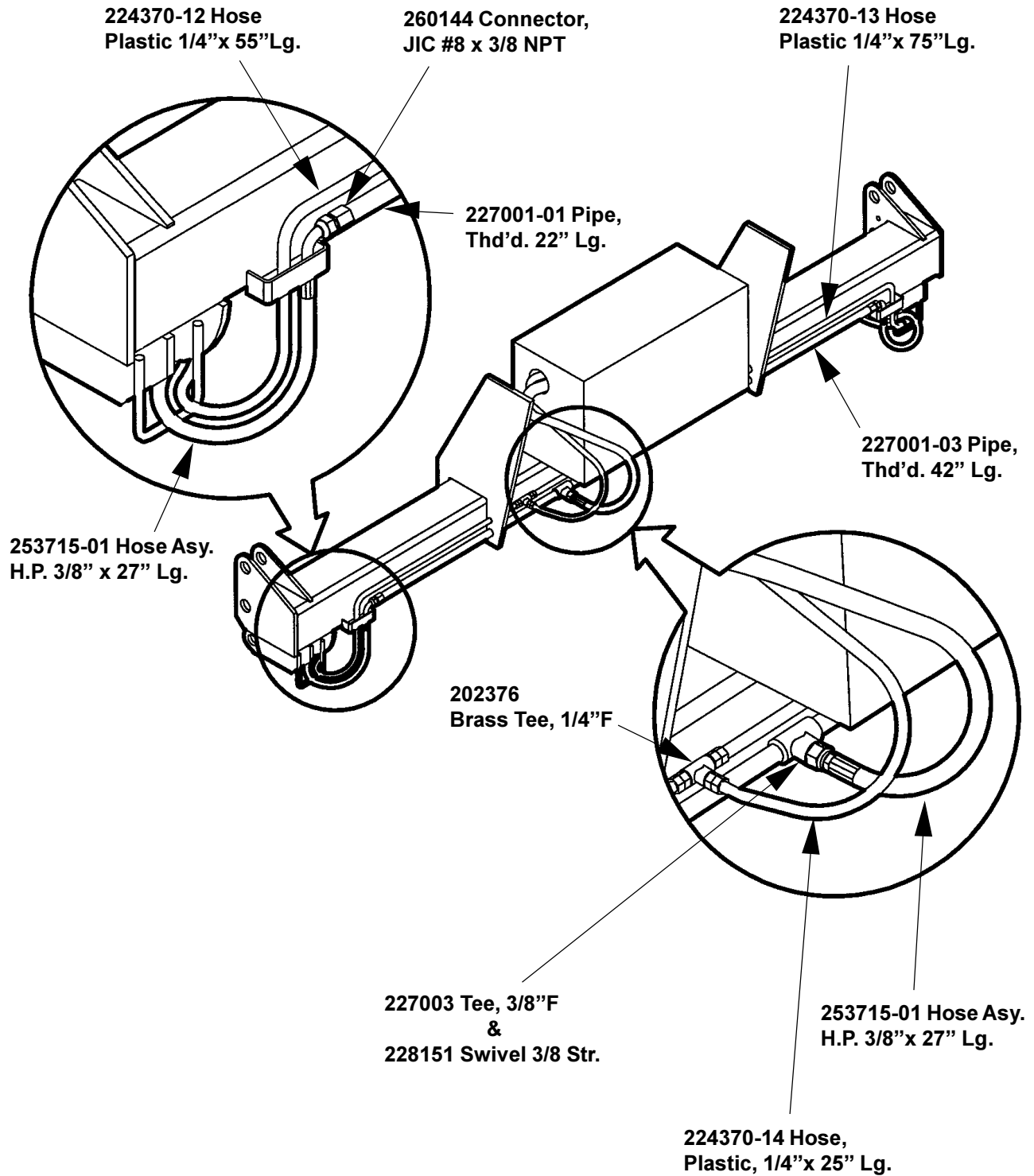

# HYD. HOSE ROUTING, POWER DOWN

**MAXON®**

11921 Slauson Ave. Santa Fe Springs, CA. 90670 (800) 227-4116 FAX (888) 771-7713

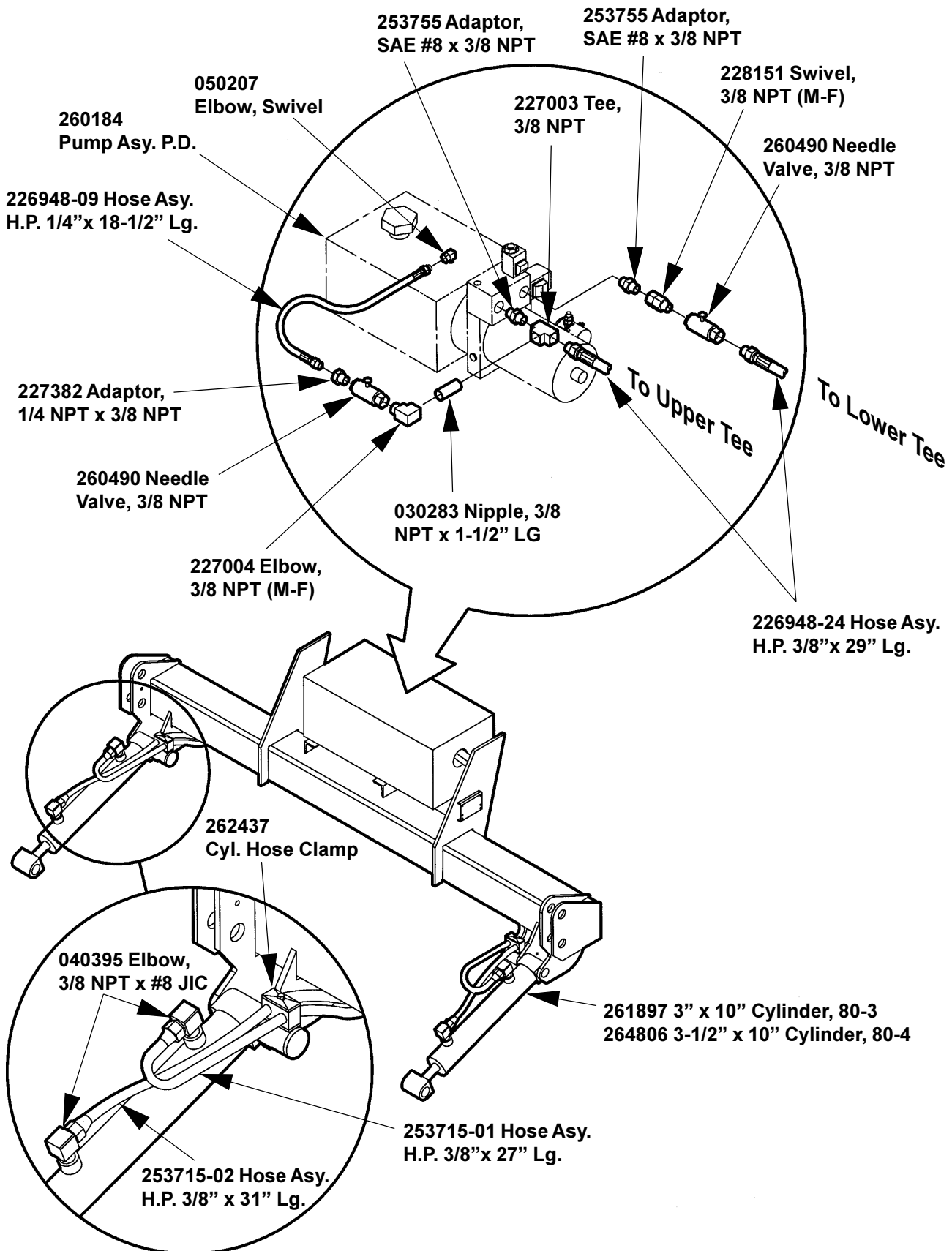

# HYD. HOSE ROUTING, POWER DOWN

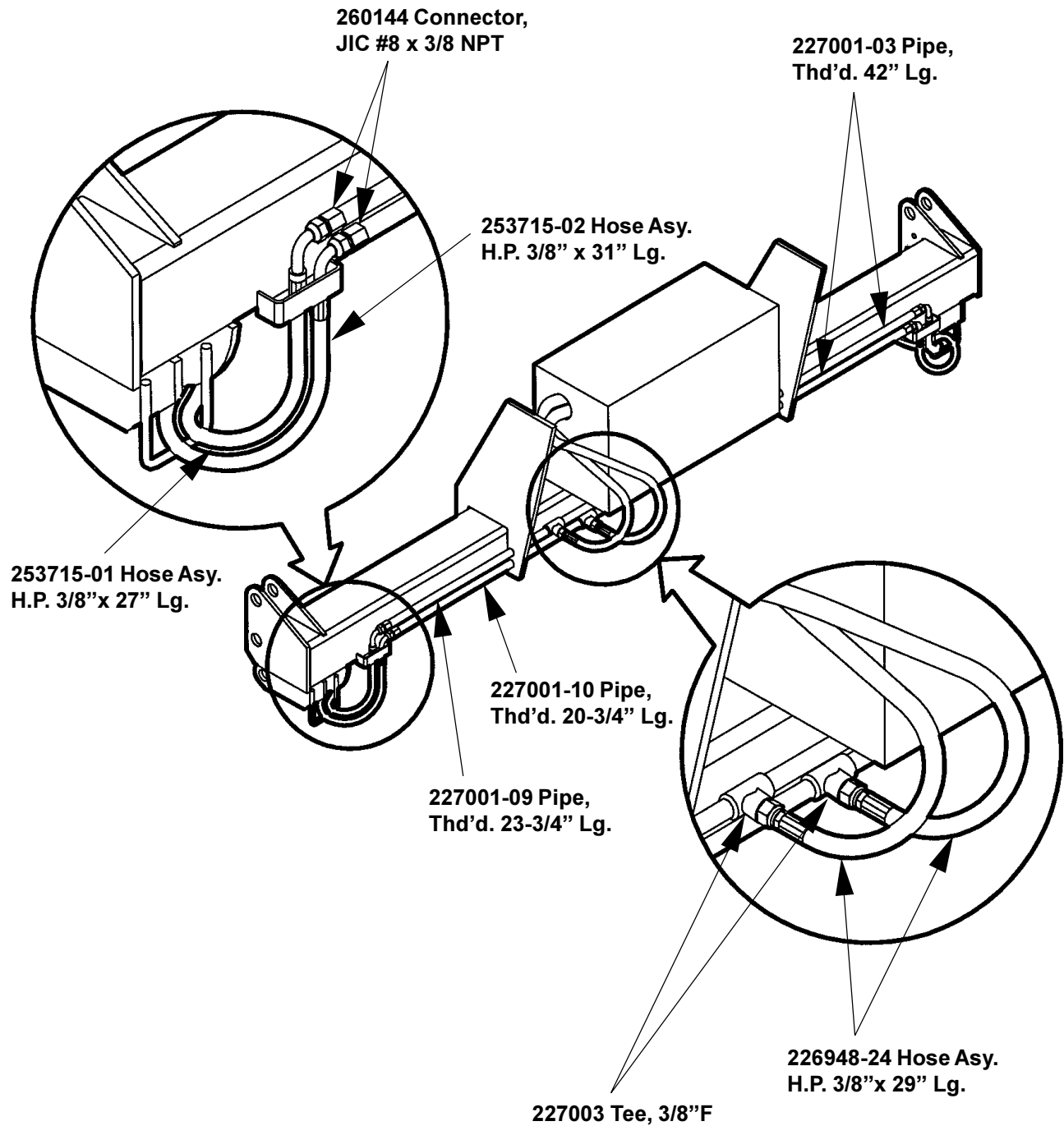

# DECALS, 80 SERIES

Warning Decal  
P/N 260008

Operating Decal  
P/N 262433

Capacity  
Decal

Safety Hook Decal  
P/N 263988

(Placed on both sides of  
Extension Plate)

These Decals are located on the rear corner post of the vehicle, at the control position. They should be read completely and understood before operating the Lift Gate. They should also be kept clean and readable at all times. If any decal should become detached from the vehicle, or defaced, it must be replaced. Free replacements are available from: **MAXON Lift Corp., Parts Dept.**

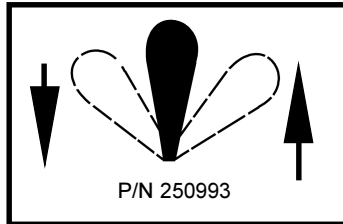
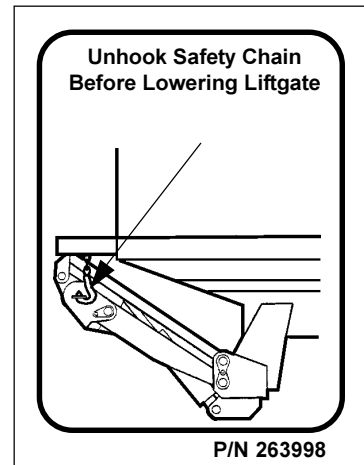

CAPACITY DECALS	
SIZE	PART NO.
3000 LBS.	220388
4000 LBS.	220389



## **WARNING** **READ CAREFULLY**



- Improper operation of this Lift can result in serious personal injury. Do not operate unless you have been properly instructed and have read, and are familiar with the operating instructions. If you do not have a copy of the instructions, please obtain them from your employer, distributor, or lessor, before you attempt to operate Lift.
- Be certain that the vehicle is properly and securely braked before using the Lift.
- Always inspect this Lift for maintenance or damage before using it. If there are signs of improper maintenance, damage to vital parts, or slippery Platform surface, do not use the Lift until these problems have been corrected.
- Do not overload the Lift. The load limit is based on evenly distributed cargo over the entire Platform surface. If you are using a pallet jack, be sure it can be maneuvered safely. Do not operate a forklift on the Platform or travel with the platform in an open position at any time.
- Load should be placed in a stable position close to the edge of the Platform nearest the truck. The heaviest portion of the load should never be placed beyond the center of the Platform away from the truck.
- Never allow yourself, a helper, or bystander to stand in a position where a falling load could land on either of you. Also do not allow any part of yours or your helper's body to be placed under, within, or around any portion of the moving liftgate, or its mechanisms, or in a position that would trap them between the platform and the ground or truck when the liftgate is operated.
- If a helper is riding the Platform with you, make sure you are both doing so safely and that you are not in danger of coming in contact with any moving or potentially moving obstacles. USE GOOD COMMON SENSE. If load appears to be unsafe, do not lift or lower it.

MAXON LIFT CORP.

PART NO. 264081

OPERATING INSTRUCTIONS GPT & 80-3/4 Units	
①	<p>Unhook Safety Chain First.</p>
②	<p>Activate Toggle Switch to Lower Stowed Lift Gate</p> <p>This point must touch the ground</p>
③	<p>Open Platform</p>
④	<p>Open Flipover</p>
⑤	<p>Activate Toggle Switch to Raise or Lower Platform</p>
⑥	<p>To Tuck Unit Away after Use, Reverse Steps 1 thru 4</p>
<p><b>MAXON®</b> P/N 251838</p>	



# POWER CABLE INFORMATION

## CRIMPING

A proper crimp is one which does not have an air gap between the cable and the copper end fittings after crimping. The crimped end fitting shall not have any cracks.

Proper sized crimping dies shall be used with a hydraulic or manual crimping tool. Crimping dies which are struck with a hammer are not acceptable for initial installation, and should be used only in the case of an emergency repair. Heat Shrink tubing is provided and must be installed at each end fitting.



Extra Heavy Duty  
Crimping Tool

Heat Shrink Tubing

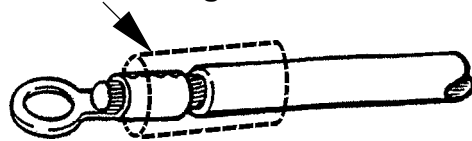

Never use a Hammer to flatten  
the End Fitting when installing  
on Power Cable

## ROUTING

For Trucks, route the cable along the chassis frame flange. Use caution when routing through or around chassis cross members to avoid sharp edges which could wear through the cable jacket. **MAXON** supplies cable installation clips as shown in **Fig. 1**.

For Trailers, clamps are provided in the Trailer Kit and can be bolted to the trailer cross members. This allows the cable to run under the cross members. See **Fig. 2**.

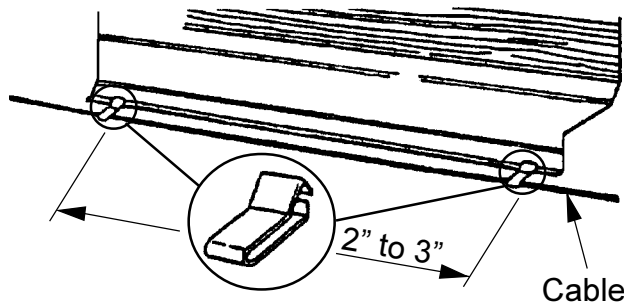

FIGURE 1

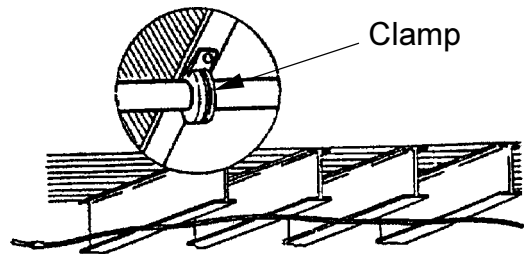

FIGURE 2

## PLATFORM OPENER

**1.** Fold the Flipover onto the Platform, and raise the Platform to the folded position, (approximately 5° from vertical).

**2.** Position the Opener on top of the Mainframe Weldment, and slide the Opener to where it butts up against the folded Platform. Tack weld into position.

**3.** Open and close Platform several times to insure there will be no interference with this location, and weld all around to the Mainframe.

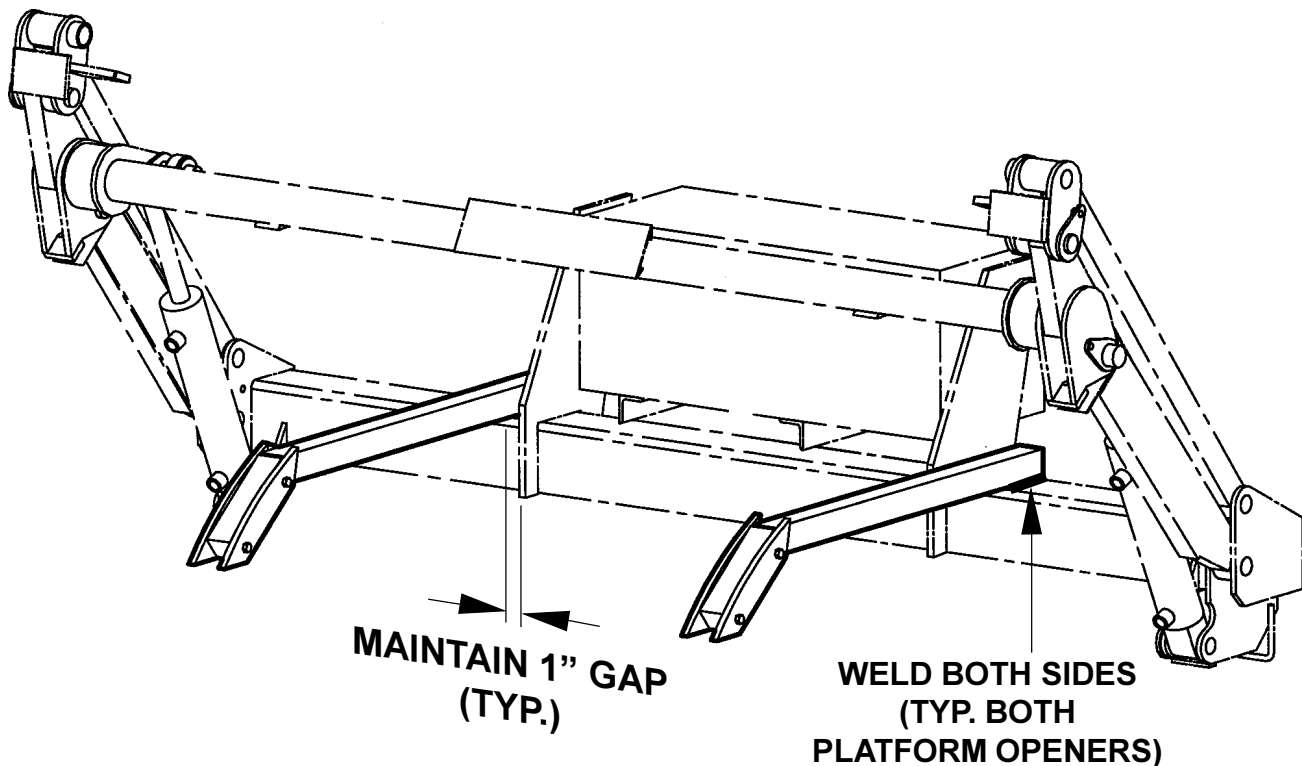
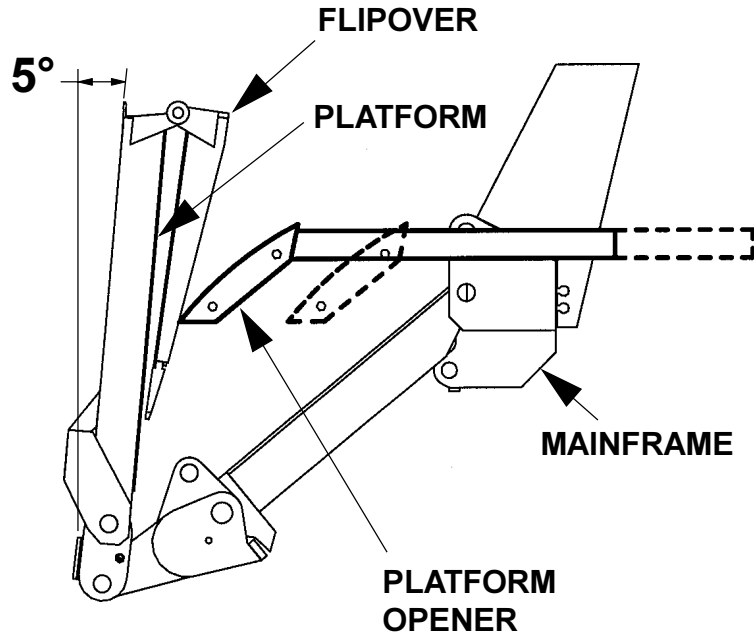

# SADDLE MOUNTING INSTRUCTIONS

1. After mounting the Platform Openers, straddle the Saddle Weldments over the Platform Openers as shown.

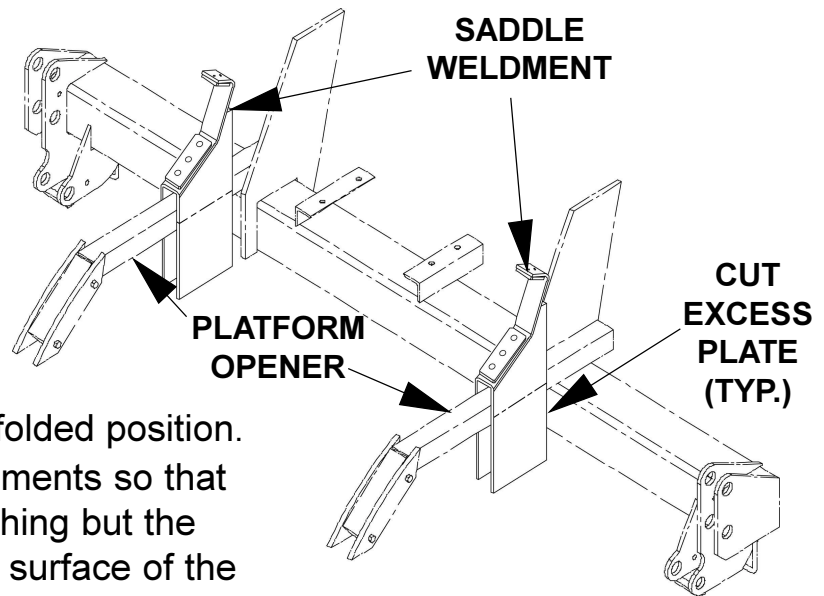

2. Store the Platform in the folded position. Position the Saddle Weldments so that the Platform touches nothing but the Plastic Pads on the inner surface of the saddle weldment. **NOTE:** Open & close Platform to ensure the Saddle Weldment is positioned correctly for the stowing procedure. Rotate Saddle Weldment as required to achieve this. Cut off any excess plate and weld Saddle to the Platform Openers.

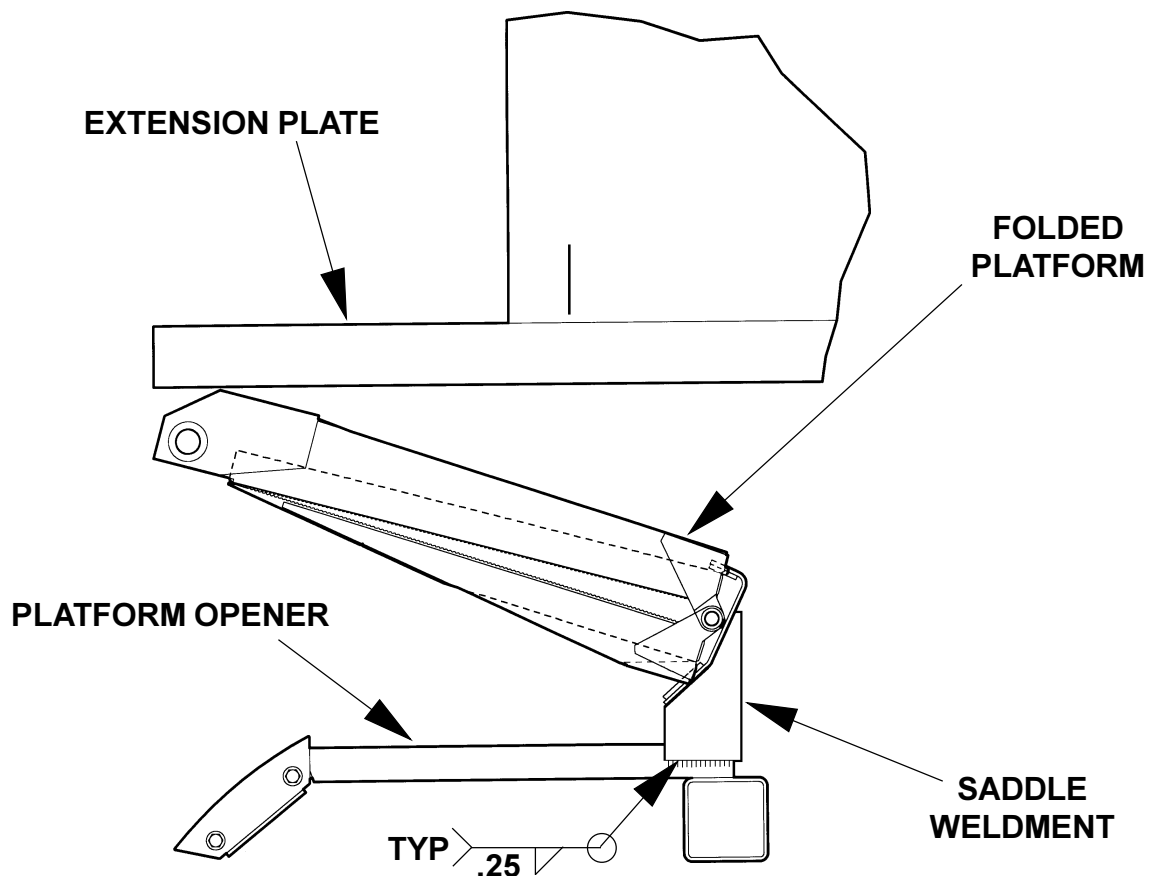

## SUGGESTED REAR LIGHT INSTALLATION (AFTER OPENERS ARE WELDED)

**NOTE:** All lighting fixtures must be installed in accordance with all applicable state and federal laws.

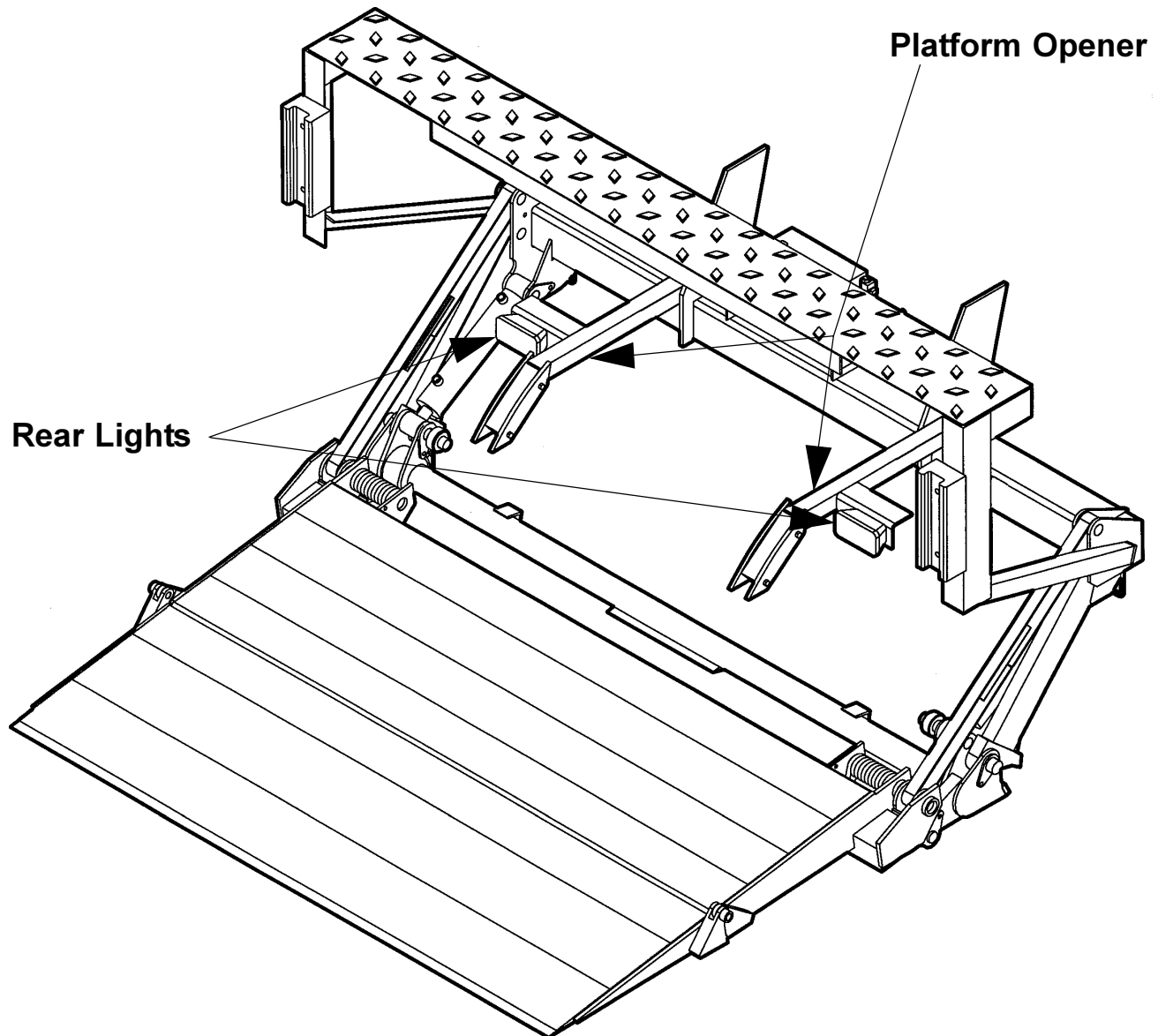

**NOTE:** Light and Fixtures must not extend into the contact area of the Platform.

**MAXON®**

11921 Slauson Ave. Santa Fe Springs, CA. 90670 (800) 227-4116 FAX (888) 771-7713

## FINAL ADJUSTMENTS

1. Move Switch to the "UP" position. This will allow Pump to fill the hose and Cylinders with oil. When you no longer hear the sound of circulating oil, release the Switch. The system is full and ready for operation.
2. Remove the Lock-Angle from the Cylinder Pins.
3. Burn off the Support Straps from the Extension Plate & Platform.
4. Remove the Floorjack, chain, "C"-clamp, and Hoist.
5. Raise and Lower the Platform several times to assure proper alignment of the Unit. If alignment is correct, complete the welding of the Mounting Plates to the Vehicle. (Ref. Fig. 1).
6. If Platform lowers with a "jerking" motion, lower the Platform to ground level, holding the switch in the "DOWN" position until air can be heard escaping into the Reservoir. Raise the Platform and repeat as necessary until no air can be heard escaping to the Reservoir and the Platform lowers smoothly.

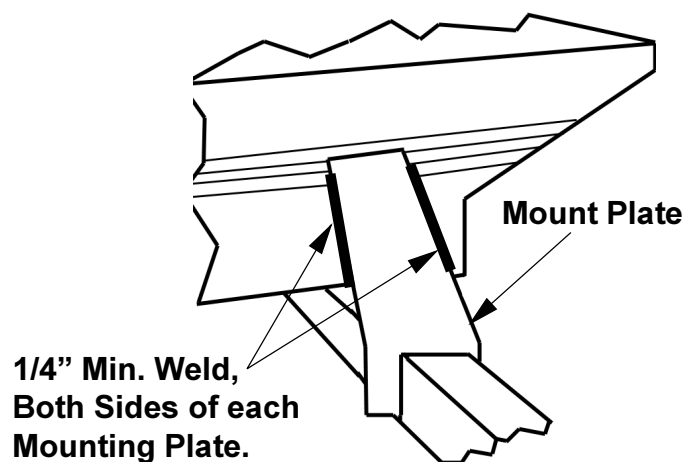

**FIGURE 1**

# PLATFORM ADJUSTMENT

The Platform should reflect the "YES" illustrations below with the tip of the Platform as much as 2-1/2" higher than the Extension Plate, or vehicle bed. There should be no sag in the Platform as pictured below.

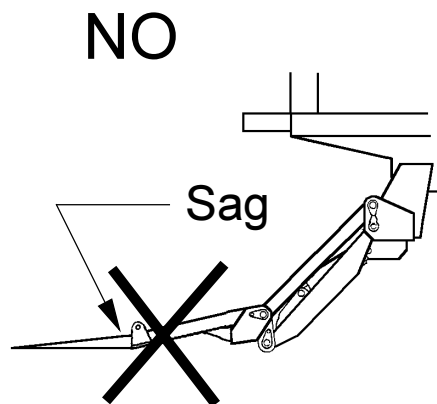
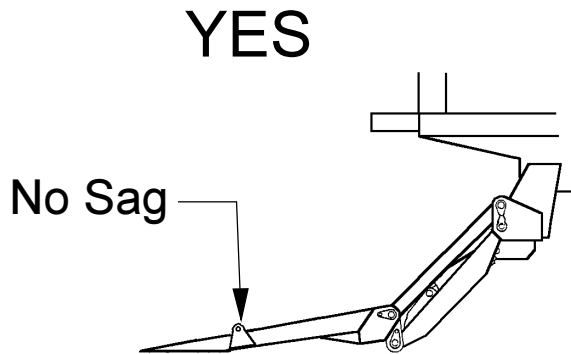
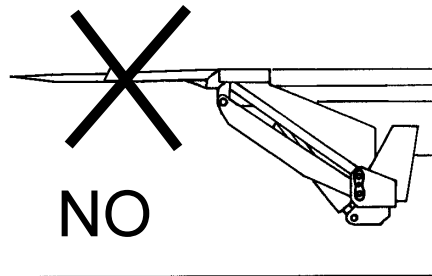
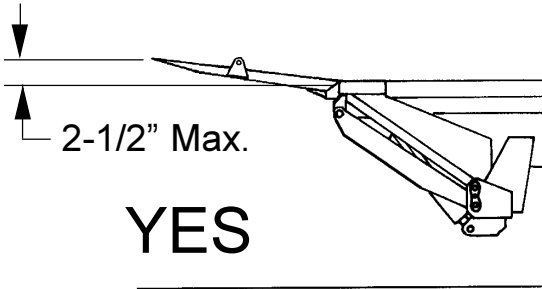

Lower the Platform to the ground so that the Shackles and Platform tip rest on the ground. If Platform is straight, no shimming is required. If Platform sags, appropriate shims must be added to both sides. Shims can be welded to position shown.

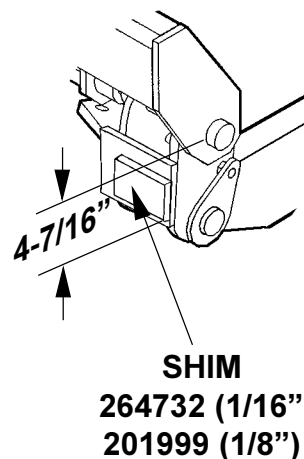
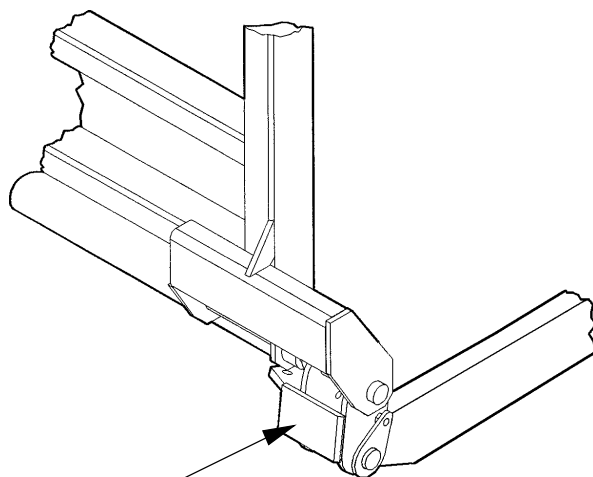

**MAXON®**

11921 Slauson Ave. Santa Fe Springs, CA. 90670 (800) 227-4116 FAX (888) 771-7713

## PLATFORM ADJUSTMENT

If Platform tip does not touch the ground, remove shackle plate from both sides. Weld shim plate (P/N 264731) in between flats. Check platform adjustment. Add an addition 1/16" or 1/8" shim if required.

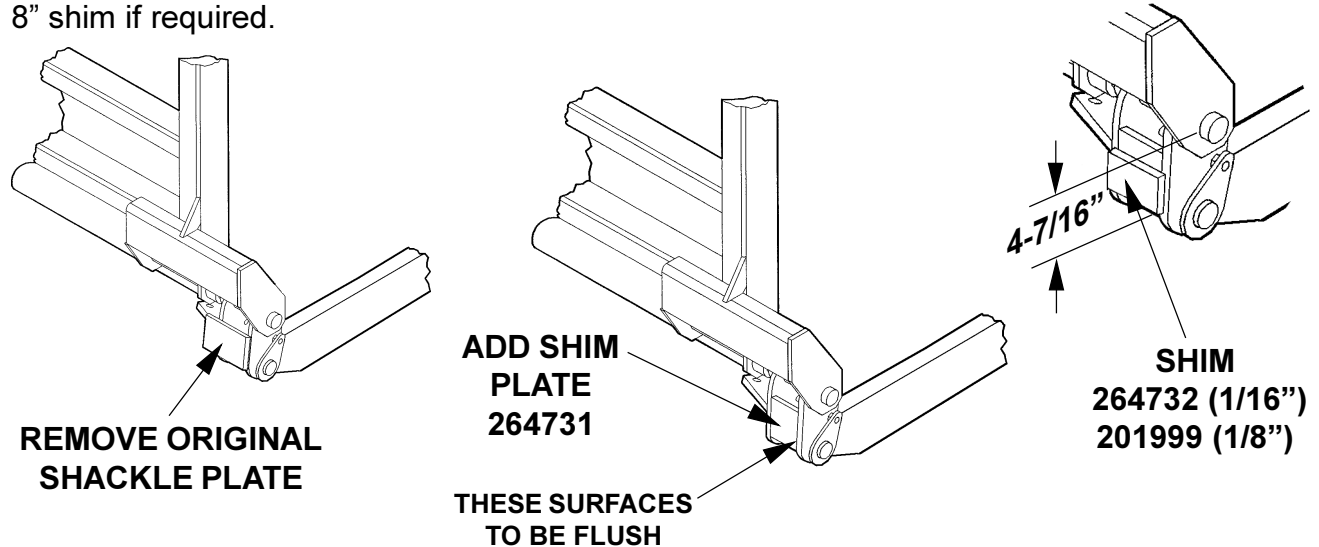

## HOOK INSTALLATION

Weld the Pad Eye to the Unit in the "up" position, insert the Hook through the Pad Eye. Weld the Chain to the inside wall of the Extension Plate Tube, leaving only enough slack to enable the Hook to be removed and reattached.

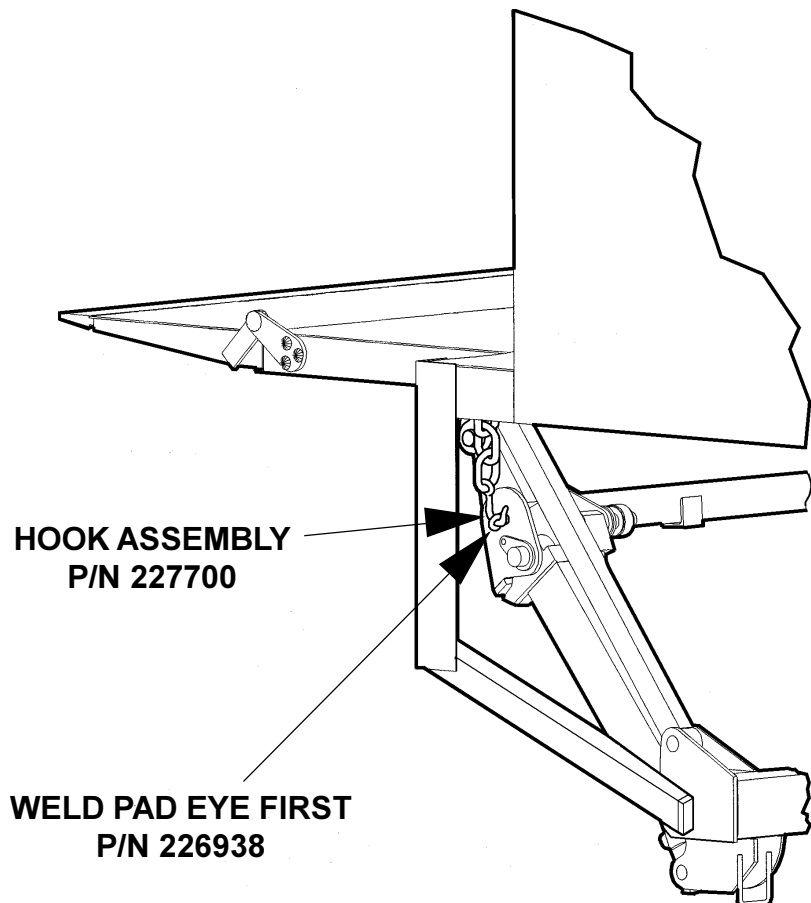

# ACCESSORIES SECTION

## 80-3, 80-4



# DOCK BUMPER ANGLES

## OPTIONAL

1. Weld the Dock Bumper Angles to the end of the Extension Plate Assembly. Be sure the holes in the Angle are facing toward the rear of the vehicle.
2. Weld the Dock Bumper Support Angles to the bottom of the Dock Bumper Angles and the Mainframe Assembly.

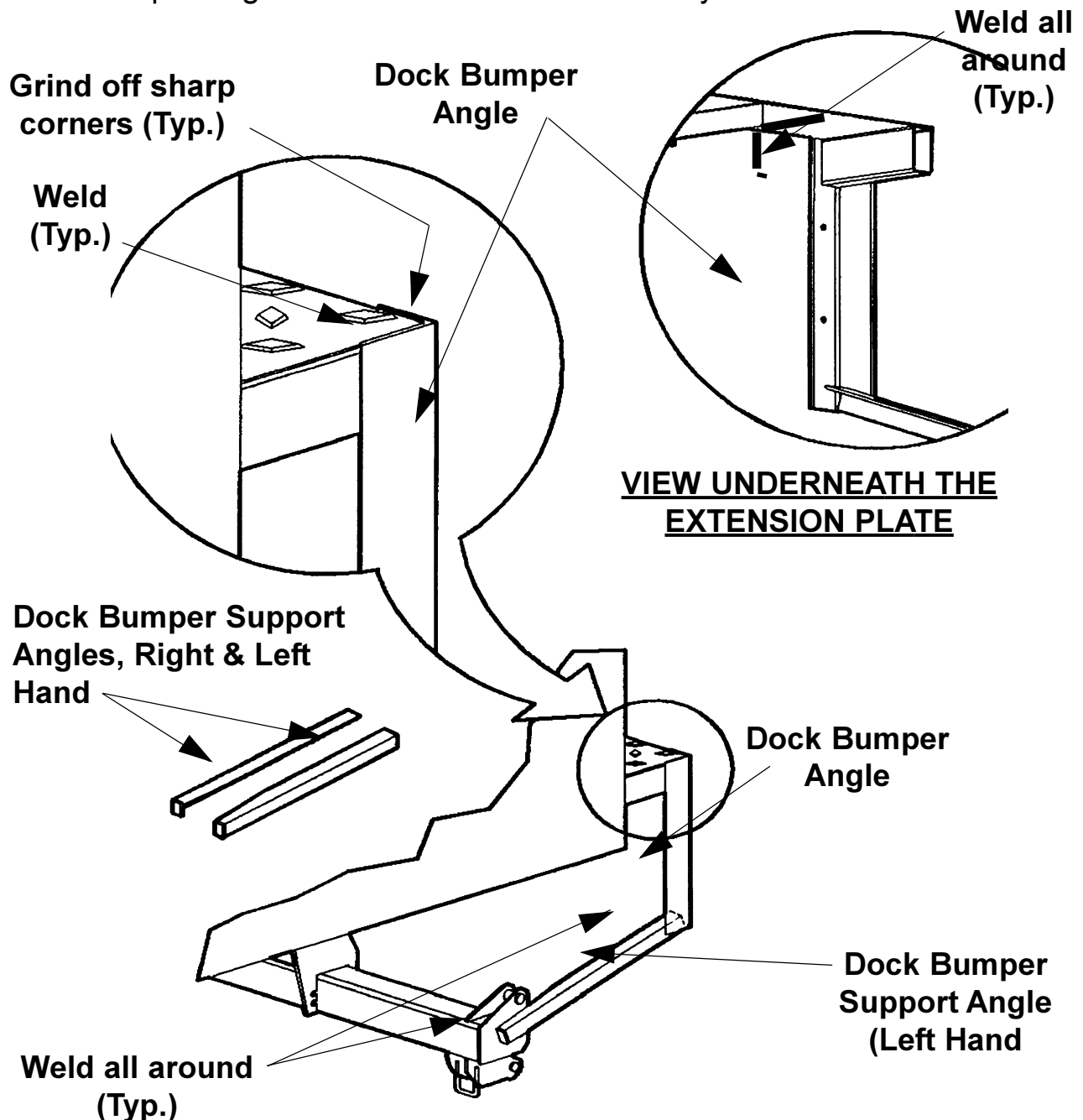

# BUMPER INSTALLATION

## OPTIONAL

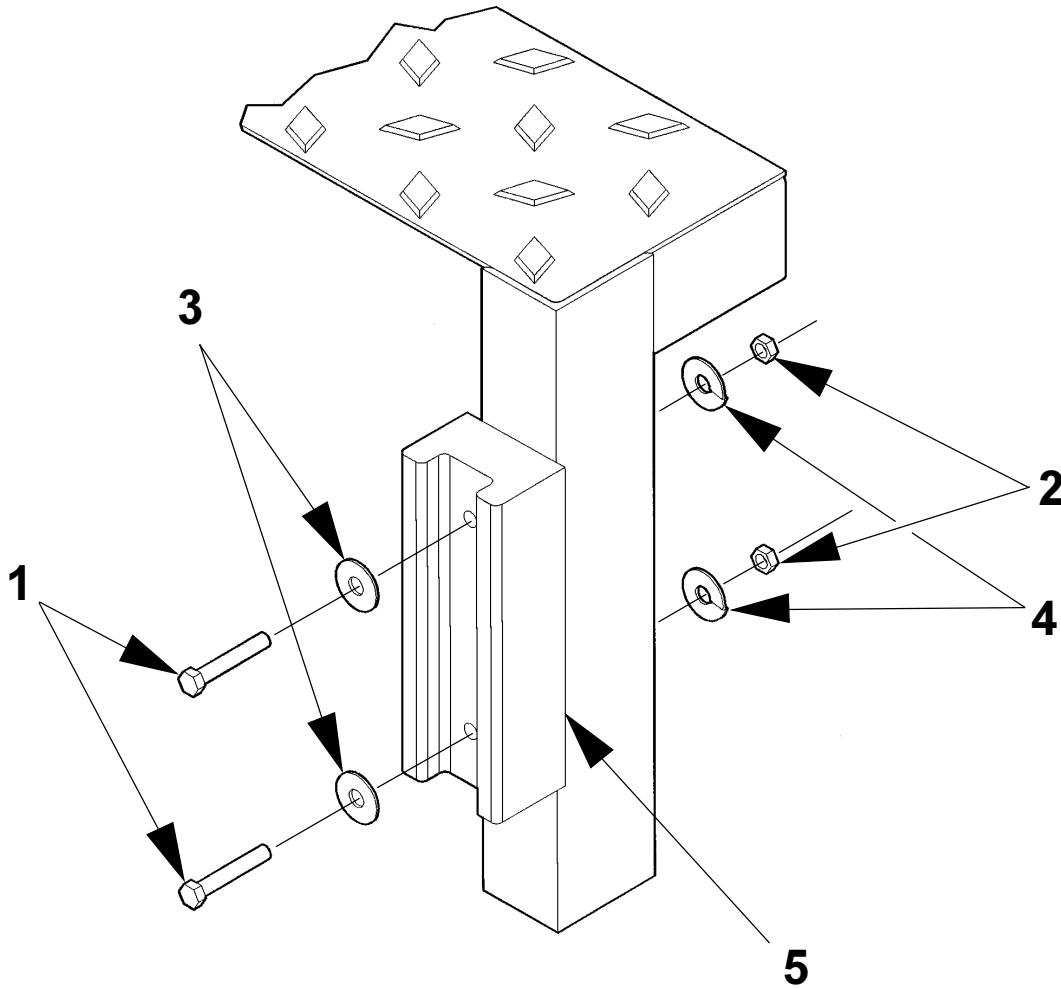

ITEM	QTY.	PART NUMBER	DESCRIPTION
1	4	030083	BOLT, 1/2-20 x 2" GR8 ZINC
2	4	030323	NUT, 1/2-20 ZINC
3	4	030566	WASHER, FLAT 1/2" ZINC
4	4	030567	WASHER, LOCK 1/2" ZINC
5	2	222988	BUMPER, 3 x 2 x 12" U-SHAPED

**MAXON®**

11921 Slauson Ave. Santa Fe Springs, CA. 90670 (800) 227-4116 FAX (888) 771-7713

# CIRCUIT BREAKER INSTALLATION

## OPTIONAL

**CIRCUIT BREAKER KIT PART NO. 251576**  
**THE CIRCUIT BREAKER (P/N 221736) IS RATED AT 150 AMPS**

### TRUCK MOUNT

Install Circuit Breaker no more than 24" from (+) battery post and between batteries and lift gate solenoid (See Fig. 1 & 2).

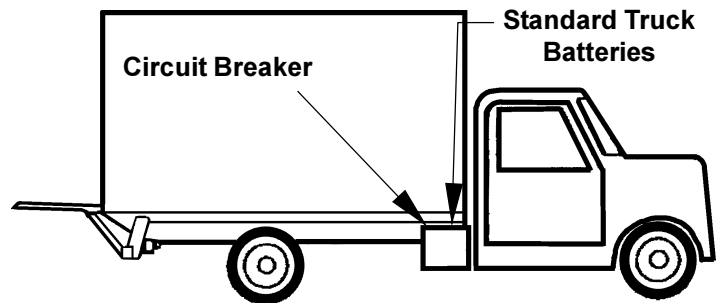

**FIGURE 1**

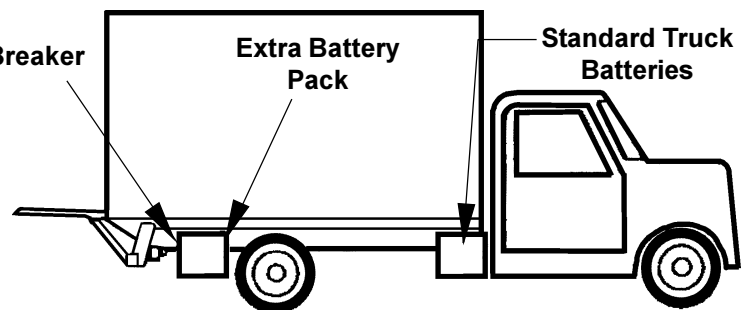

**FIGURE 2**

### TRAILER MOUNT

Install Circuit Breaker no more than 24" from (+) battery post and between batteries and lift gate solenoid (See Fig. 3).

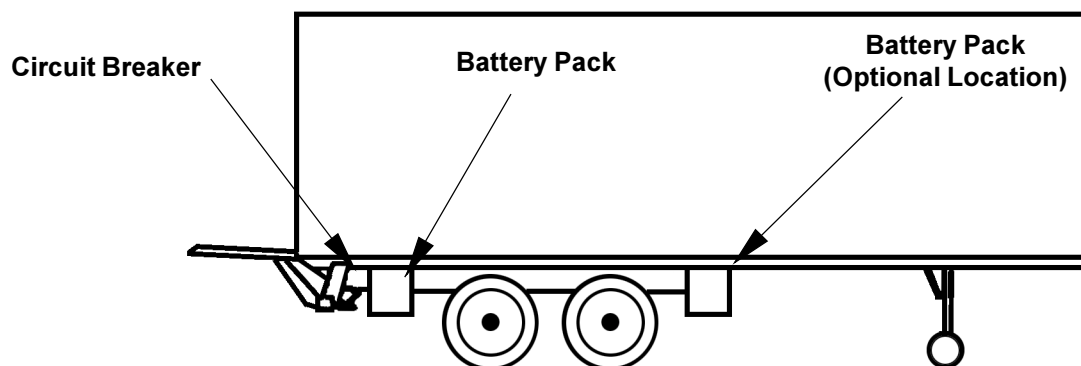

**FIGURE 3**

Male Trailer Connector:  
**P/N 050115**  
Female Trailer Connector:  
**P/N 050116**

## LIQUID SEALANT APPLICATION

1. Clean all threads with a soft brush and a suitable cleaning solvent.
2. Dry threads thoroughly with compressed air or shop towel.
3. Apply the Liquid Sealant (Compound PLS 2), to the external threads of the Male Connector.
4. Assemble the fitting and torque it to the prescribed value.
5. Check for leakage. If leakage exists, remove the fitting and return to Step # 1.
6. If fitting is loosened or removed, return to Step # 1.

