

## INSTRUCTION, REPLACING INNER & OUTER COUPLINGS KIT P/N 260489

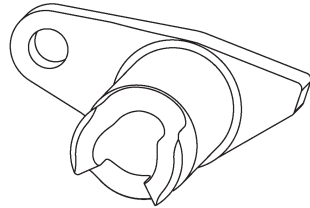

**OUTSIDE COUPLING**  
**P/N 285133-02**  
**QTY. 1**

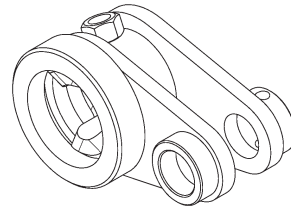

**INSIDE COUPLING**  
**P/N 253589**  
**QTY. 1**

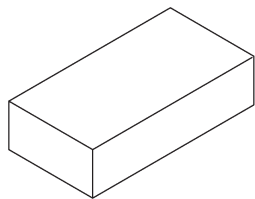

**FLAT, 1/2" X 1" X 2" LG.**  
**P/N 090242-11**  
**QTY. 1**

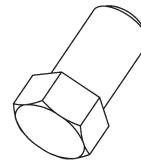

**BOLT, 3/4"-10 X 1-1/8" LG.**  
**P/N 260181-01**  
**QTY. 1**

**NOTE:** Refer to **Operation Manual** for instructions to operate Liftgate.

1. Use control box to lower the platform **(DOWN)** to approximately 12" above the ground. Support platform with 2 jack stands (**FIG. 2-1**). Make sure ramp edge is 4" higher than inboard edge of platform.

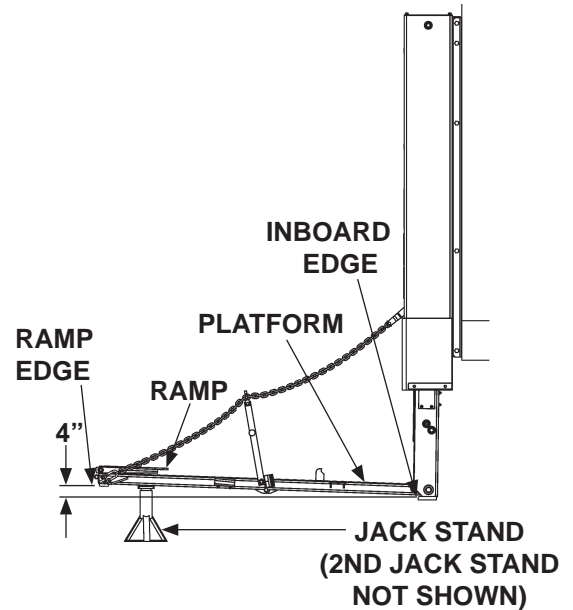

**FIG. 2-1**

2. Unbolt pin collar from RH runner to remove chain arm (**FIG. 2-2**). Then, unbolt and remove cover from runner. Repeat for LH chain arm and LH runner.

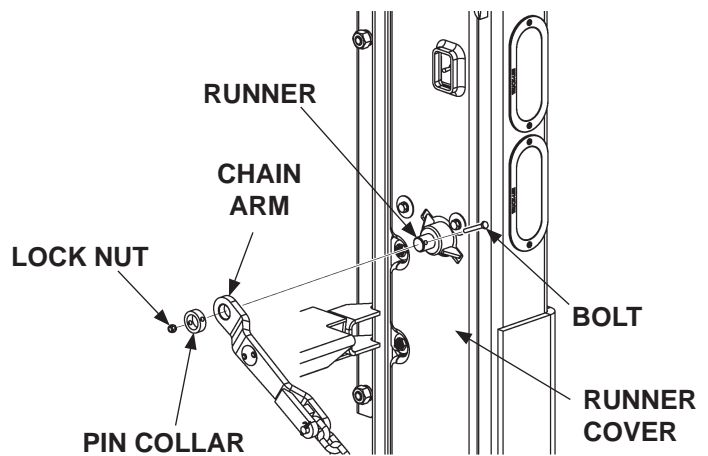

**FIG. 2-2**

3. Raise the platform (**UP**) slightly and place 2 more jack stands near the inboard edge (**FIG. 3-1**).

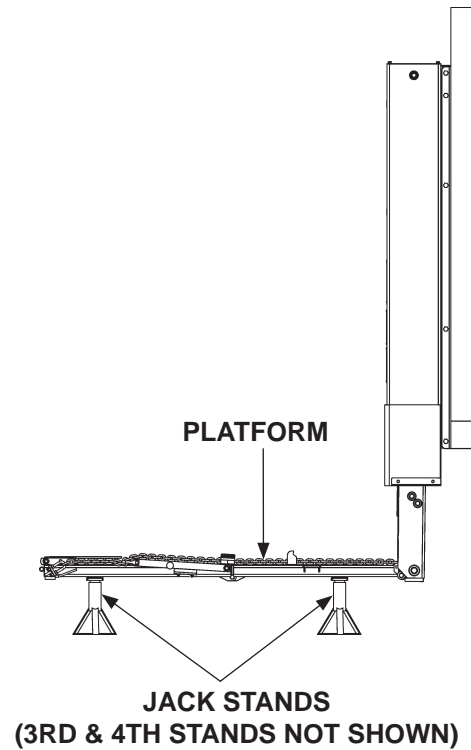

**FIG. 3-1**

4. Unbolt pin from platform connector bar and inner coupling at the RH runner (**FIG. 3-2**). Then, remove pin.

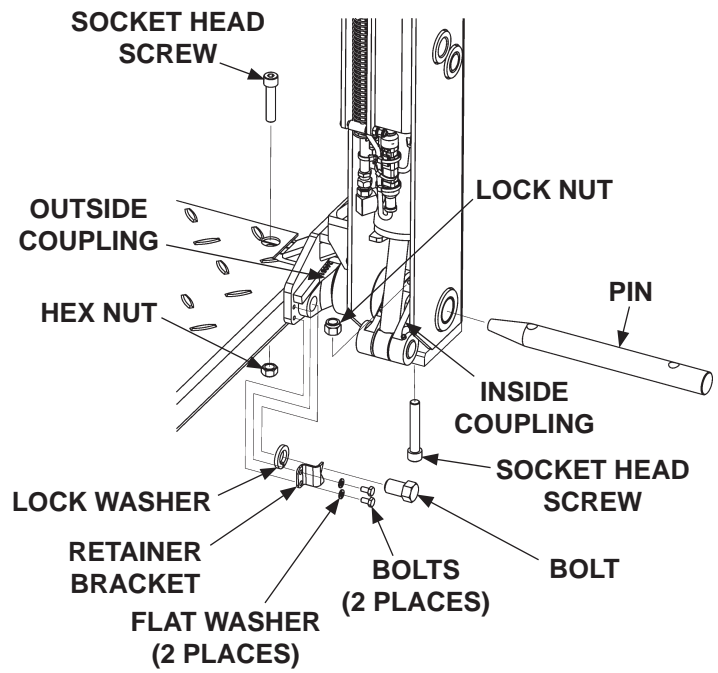

**FIG. 3-2**

5. Unbolt outside coupling from platform connector bar on RH side of platform (**FIG. 3-2**). Discard bolt.

6. Unbolt pin from platform connector bar, LH coupling, and pin collar on the LH runner (**FIG. 4-1**). Then, remove pin.

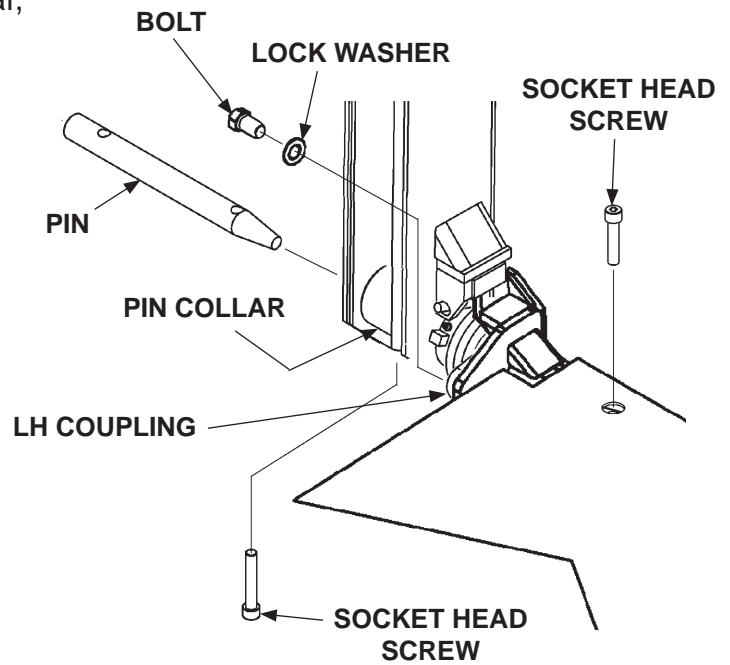

**FIG. 4-1**

7. Unbolt LH coupling from platform connector bar on LH side of platform (**FIG. 4-1**). Save bolt to reinstall.

8. Use a forklift or equivalent lifting device to move the platform approximately 6" towards the front of the vehicle to clear the platform away from the attaching points on the runners (**FIG. 5-1**). When platform is clear of the runners, raise the runners (**UP**) a few inches. Then, lower platform down on the supports.

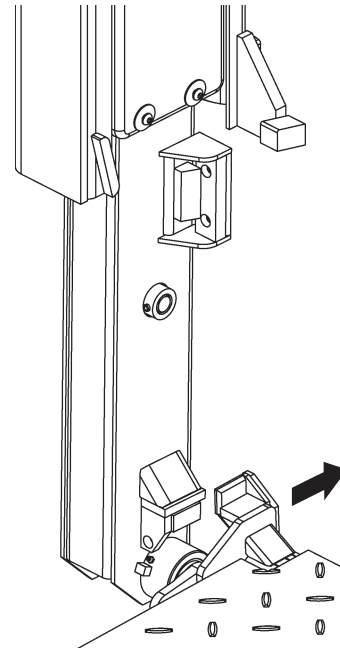

**MOVING PLATFORM  
CLEAR OF RUNNERS  
FIG. 5-1**

9. Remove inner and outer couplings, bushing, and torsion spring (if equipped) from RH runner as shown in **FIG. 5-2**. If equipped, save torsion spring to reinstall with new couplings. Discard bushing.

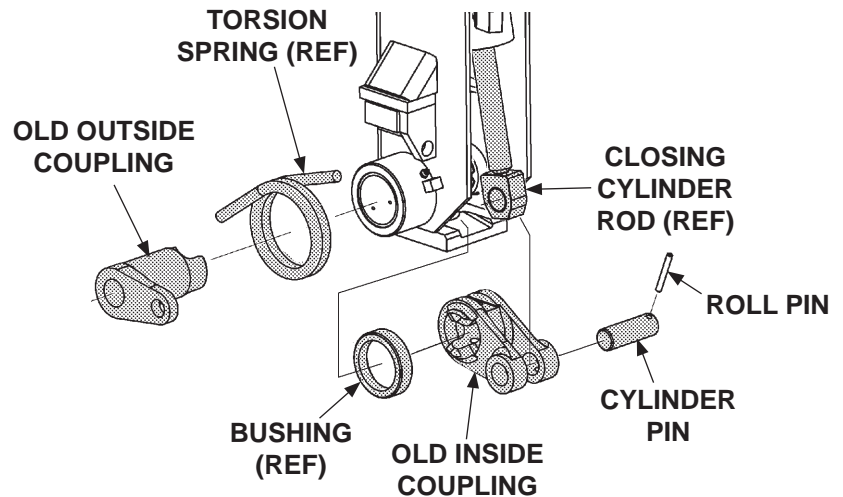

**REMOVING OUTSIDE &  
INSIDE COUPLINGS  
FIG. 5-2**

**NOTE:** Connector bar bracket on RH side of platform must be cut at the bottom to create enough clearance for the new outer coupling. (See FIG. 6-1.)

10. Measure and mark platform connector bracket on RH side of platform as shown in FIG. 6-1. Then, cut away bottom of bracket (FIG. 6-2).

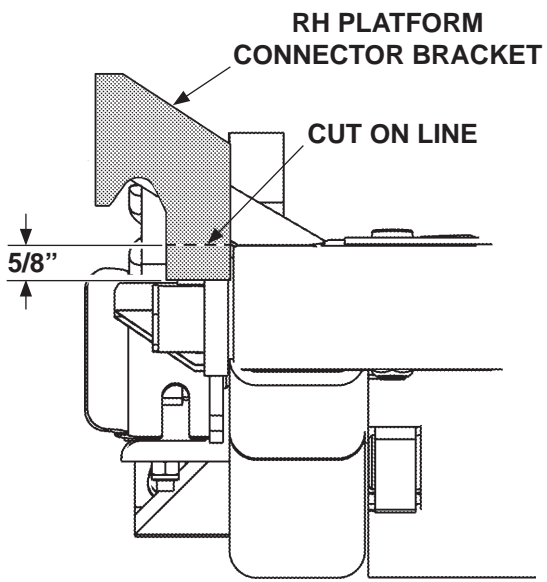

**MARKING RH PLATFORM  
CONNECTOR BRACKET  
FIG. 6-1**

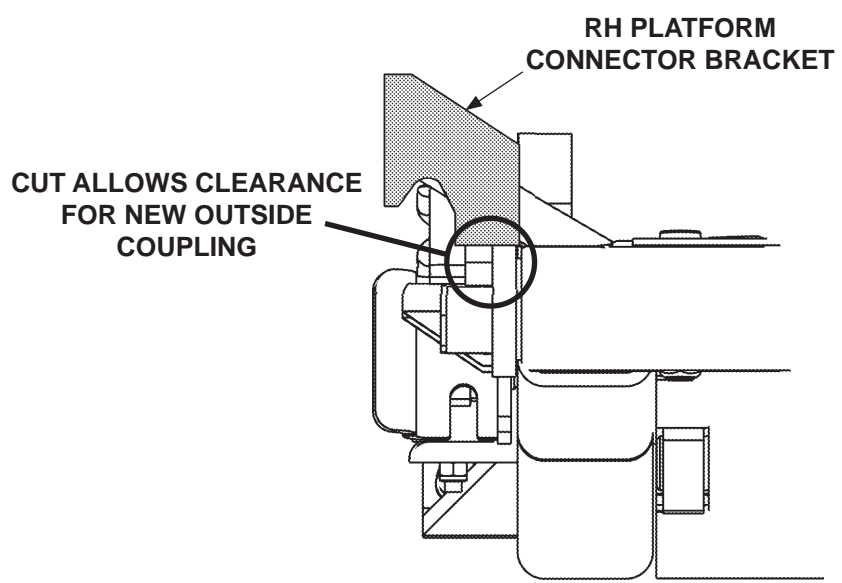

**RH PLATFORM CONNECTOR  
BRACKET AFTER CUT  
FIG. 6-2**

11. Position new outer coupling (Kit item) with pin, on RH side platform connector (FIG. 7-1). Then, bolt coupling to platform connector.

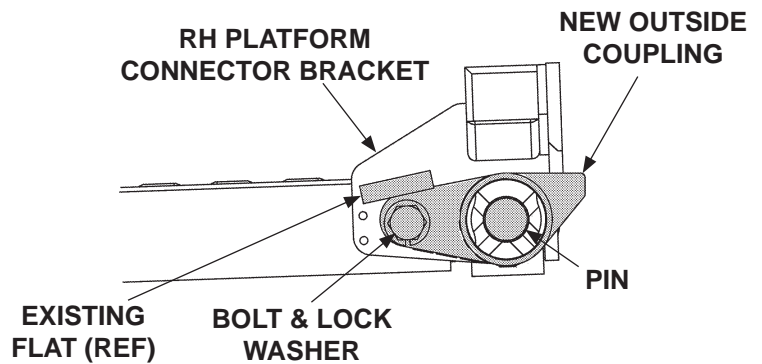

**POSITIONING OUTSIDE COUPLING ON RH PLATFORM CONNECTOR BRACKET (SIDE VIEW)**

**FIG. 7-1**

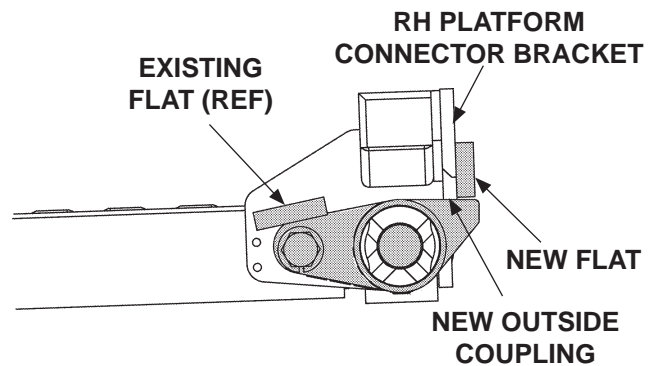

**POSITIONING FLAT ON RH PLATFORM CONNECTOR BRACKET (SIDE VIEW)**

**FIG. 7-2**

12. Position flat (Kit item) on platform connector bracket (FIGS. 7-2 and 7-3). Then tack weld in position.

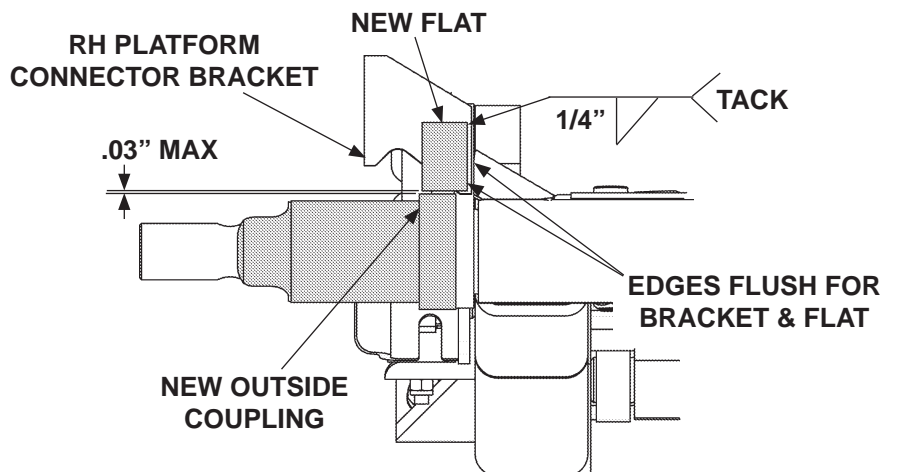

**POSITIONING FLAT ON RH PLATFORM CONNECTOR BRACKET (REAR VIEW)**

**FIG. 7-3**

13. Unbolt new outside coupling from RH platform connector bracket. Then, remove coupling and pin.

14. Weld new flat to RH platform connector bracket as shown in FIG. 8-1.

15. After welds cool, clean and touchup paint the welded surfaces on new flat and platform connector bracket.

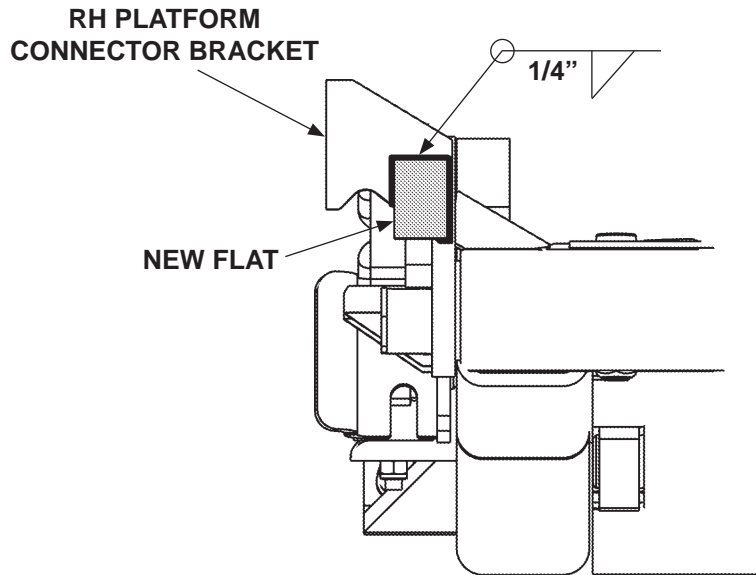

**WELDING FLAT TO RH PLATFORM CONNECTOR BRACKET (REAR VIEW)  
FIG. 8-1**

**NOTE:** Spacer bushing and hex nut are part of the new inside coupling.

16. Install new inner and outer couplings (Kit items) and torsion spring (if equipped) on RH runner as shown in FIG. 8-2.

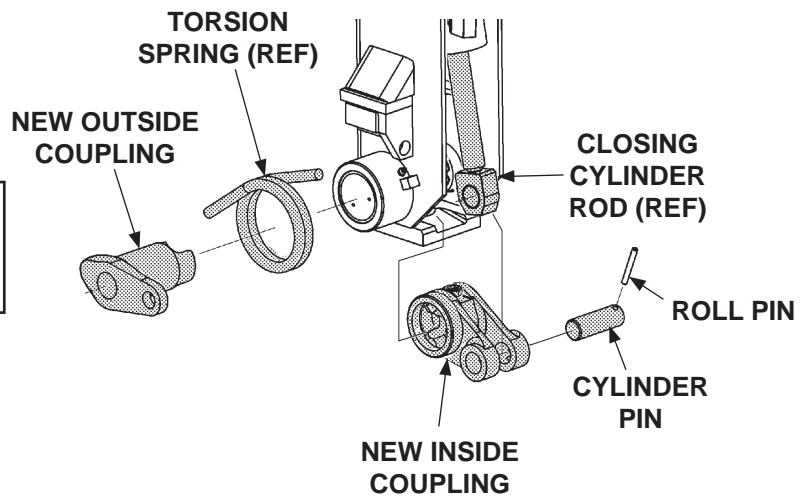

**INSTALLING NEW OUTSIDE & INSIDE COUPLINGS  
FIG. 8-2**



17. Use a forklift or equivalent lifting device to lift platform and line it up with attaching points on the LH runner (FIG. 9-1) and RH runner.

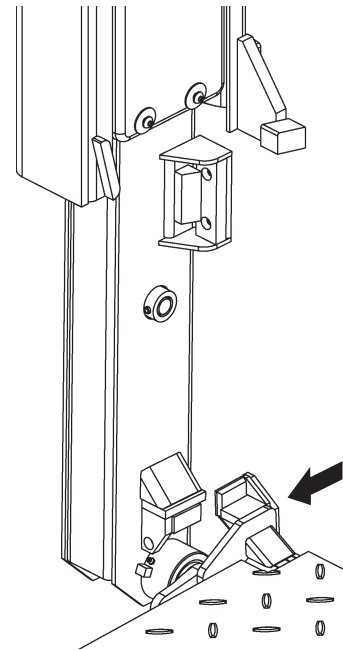

**FIG. 9-1**

18. Insert pin through runner, inside and outside couplings, and platform connector at the RH runner. Then, bolt pin to inside coupling and platform (FIG. 9-2).

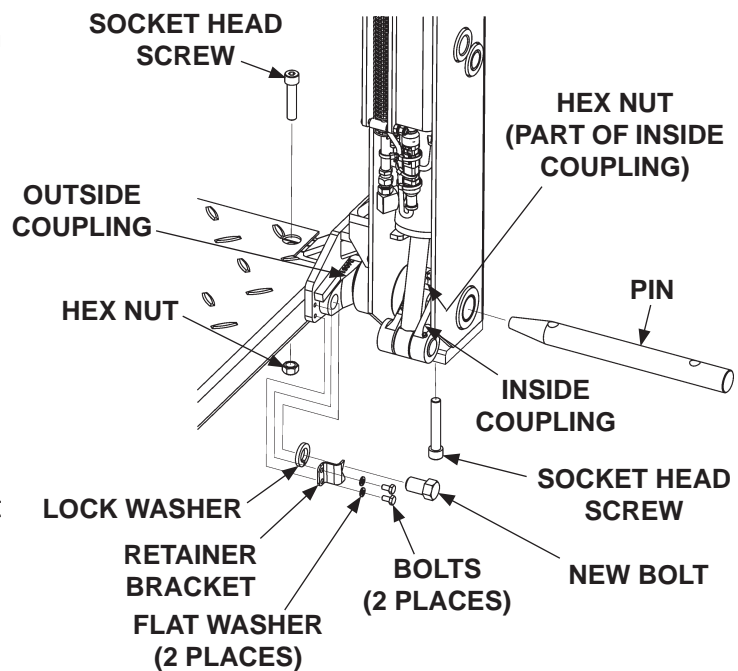

**FIG. 9-2**

19. Bolt outside coupling to platform connector bracket with new bolt (Kit item) (FIG. 9-2). Then, bolt retainer bracket to connector bracket.

20. Bolt LH coupling to LH platform connector bracket (FIG. 10-1).

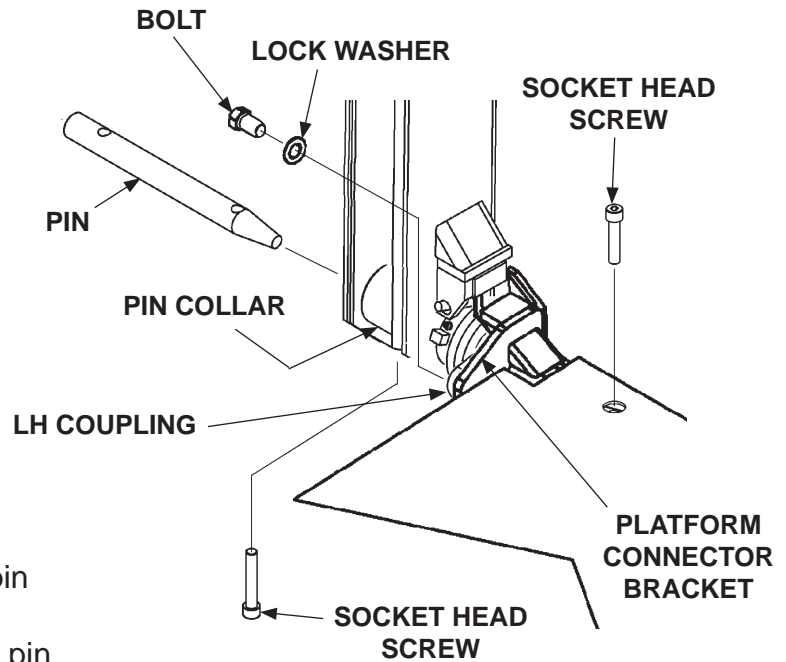

FIG. 10-1

21. Insert pin through LH coupling, pin collar and platform at LH runner (FIG. 10-1). Then, bolt pin to LH pin collar and platform (FIG. 10-1).

22. Use control box to raise the platform (UP) slightly and remove 2 jack stands near the inboard edge (FIG. 10-2).

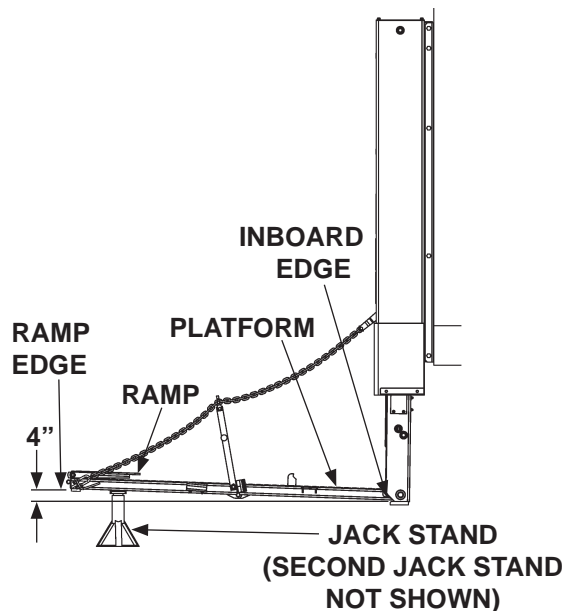

FIG. 10-2

23. Use control box to lower (DOWN) platform on jack stands (FIG. 10-2) so inboard edge is 4" below ramp edge.

24. Reattach chain arm to RH runner. Then, bolt on the pin collar to secure chain arm (FIG. 11-1). Repeat for LH runner.

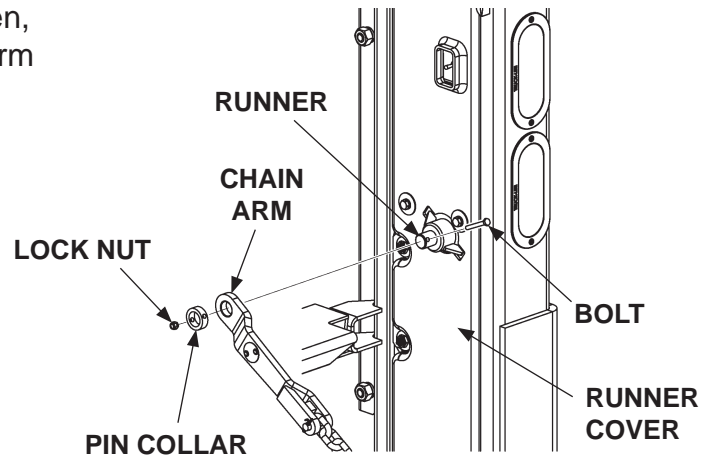

FIG. 11-1