

INSTRUCTION, GPT HAND PUMP KIT INSTALLATION

GPT KIT P/N 283330-01

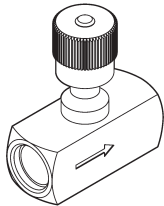

**NEEDLE VALVE,
ADJUSTABLE, SAE #6
P/N 906739-01
QTY. 1**



**CONNECTOR, SAE #6 FACE SEAL,
SAE #4 O-RING
P/N 906759-01
QTY. 2**

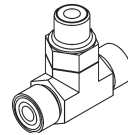

**TEE, SAE #6 FACE
SEAL O-RING
P/N 906745-01
QTY. 1**



**FITTING, STRAIGHT
O-RING, SAE#6
P/N 906751-01
QTY. 1**

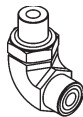

**ELBOW, SAE#6,
MALE FACE
SEAL, O-RING
P/N 906707-01
QTY. 1**

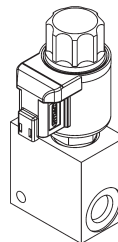

**LOCK VALVE ASSEMBLY,
WITH OVERRIDE, 12V
P/N 282999-03
QTY. 1**

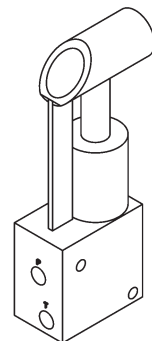

**HAND PUMP,
SAE#4 PORTS
P/N 266588-01
QTY. 1**



**POP RIVET, 3/16 X .565 LG.
P/N 904002-2
QTY. 2**

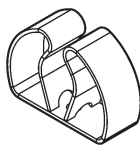

**SPRING CLIP HOLDER
P/N 227681
QTY. 2**

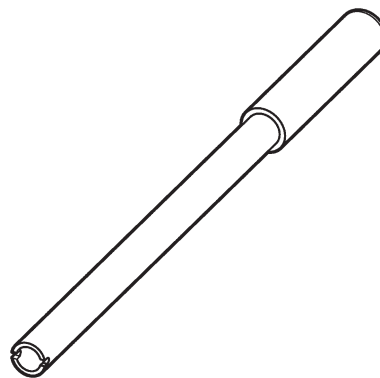

**HANDLE, HAND PUMP
P/N 251407-02
QTY. 1**

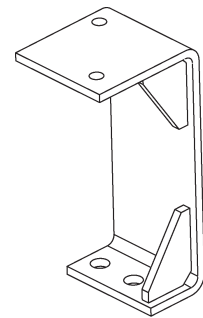

**BRACKET,
HAND PUMP (GPTB)
P/N 288930-01G
QTY. 1**

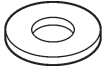

FLAT WASHER, 3/8"
P/N 902013-11
QTY. 2



FLAT WASHER, 1/4"
P/N 902000-2
QTY. 2



LOCK NUT, 1/4"-20
P/N 901000
QTY. 2



LOCK NUT, 3/8"-16
P/N 901002
QTY. 2

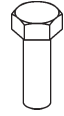

**HEX CAP SCREW,
3/8"-16 X 1" LG, GR8**
P/N 900014-4
QTY. 2



**SOCKET SCREW,
1/4"-20 X 2" LG, GR8**
P/N 900025-8
QTY. 2

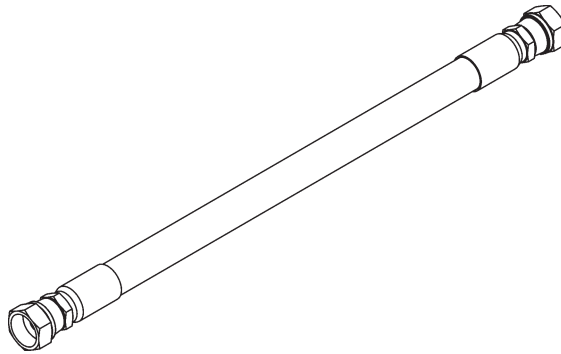

HOSE ASSEMBLY, STRAIGHT 3/8" I.D. X 18" LG.
P/N 282467-01
QTY. 1

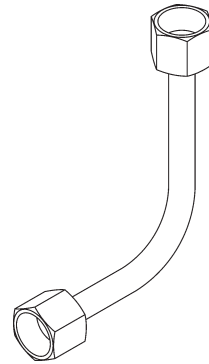

**TUBE ASSY,
(90 DEG, 3/8" O.D., #8 FACE SEAL)**
P/N 282469-01
QTY. 1

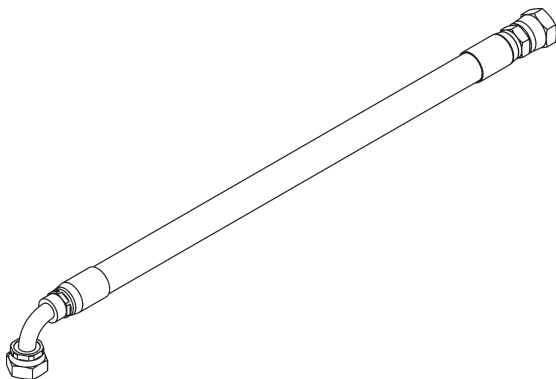

HOSE ASSY (WITH 90° ELBOW), 3/8" I.D. X 20" LG.
P/N 282468-01
QTY. 1

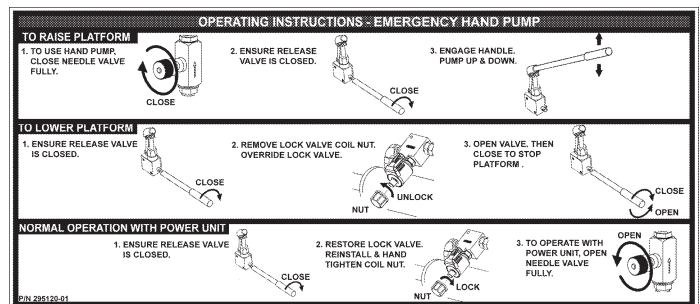

HAND PUMP DECAL
P/N 295120-01
QTY. 1

1. Lower the platform to a comfortable work height (**FIG. 3-1**). Then, use jack under the lift frame to support the Lift-gate (**FIG. 3-1**). Refer to **GPT Operation Manual** for detailed operating instructions.

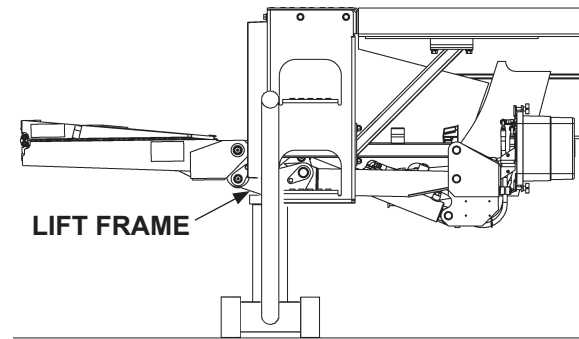

SUPPORTING LIFT FRAME WITH JACK

FIG. 3-1

⚠ WARNING

To prevent personal injury and equipment damage, make sure power is disconnected from Liftgate while installing hydraulic electrical parts.

2. Disconnect power from Liftgate by disconnecting negative (-) battery cable from negative (-) battery terminal (**FIG. 3-2**).

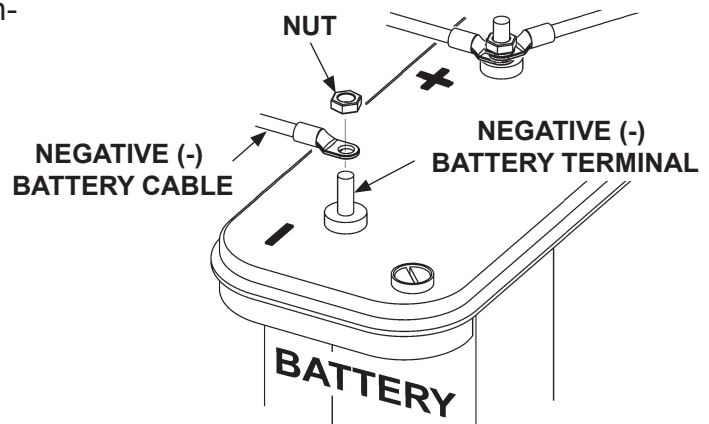

DISCONNECTING POWER

FIG. 3-2

3. Unfasten and remove pump cover
(FIG. 4-1).

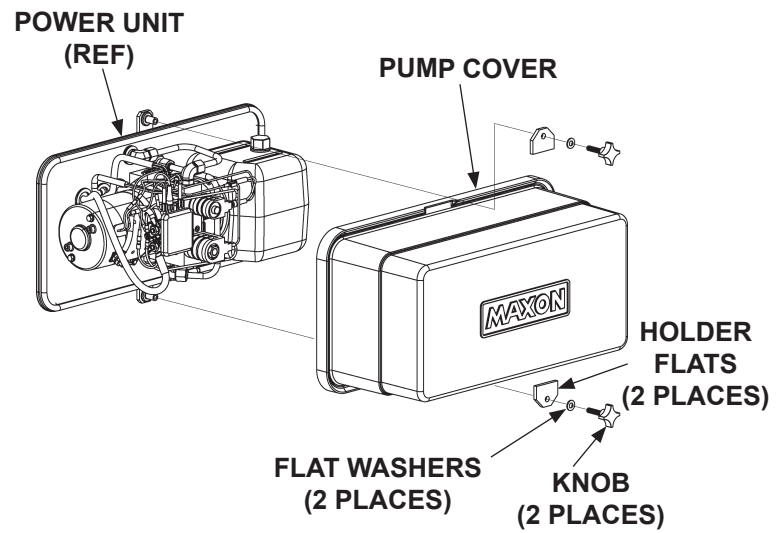

REMOVING PUMP COVER
FIG. 4-1

4. Measure, mark, and drill holes in mounting plate for the mounting bracket (**FIG. 5-1**).

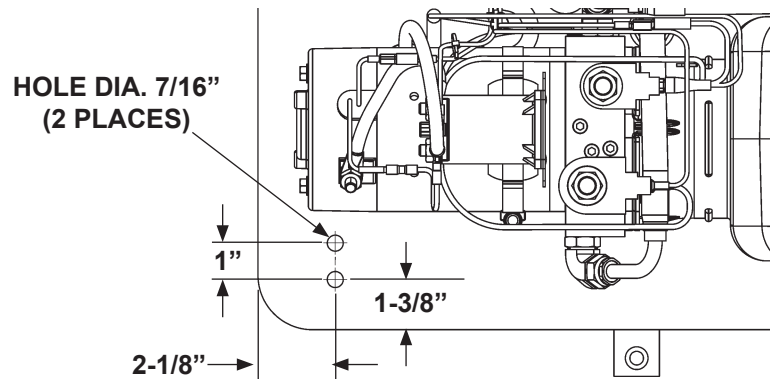

HOLE PATTERNS FOR MOUNTING BRACKET
FIG. 5-1

5. Measure, mark, and drill 2 holes for spring clips (**FIG. 5-2**).

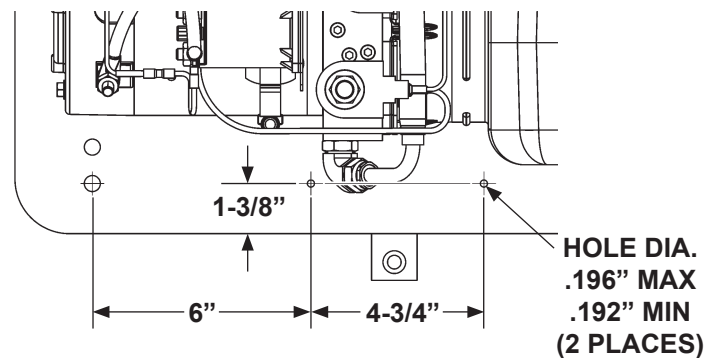

HOLE PATTERNS FOR SPRING CLIPS
FIG. 5-2

6. Bolt mounting bracket (Kit item)
to mounting plate as shown in
FIG. 6-1.

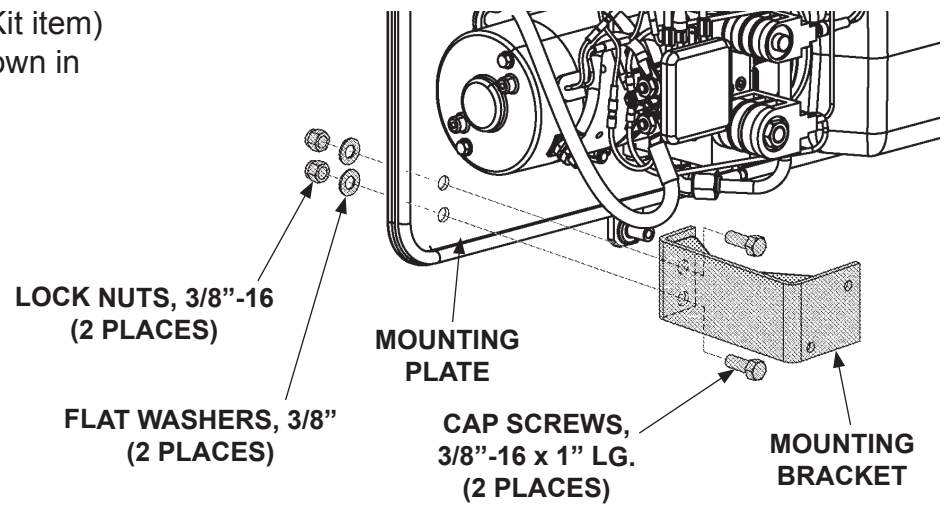

BOLTING ON MOUNTING BRACKET
FIG. 6-1

7. Rivet the 2 spring clips to mounting plate (**FIG. 7-1**).

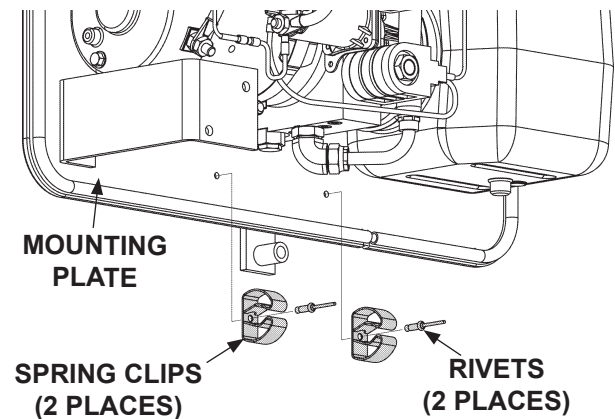

**RIVETING SPRING CLIPS
FIG. 7-1**

8. Place handle (Kit item) in the spring clips as shown in **FIG. 7-2**.

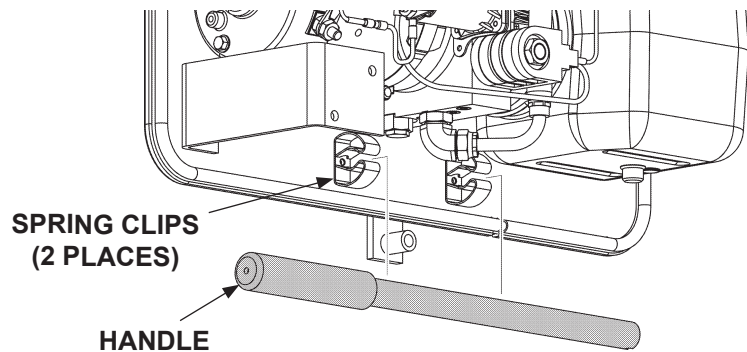

**STOWING HANDLE IN SPRING CLIPS
FIG. 7-2**

9. Bolt hand pump (Kit item) to mounting bracket (**FIG. 8-1**).

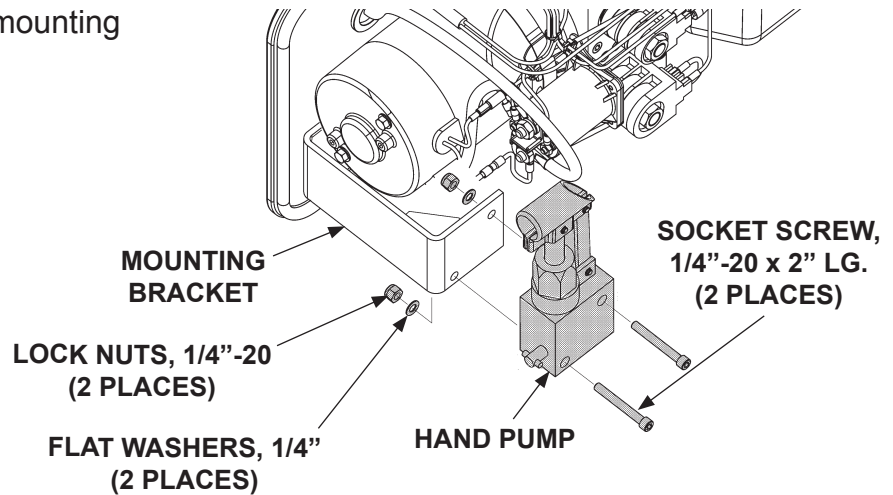

BOLTING ON HAND PUMP
FIG. 8-1

CAUTION

Torque the connectors to 13-15 lb-ft.
Do not overtighten.

10. Fasten 2 face seal connectors (Kit items, P/N 906759-01) to hand pump (**FIG. 8-2**).

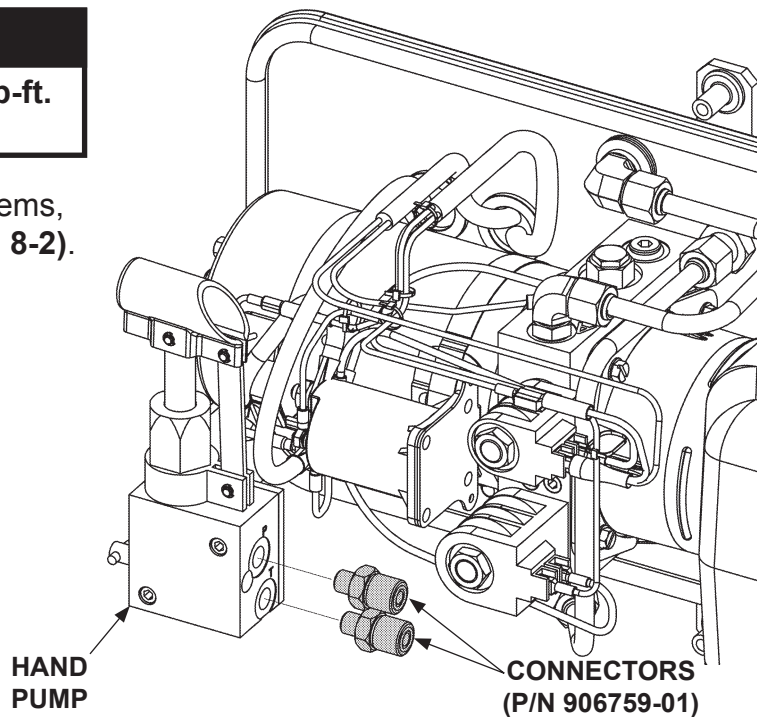

FASTENING FACE SEAL CONNECTORS
FIG. 8-2

CAUTION

Keep dirt, water and other contaminants from entering the hydraulic system. Before opening the hydraulic fluid reservoir filler cap, drain plug and hydraulic lines, clean up contaminants that can get in the openings. Also, protect the openings from accidental contamination.

11. Remove and discard high pressure line from pump assembly (**FIG. 9-1**).

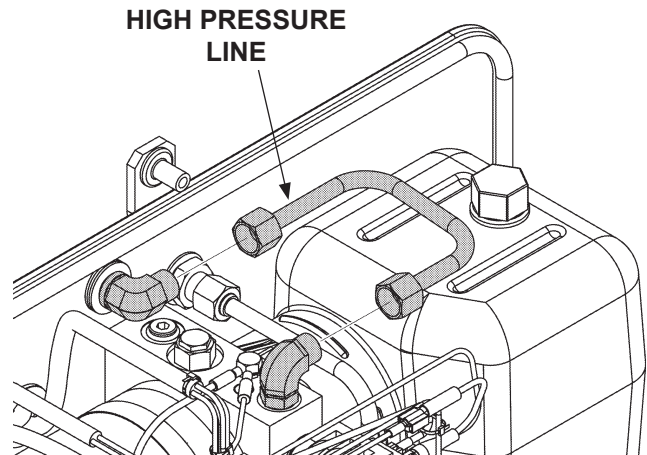

REMOVING HIGH PRESSURE LINE
FIG. 9-1

12. Loosen the elbows on pump port 'A' and mounting plate (**FIG. 10-1A**). Next, rotate elbow 180° on pump port 'A' (**FIG 10-1C**). Then, rotate mounting plate elbow 180° as shown in **FIG. 10-1B**.

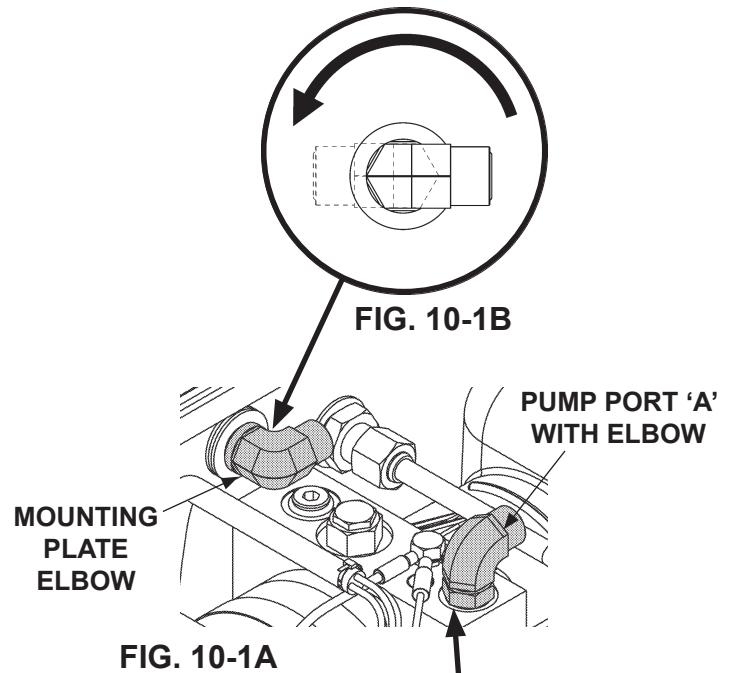

13. Connect straight fitting (Kit item) to elbow on pump port 'A' (**FIG. 10-2**). Then, connect needle valve to straight fitting as shown in **FIG. 10-2**.

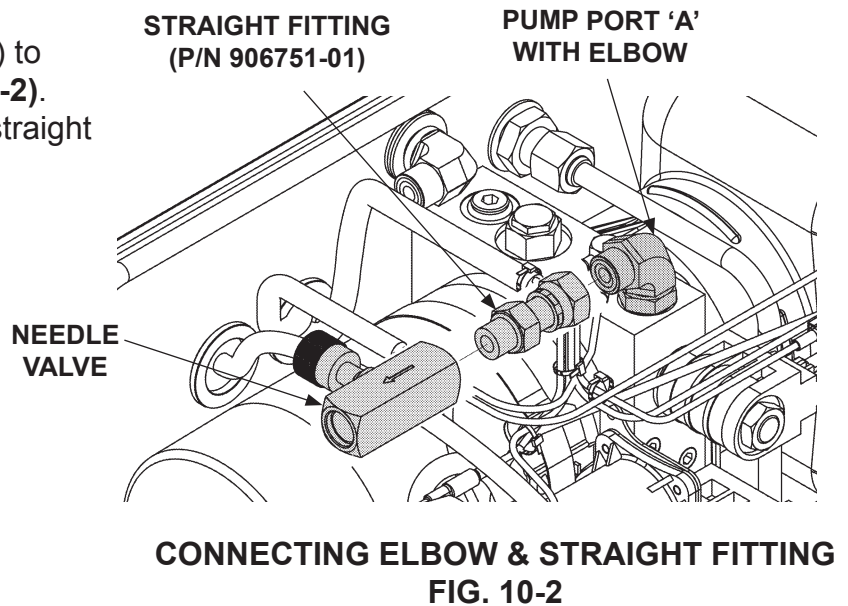

14. Connect tee (Kit item) to needle valve (FIG. 11-1).

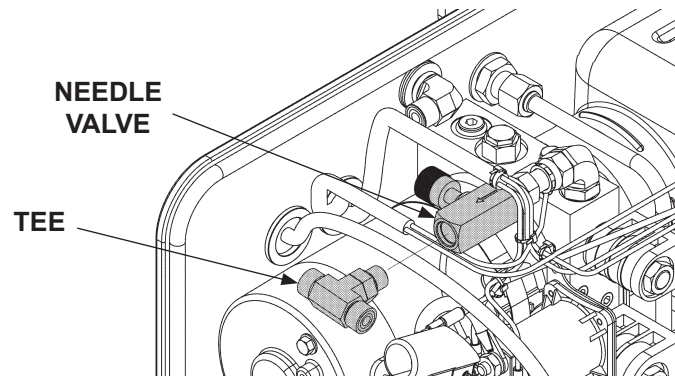

CONNECTING TEE
FIG. 11-1

15. Connect tube assembly (Kit item) to tee and elbow on mounting plate (FIG. 11-2). Do not tighten connectors until later in this procedure.

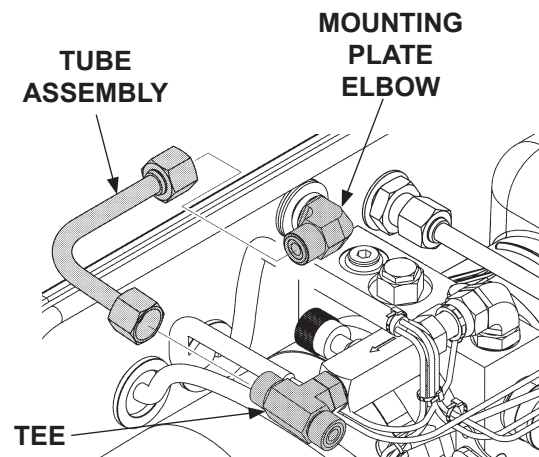

CONNECTING TUBE ASSEMBLY
FIG. 11-2

16. Connect hose (Kit item, P/N 282468-01) to tee and fitting on hand pump (**FIG. 12-1**). Do not tighten connectors until later in this procedure.

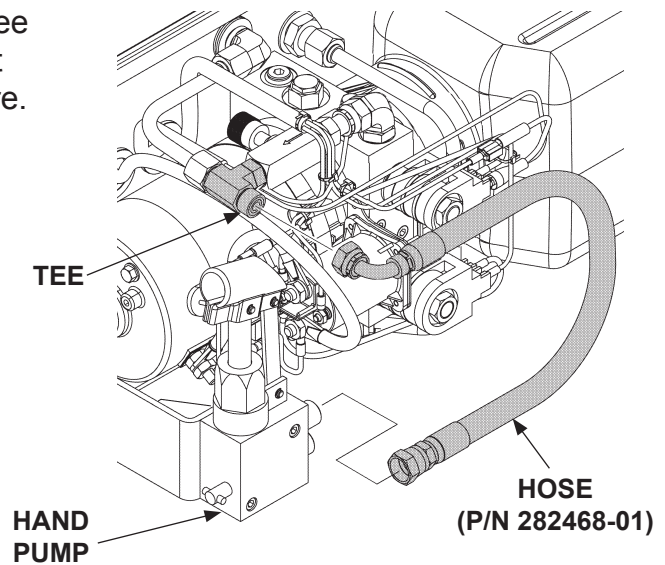

**CONNECTING HOSE
FIG. 12-1**

17. Remove plug from hand pump port on pump block (**FIG. 12-2**).

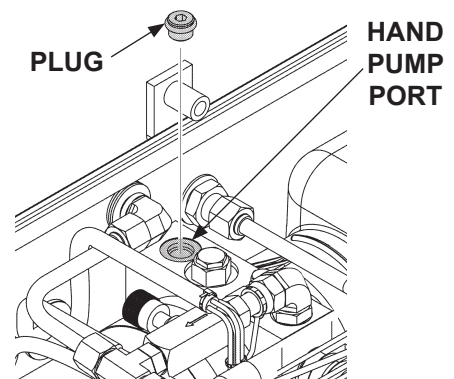

**REMOVING PLUG FROM
HAND PUMP PORT
FIG. 12-2**

18. Connect elbow (Kit item) to hand pump port (FIG. 13-1). Position elbow as shown.

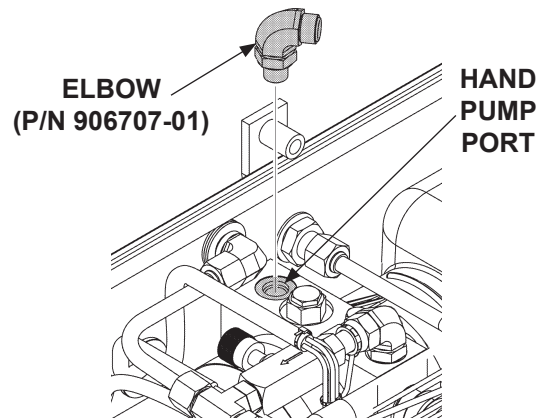

CONNECTING ELBOW
FIG. 13-1

19. Connect straight hose (Kit item, P/N 282467-01) to elbow on pump block and connector on hand pump (FIG. 13-2).

CAUTION

Hydraulic lines and fittings must be torqued as shown in FIG. 14-1 and TABLE 14-1.

20. Reposition elbows, hoses, and tube assembly as required (FIG. 14-1). Then, torque the fittings as shown in FIG. 14-1 and TABLE 14-1.

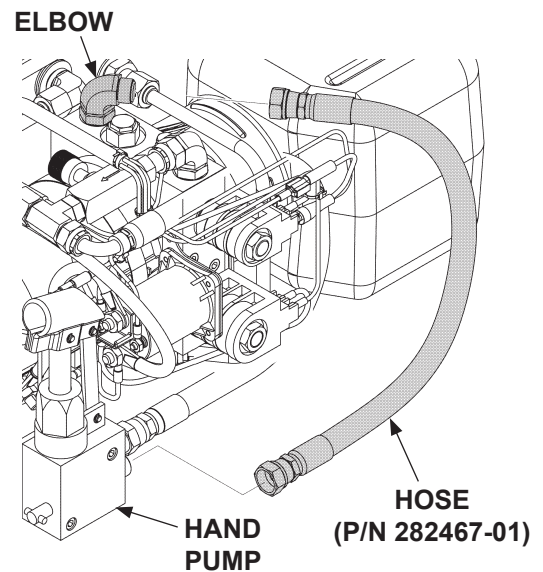

CONNECTING STRAIGHT HOSE
FIG. 13-2

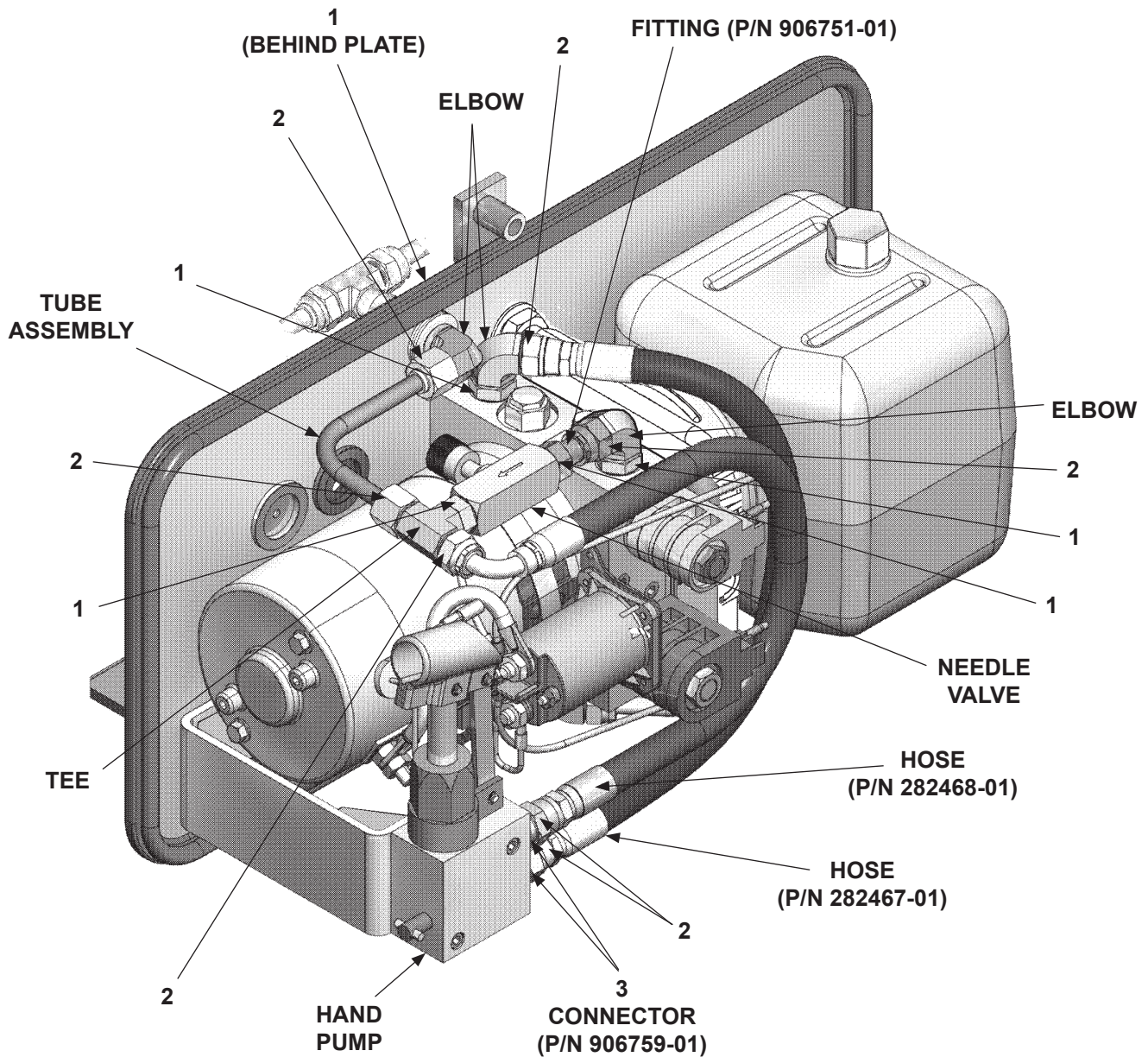

TIGHTENING FITTINGS
FIG. 14-1

ITEM	DESCRIPTION	TORQUE VALUE
1	SAE#6 O-RING (MALE)	22-24 lb-ft.
2	SAE#6 FACE SEAL (FEMALE)	25-27.5 lb-ft.
3	SAE#4 O-RING (MALE)	13-15 lb-ft.

TORQUE VALUES
TABLE 14-1

21. Remove the existing lock valve assembly from RH cylinder as shown in **FIG. 15-1**. Install lock valve assembly with override (Kit item) as shown in **FIG. 15-2**.

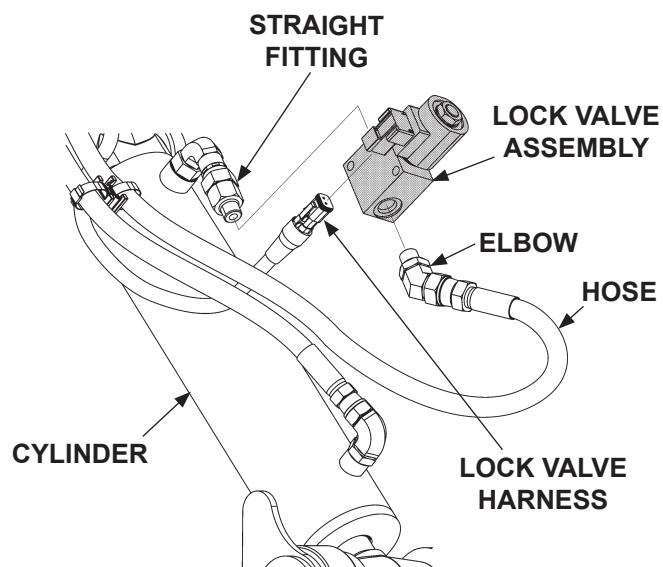

**REMOVING LOCK VALVE
FIG. 15-1**

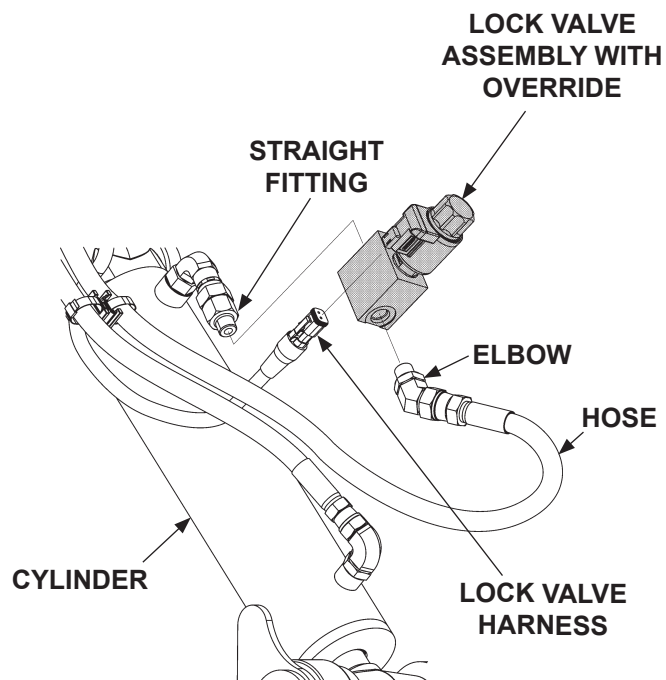

**INSTALLING LOCK VALVE
FIG. 15-2**

NOTE: Ensure pressure release valve is closed (turn clockwise) before attempting to raise platform.

22. Close needle valve by turning knob fully clockwise (**FIG. 16-1**). Then, close hand pump release valve, by turning valve clockwise with handle.

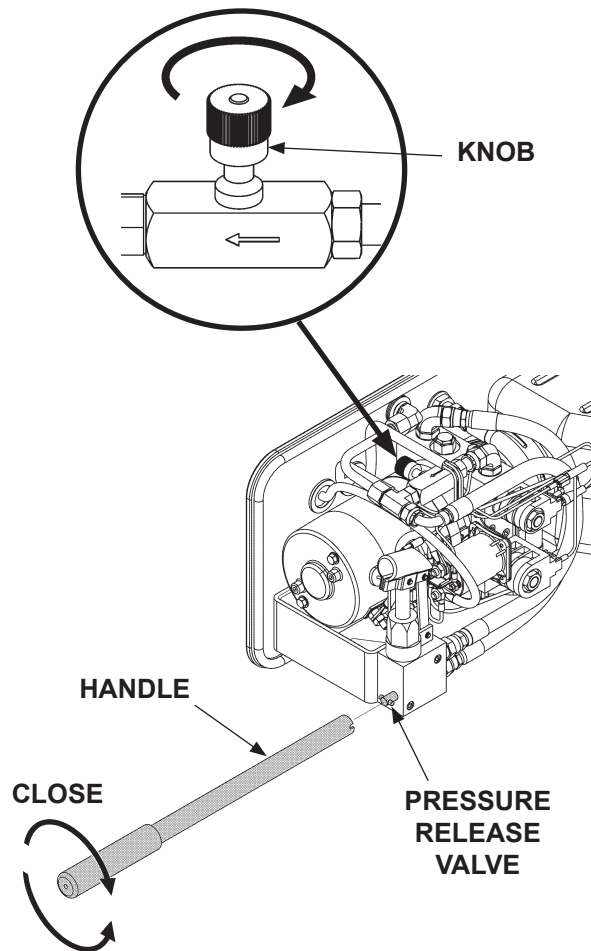

**CLOSING NEEDLE VALVE & HAND PUMP
RELEASE VALVE
FIG. 16-1**

23. Remove plastic nut from lock valve (**FIG. 17-1**). Then, ensure valve is closed to locked (reset) position by turning lock valve shaft fully clockwise (**FIG. 17-1**).

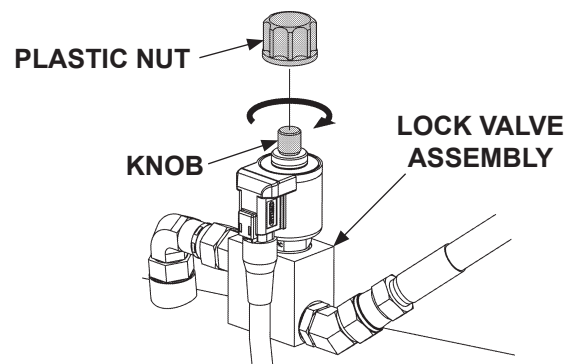

ENSURING LOCK VALVE IS CLOSED
FIG. 17-1

24. Lower and remove floor jack (**FIG. 17-2**).

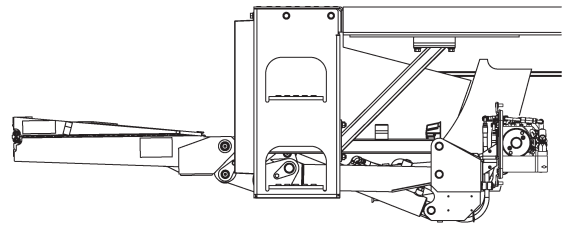

JACK REMOVED
FIG. 17-2

25. Override (open) lock valve by turning shaft fully counterclockwise (**FIG. 18-1**).

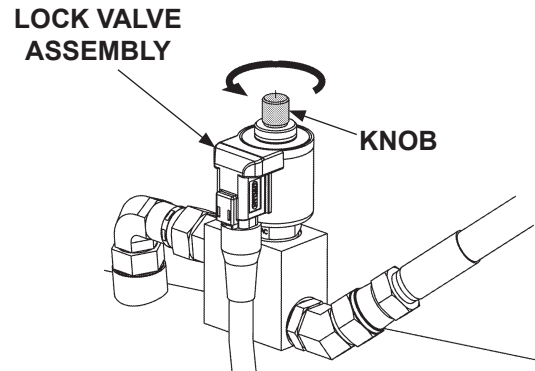

OVERRIDING LOCK VALVE
FIG. 18-1

26. Lower platform 1/2 the distance to ground (**FIG. 18-3**) by turning hand pump release valve counterclockwise with handle (**FIG. 18-2**). Turn release valve fully clockwise to stop platform from lowering (**FIG. 18-2**).

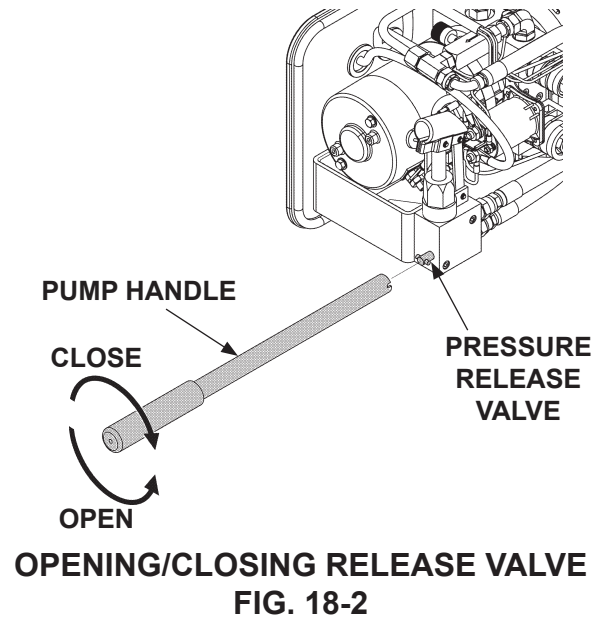

OPENING/CLOSING RELEASE VALVE
FIG. 18-2

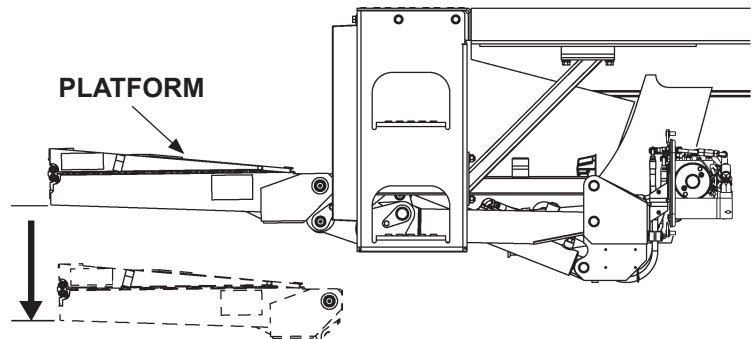

LOWERING PLATFORM WITH HAND PUMP
FIG. 18-3

27. Reset (close) lock valve by turning shaft fully clockwise, **(FIG. 19-1)** so that it locks. Reinstall plastic nut on lock valve.

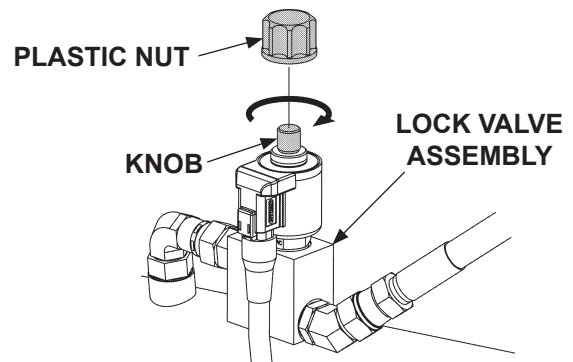

RESETTING LOCK VALVE
FIG. 19-1

28. Reconnect the negative (-) battery cable to the negative (-) battery terminal **(FIG. 19-2)**. Tighten nut.

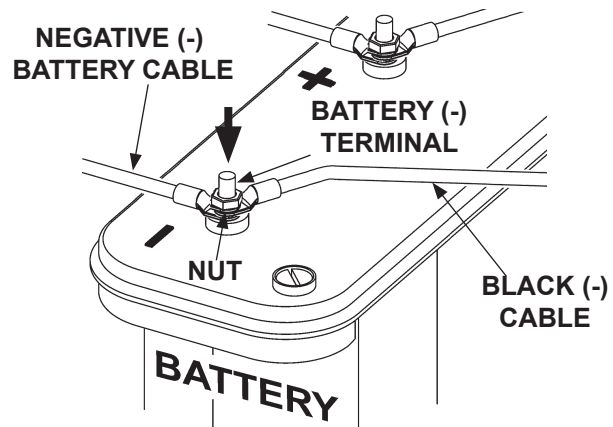

RECONNECTING POWER
FIG. 19-2

CAUTION

The hand pump is only intended for stowing the platform if the power unit does not work. Do not use for repeated loading and unloading of vehicle.

29. Open the needle valve by turning knob fully counterclockwise **(FIG. 19-3)**.

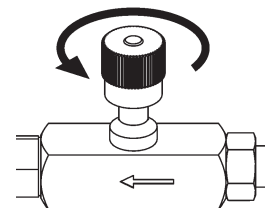

OPENING NEEDLE VALVE
FIG. 19-3

30. Use the control switch to **LOWER** platform to the ground (**FIG. 20-1**).

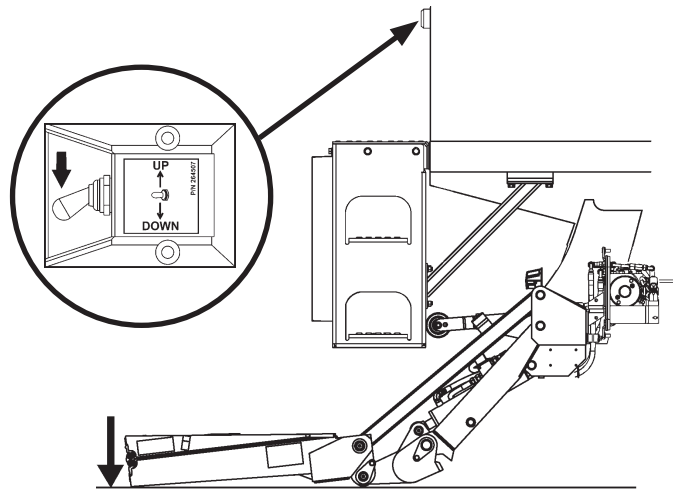

**LOWERING PLATFORM TO GROUND
WITH CONTROL SWITCH
FIG. 20-1**

31. Unfold platform and flipover (**FIG. 20-2**).

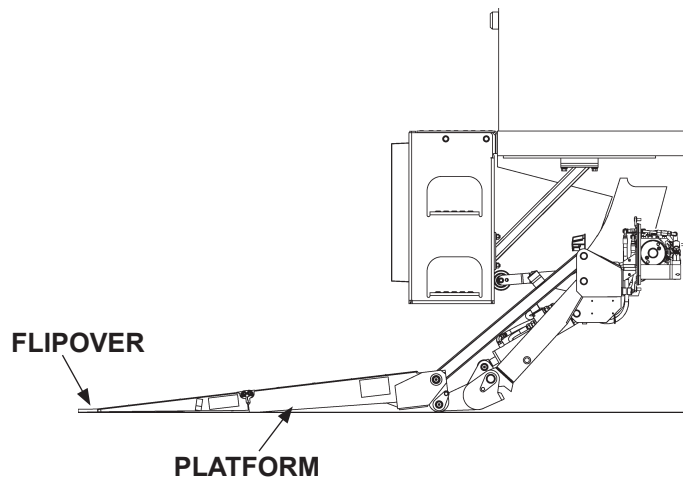

**UNFOLDING PLATFORM & FLIPOVER
FIG. 20-2**

32. Use the control switch to **RAISE** platform to bed height (**FIG. 21-1**).

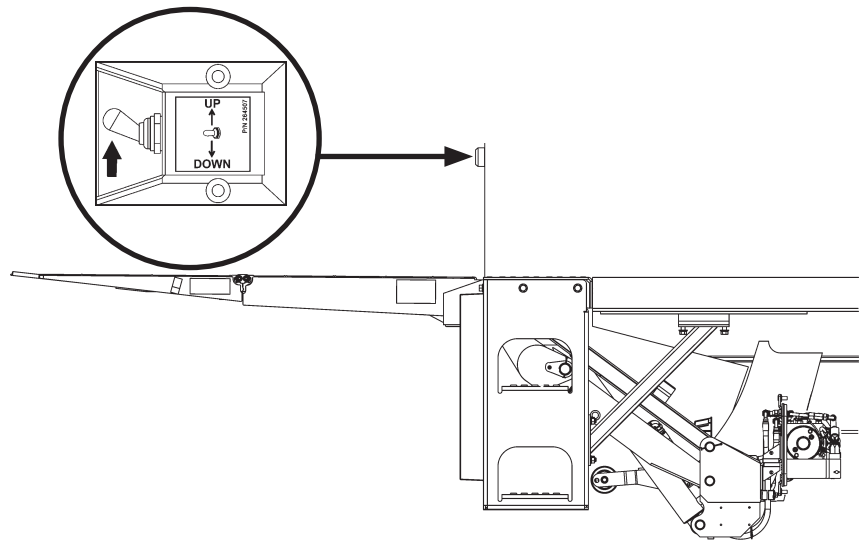

**RAISING PLATFORM TO BED HEIGHT
WITH CONTROL SWITCH
FIG. 21-1**

33. Repeat step 30 and step 32 until all air has been bled from the system.
34. Refer to the **GPT Maintenance Manual** for instructions on checking hydraulic fluid.

35. Stow hand pump handle in the spring clips on pump mounting plate (**FIG. 22-1**).

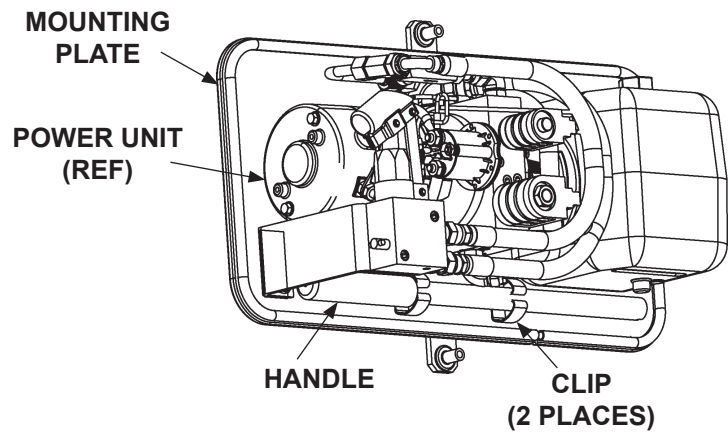

STOWING PUMP HANDLE
FIG. 22-1

36. Attach pump operation decal inside the pump cover as shown in **FIG. 22-2**.

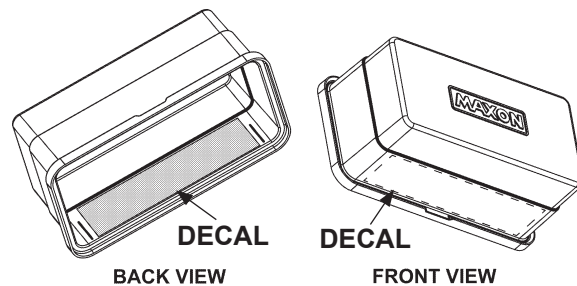

ATTACHING DECAL
FIG. 22-2

37. Reinstall and fasten pump cover
(FIG. 23-1). Hand-tighten knobs.

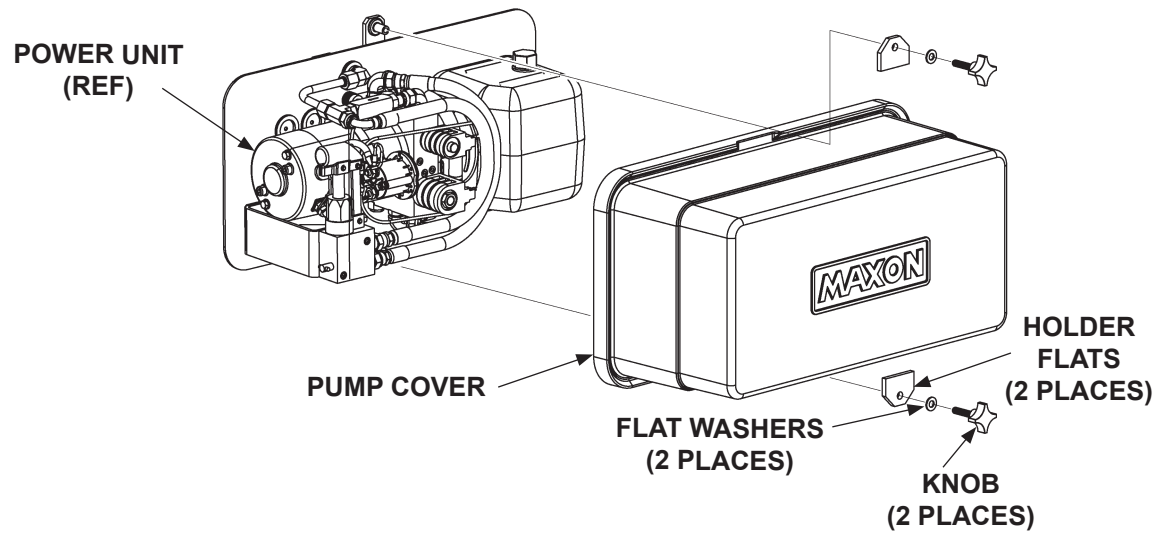

REINSTALLING PUMP COVER
FIG. 23-1

GPT HAND PUMP OPERATION INSTRUCTIONS

CAUTION

The hand pump is only intended for stowing the platform if the power unit does not work. Do not use for repeated loading and unloading of vehicle.

1. Unfasten and remove pump cover (FIG. 24-1).

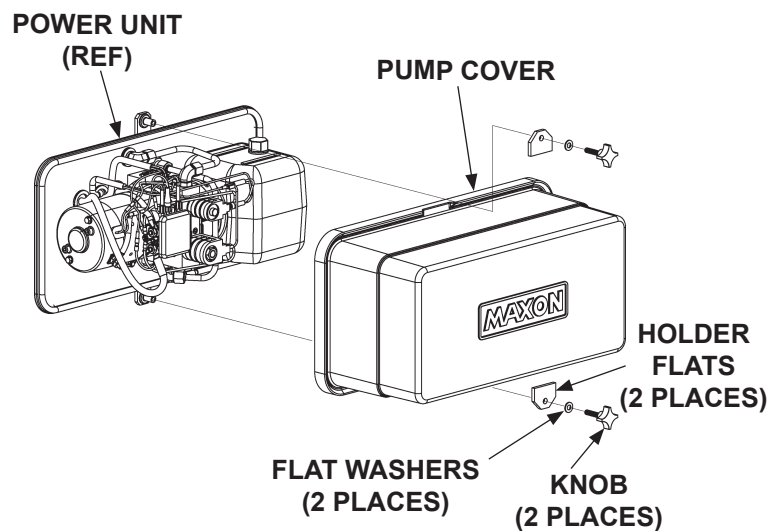

REMOVING PUMP COVER
FIG. 24-1

CAUTION

The manual override option is intended for emergency use only. Do not use for continuous operation.

2. To use hand pump for backup operation, close the needle valve by turning knob fully clockwise (**FIG. 25-1**).

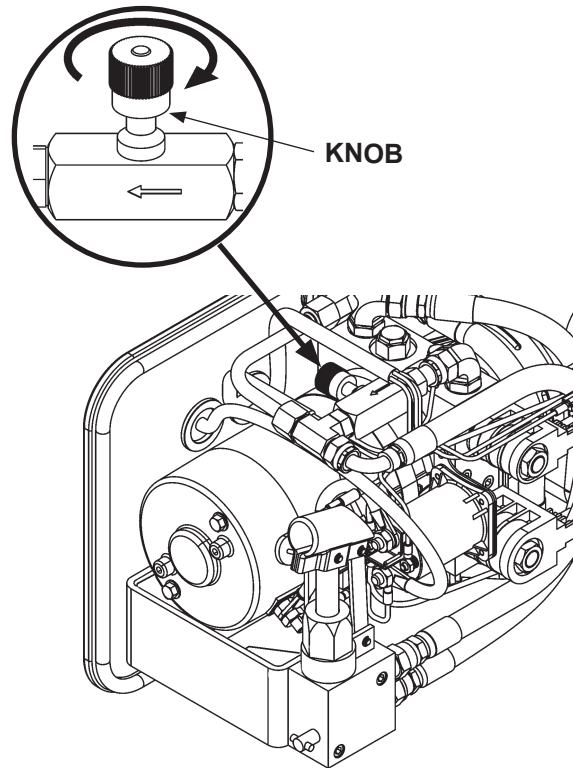

CLOSING NEEDLE VALVE
FIG. 25-1

3. Remove plastic nut on lock valve (**FIG. 25-2**). Override (open) lock valve by turning shaft fully counter-clockwise (**FIG. 25-2**).

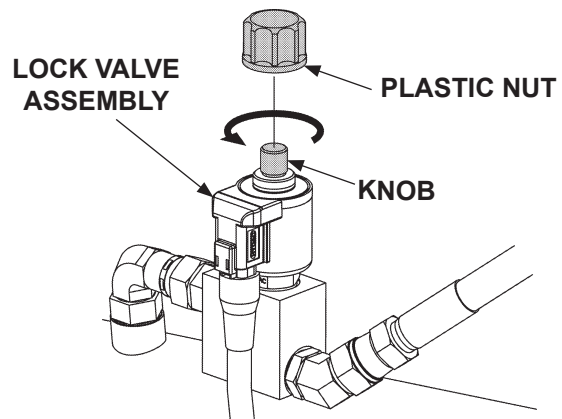

REMOVING NUT & OVERRIDING LOCK VALVE
FIG. 25-2

4. Lower the platform by opening the hand pump release valve 1/2 turn counterclockwise with the handle (**FIGS. 26-1 & 26-2**). To stop platform from lowering (**FIG. 26-2**), close the release valve (**FIG. 26-1**) by turning clockwise.

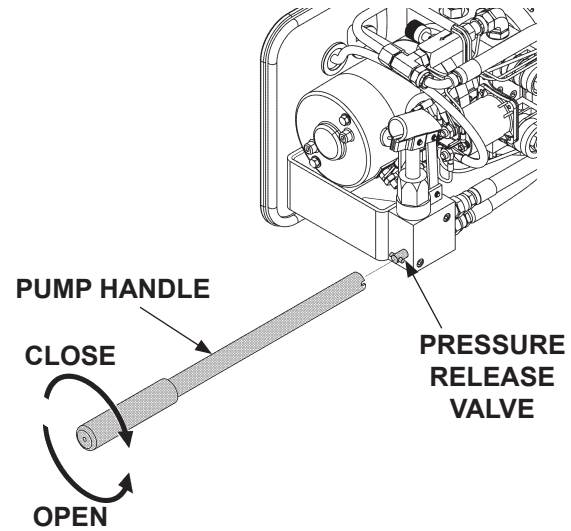

**OPENING HAND PUMP RELEASE VALVE
TO LOWER PLATFORM
FIG. 26-1**

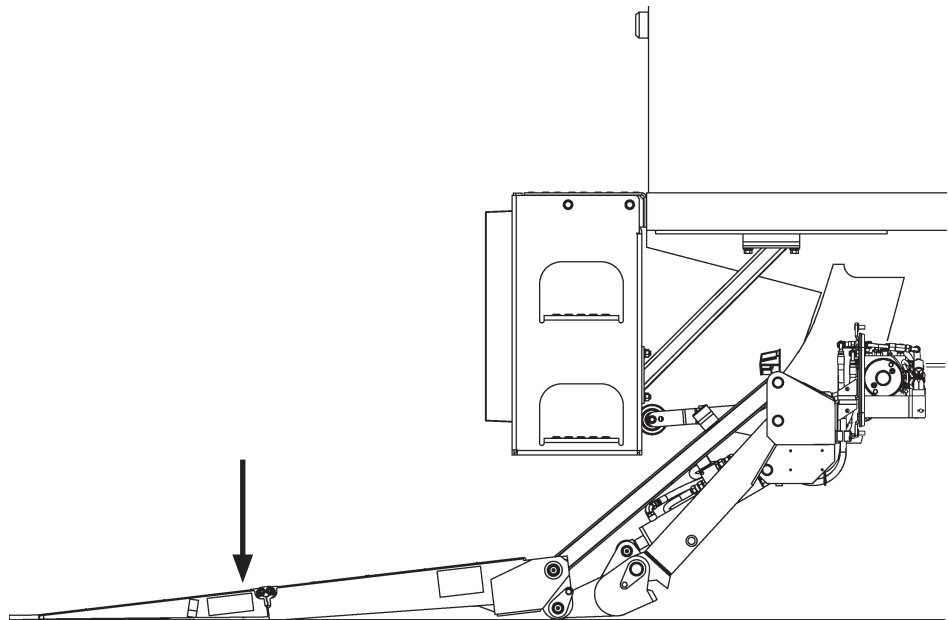

**LOWERING PLATFORM
FIG. 26-2**

5. Use the handle with hand pump to raise the platform (**FIGS. 27-1 & 27-2**).

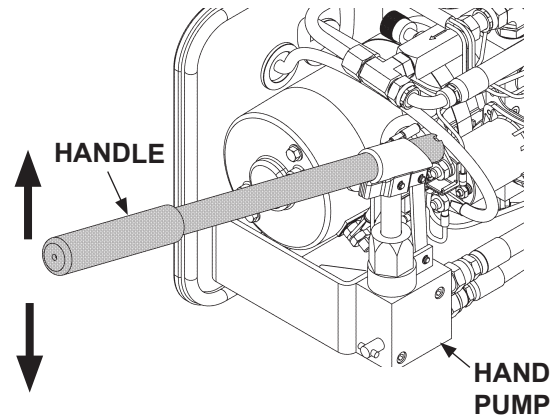

RAISING PLATFORM WITH HAND PUMP
FIG. 27-1

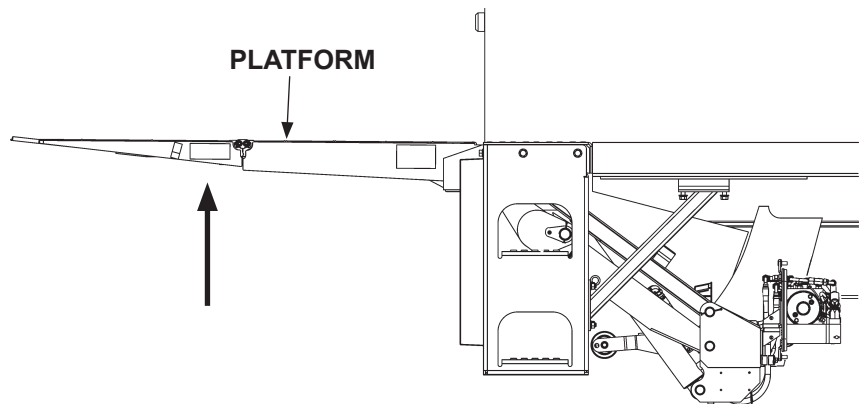

RAISING PLATFORM
FIG. 27-2

6. Reset (close) lock valve by turning shaft fully clockwise, **(FIG. 28-1)** so that it locks. Reinstall plastic nut.

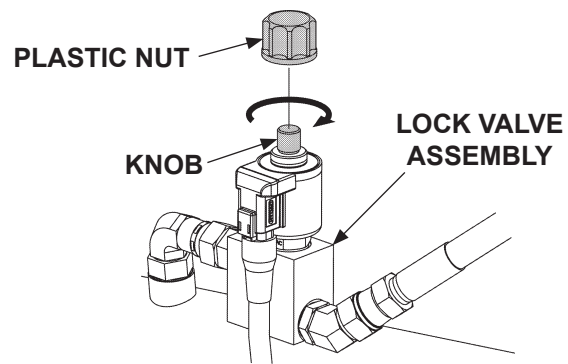

**RESETTING LOCK VALVE
FIG. 28-1**

7. For normal Liftgate operation with power unit, open the needle valve by turning knob fully counterclockwise **(FIG. 28-2)**.

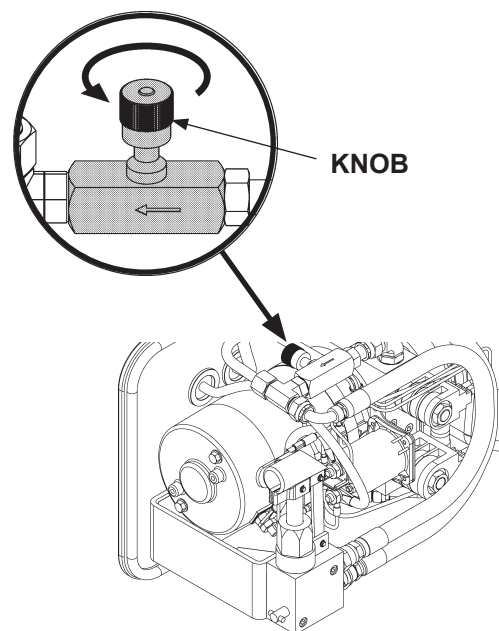

**OPENING NEEDLE VALVE FOR
NORMAL OPERATION
FIG. 28-2**

8. Stow hand pump handle in the spring clips on pump mounting plate (**FIG. 29-1**).

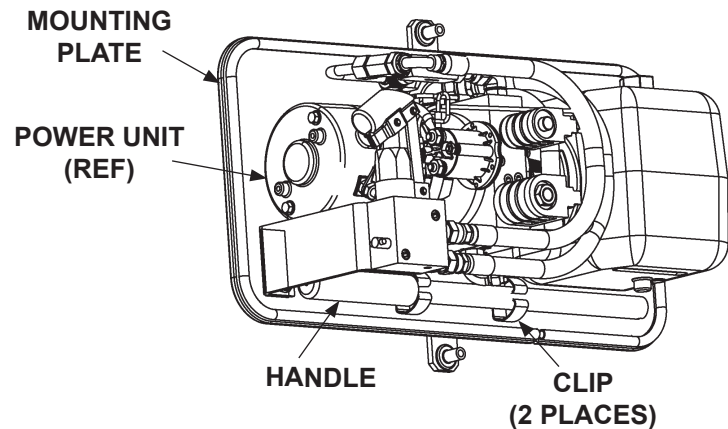

STOWING PUMP HANDLE
FIG. 29-1

9. Reinstall and fasten pump cover (**FIG. 29-2**). Hand-tighten knobs.

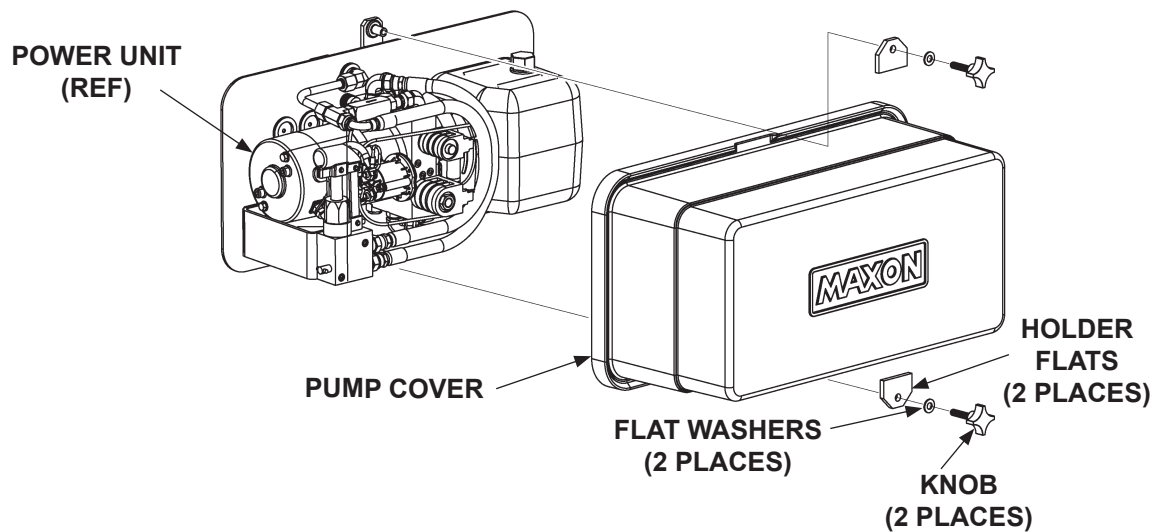

REINSTALLING PUMP COVER
FIG. 29-2