

INSTRUCTIONS, ME2 BACKUP BAR KIT**KIT P/N 296845-01****KIT P/N 296845-01G (GALVANIZED)****FORD F-150 (2014-2016), F-250/F-350 (2014 & 2017 MODELS)**

BACKUP BAR, 55-1/2" LG.
P/N 296844-01,
BACKUP BAR, 55-1/2" LG. (GALVANIZED)
P/N 296844-01G
QTY. 1

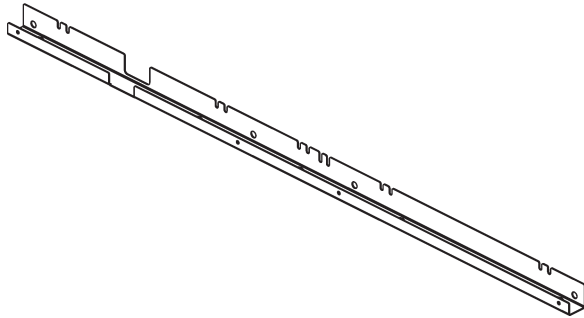

BRACKET, 1-1/4" X 1-1/4"
P/N 296842-01
QTY. 1

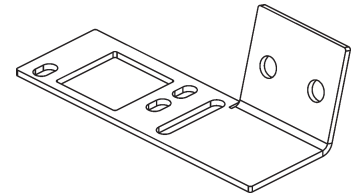
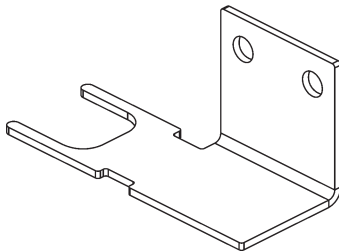

BRACKET, LH, 1-1/4" X 1-7/16"
P/N 296841-01
QTY. 2

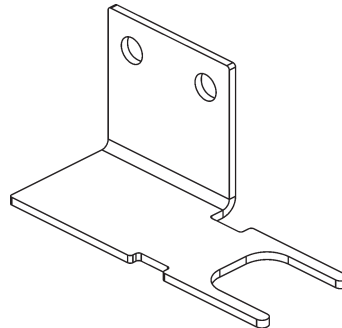

BRACKET, RH, 1-1/4" X 1-7/16"
P/N 296841-02
QTY. 2

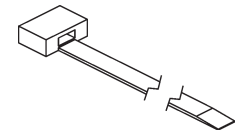

PLASTIC TIE
P/N 205780
QTY. 5

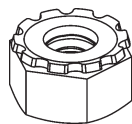
BACKUP BAR BOLT KIT**P/N 296843-01**

NUT, 1/4"-20
P/N 903163-01
QTY. 14

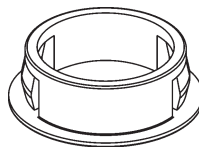

NYLON PLUG, 1"
P/N 908081-05
QTY. 4

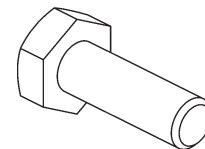

SCREW, HEX CAP, 1/4"-20 X 3/4" LG.
P/N 900788-02
QTY. 14

KIT P/N 297430-01
KIT P/N 297430-01G (GALVANIZED)
FORD SUPER DUTY F-250/F-350 (2016 MODELS)

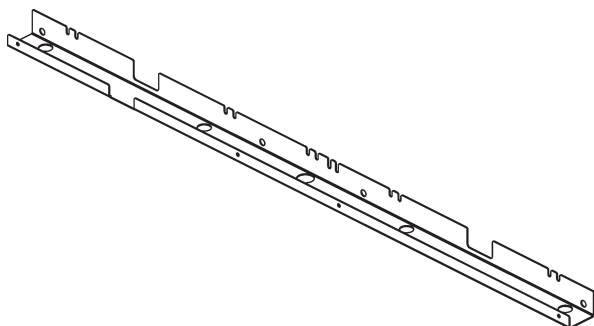

BACKUP BAR, 55-1/2" LG.
P/N 297431-01,
BACKUP BAR, 55-1/2" LG. (GALVANIZED)
P/N 297431-01G
QTY. 1

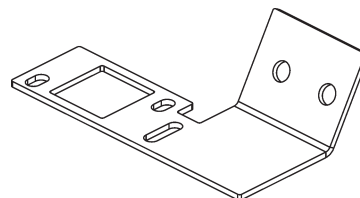

CAMERA BRACKET, FORD SUPER DUTY
P/N 297432-01
QTY. 1

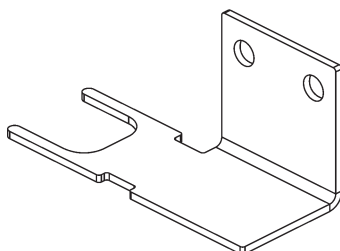

BRACKET, LH, 1-1/4" X 1-7/16"
P/N 296841-01
QTY. 2

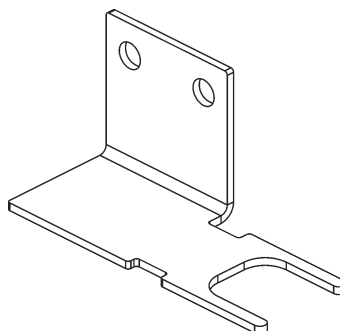

BRACKET, RH, 1-1/4" X 1-7/16"
P/N 296841-02
QTY. 2

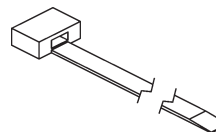

PLASTIC TIE
P/N 205780
QTY. 5

BACKUP BAR BOLT KIT
P/N 296843-01

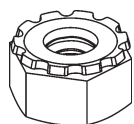

NUT, 1/4"-20
P/N 903163-01
QTY. 14

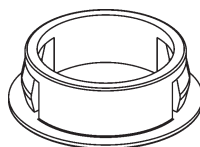

NYLON PLUG, 1"
P/N 908081-05
QTY. 4

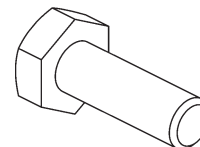

SCREW, HEX CAP, 1/4"-20 X 3/4" LG.
P/N 900788-02
QTY. 14

KIT P/N 296850-01
KIT P/N 296850-01G (GALVANIZED)
CHEVROLET/GMC 1500/2500/3500 (2014-2016 MODELS)

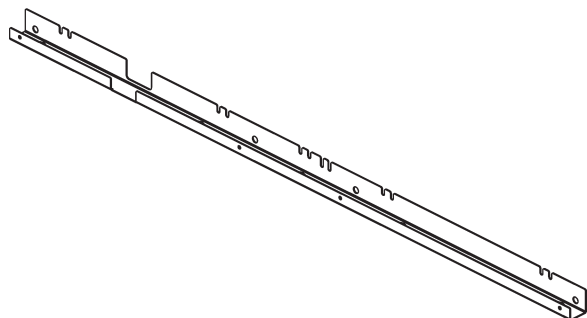

BACKUP BAR, 55-1/2" LG.
P/N 296844-01,
BACKUP BAR, 55-1/2" LG. (GALVANIZED)
P/N 296844-01G
QTY. 1

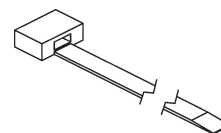

PLASTIC TIE
P/N 205780
QTY. 5

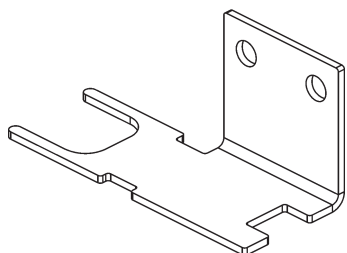

BRACKET, LH, 1-1/4" X 1-7/16"
P/N 296841-03
QTY. 2

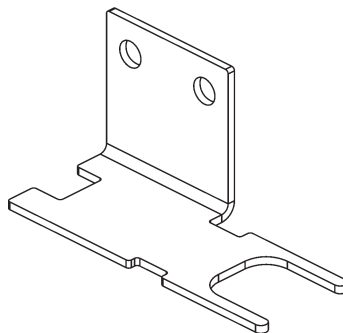

BRACKET, RH, 1-1/4" X 1-7/16", RH
P/N 296841-04
QTY. 2

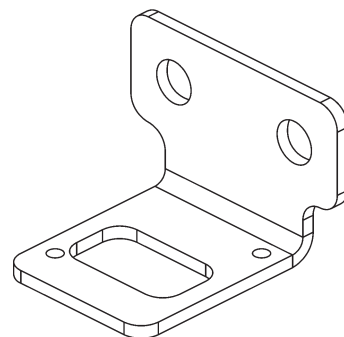

BRACKET, 1-1/2" X 1"
P/N 296846-01
QTY. 1

BACKUP BAR BOLT KIT
P/N 296843-01

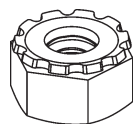

NUT, 1/4"-20
P/N 903163-01
QTY. 14

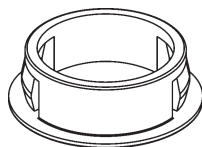

NYLON PLUG, 1"
P/N 908081-05
QTY. 4

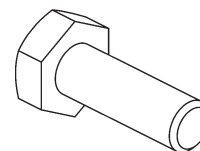

SCREW, HEX CAP, 1/4"-20 X 3/4" LG.
P/N 900788-02
QTY. 14

KIT P/N 297840-01
KIT P/N 297840-01G (GALVANIZED)
DODGE RAM 1500/2500/3500 (2013-2017 MODELS)

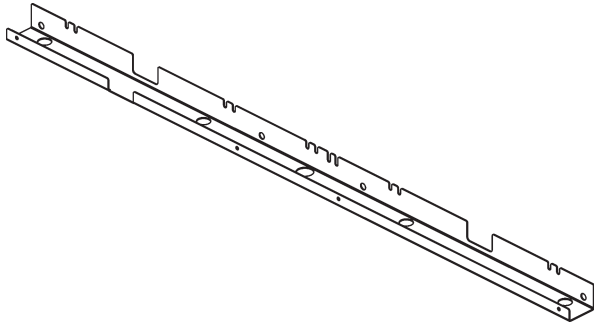

BACKUP BAR, 55-1/2" LG.
P/N 297431-01,
BACKUP BAR, 55-1/2" LG. (GALVANIZED)
P/N 297431-01G
QTY. 1

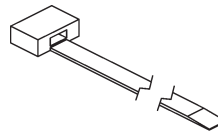

PLASTIC TIE
P/N 205780
QTY. 5

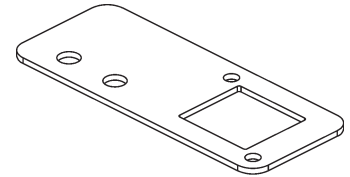

CAMERA BRACKET
P/N 297893-01
QTY. 1

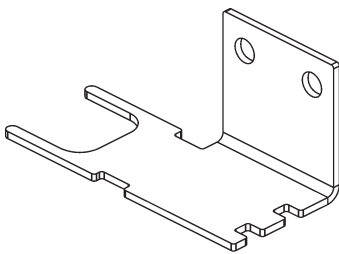

SENSOR BRACKET, LH
P/N 297892-01
QTY. 2

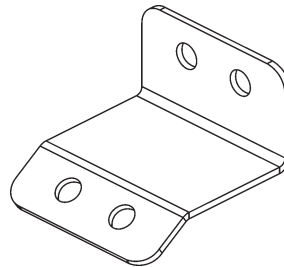

SUPPORT CAMERA BRACKET
P/N 297894-01
QTY. 1

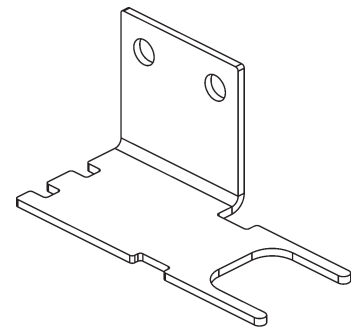

SENSOR BRACKET, RH
P/N 297892-02
QTY. 2

BACKUP BAR BOLT KIT
P/N 297841-01

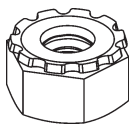

NUT, 1/4"-20
P/N 903163-01
QTY. 16

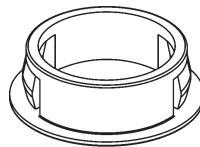

NYLON PLUG, 1"
P/N 908081-05
QTY. 4

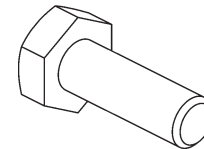

SCREW, HEX CAP, 1/4"-20 X 3/4" LG.
P/N 900788-02
QTY. 16

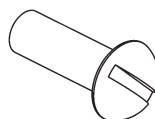

SCREW, 8-32 X 1/2" LG.
P/N 901211-06
QTY. 2

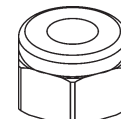

LOCK NUT, 8-32
P/N 901006
QTY. 2

⚠ WARNING

Relocating the factory installed camera may result in inaccurate gridlines on the display screen. Operate with caution and always check surroundings before putting the vehicle in reverse.

NOTE: Backup camera system on vehicle must comply with **Federal Motor Vehicle Safety Standard (FMVSS 111) for Rear Visibility**. It is the installers responsibility to ensure camera is mounted and aimed to meet the 10'x20' field of view requirement in **FMVSS 111**.

1. Lower Liftgate to ground (**FIG. 5-1**) and remove cover.
2. Disconnect ground (-) battery cable from vehicle battery.
3. Remove backup camera and wire harness from tailgate and set aside.
4. If equipped, remove backup sensors and wire harness from bumper and set aside.

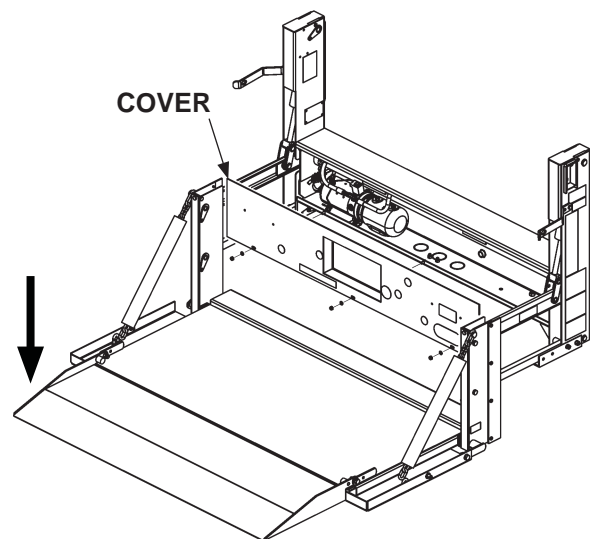

**LOWERING LIFTGATE TO GROUND
FIG. 5-1**

NOTE: Check for interference when positioning backup bar under the Liftgate before drilling holes.

- Position backup bar (Kit item) underneath the Liftgate on the mainframe as shown in **FIG. 6-1**.
- Use backup bar as a template and drill (4) 1/4" holes through the mainframe (**FIG. 6-1A**).

NOTE: If gusset covers sensor hole (**FIG. 6-1B**), grind gusset to clear hole.

- Install backup bar to the bottom of the Liftgate with cap screws (Kit items) and nuts (Kit items) (**FIGS. 6-1 and 6-1A**).

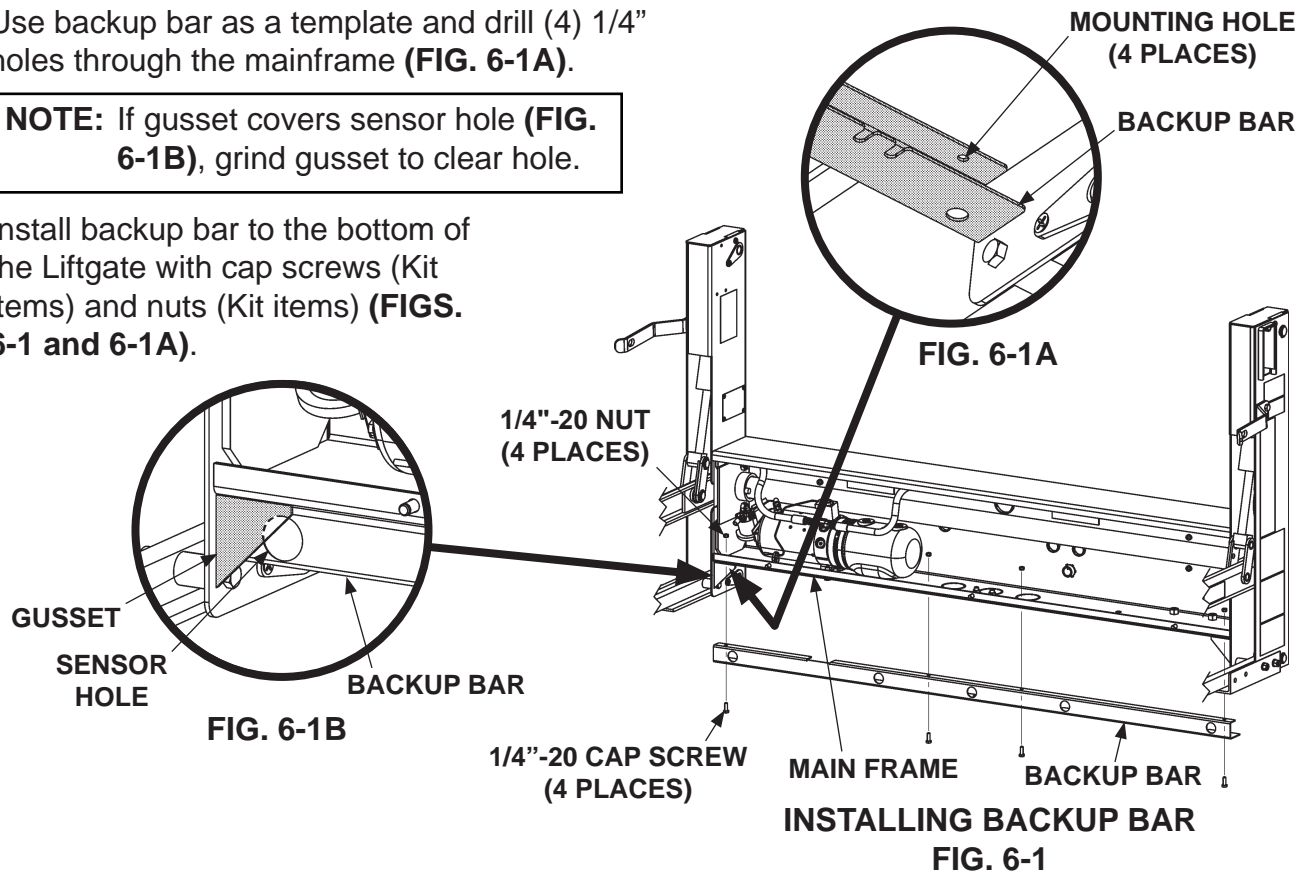

- Route wire harness from the vehicle to the bottom of the mainframe.
- Connect backup camera and each sensor (if equipped) to wiring harness.

NOTE: Sensor wires (if equipped) should be routed towards center of the vehicle.

- If equipped, position sensors in the brackets (Kit items) and secure with plastic ties (Kit items) (**FIG. 6-2**).

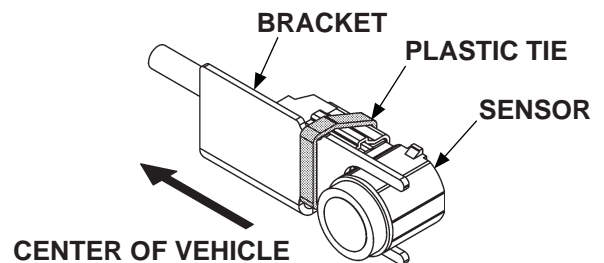

POSITIONING SENSOR IN BRACKET (RH SIDE SHOWN) FIG. 6-2

NOTE: Ford kits use plastic ties (Kit items) to secure backup camera to the bracket. For the GM and Chevrolet kits, use the original backup camera screws to fasten camera to bracket. If unable to use the original screws, use plastic ties (Kit items) to fasten camera to bracket.
 Dodge kits use 8-32 x 1/2" LG. screws (Kit items) to fasten camera to bracket, and 1/4"-20 x 3/4" LG. screws (Kit items) to fasten support bracket to camera bracket.

11. Attach backup camera to the camera bracket (Kit item) with plastic ties (Kit items) (**FIG. 7-1**) or screws (**FIGS. 7-2 and 7-3**).

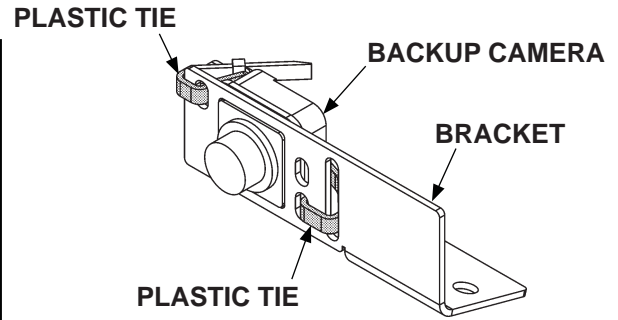

**ATTACHING CAMERA BRACKET
 (FORD KITS)
 FIG. 7-1**

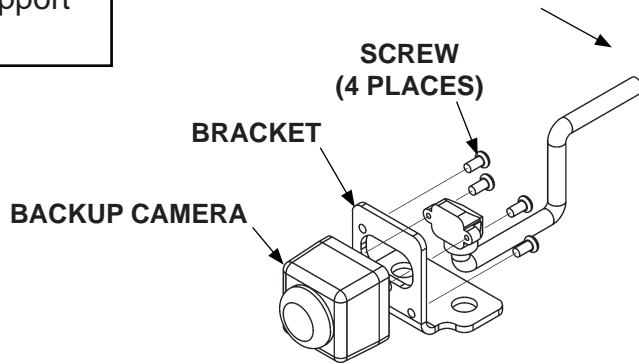

**ATTACHING CAMERA BRACKET
 (GM AND CHEVROLET KITS)
 FIG. 7-2**

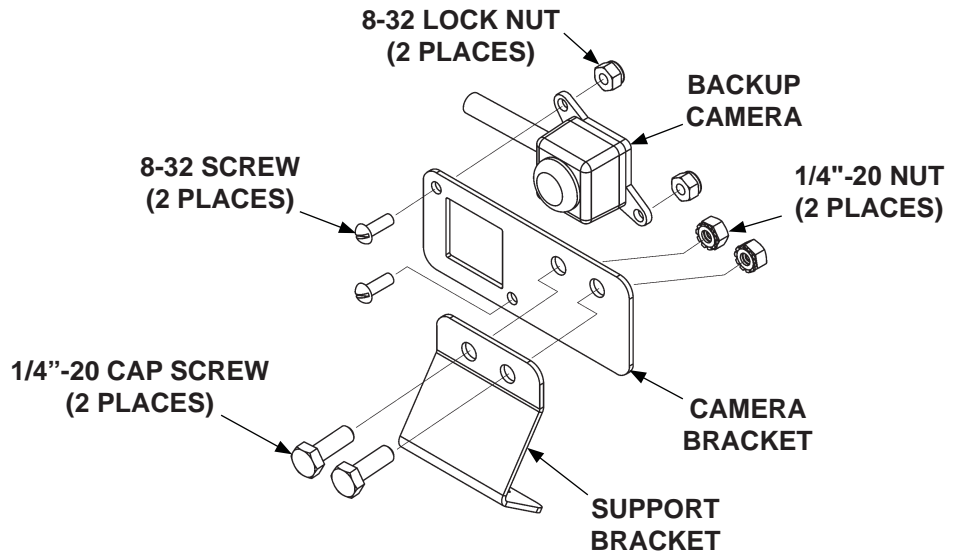

**ATTACHING CAMERA BRACKET
 (DODGE KITS)
 FIG. 7-3**

12. Install sensors, camera and brackets in the backup bar with cap screws (Kit items) and nuts (Kit items) (**FIG. 8-1**). Then insert nylon plugs (Kit Items) as shown in **FIG. 8-1**.

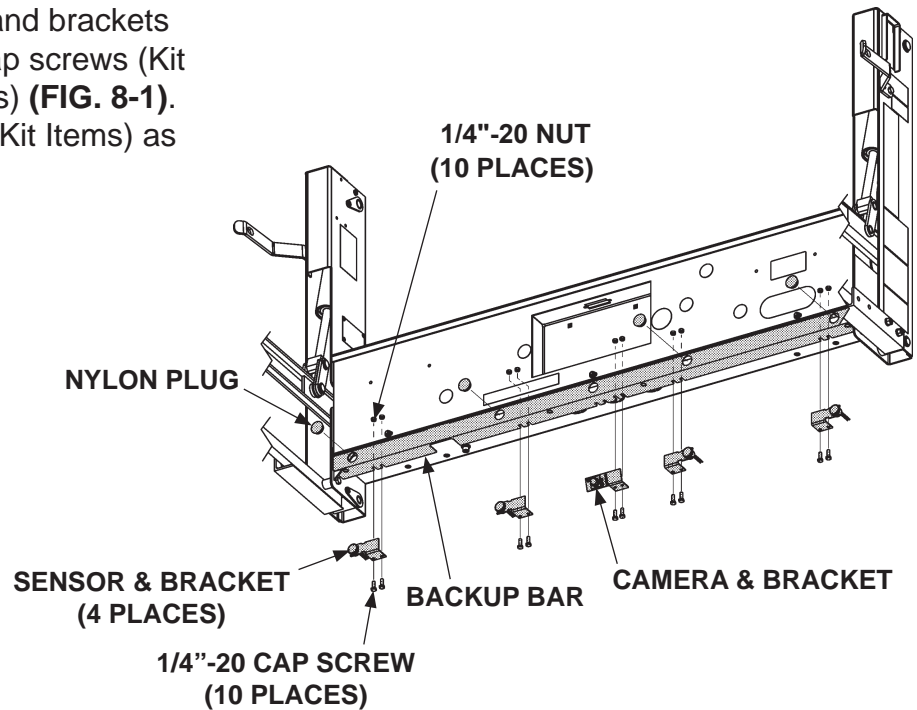

INSTALLING BRACKETS
FIG. 8-1

13. Secure wiring harness in backup bar with plastic ties (Kit items).
14. Replace cover on mainframe (**FIG. 8-2**).
15. Reconnect ground (-) battery cable to vehicle battery.

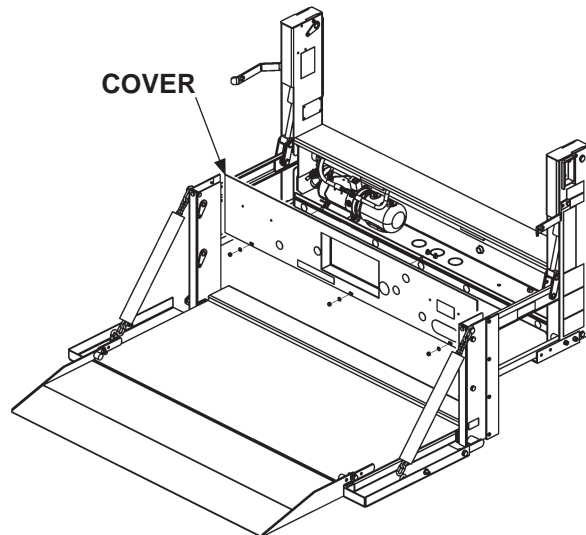

REPLACING COVER
FIG. 8-2

INSTRUCCIONES, ME2

KIT N/P 296845-01

KIT (GALVANIZADO) N/P 296845-01G

FORD F-150 (MODELOS 2014-2016), F-250/F-350 (MODELOS 2014 & 2017)

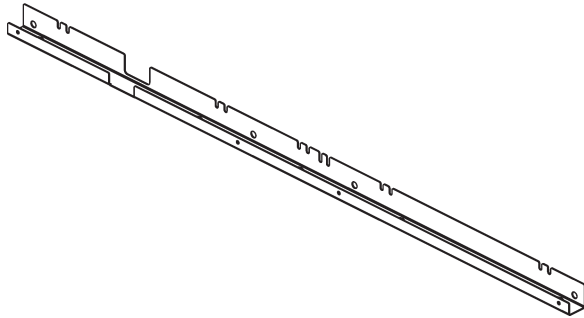

BARRA DE REVERSA,
55-1/2" LG., N/P 296844-01,
BARRA DE REVERSA, 55-1/2" LG.
(GALVANIZADA)
N/P 296844-01G
CANT. 1

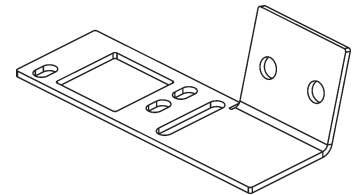

SOPORTE, 1-1/4" X 1-1/4"
N/P 296842-01
CANT. 1

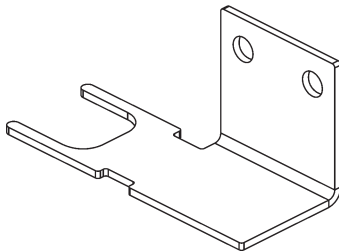

SOPORTE IZQUIERDO,
1-1/4" X 1-7/16"
N/P 296841-01
CANT. 2

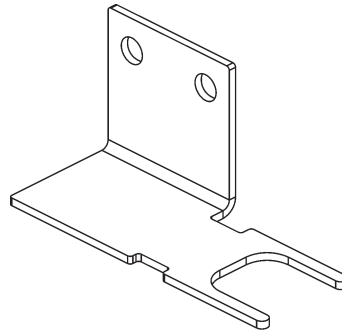

SOPORTE DERECHO,
1-1/4" X 1-7/16"
N/P 296841-02
CANT. 2

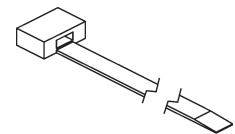

CINTILLO PLÁSTICO
N/P 205780
CANT. 5

KIT DE TORNILLOS PARA BARRA DE REVERSA N/P 296843-01

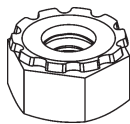

TUERCA, 1/4"-20
N/P 903163-01
CANT. 14

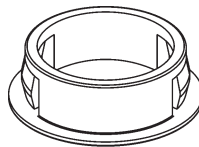

TAPÓN DE NYLON, 1"
N/P 908081-05
CANT. 4

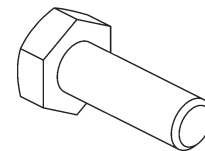

TORNILLO, CBZ. HEX.,
1/4"-20 X 3/4" LG.
N/P 900788-02
CANT. 14

KIT N/P 297430-01
KIT (GALVANIZADO) N/P 297430-01G
FORD SUPER DUTY F-250/F-350 (MODELOS 2016)

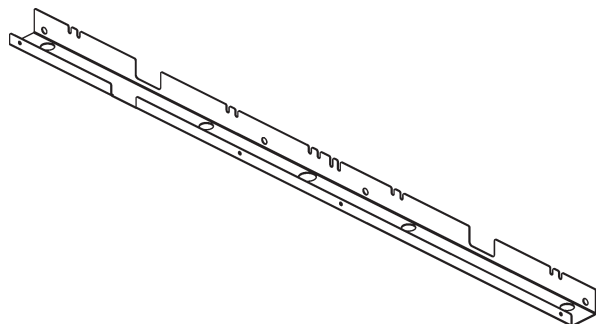

BARRA DE REVERSA,
55-1/2" LG., N/P 297431-01,
BARRA DE REVERSA,
55-1/2" LG. (GALVANIZADA)
N/P 297431-01G
CANT. 1

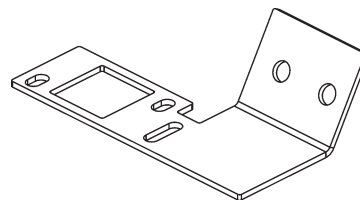

SOPORTE PARA CÁMARA,
FORD SUPER DUTY
N/P 297432-01
CANT. 1

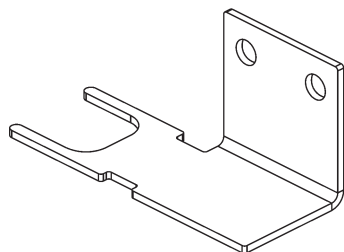

SOPORTE IZQUIERDO,
1-1/4" X 1-7/16"
N/P 296841-01
CANT. 2

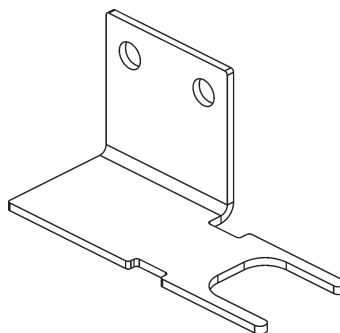

SOPORTE DERECHO,
1-1/4" X 1-7/16"
N/P 296841-02
CANT. 2

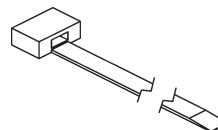

CINTILLO PLÁSTICO
N/P 205780
CANT. 5

KIT DE TORNILLOS PARA BARRA DE REVERSA
N/P 296843-01

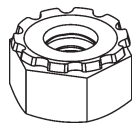

TUERCA, 1/4"-20
N/P 903163-01
CANT. 14

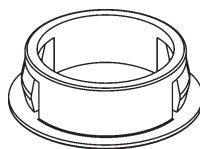

TAPÓN DE NYLON, 1"
N/P 908081-05
CANT. 4

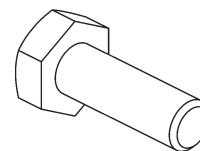

TORNILLO, CBZ. HEX.,
1/4"-20 X 3/4" LG.
N/P 900788-02
CANT. 14

KIT N/P 296850-01
KIT (GALVANIZADO) N/P 296850-01G
CHEVROLET/GMC 1500/2500/3500 (MODELOS 2014-2016)

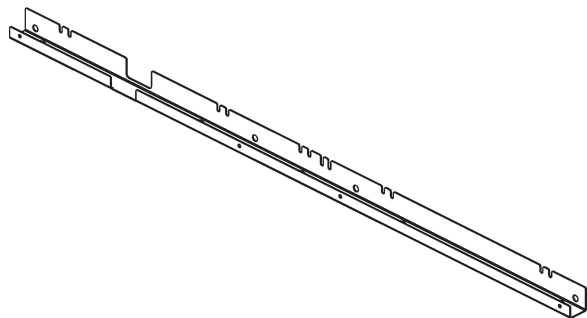

BARRA DE REVERSA,
55-1/2" LG., N/P 296844-01,
BARRA DE REVERSA,
55-1/2" LG. (GALVANIZADA)
N/P 296844-01G
CANT. 1

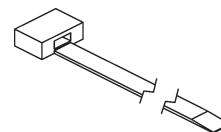

CINTILLO PLÁSTICO
N/P 205780
CANT. 5

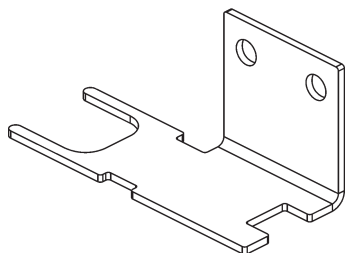

SOPORTE IZQUIERDO, 1-1/4"
X 1-7/16"
N/P 296841-03
CANT. 2

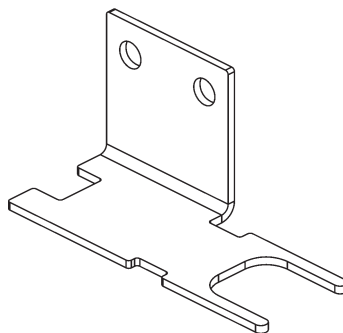

SOPORTE DERECHO,
1-1/4" X 1-7/16", DER.
N/P 296841-04
CANT. 2

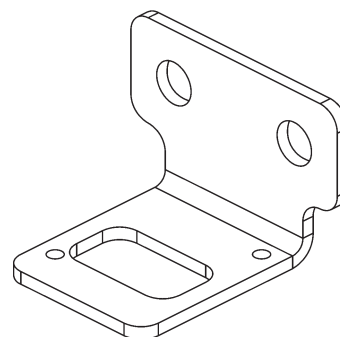

SOPORTE, 1-1/2" X 1"
N/P 296846-01
CANT. 1

KIT DE TORNILLOS PARA BARRA DE REVERSA
N/P 296843-01

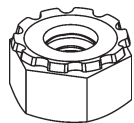

TUERCA, 1/4"-20
N/P 903163-01
CANT. 14

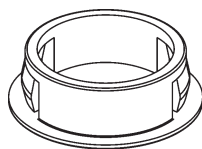

TAPÓN DE NYLON, 1"
N/P 908081-05
CANT. 4

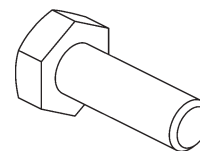

TORNILLO, CBZ. HEX.,
1/4"-20 X 3/4" LG.
N/P 900788-02
CANT. 14

KIT N/P 297840-01
KIT (GALVANIZADO) N/P 297840-01G
DODGE RAM 1500/2500/3500 (MODELOS 2013-2017)

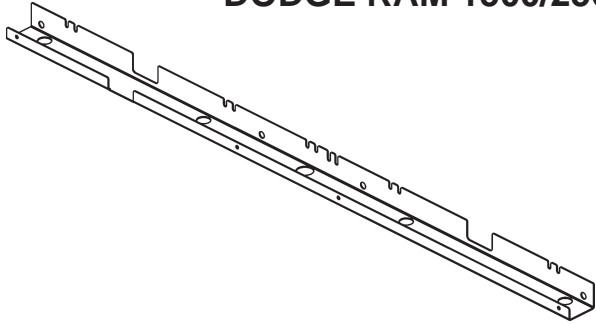

BARRA DE REVERSA,
55-1/2" LG., N/P 297431-01,
BARRA DE REVERSA,
55-1/2" LG. (GALVANIZADA)
N/P 297431-01G
CANT. 1

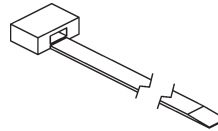

CINTILLO PLÁSTICO
N/P 205780
CANT. 5

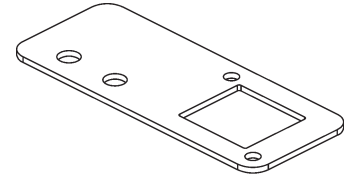

SOPORTE PARA CÁMARA
N/P 297893-01
CANT. 1

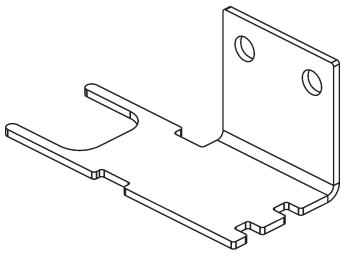

SOPORTE DEL SENSOR,
IZQUIERDO
N/P 297892-01
CANT. 2

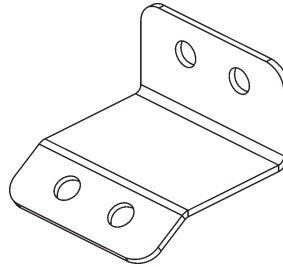

SOPORTE ANGULAR
PARA CÁMARA
N/P 297894-01
CANT. 1

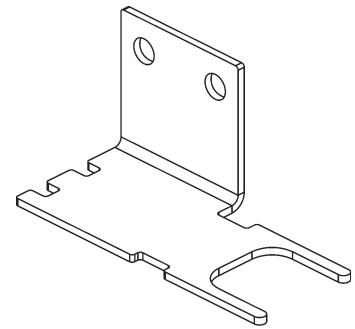

SOPORTE DEL SENSOR,
DERECHO
N/P 297892-02
CANT. 2

KIT DE TORNILLOS PARA BARRA DE REVERSA
N/P 297841-01

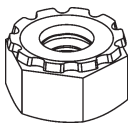

TUERCA, 1/4"-20
N/P 903163-01
CANT. 16

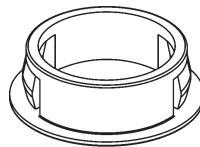

TAPÓN DE NYLON, 1"
N/P 908081-05
CANT. 4

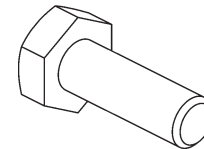

TORNILLO, CBZ. HEX.,
1/4"-20 X 3/4" LG.
N/P 900788-02
CANT. 16

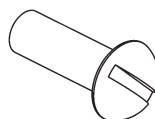

TORNILLO, 8-32 X 1/2" LG.
N/P 901211-06
CANT. 2



LOCK TUERCA, 8-32
N/P 901006
CANT. 2

⚠ ADVERTENCIA

Reubicar la cámara instalada por la fábrica puede ocasionar cuadrículas inexactas en la pantalla de visualización. Opere con precaución y siempre verifique sus alrededores antes de hacer marchar el vehículo en reversa.

NOTA: El sistema de la cámara de reversa debe cumplir con los Estándares Federales de Seguridad para Visibilidad Trasera en Vehículos Automotrices **FMVSS 111 (Federal Motor Vehicle Safety Standard for Rear Visibility)**. Es responsabilidad del instalador asegurarse de que la cámara esté montada y enfocada para cumplir con el campo de visión de 10'x20' [25.4cm x 50.8cm] estipulado en los **FMVSS 111**.

1. Baje el Elevador al suelo (**FIG. 13-1**) y retire la cubierta.
2. Desconecte el cable a tierra (-) de la batería del vehículo.
3. Retire la cámara de reversa y el arnés de cableado de la puerta trasera.
4. De estar equipado, retire los sensores de reversa y el arnés de cableado del para-choques y reserve.

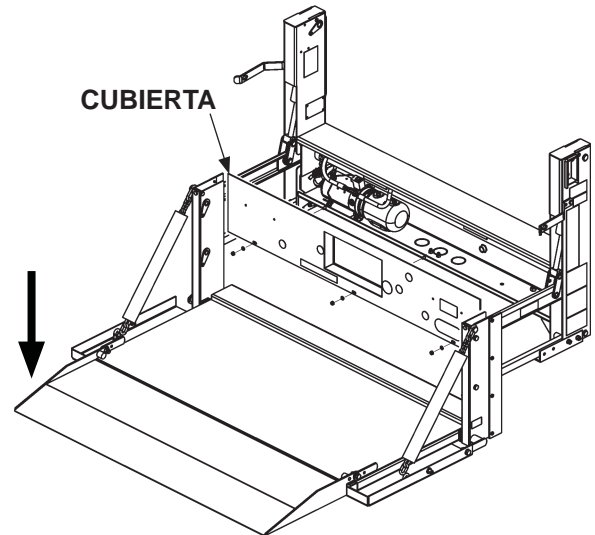

**BAJAR ELEVADOR AL SUELO
FIG. 13-1**

NOTA: Verifique que no haya interferencia al colocar la barra de reversa debajo del Elevador Hidráulico antes de realizar las perforaciones.

- Coloque la barra de reversa (incluida en el kit) debajo del Elevador en el bastidor principal como se muestra en la **FIG. 14-1**.
- Utilice la barra de reversa como plantilla para realizar (4) orificios de 1/4" [6 mm] a través del bastidor principal (**FIG. 14-1A**).

NOTA: Si la placa triangular cubre el orificio del sensor (**FIG. 14-1B**), esmerile la placa hasta dejar libre el orificio.

- Instale la barra de reversa en la parte inferior del Elevador con tornillos (incluidos en el kit) y tuercas (incluidas en el kit) (**FIGS. 14-1 y 14-1A**).

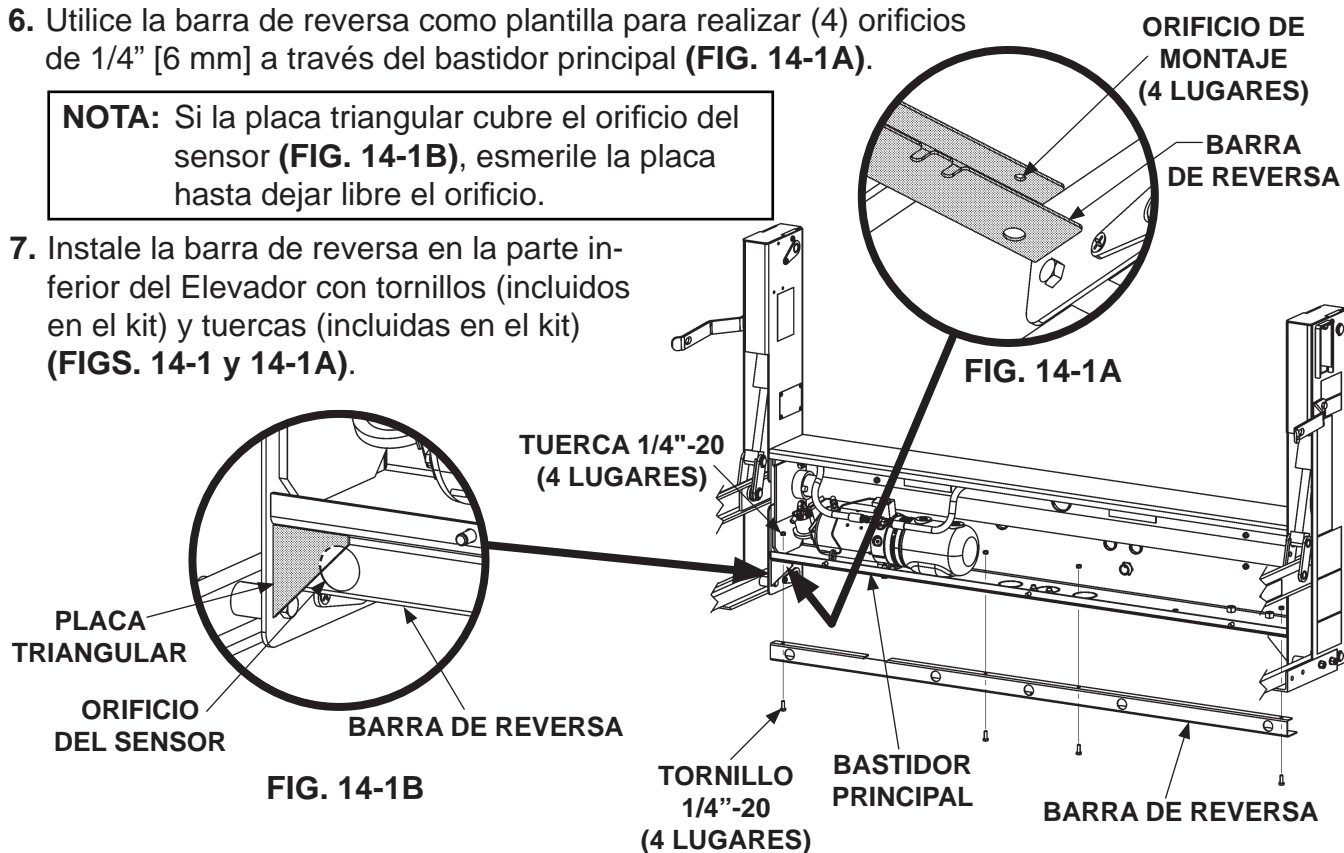

**INSTALAR BARRA DE REVERSA
FIG. 14-1**

- Guíe el arnés de cableado desde el vehículo hasta la parte inferior del bastidor principal.
- Conecte la cámara de reversa y cada sensor (si están equipados) al arnés de cableado.

NOTA: Los cables de sensor (si están equipados) deben guiarse hacia el centro del vehículo.

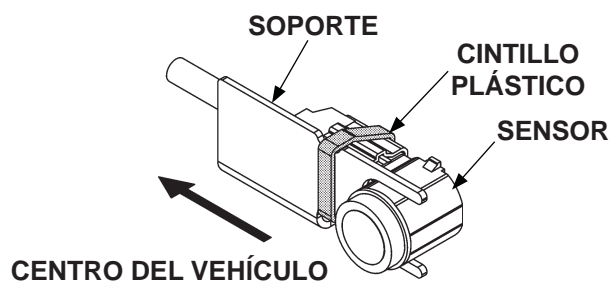

**COLOCAR SENSOR EN EL SOPORTE
(SE MUESTRA LADO DERECHO)
FIG. 14-2**

- Si están equipados, coloque los sensores en los soportes (incluidos en el kit) y asegúrelos con cintillos plásticos (incluidos en el kit) (**FIG. 14-2**).

NOTA: Los kits para Ford utilizan cintillos plásticos (incluidos en el kit) para asegurar la cámara de reversa al soporte. Los kits de GM y Chevrolet utilizan los tornillos originales de la cámara de reversa para sujetarla al soporte. Si no es posible utilizar los tornillos originales, utilice cintillos plásticos (incluidos en el kit) para sujetar la cámara al soporte. Los kits para Dodge utilizan tornillos de 8-32 x 1/2" de lg. (incluidos en el kit) para fijar la cámara al soporte, y tornillos de 1/4"-20 x 3/4" de lg. (incluidos en el kit) para ajustar el soporte angular al soporte para cámara.

11. Fije la cámara de reversa al soporte para cámara (artículo incluido en el kit) con cintillos plásticos (incluidos en el kit) (**FIG. 15-1**) o tornillos (**FIGS. 15-2 y 15-3**).

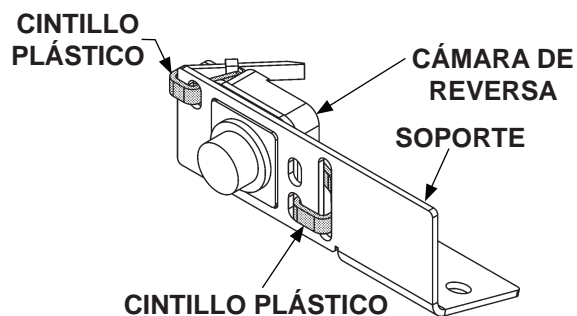

**FIJAR SOPORTE PARA CÁMARA
(KITS PARA FORD)
FIG. 15-1**

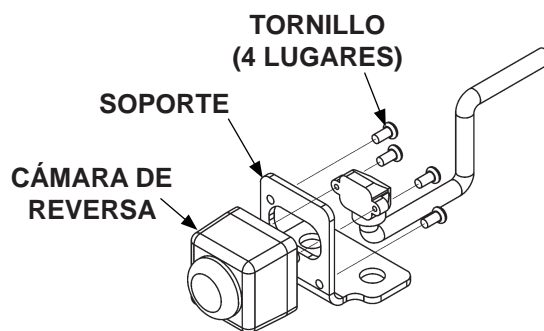

**FIJAR SOPORTE PARA CÁMARA
(KITS PARA GM Y CHEVROLET)
FIG. 15-2**

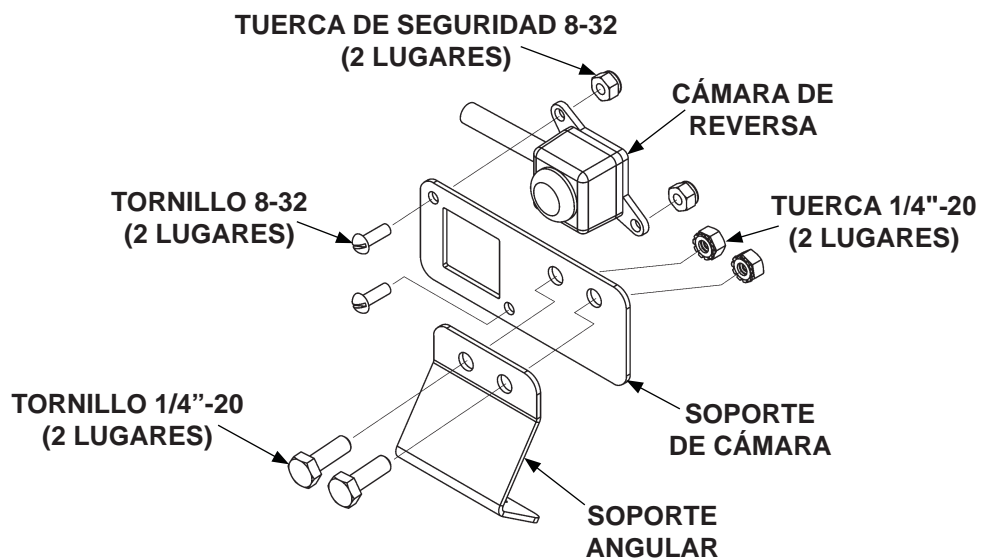

**FIJAR SOPORTE PARA CÁMARA
(KITS PARA DODGE)
FIG. 15-3**

12. Instale sensores, cámara y soportes en la barra de reversa con tornillos (incluidos en el kit) y tuercas (incluidas en el kit) (**FIG. 16-1**). Después inserte tapones de nylon (incluidos en el kit) como se muestra en la **FIG. 16-1**.

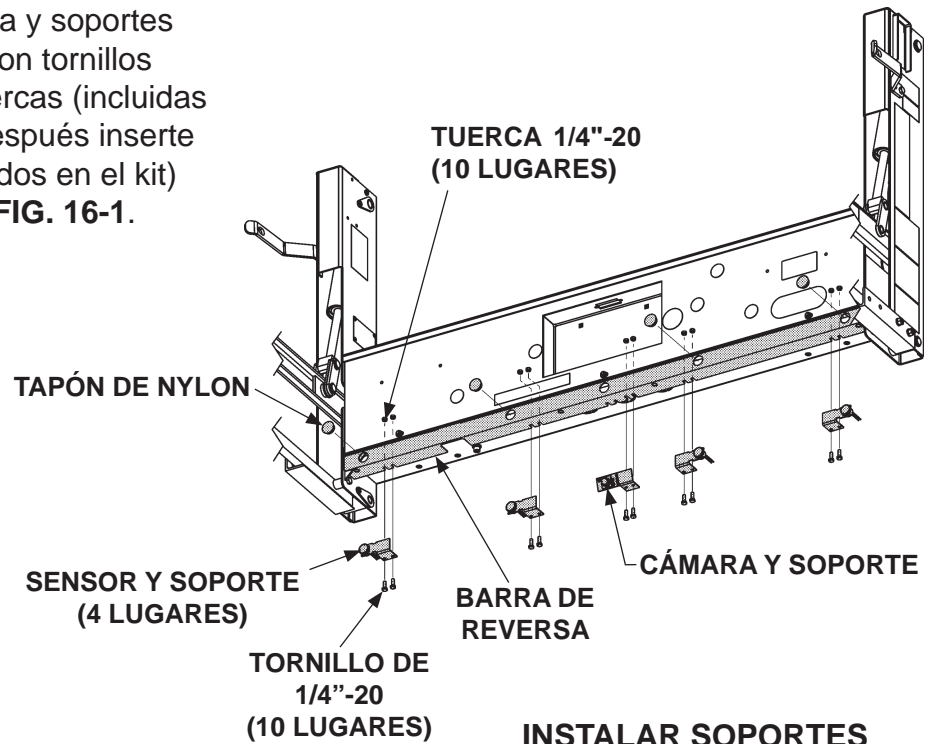

**INSTALAR SOPORTES
FIG. 16-1**

13. Asegure el arnés de cableado a la barra de reversa con cintillos plásticos (incluidos en el kit).
14. Vuelva a colocar la cubierta en el bastidor principal (**FIG. 16-2**).
15. Reconecte el cable a tierra (-) a la batería del vehículo.

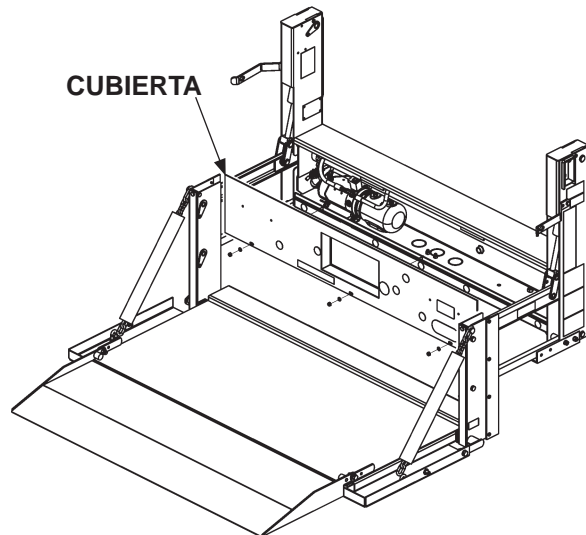

**REEMPLAZAR CUBIERTA
FIG. 16-2**