

INSTRUCTION, TUK-A-WAY DUAL CONTROL P/N 297115-01

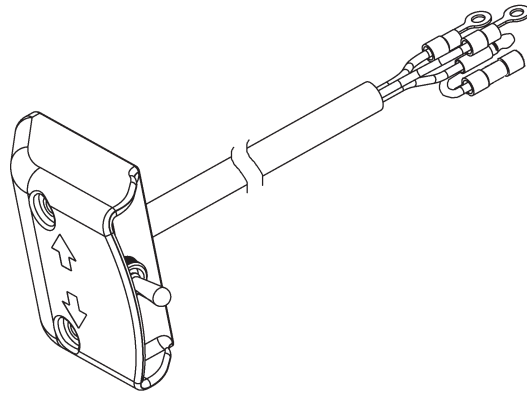

TOGGLE SWITCH ASSEMBLY, 175" LG
P/N 296855-03
QTY. 1



SELF-TAPPING SCREW
P/N 900057-5
QTY. 2



GROMMET
P/N 266428-12
QTY. 1

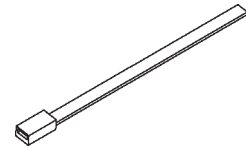

7" PLASTIC TIE
P/N 205780
QTY. 3

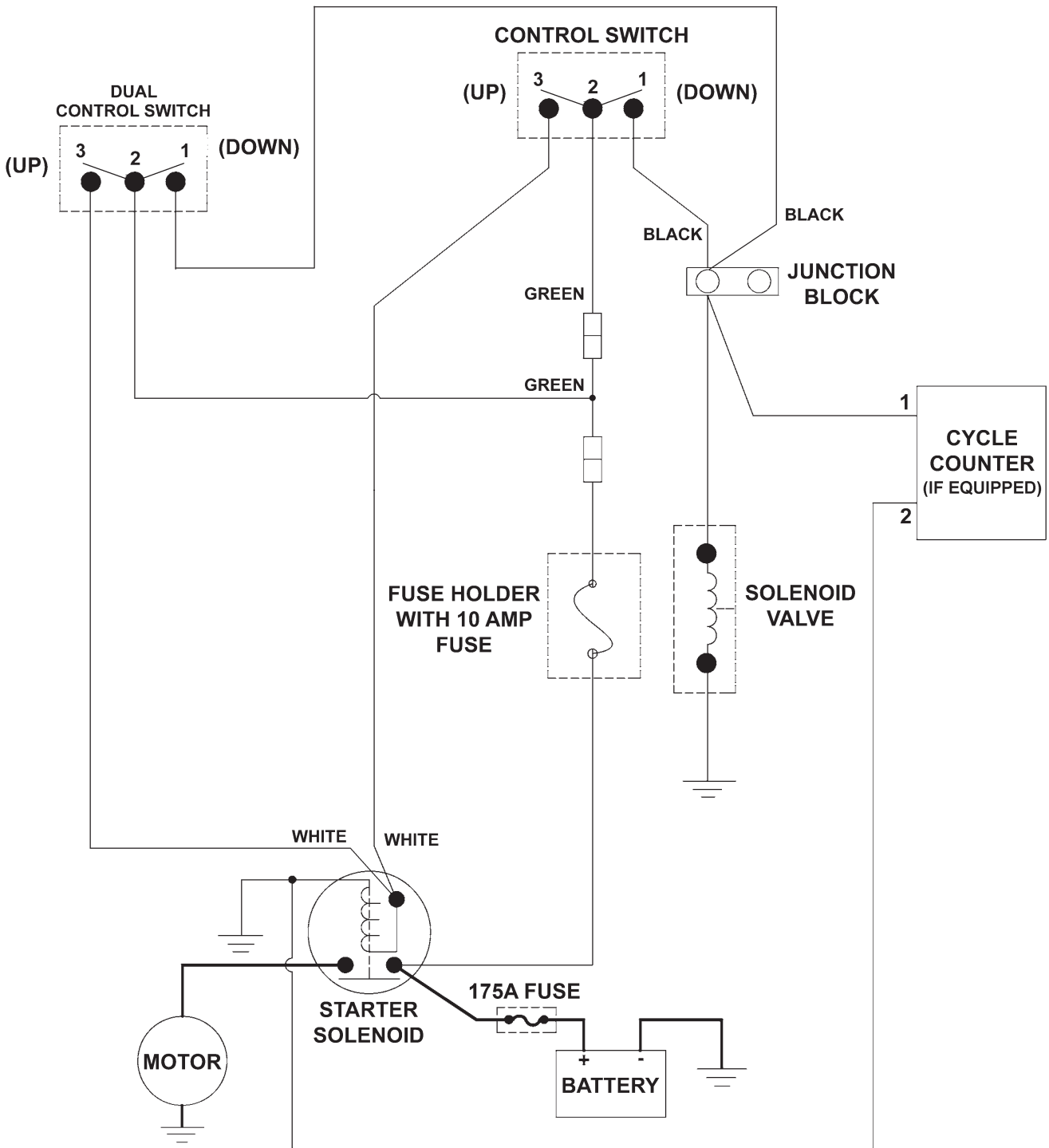

**ELECTRICAL SCHEMATIC (GRAVITY DOWN)
FIG. 2-1**

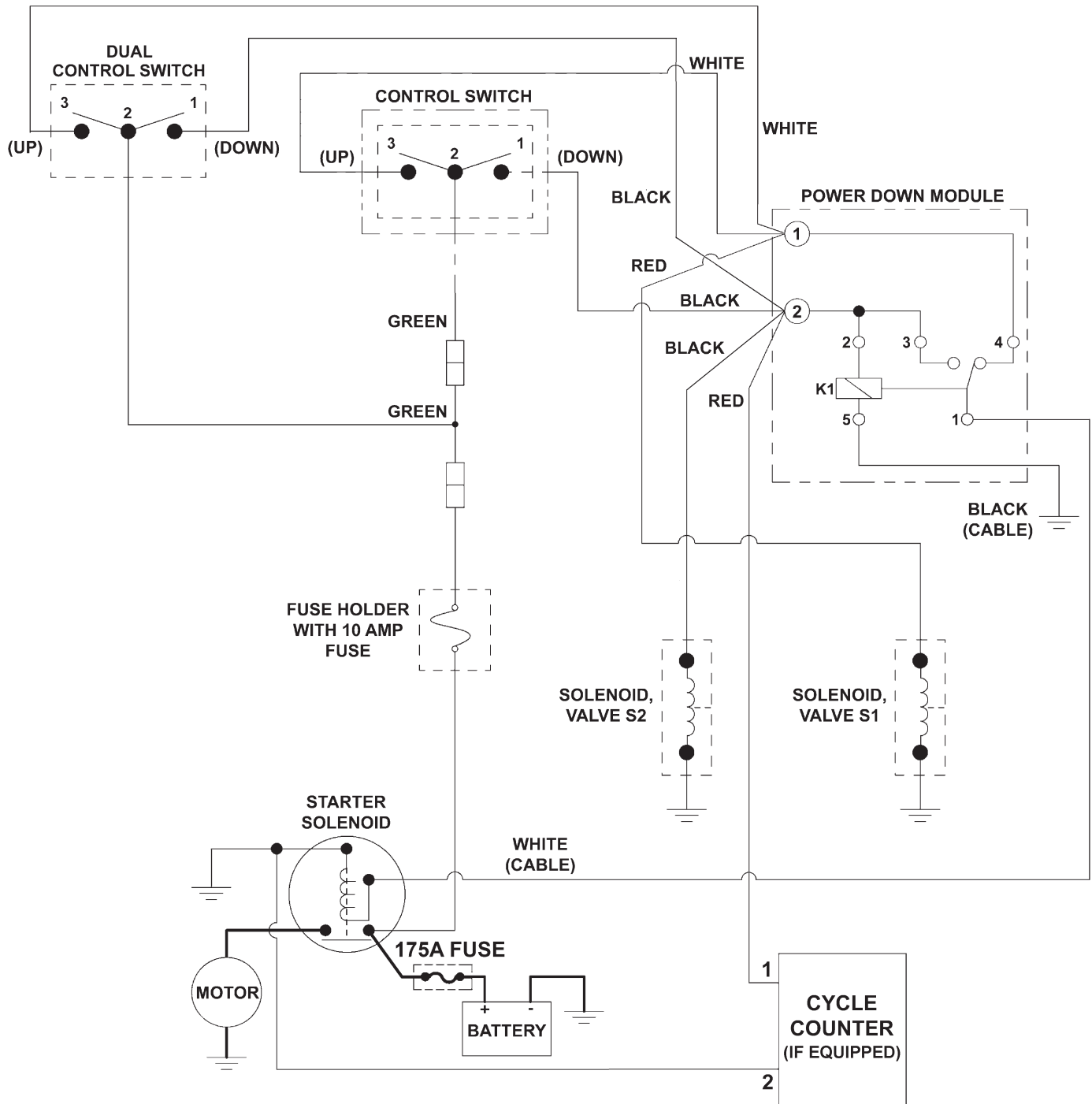

**ELECTRICAL SCHEMATIC (POWER DOWN)
FIG. 3-1**

⚠ WARNING

Remove all rings, watches and jewelry before doing any electrical work.

⚠ WARNING

To prevent accidental personal injury and equipment damage, disconnect (-) battery cable from battery.

⚠ WARNING

Never route an energized wire. Make sure battery is disconnected. Always route electrical wires clear of moving parts, brake lines, sharp edges and exhaust systems. Avoid making sharp bends in wiring. Attach securely. If drilling is necessary, first check behind the drilling surface so you do not damage any fuel lines, vent lines, brake lines or wires.

1. Lower platform to the ground. Then, unfold platform and flipover to the ground (**FIG. 4-1**). See **Operation Manual** for detailed operating instructions.

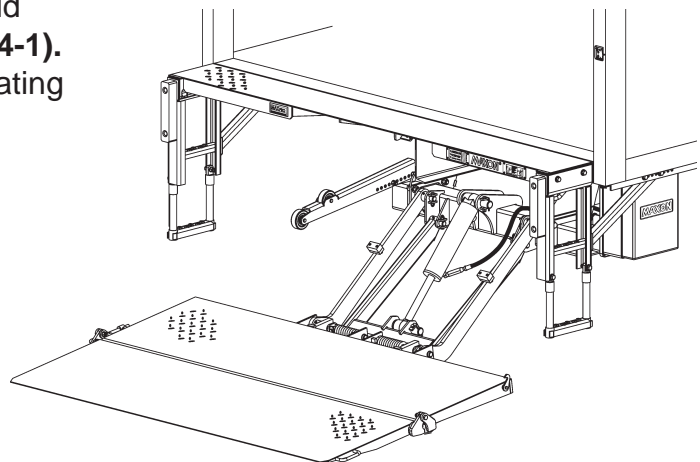

PLATFORM LOWERED TO THE GROUND
FIG. 4-1

2. Disconnect power from liftgate. Remove nut from negative (-) battery terminal (**FIG. 4-2**). Disconnect negative (-) battery cable (**FIG. 4-2**).

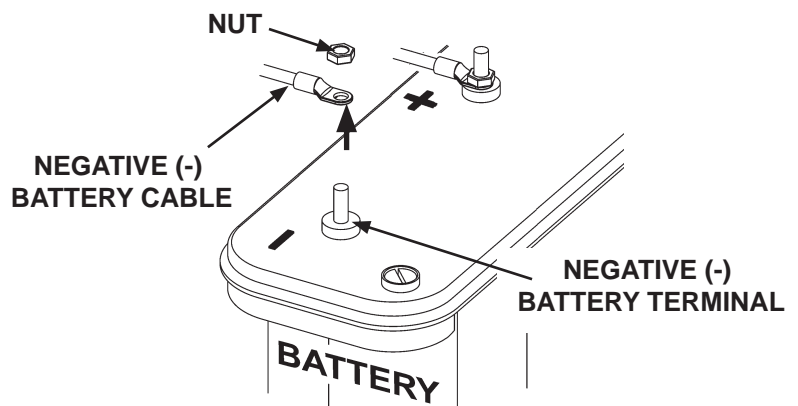

DISCONNECTING POWER
FIG. 4-2

3. Measure, mark, and drill one 3/4" hole and two #21-size holes in the vertical post on curb side of vehicle body as shown in **FIG. 5-1**.

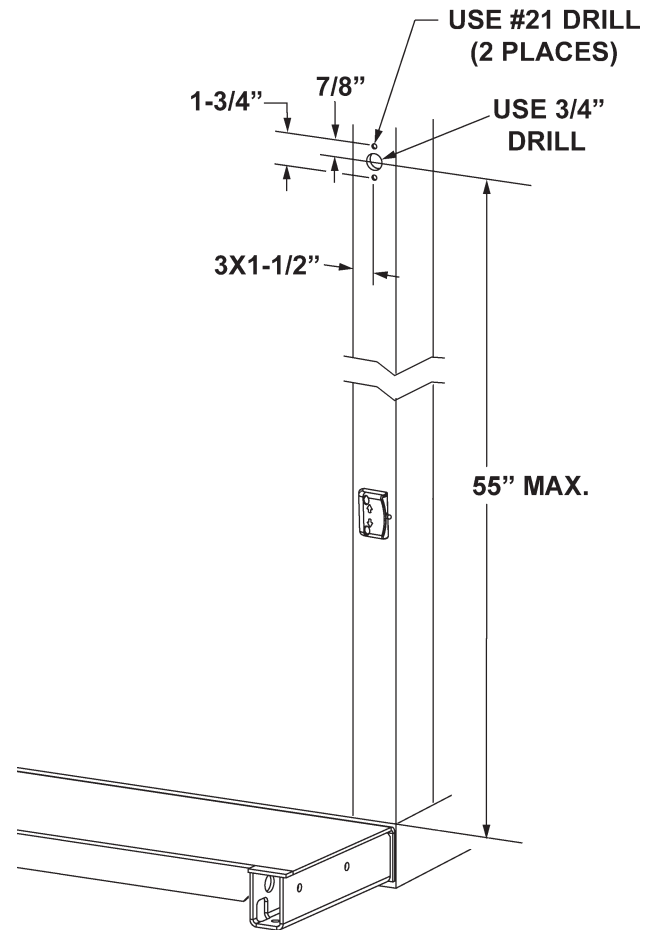

DRILLING HOLES IN VEHICLE BODY
FIG. 5-1

⚠ CAUTION

Always route electrical wires clear of moving parts, brake lines, sharp edges and exhaust systems. Avoid making sharp bends in wiring. Attach securely. If drilling is necessary, first check behind the drilling surface so you do not damage fuel lines, vent lines, brake lines or wires.

4. Insert control switch wiring into the 3/4" hole on the corner post and run it down, out and under the vehicle body to the pump assembly. (See dashed line - FIG. 6-1.) Secure wiring to vehicle body using frame clips and/or loom clamps with self tapping screws (Kit items). Then, attach switch in correct position on corner post.

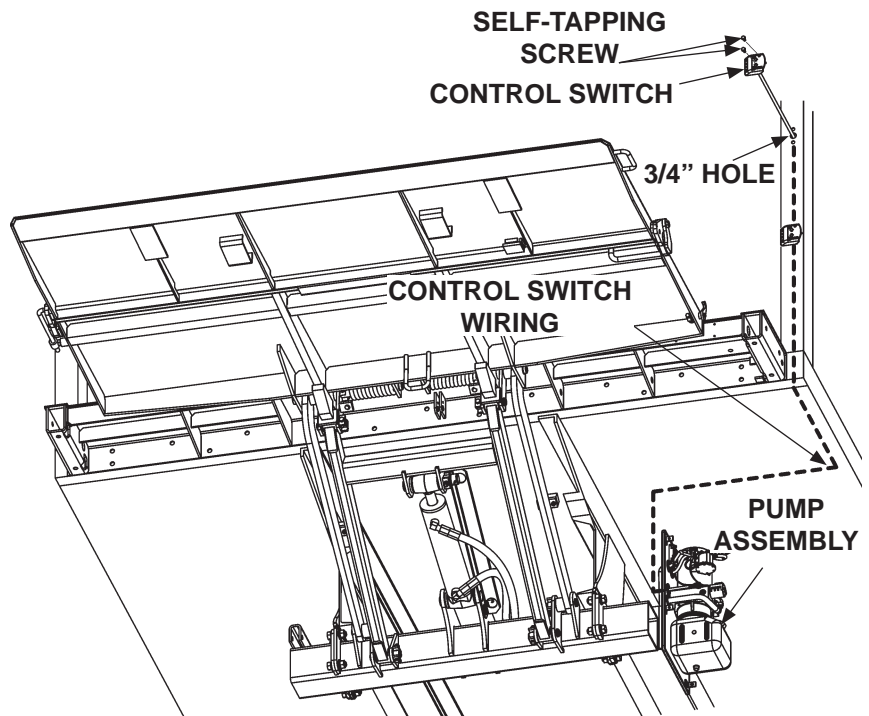

**CONTROL SWITCH WIRING
FIG. 6-1**

5. Unbolt and remove pump cover (FIG. 7-1).

6. Disconnect battery cable from starter solenoid (FIG. 7-1A). Remove existing grommet from pump mounting plate (FIG. 7-1A). Insert new grommet (Kit item) into pump mounting plate (FIG. 7-1B).

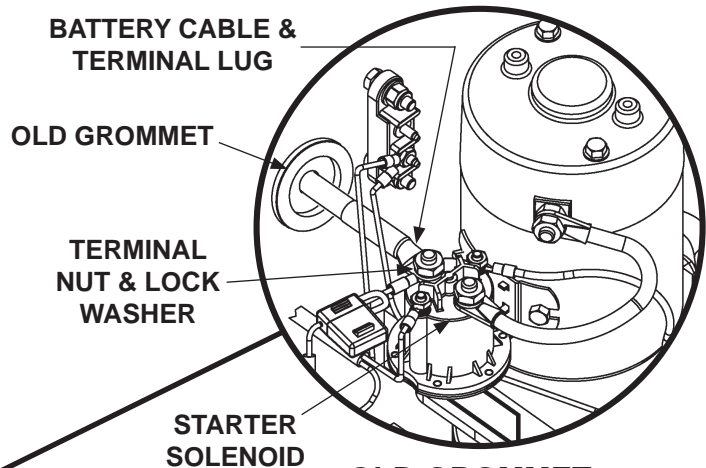

OLD GROMMET
FIG. 7-1A

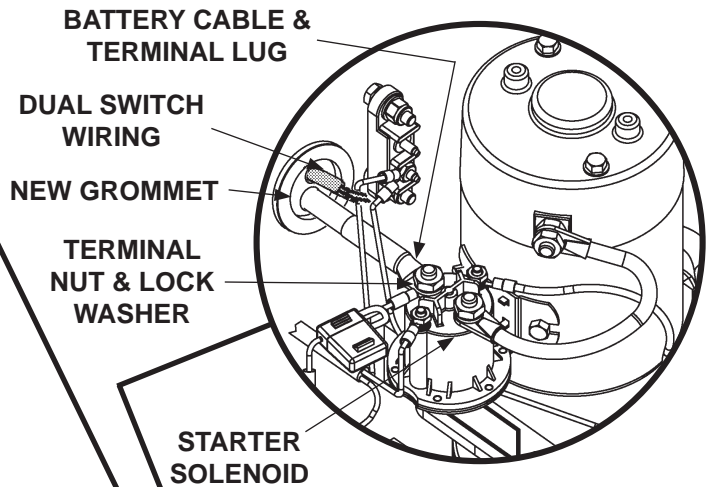

NEW GROMMET
FIG. 7-1B

CAUTION

Do not over-tighten the terminal nuts. For the 5/16" load terminals, torque nuts to 35 lb-in. Torque the nuts on #10-32 control terminals to 15 lb-in.

7. Insert switch wiring through new grommet on pump mounting plate (FIG. 7-1A). Then, connect the switch wiring to the junction block (FIG. 8-1) or power down module (FIG. 8-2) as shown on the next page.

8. Reconnect battery cable to starter solenoid (FIG. 7-1B).

9. Bolt on the pump cover as shown in FIG. 7-1.

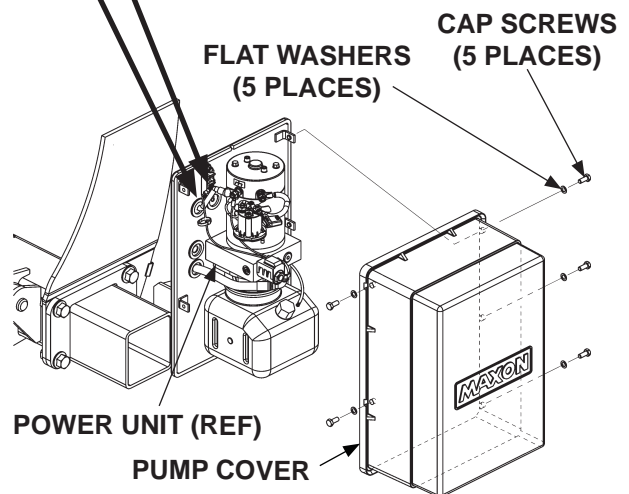

BOLTING / UNBOLTING PUMP COVER
FIG. 7-1

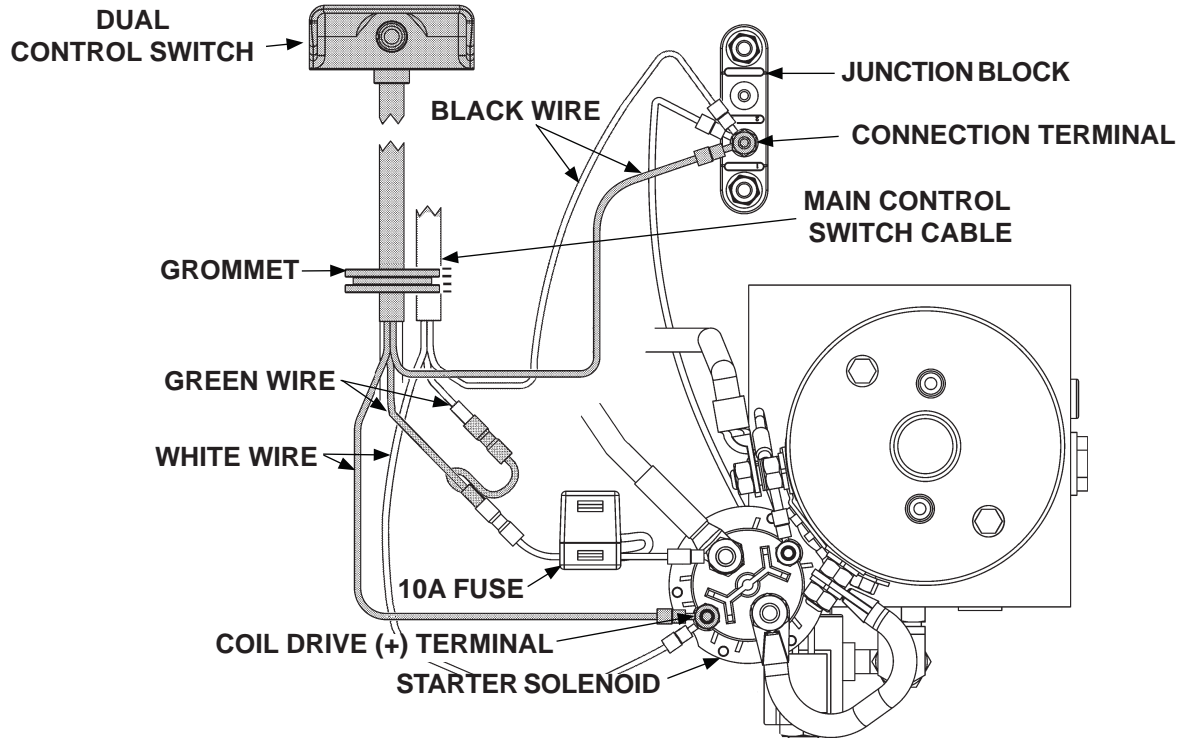

CONNECTING SECOND CABLE TO G/D PUMP
FIG. 8-1

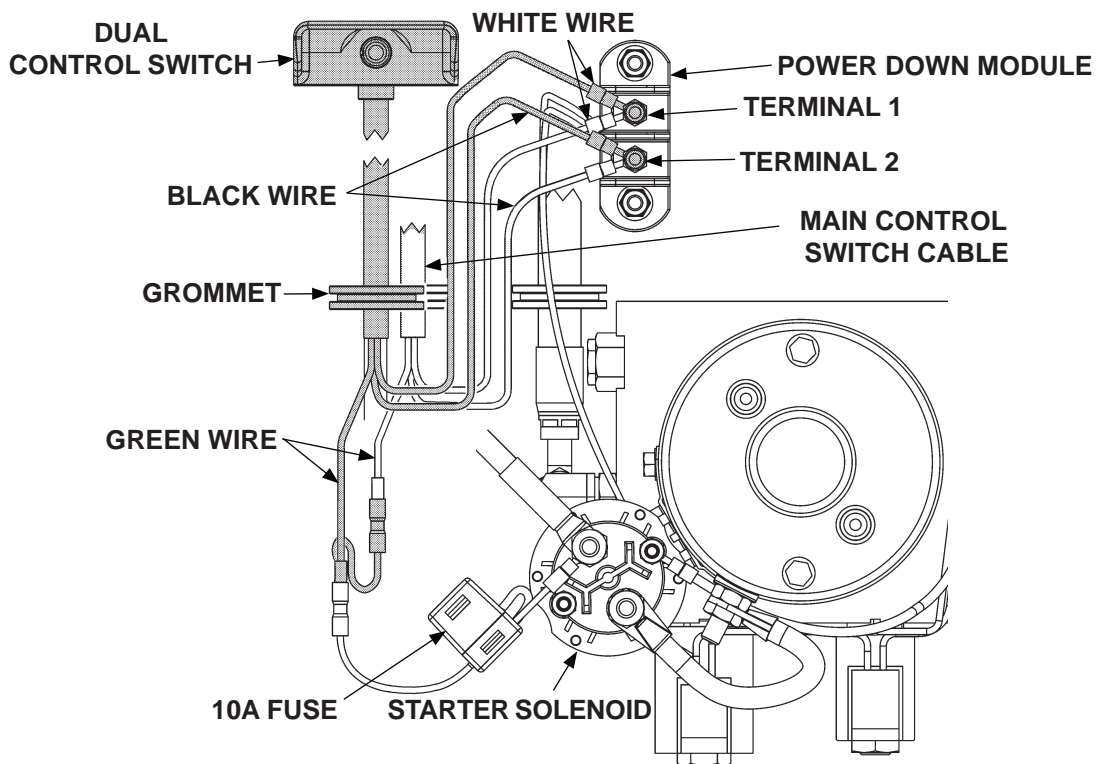

CONNECTING SECOND CABLE TO P/D PUMP
FIG. 8-2

10. Reconnect power to liftgate.
Remove nut from negative (-) battery terminal (**FIG. 9-1**).
Connect negative (-) battery cable to the negative (-) battery terminal (**FIG. 9-1**).
Install and tighten nut.

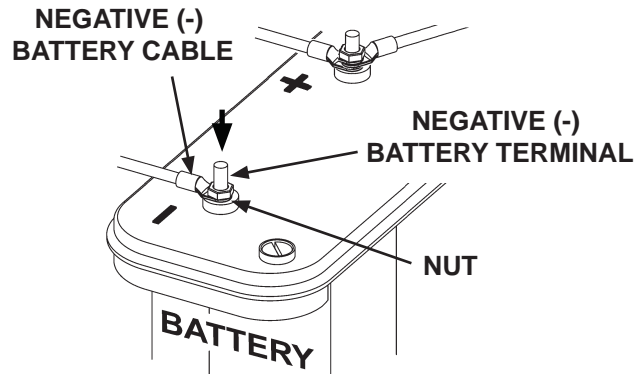

RECONNECTING POWER
FIG. 9-1

11. Verify street side control works correctly. Push switch to **UP** position to raise platform (**FIG. 9-2**).
Then, push switch to **DOWN** position (**FIG. 9-2**) to lower platform to the ground.

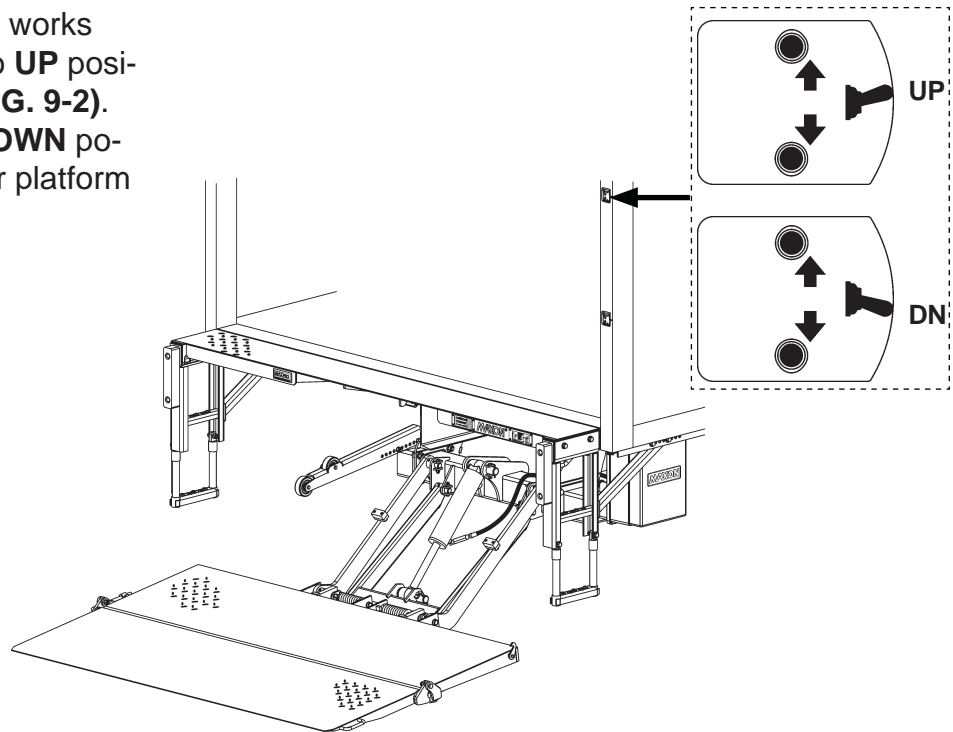

VERIFYING DUAL CONTROL SWITCH
FIG. 9-2