

INSTRUCTION, GPT CYCLE COUNTER KIT P/N 282520-02

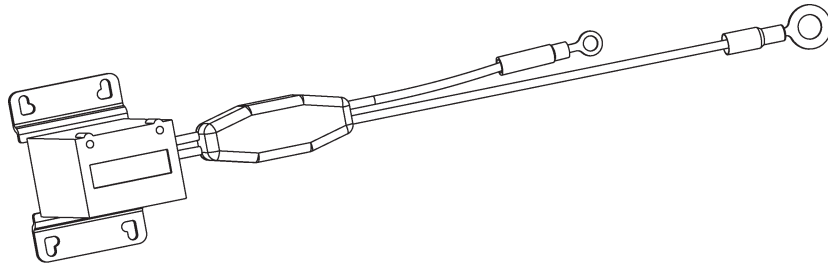

CYCLE COUNTER (ASSEMBLY)
P/N 280591-03
QTY. 1



PLASTIC TIE
P/N 208153
QTY. 2



POP RIVET
P/N 904000-1
QTY. 4

⚠ WARNING

To prevent personal injury and equipment damage, make sure power is disconnected from Liftgate while installing electrical parts.

1. Remove nut from positive (+) battery terminal connector. Disconnect the fused power cable (**FIG. 2-1**). Re-install nut.

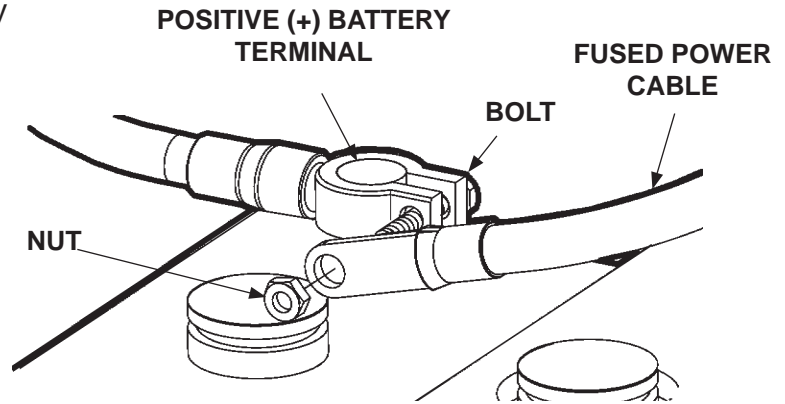

FIG. 2-1

2. Unbolt and remove pump cover (**FIG. 2-2**).

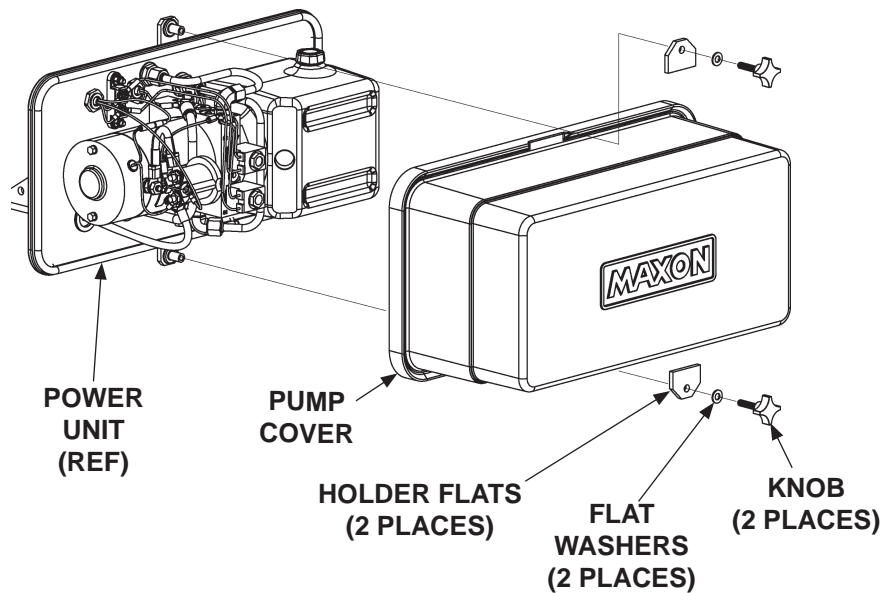
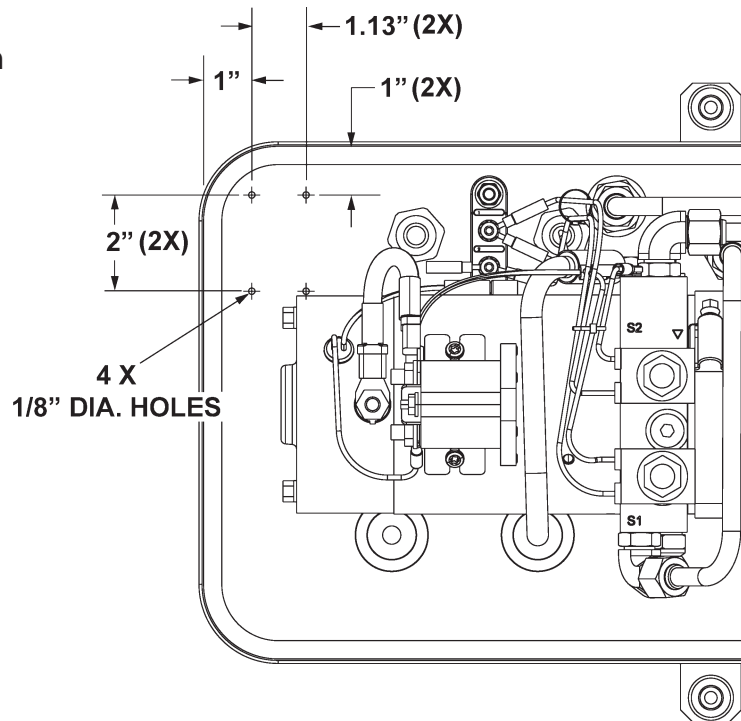

FIG. 2-2

3. Measure, mark and drill 4 holes in the pump mounting plate as shown in **FIG. 3-1**. Use 1/8" drill bit.



MEASURING AND MARKING HOLES
FIG. 3-1

4. Rivet the cycle counter assembly to the pump mounting plate (**FIG. 3-2**).

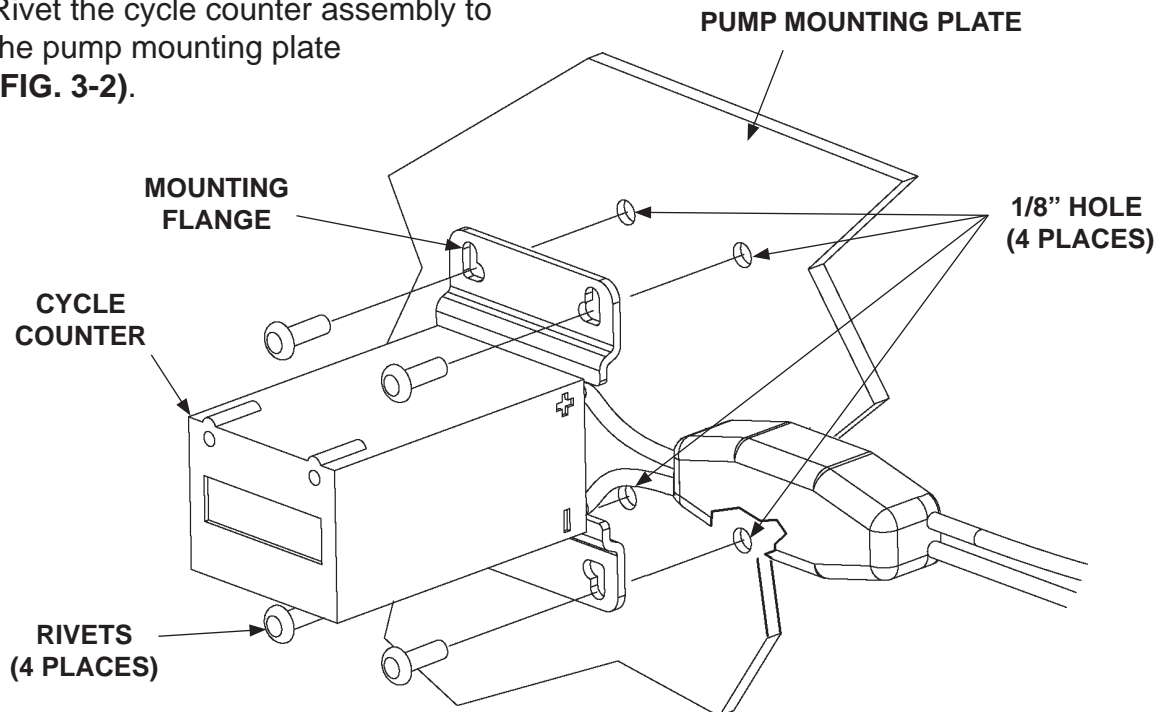
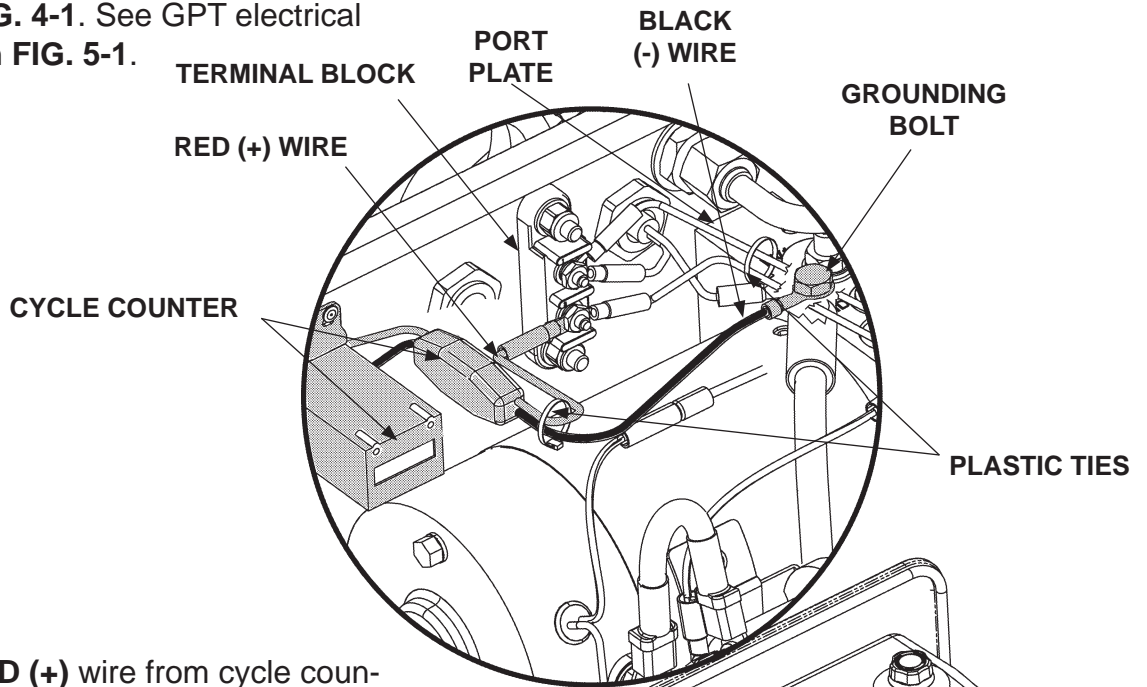

FIG. 3-2

5. Connect **BLACK (-)** wire from cycle counter to grounding point on port plate as shown in **FIG. 4-1**. See GPT electrical schematic in **FIG. 5-1**.



6. Connect **RED (+)** wire from cycle counter to terminal block. (**FIG. 4-1**). See GPT electrical schematic in **FIG. 5-1**.

7. Secure wiring with plastic ties (Kit items) as shown in **FIG. 4-1**.

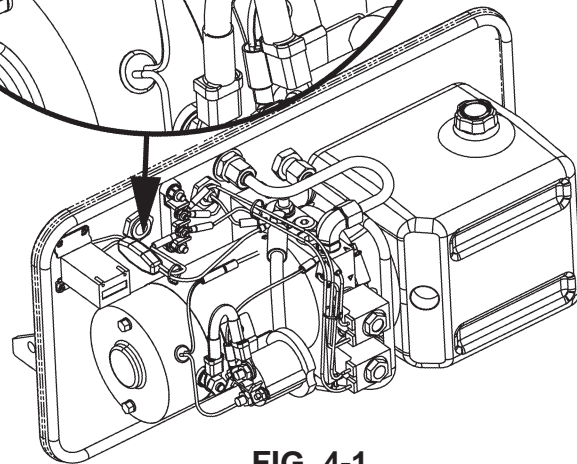

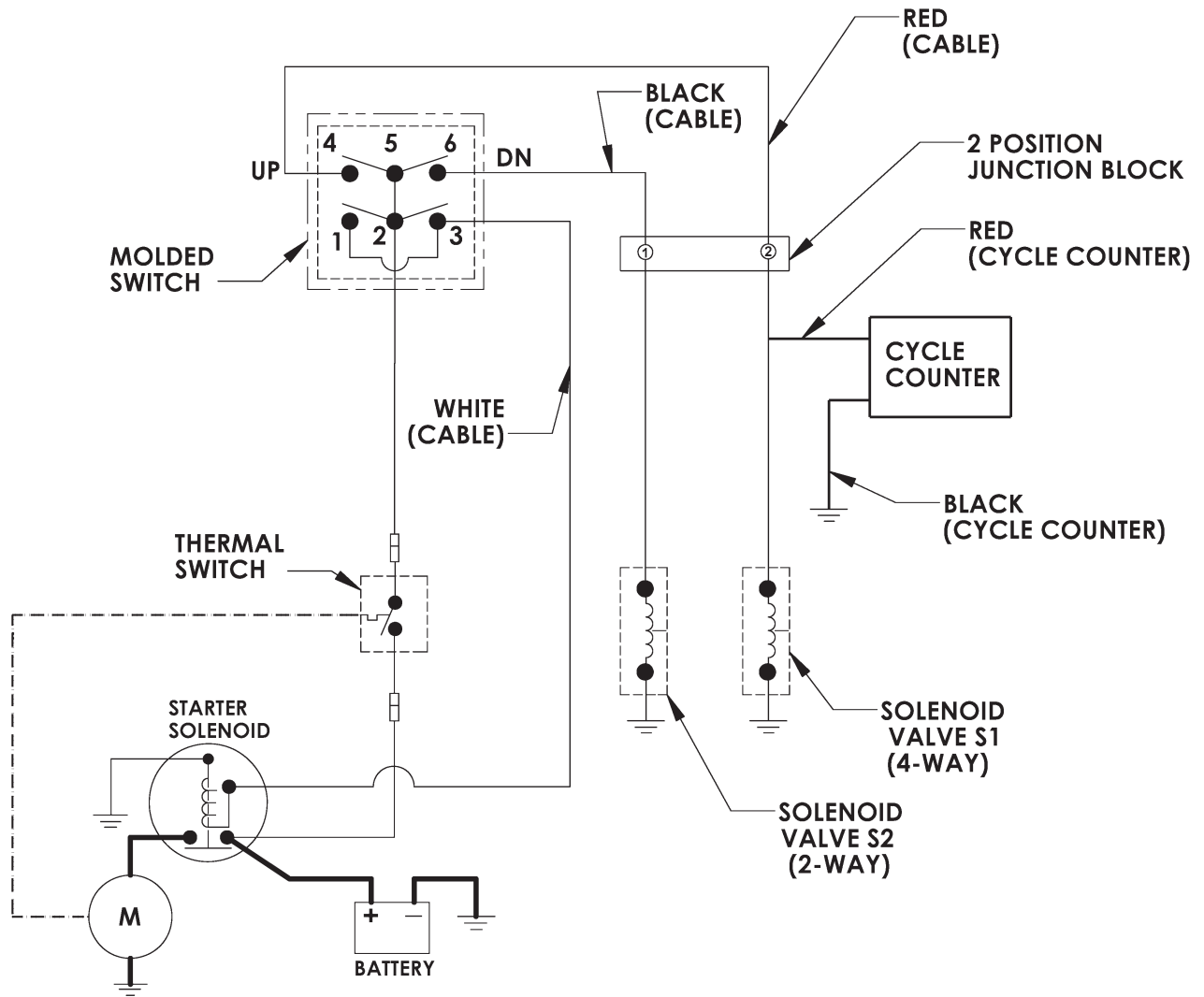

GPT ELECTRICAL SCHEMATIC WITH CYCLE COUNTER
FIG. 5-1

8. Reinstall nut from positive (+) battery terminal connector. Reconnect power cable to positive (+) battery terminal connector (**FIG. 6-1**). Reinstall and tighten nut.

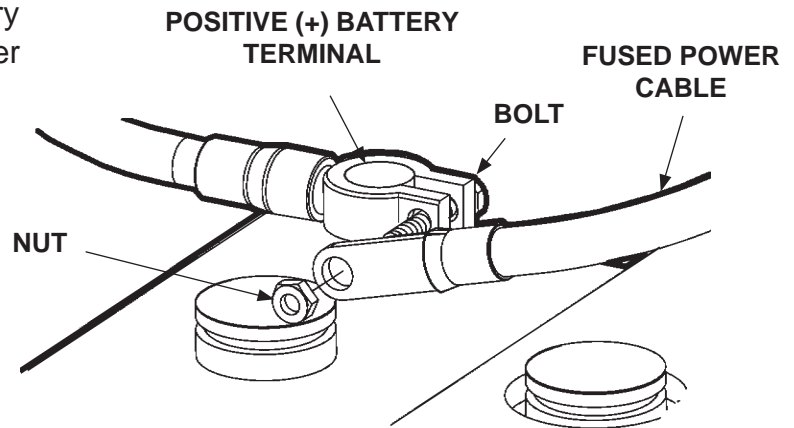

FIG. 6-1

9. Raise and lower Liftgate platform more than once (see **Liftgate Operation Manual**). Check number on cycle counter indicator (**FIG. 6-2**). The number of platform raise cycles must equal the number indicated on cycle counter.

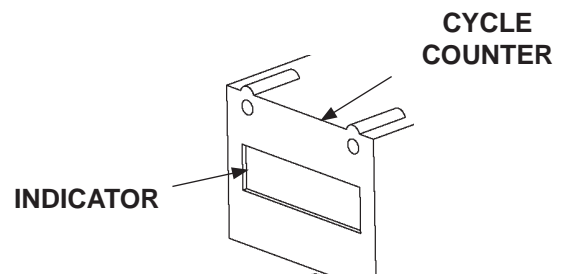

FIG. 6-2

10. Attach the pump cover as shown in FIG. 7-1. Hand tighten the threaded cover knobs.

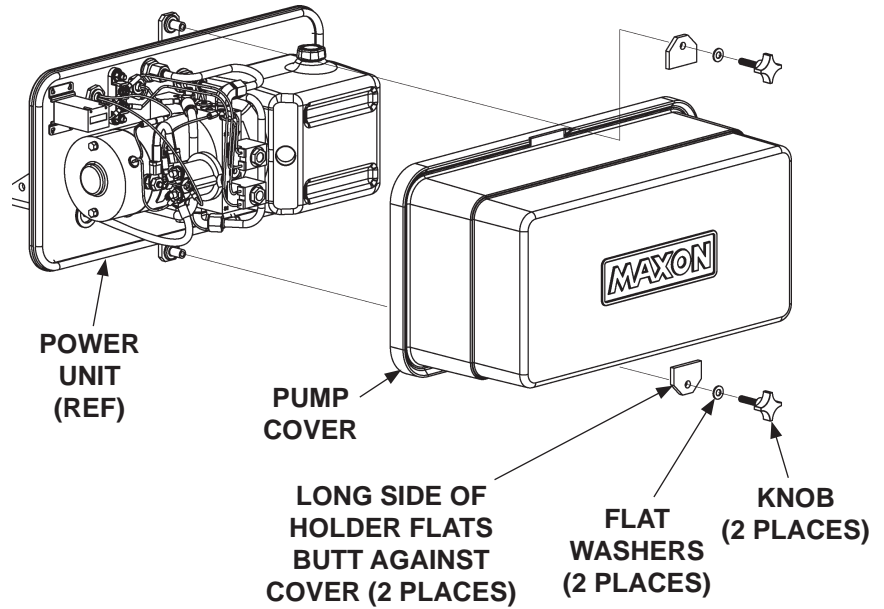

FIG. 7-1