

## INSTRUCTION, GPT HAND HELD CONTROL KIT KIT P/N 263260-12

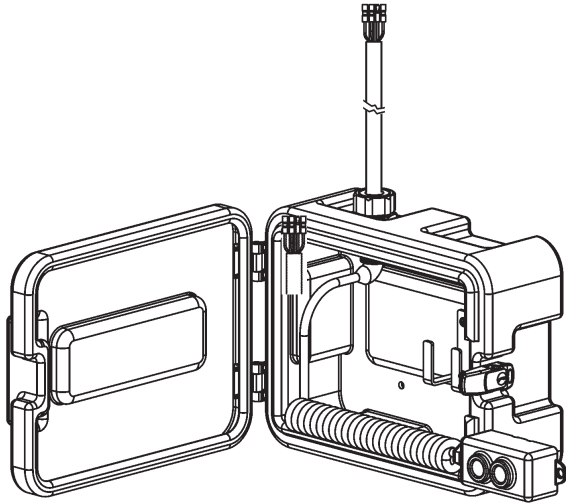

**PLASTIC ENCLOSURE (ASSEMBLED)**  
QTY. 1

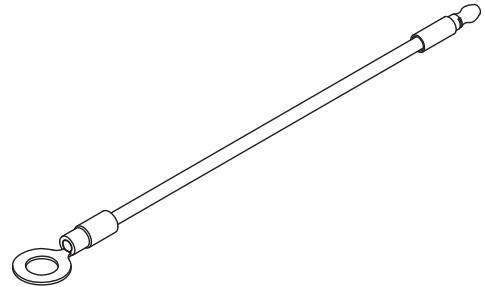

**WIRE ASSEMBLY**  
P/N 296293-01  
QTY. 1

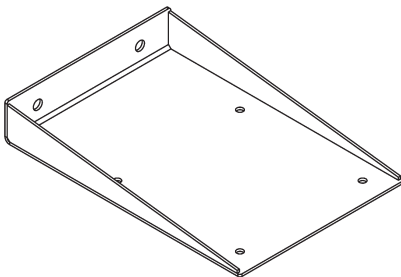

**ANGLE PLATE**  
P/N 263264-01  
QTY. 1

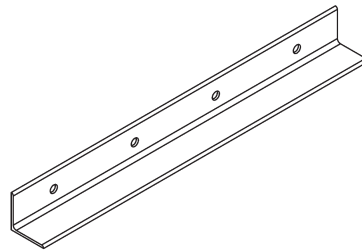

**ANGLE, 2" X 2" X 1/8" X 20" LG**  
P/N 263299  
QTY. 1



**GROMMET, 1" DIA.**  
P/N 266428-12  
QTY. 1

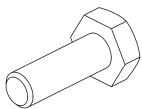

**CAP SCREW**  
1/4"-20 X 3/4" LG, GRADE 8  
P/N 900004-2  
QTY. 4

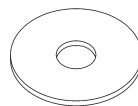

**WASHER, 1/4" X 7/8" O.D.**  
P/N 903438-01  
QTY. 8

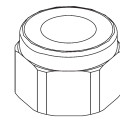

**LOCK NUT, 1/4"-20**  
P/N 901000  
QTY. 4

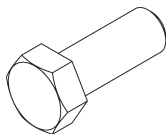

**HEX CAP SCREW**  
**3/8"-16 X 1" LG, GRADE 8**  
**P/N 900014-4**  
**QTY. 2**

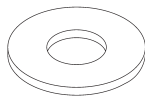

**FLAT WASHER, 3/8"**  
**P/N 902001-2**  
**QTY. 4**

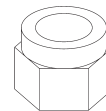

**LOCK NUT, 3/8"-16**  
**P/N 901002**  
**QTY. 2**

**PLASTIC ENCLOSURE ASSEMBLED**

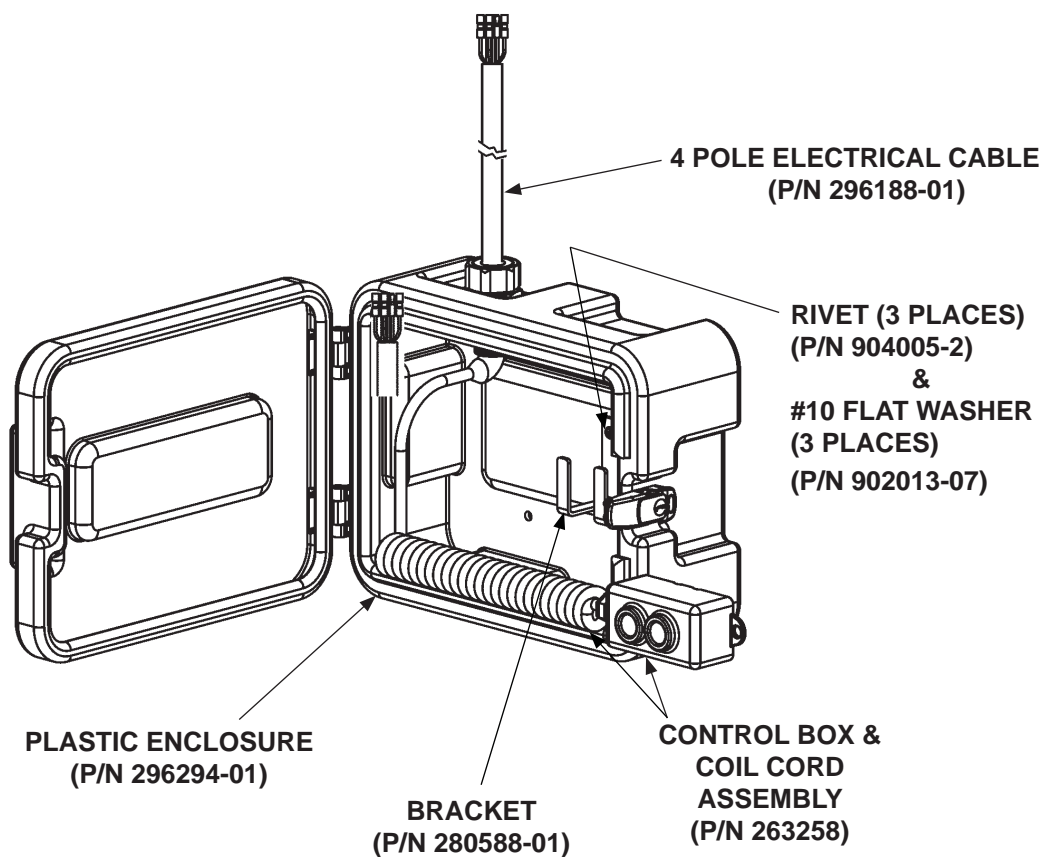

**⚠ WARNING**

Remove all rings, watches and jewelry before doing any electrical work.

**⚠ WARNING**

Never route an energized wire. Make sure battery is disconnected. Always route electrical wires clear of moving parts, brake lines, sharp edges and exhaust systems. Avoid making sharp bends in wiring. Attach securely. If drilling is necessary, first check behind the drilling surface so you do not damage any fuel lines, vent lines, brake lines or wires.

1. Disconnect power from pump box by disconnecting negative (-) battery cable from the battery.

**⚠ WARNING**

Recommended practices for welding on steel parts are contained in the current AWS (American Welding Society) D1.1 Structural Welding Code - Steel. Damage to Liftgate and/or vehicle, and personal injury can result from welds that are done incorrectly.

**⚠ CAUTION**

- Ensure the plastic enclosure with hand control is mounted near the RH rear of the vehicle body where the operator has a clear view of the Liftgate.
- Ensure the plastic enclosure, mounting angle, and mounting plate do not interfere with operation of Liftgate or allow enclosure to protrude from side of vehicle.
- Ensure interconnect cable will reach pump assembly without putting strain on the electrical connections.

2. Position the mounting angle (Kit item) under crossmembers of the vehicle body (**FIG. 4-1**).

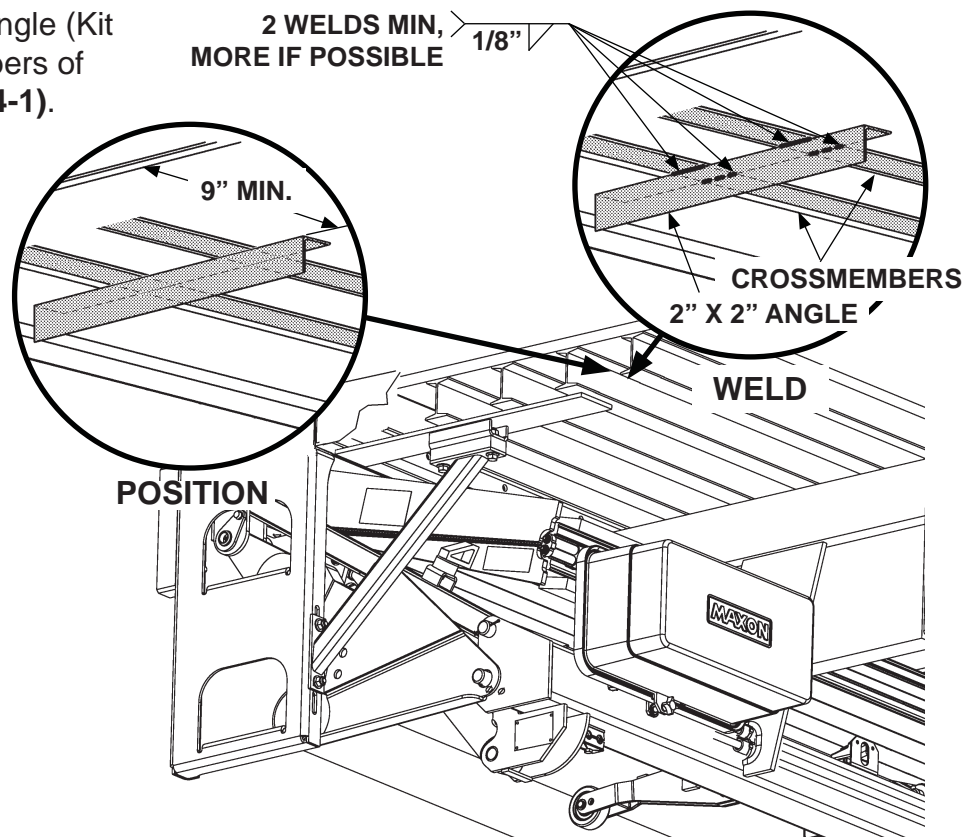

**POSITIONING MOUNTING ANGLE UNDER CROSSMEMBERS OF VEHICLE BODY  
FIG. 4-1**

3. Weld the angle to the truck/trailer cross members (**FIG. 4-1**).

**NOTE:** Angle plate can be bolted in 1 of 3 positions on the mounting angle.

4. Bolt the angle plate (Kit item) to angle (FIG. 5-1).

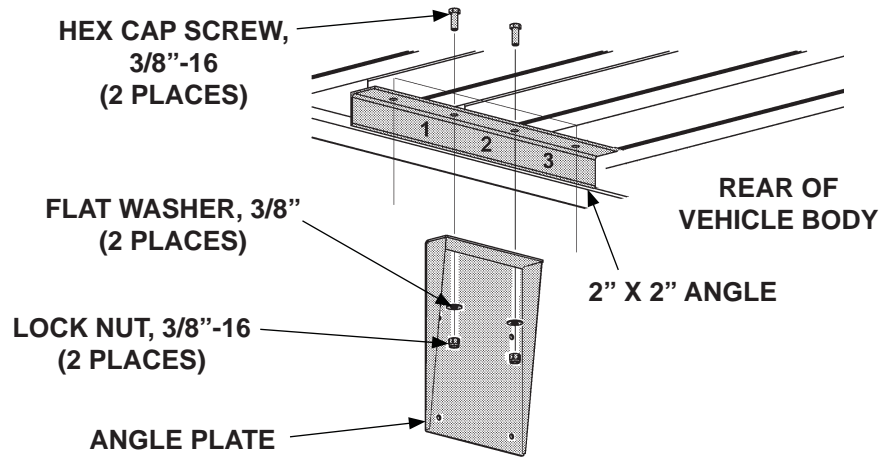

**BOLTING ANGLE PLATE TO ANGLE**  
**FIG. 5-1**

## CAUTION

Allow welds to cool before attaching plastic enclosure.

5. Bolt plastic enclosure (Kit item) to the angle plate (FIG. 5-2).

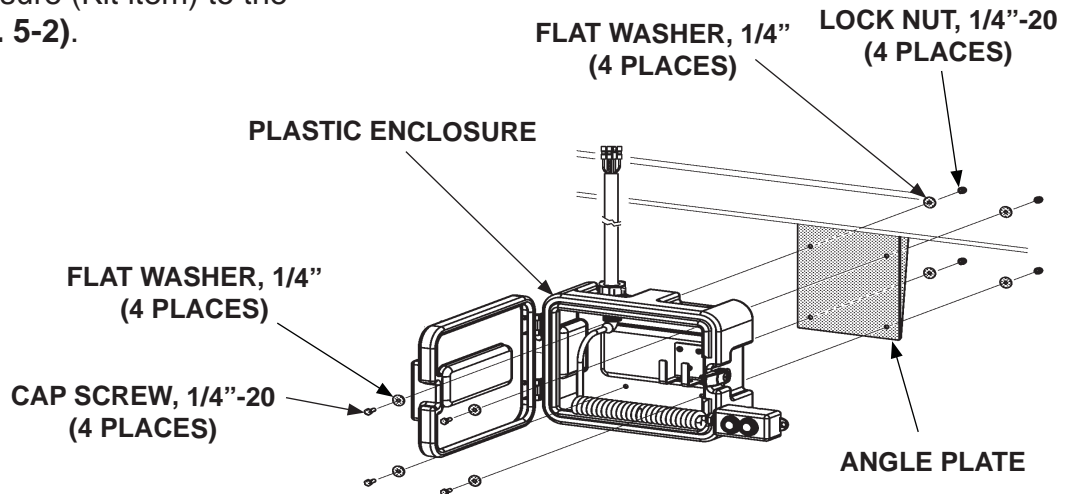

**BOLTING ENCLOSURE TO ANGLE PLATE**  
**FIG. 5-2**

6. Disconnect ground cable from pump mounting bracket (**FIG. 6-1**). Next remove old grommet from pump mounting plate (**FIG. 6-1**).

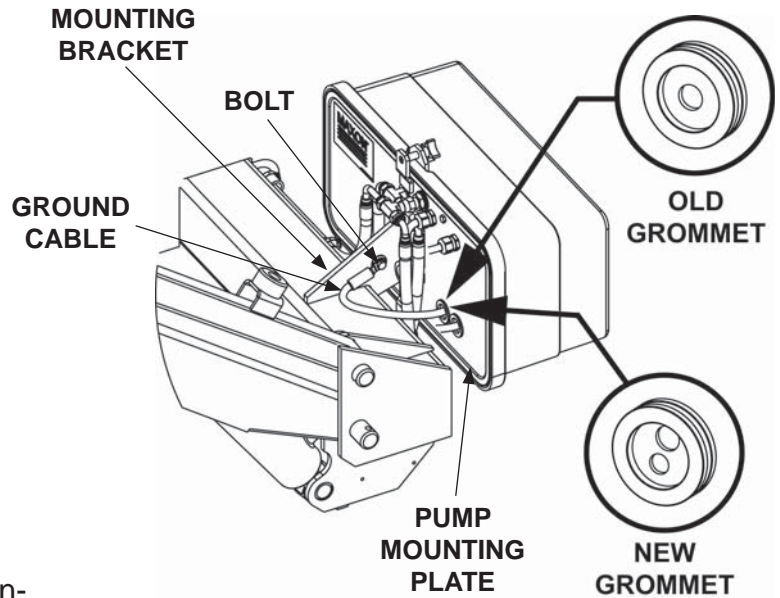

**REPLACING GROMMET**  
**FIG. 6-1**

7. Insert ground cable through new grommet (Kit item) (**FIG. 6-1**). Next, insert new grommet in the pump mounting plate (**FIG. 6-1**). Then, reconnect ground cable to pump mounting bracket (**FIG. 6-1**).

8. Route electrical control cable from plastic enclosure (**FIG. 6-2**) to the new grommet on the pump mounting plate (**FIG. 6-1**).

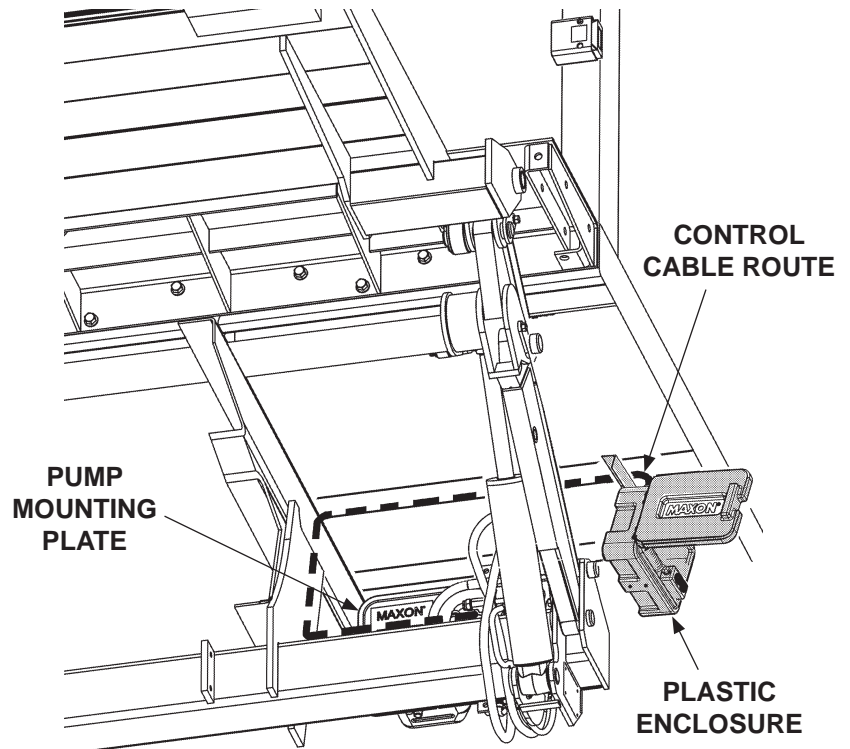

**ROUTING ELECTRICAL CABLE**  
**UNDER VEHICLE BODY**  
**FIG. 6-2**

9. Unbolt and remove pump cover (FIG. 7-1).

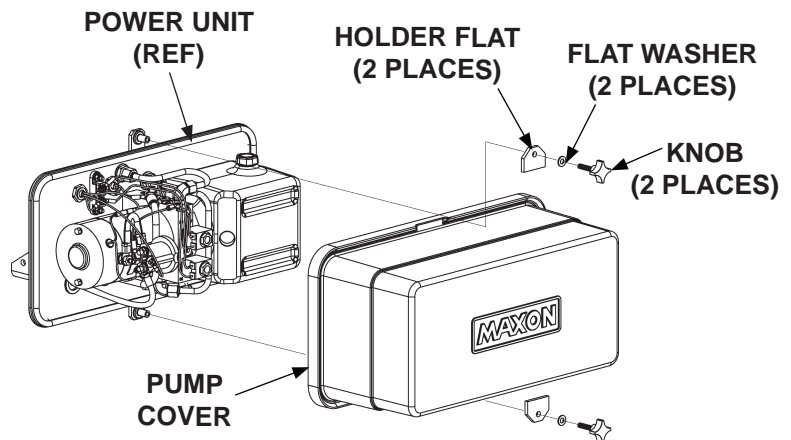

**BOLTING / UNBOLTING PUMP COVER**  
**FIG. 7-1**

10. Insert electrical control cable through new grommet on pump mounting plate (FIG. 7-1). Then, connect the switch wiring to the junction block as shown on the next page in FIG. 7-2.

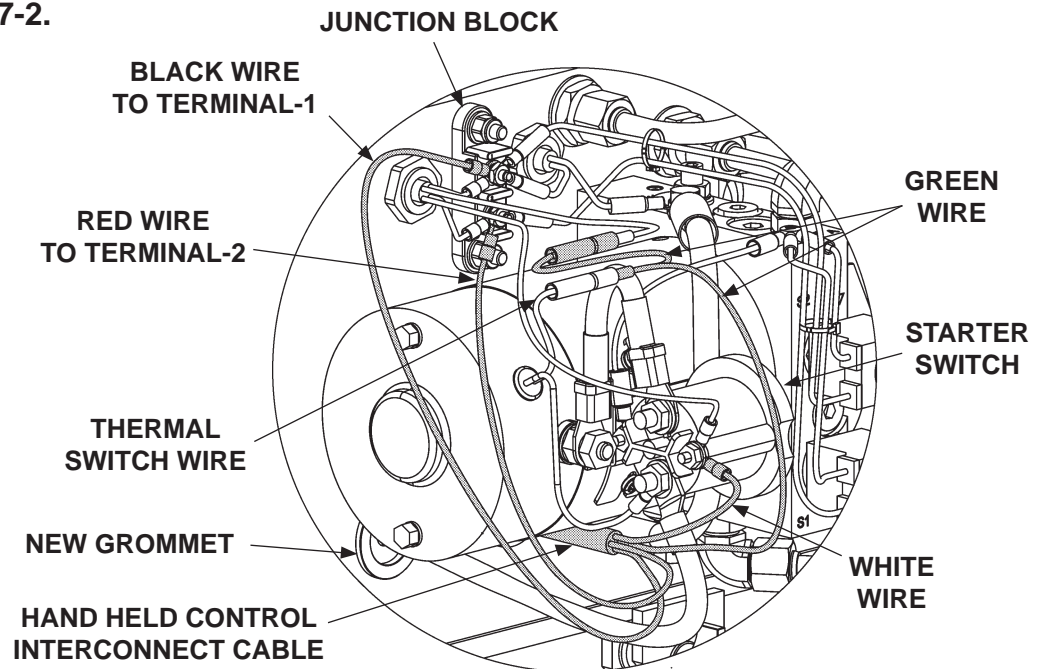

**CONTROL SWITCH WIRING CONNECTIONS**  
**FIG. 7-2**

11. Bolt on the pump cover as shown in FIG. 7-1.
12. Reconnect the negative (-) battery cable to battery.

13. Unfold platform. Then use standard control switch to lower platform to the ground (**FIG. 8-1**). Refer to **GPT Operation Manual** for detailed operating instructions.

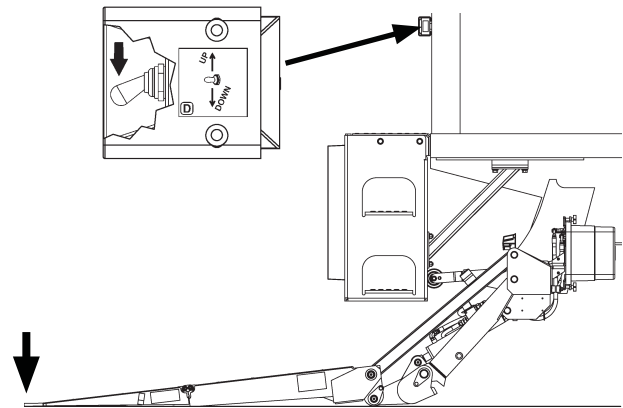

**PLATFORM UNFOLDED & LOWERED TO THE GROUND**  
**FIG. 8-1**

14. Check operation with hand held control. Raise platform (**FIG. 8-2**) and lower platform (**FIG. 8-3**).

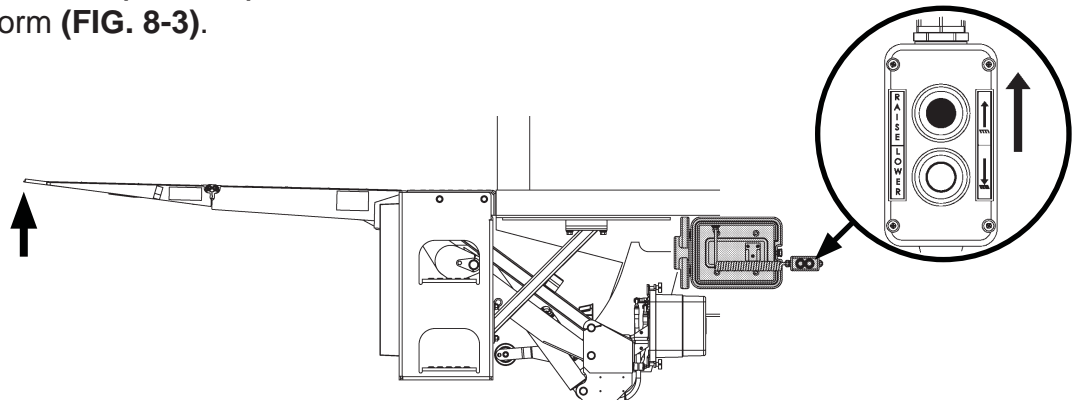

**RAISING PLATFORM WITH HAND HELD CONTROL**  
**FIG. 8-2**

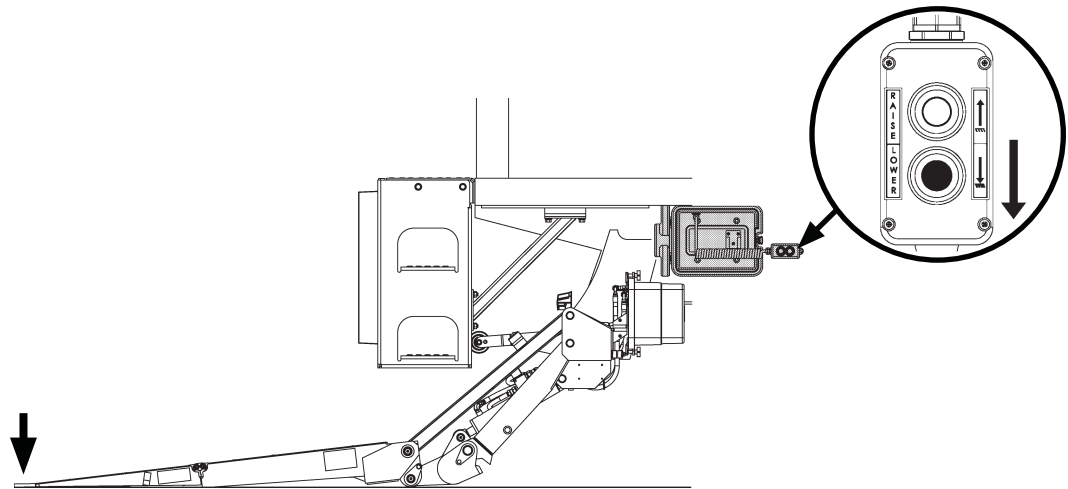

**LOWERING PLATFORM WITH HAND HELD CONTROL**  
**FIG. 8-3**