

INSTRUCTIONS, C2 CYLINDER REPLACEMENT

C2-54" & C2-60" REPLACEMENT CYLINDER KIT, P/N 295454-01 (971)

C2-92" REPLACEMENT CYLINDER KIT, P/N 295489-01 (2559)

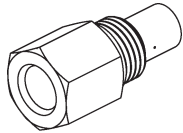

CYLINDER FLOW VALVE
P/N 906934-01
QTY. 1

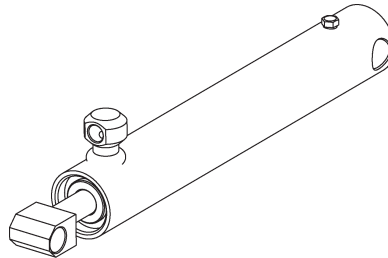

CYLINDER ASSEMBLY
(C2-54" & C2-60" KIT)
P/N 289402-01
(C2-92" KIT)
P/N 295297-01
QTY. 1

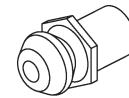

**1/4" SELF DRILL
GREASE FITTING**
P/N 224342
QTY. 1



RETAINING RING,
3/4" DIA.
P/N 906107-01
QTY. 2

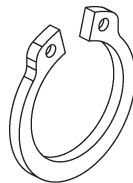

RETAINING RING,
7/8" DIA.
P/N 906107-02
QTY. 1



CAUTION DECAL
ISO-32 OIL
P/N 295317
QTY. 1



FLAT WASHER, 3/4" O.D. X .032" THK.
(C2-54" & C2-60" KIT ONLY)
P/N 902000-19
QTY. 1



FLAT WASHER, 3/4" O.D. X .090" THK.
P/N 902000-20
QTY. 1

⚠ WARNING
Remove all rings, watches and jewelry before doing any electrical work.

⚠ WARNING
To prevent accidental personal injury and equipment damage, disconnect (-) battery cable from battery.

1. Unfold the platform and activate Liftgate. Refer to **C2 Operation Manual**.
2. Lower the platform on supports, making sure the platform heel is supported (**FIG. 2-1**).

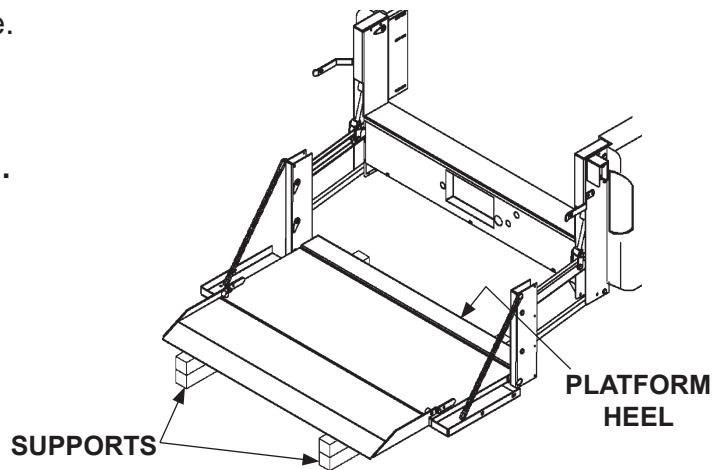

SUPPORTING LIFTGATE & RELEASING PRESSURE
FIG. 2-1

3. Disconnect ground (-) battery cable from vehicle battery.
4. If replacing RH cylinder, unbolt control switch to the RH column (**FIG. 2-2**) and allow it to hang by the control cable.

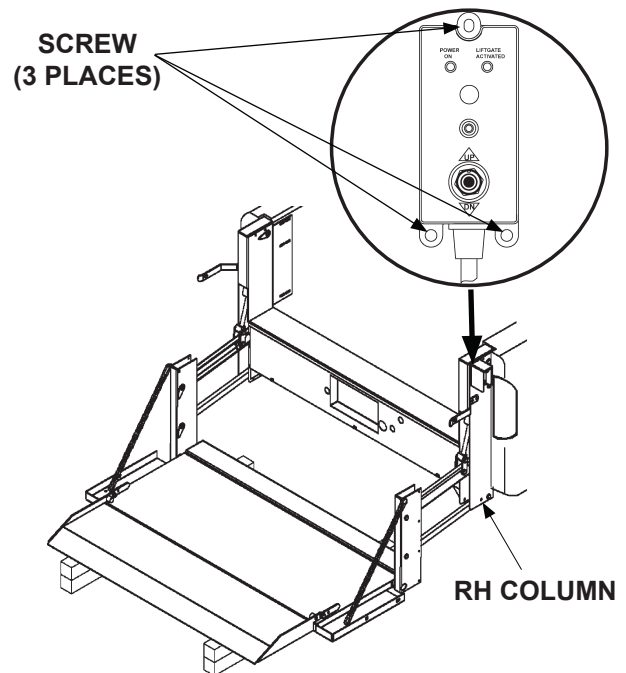

UNBOLTING CONTROL SWITCH
FIG. 2-2

5. Unfasten cover and remove from front of Liftgate as shown in **FIG. 3-1**.

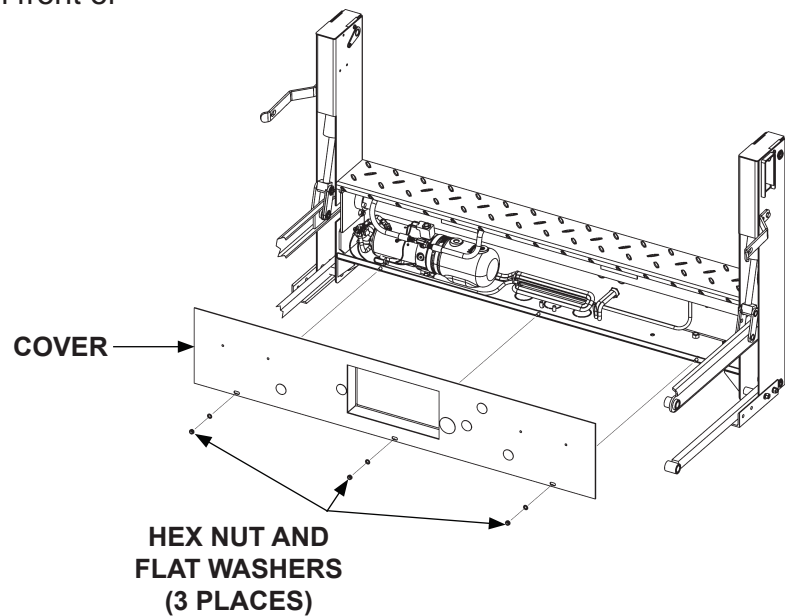

UNBOLTING & REMOVING COVER
FIG. 3-1

NOTE: Place a rag under the tee to absorb hydraulic oil. Place the end of the hydraulic hose over a bucket to drain remaining hydraulic fluid from the cylinder.

6. Disconnect hydraulic hose for RH or LH cylinder at the tee for RH or LH cylinder to be replaced (**FIG. 3-2**).

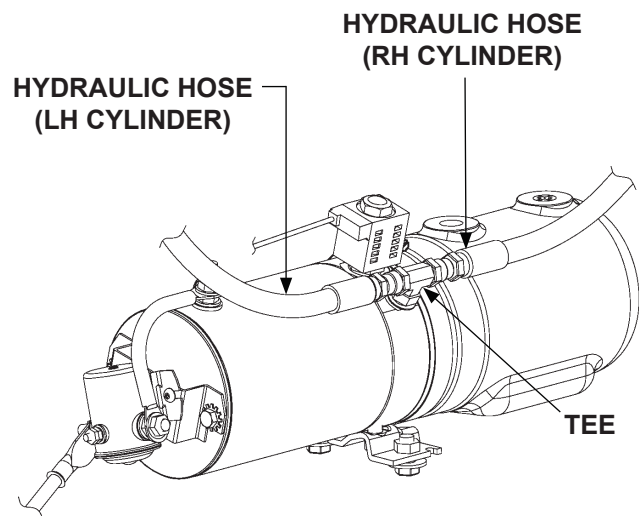

**DISCONNECTING
HYDRAULIC HOSE**
FIG. 3-2

7. Remove the master link from the cylinder rod and lift arm by removing the retaining rings, link plate and flat washer (**FIG. 4-1**).

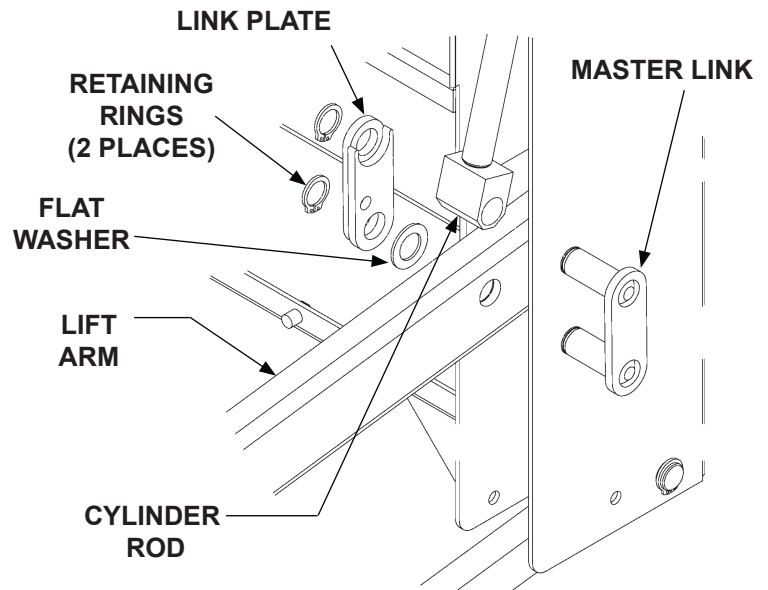

**REMOVING MASTER LINK
(RH LIFT ARM SHOWN)
FIG. 4-1**

8. Unbolt the cover from RH column and/or LH column for the cylinder to be replaced (**FIG. 4-2**).

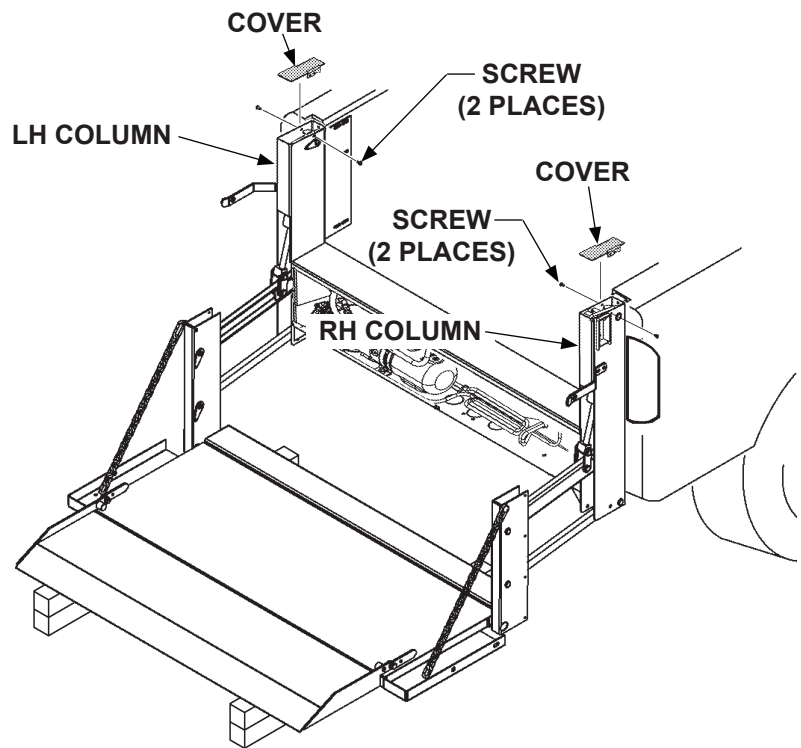

**UNBOLTING COLUMN COVER
FIG. 4-2**

NOTE: Observe how the hydraulic hose is routed in the column for reconnecting hydraulic pump.

- 9. Remove retaining ring from upper pin on cylinder. Next, unbolt pin from column. Then, remove pin securing cylinder to column (**FIG. 5-1**).

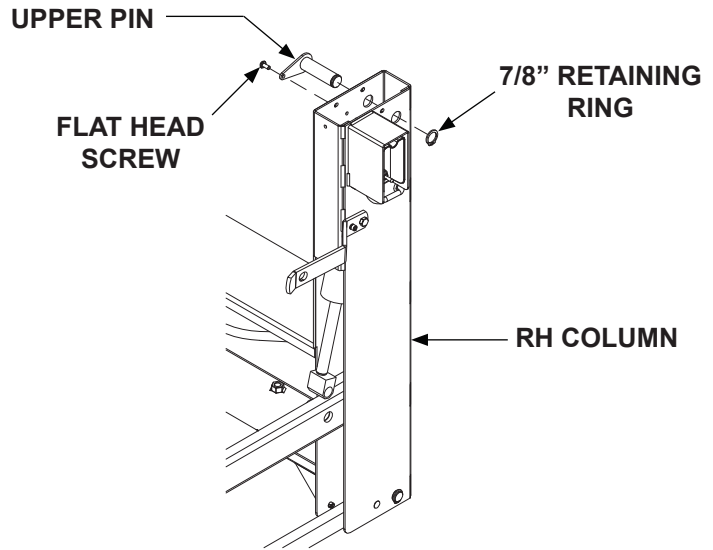

**REMOVING UPPER PIN FROM CYLINDER
(RH COLUMN SHOWN)
FIG. 5-1**

- 10. Remove cylinder and hose through top of the column (**FIG. 5-2**).

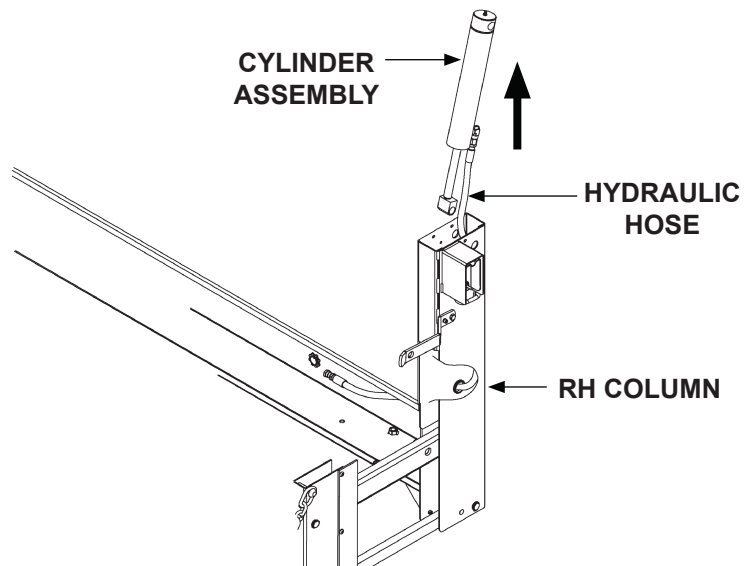

**REMOVING CYLINDER & HOSE FROM COLUMN
(RH COLUMN SHOWN)
FIG. 5-2**

11. Disconnect hose from the cylinder (FIG. 6-1).

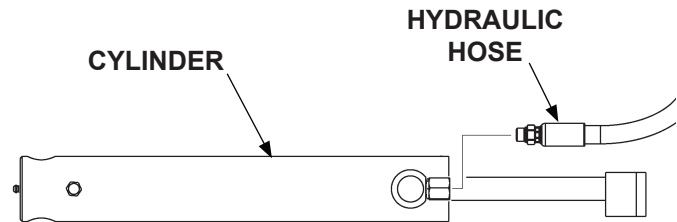

**DISCONNECTING HOSE FROM CYLINDER
FIG. 6-1**

12. Insert new 1/4" grease fitting (Kit item) at end of cylinder (Kit item) (FIG. 6-2).
13. Connect new flow valve (Kit item) to cylinder assembly (Kit item) (FIG. 6-2).
14. Lubricate connector o-ring on the end of hydraulic hose (FIG. 6-2). Then, connect hose to flow valve on cylinder (FIG. 6-2). Tighten hose connector securely (FIG. 6-2).

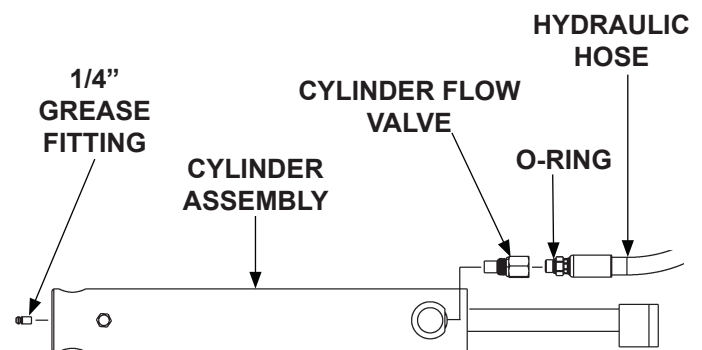

**INSERTING GREASE FITTING /
CONNECTING FLOW VALVE & HOSE
TO NEW CYLINDER
FIG. 6-2**

15. Extend cylinder rod so the end is 6" from cylinder (**FIG. 7-1**).
16. Rotate the cylinder rod so the widest portion of the rod end is toward outboard side of column (**FIG. 7-1**).
17. Insert new cylinder and hose through top of RH or LH column (**FIG. 7-1**). Then, route hose end through grommet on the inboard side of RH or LH column (**FIG. 7-1**).

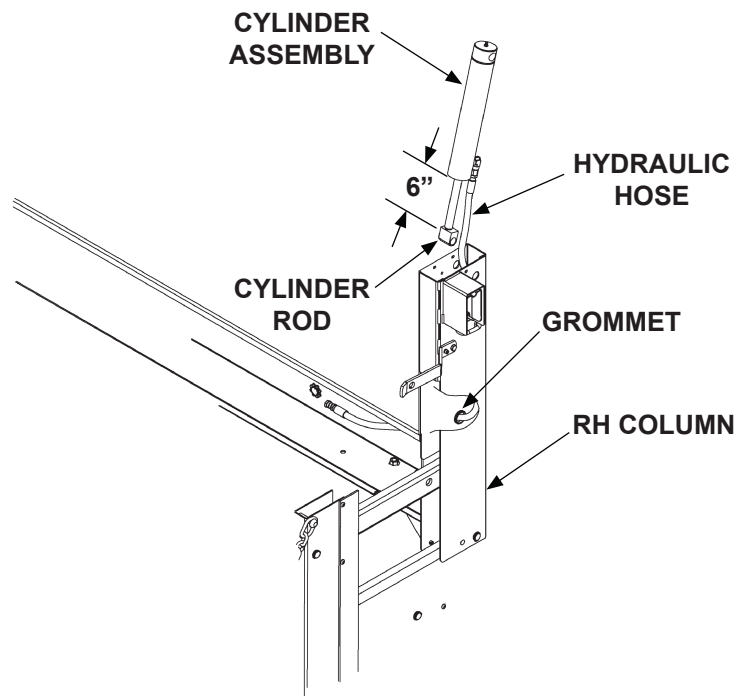

**INSERTING CYLINDER & HYDRAULIC HOSE
(RH COLUMN SHOWN)
FIG. 7-1**

18. Attach upper end of cylinder to column with pin, flat head screw, and retaining ring (Kit item) (FIG. 8-1).

NOTE: MAXON does not supply grease.

19. Apply grease to the pins of the master link (FIG. 8-2). Then, connect the cylinder rod to lift arm with the master link and washers (FIG. 8-2). Secure the master link with link plate and 2 new 3/4" retaining rings (Kit items) (FIG.8-2).

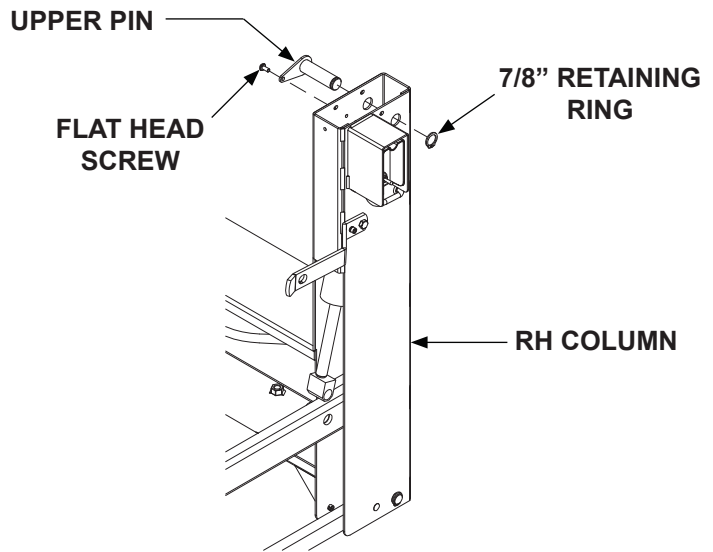

**INSTALLING UPPER PIN
(RH COLUMN SHOWN)
FIG. 8-1**

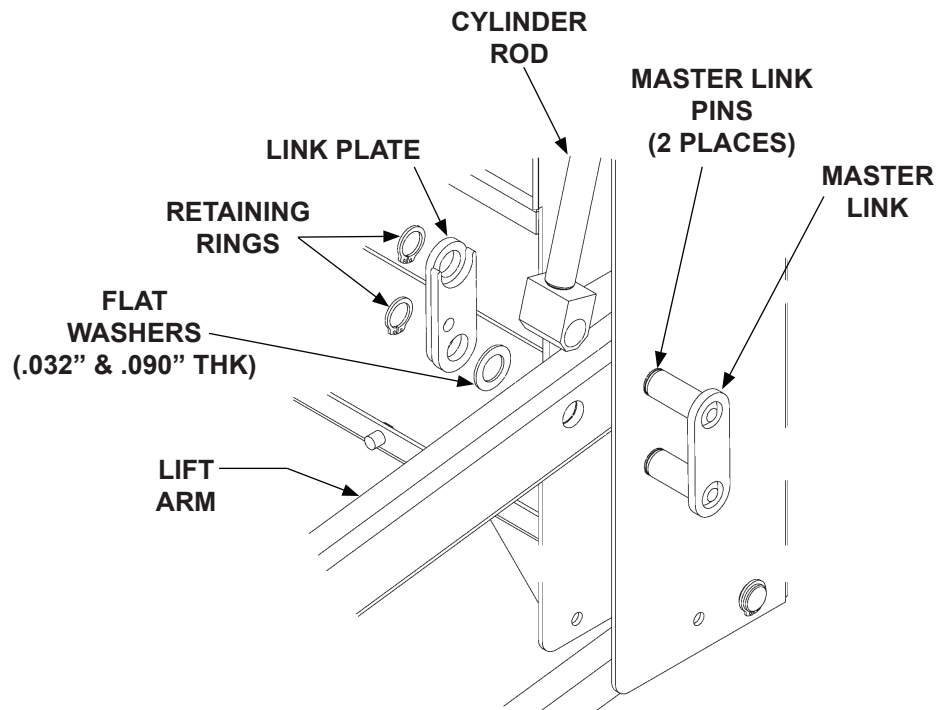

**CONNECTING CYLINDER ROD TO LIFT ARM
FIG. 8-2**

NOTE: Do not twist the hydraulic hoses during installation. Twisted hoses may fail prematurely.

20. Connect the hydraulic hose to tee (FIG. 9-1).

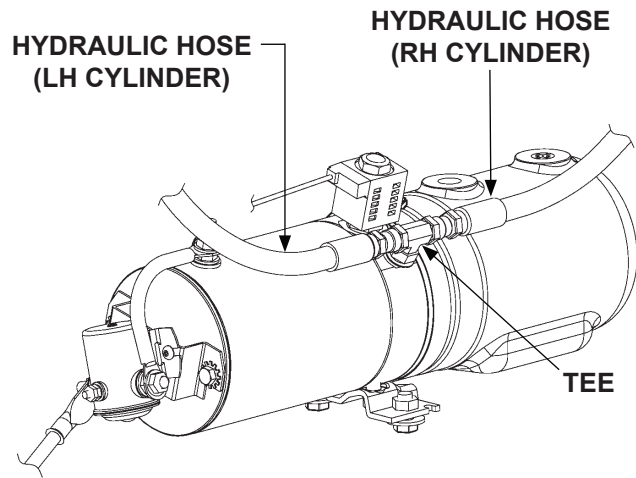

**RECONNECTING HYDRAULIC HOSE
FIG. 9-1**

21. If control switch was removed, bolt control to the RH column (FIG. 9-2).

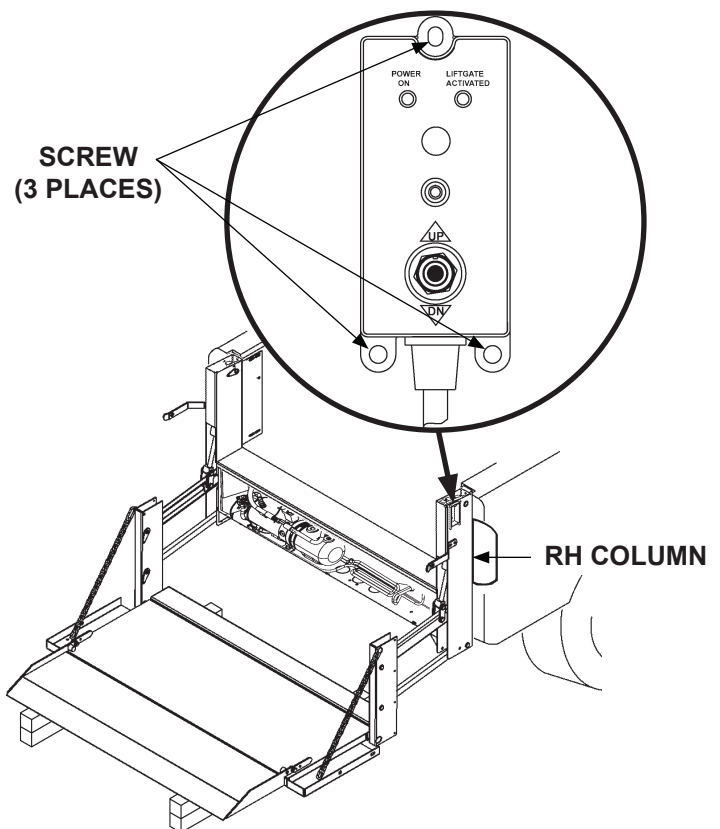

**REINSTALLING CONTROL SWITCH
FIG. 9-2**

22. Apply grease in the fitting on the cylinder (FIG. 10-1).

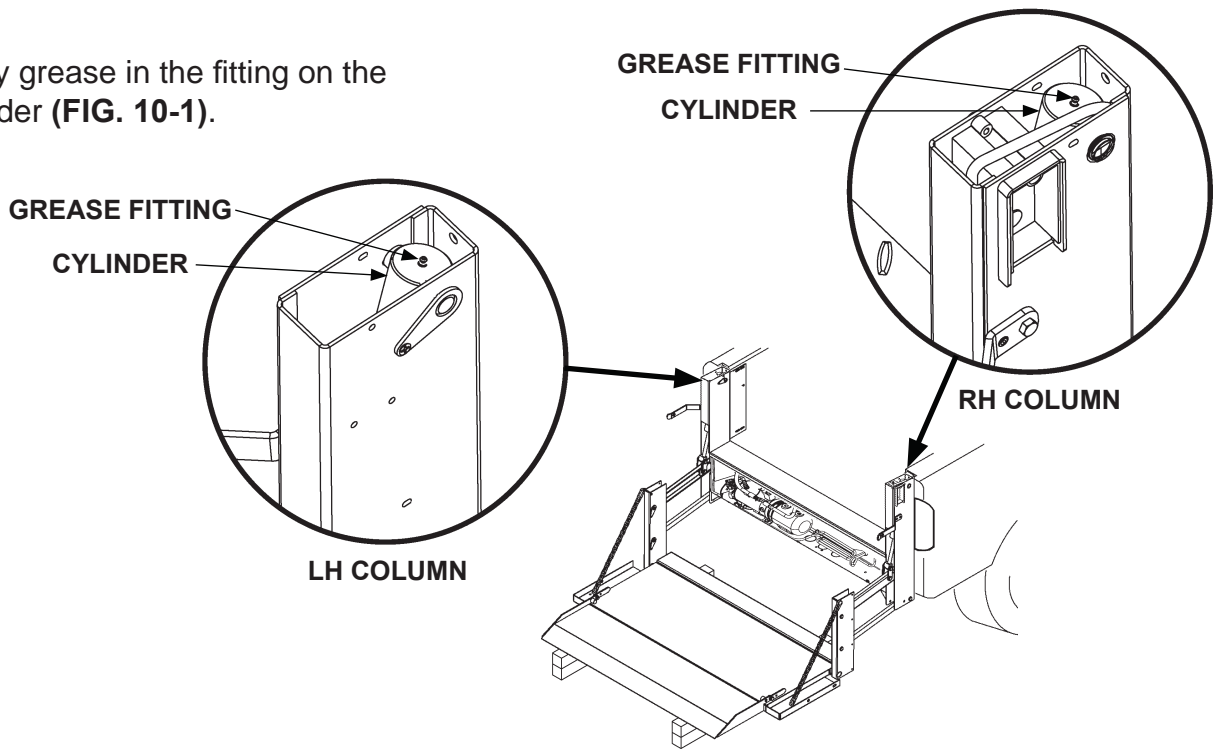

**APPLYING GREASE TO FITTING
FIG. 10-1**

23. Bolt cover to column (FIG. 10-2).

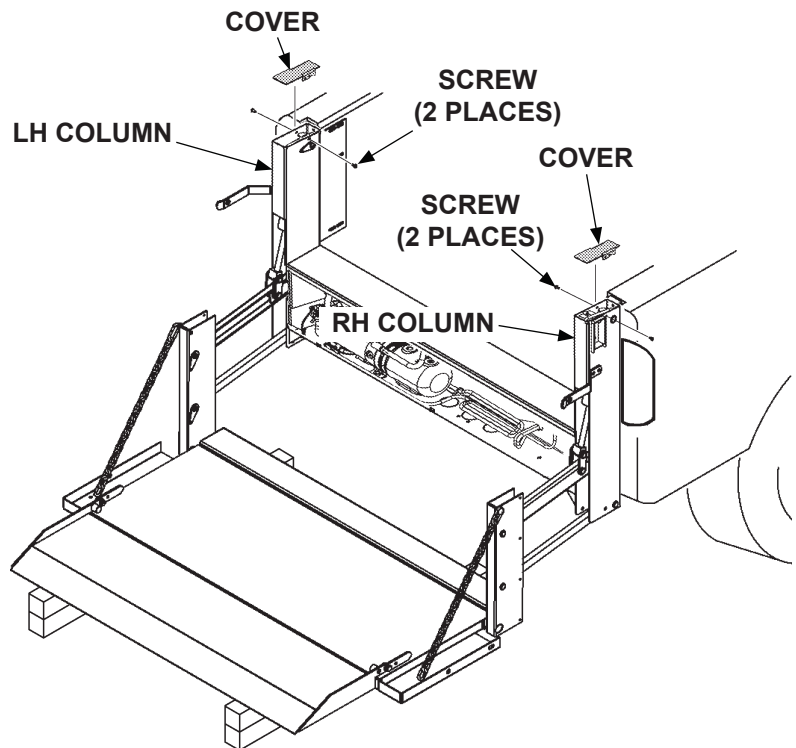

**REINSTALLING COLUMN COVER
FIG. 10-2**

CAUTION

Use ISO Grade 32 hydraulic oil only. Any other oil will void cylinder warranty.

24. Check and add oil to the hydraulic reservoir. Then, inspect hydraulic lines and fittings for leaks.
25. Fasten cover to housing (**FIG. 11-1**). Then, apply **CAUTION** decal (Kit item) to cover (**FIG. 11-1**).
26. Reconnect ground (-) battery cable to vehicle battery.

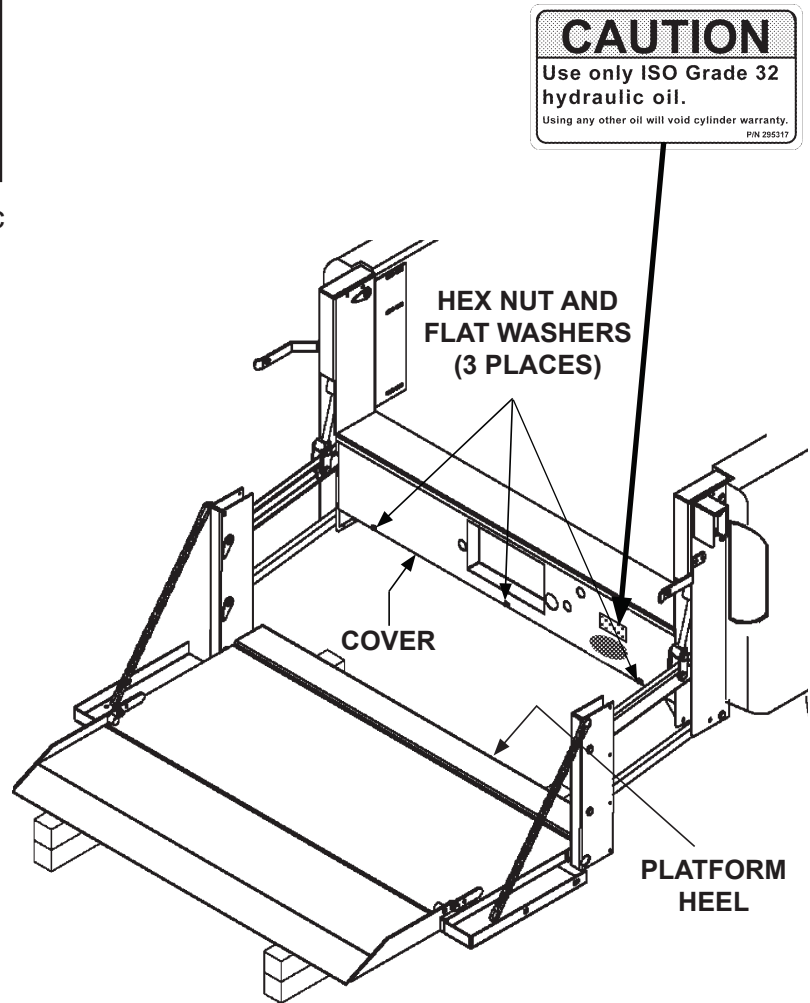

**REINSTALLING COVER & APPLYING
CAUTION DECAL
FIG. 11-1**

NOTE: Refer to **C2 Operation Manual** for detailed instructions on operating the Liftgate.

27. Activate Liftgate. Then, raise platform to bed height and stow the platform. Remove supports from under the platform.