

## INSTRUCTIONS, C2 PUMP REPLACEMENT

**KIT (2050 PSI PUMP), P/N 296416-01 (968)**

**KIT (2350 PSI PUMP), P/N 296417-01 (969)**

**KIT (2500 PSI PUMP), P/N 296418-01 (970)**

**KIT (3400 PSI PUMP), P/N 296419-01 (4363)**

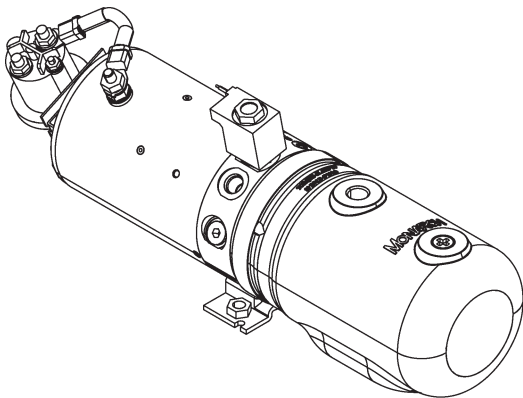

**PUMP & MOTOR (2050 PSI)  
P/N 296412-01**

**PUMP & MOTOR (2350 PSI)  
P/N 296413-01**

**PUMP & MOTOR (2500 PSI)  
P/N 296414-01**

**PUMP & MOTOR (3400 PSI)  
P/N 296415-01  
QTY. 1**

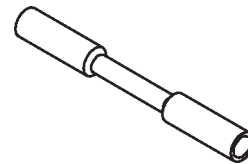

**BUTT SPLICE, 16 GA  
P/N 263891  
QTY. 1**

**! WARNING**

Remove all rings, watches and jewelry before doing any electrical work.

**! WARNING**

To prevent accidental personal injury and equipment damage, disconnect (-) battery cable from battery.

1. Unfold the platform (**FIG. 2-1**). Refer to **C2 Operation Manual** for instructions.
2. Turn power on and activate Liftgate. Then, use the control switch to lower (**DN**) platform until all pressure in hydraulic system is released (**FIG. 2-1**).

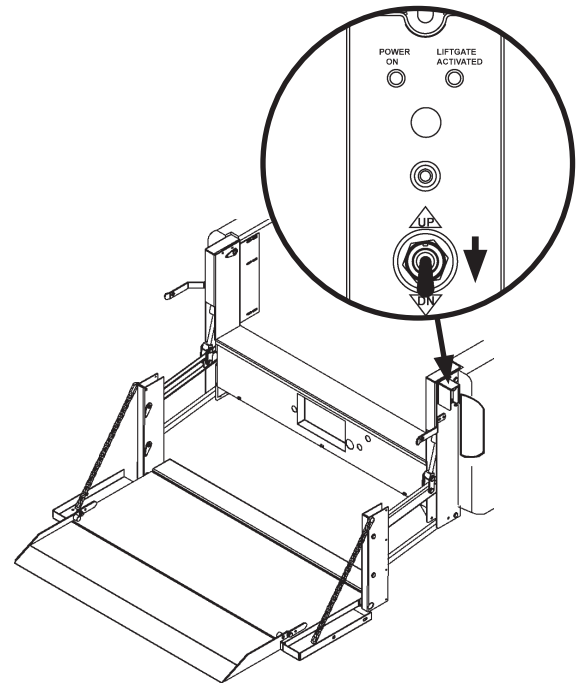

**LOWERING PLATFORM TO RELEASE  
HYDRAULIC PRESSURE  
FIG. 2-1**

3. Disconnect ground (-) battery cable from vehicle battery.

4. Unbolt cover and remove from front of Liftgate as shown in **FIG. 3-1**.

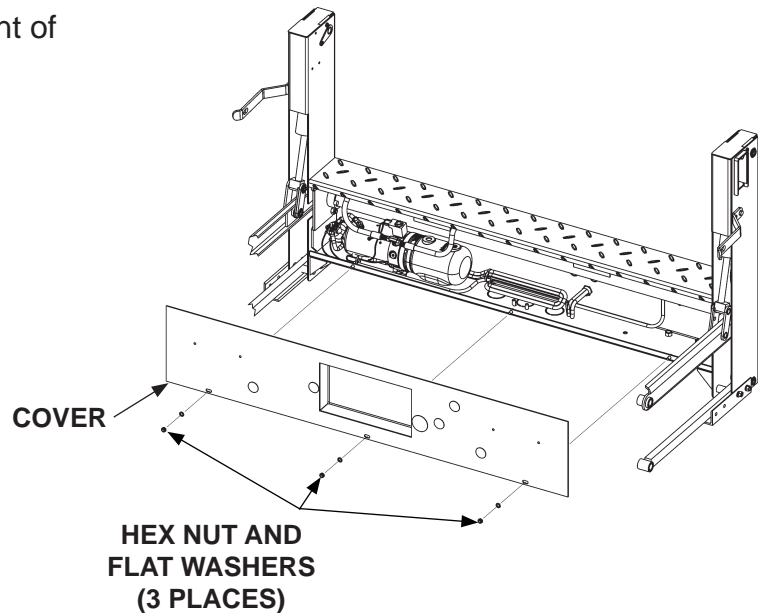

**UNBOLTING & REMOVING COVER**  
**FIG. 3-1**

**NOTE:** Place a rag under the tee to absorb hydraulic oil. Place the end of the hydraulic hose over a bucket to drain remaining hydraulic fluid from the cylinder.

5. Disconnect 2 hydraulic hoses (**FIG. 3-2**) from the tee.
6. Unbolt **BLACK** wire and ground (-) cable from motor housing (**FIG. 3-2**). Next, disconnect **GREEN** wire from coil drive stud on the starter solenoid (**FIG. 3-2**). Then, disconnect positive (+) power cable from starter solenoid.

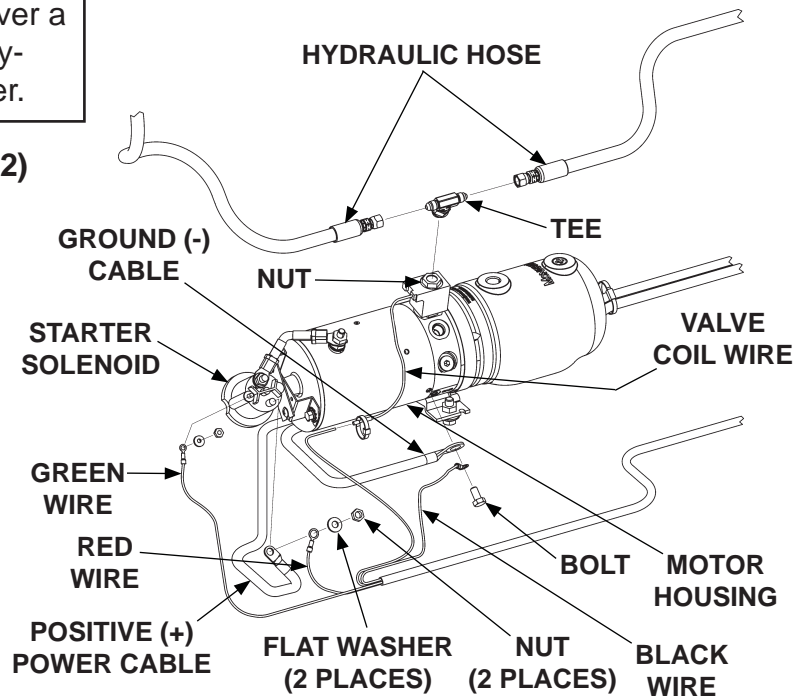

**DISCONNECTING HYDRAULIC HOSES & ELECTRICAL WIRES**  
**FIG. 3-2**

7. Cut the coil wire near the coil  
(FIG. 4-1).

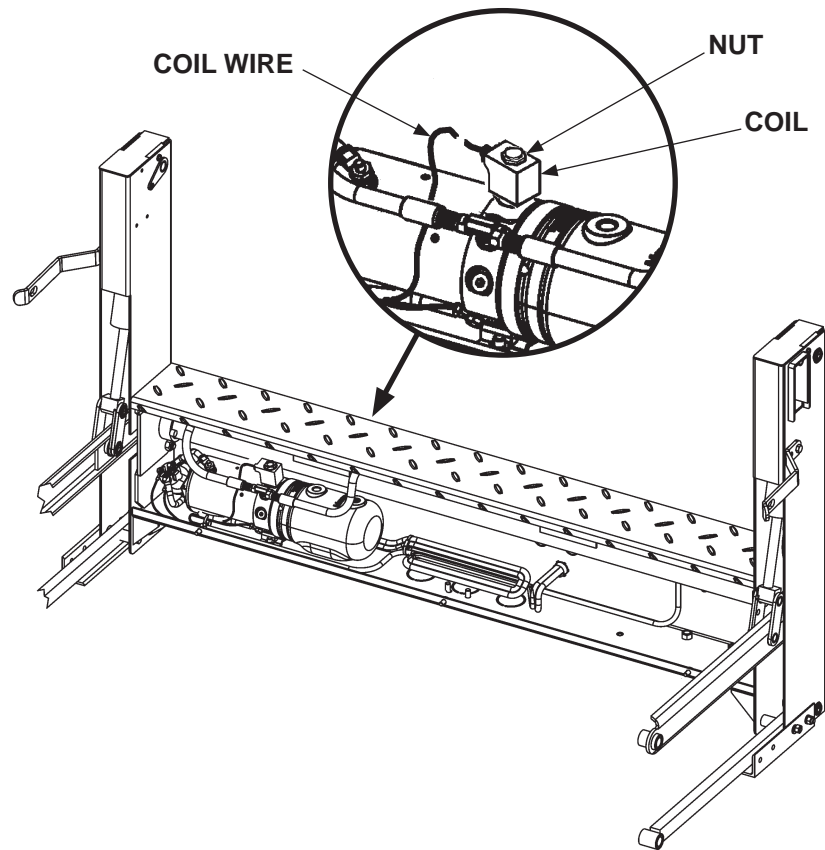

**DISCONNECTING COIL**  
**FIG. 4-1**

8. Unbolt the pump from the bottom of the main frame housing as shown in FIG. 4-2.

9. Bolt the new pump (Kit item) to main frame housing as shown in FIG. 4-2.

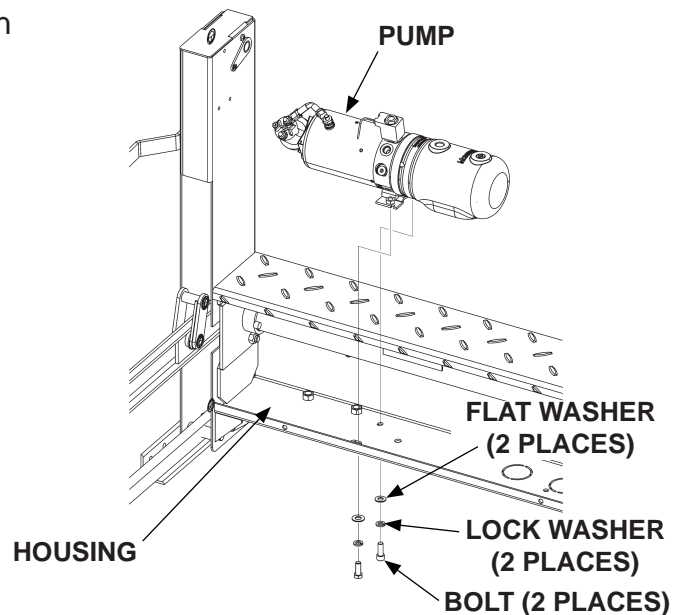

**BOLTING / UNBOLTING PUMP**  
**FIG. 4-2**

**NOTE:** Do not twist the hydraulic hoses during installation. Twisted hoses may fail prematurely.

10. Connect 2 hydraulic hoses (**FIG. 5-1**) to the tee on the new pump (Kit item). Then, tighten both hose connections securely (**FIG. 5-1**).

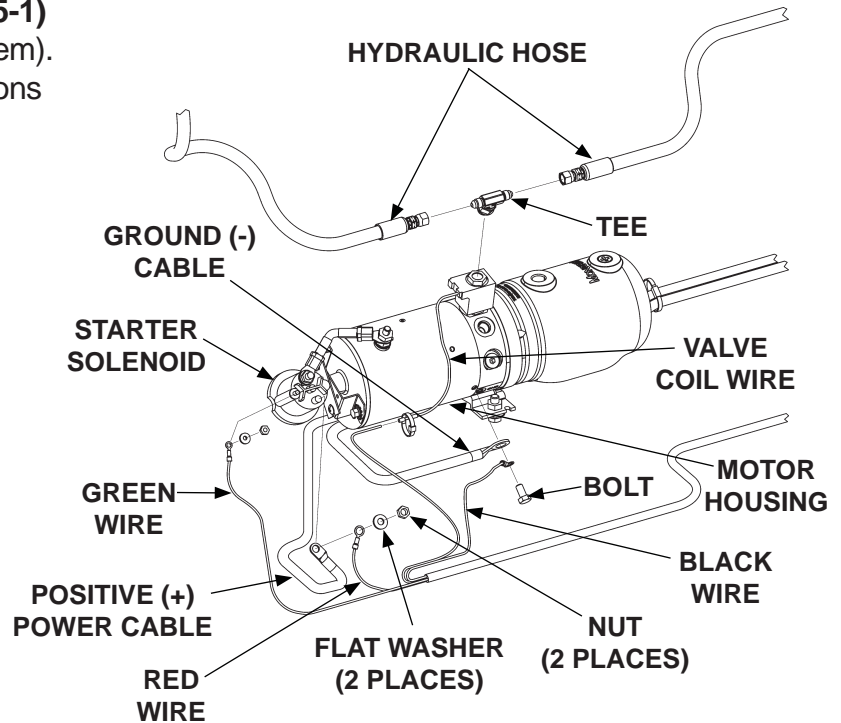

**RECONNECTING PUMP  
FIG. 5-1**

11. Reconnect positive (+) power cable and **RED** wire to starter solenoid (**FIG. 5-1**). Next, bolt **BLACK** wire and ground (-) cable to motor housing (**FIG. 5-1**). Then, reconnect **GREEN** wire to coil drive stud on the starter solenoid (**FIG. 5-1**). Tighten connections securely.

12. Use butt connector (Kit item) to connect valve coil wire to the electrical wiring (**FIG. 6-1**).

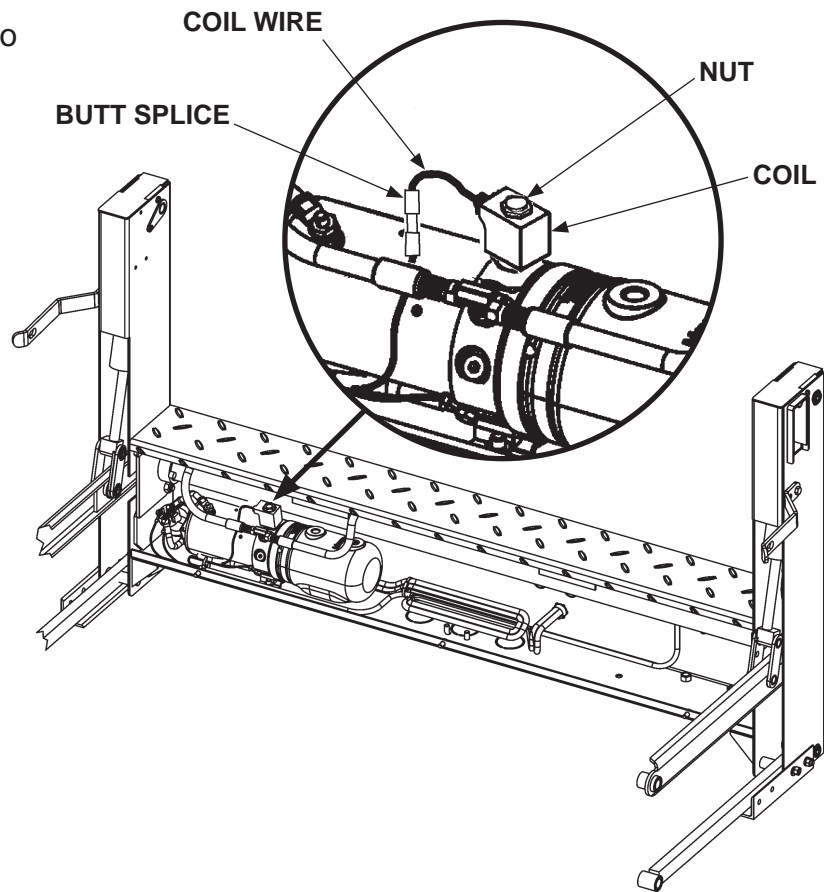

**CONNECTING COIL WIRE**  
**FIG. 6-1**

13. Remove the shipping plug from the pump reservoir (**FIG. 6-2**). With platform on the ground, fill reservoir with hydraulic oil approximately 1-1/2" below the fill hole. Then, install breather plug in pump reservoir (**FIG. 6-2**).

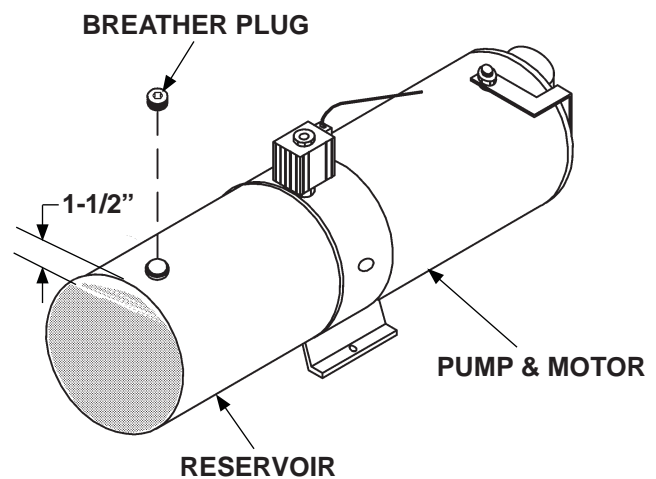

**INSTALLING BREATHER PLUG ON**  
**PUMP RESERVOIR**  
**FIG. 6-2**

14. Reconnect power to the pump by reconnecting negative (-) battery cable to battery.
15. Test the Liftgate for proper operation and check for hydraulic leaks.
16. Bolt cover to front of Liftgate as shown in **FIG. 7-1**.

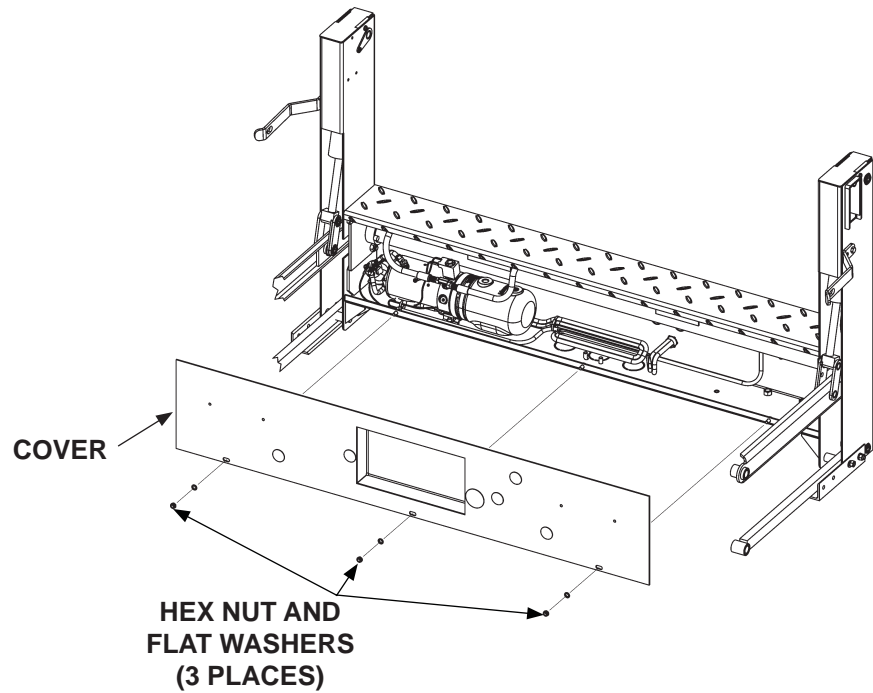

**FIG. 7-1**