

M-95-09
REV. C
MARCH 1999

MAINTENANCE MANUAL

TUK-A-WAY[®] **LIFTGATE SERIES**

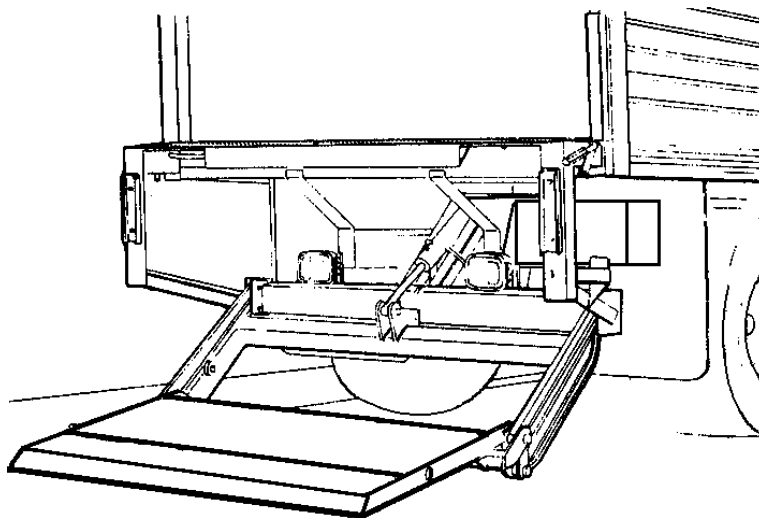

72-25(B & LM)

72-30(B & LM)

MAXON[®]
LIFT CORP.

11921 Slauson Avenue.
Santa Fe Springs, CA. 90670
(800) 227-4116

MAXON[®]

LIFT CORP.

**11921 Slauson Ave.
Santa Fe Springs, CA. 90670**

CUSTOMER SERVICE:

TELEPHONE (562) 464-0099 TOLL FREE (800) 227-4116

FAX: (888) 771-7713

**NOTE: Check with Customer Service for updated versions
of Manuals on an annual basis.**

WARRANTY POLICY & PROCEDURE

NEW LIFTGATE WARRANTY

Term of Warranty: 2 Years from Date of In-Service

Type of Warranty: Full Parts and Labor

MAXON agrees to replace any components which are found to be defective during the first 2 years of service, and will reimburse for labor based on MAXON's Liftgate Warranty Flat Rate Labor Schedule. (Call MAXON Customer Service for a copy).

All claims for warranty must be received within 30 Days of the repair date, and include the following information:

1. Liftgate Model Number
2. Liftgate Serial Number
3. Detailed Description of Problem
4. Corrective Action Taken, and Date of Repair.
5. Parts used for Repair, Including MAXON Part Number(s).
6. MAXON R.M.A. # and/or Authorization # if applicable (see below).
7. Person contacted at MAXON if applicable.

All warranty repairs must be performed by an authorized MAXON warranty station. For major repairs, MAXON Customer Service must be notified and an "Authorization Number" obtained. Major repairs would generally be considered repairs made to the structural assembly of the liftgate and/or repairs not outlined in the MAXON Liftgate Warranty Flat Rate Schedule.

Major components (i.e. hydraulic pumps, cylinders, valves, or failed structural parts) must be returned, freight pre-paid, prior to the claim being processed. To ensure timely processing of these warranty claims, an R.M.A. (Returned Merchandise Authorization) number must be obtained from MAXON Customer Service prior to the return of any defective part. Defective Parts must be returned within 60 days of the claim date for consideration to:

**MAXON Lift Corp.
16205 Distribution Way, Cerritos, CA 90703
Attn: RMA#__**

MAXON's warranty policy does not include the reimbursement for travel time, towing, vehicle rental, service calls, oil, batteries, defects due to misuse or abuse, or loss of income due to downtime. Fabrication of parts, which are available from MAXON, are also not covered.

MAXON's Flat Rate Labor Schedule takes into consideration the time required for diagnosis of a problem.

PURCHASE PART WARRANTY

Term of Warranty: 1 Year from Date of Purchase

Type of Warranty: Part Replacement

MAXON will guarantee all returned genuine replacement parts upon receipt and inspection of parts and invoice.

Table of Contents

INTRODUCTION	PAGE 4
WARNING	PAGE 5
PERIODIC MAINTENANCE CHECKLIST	PAGE 6
DECALS	PAGE 7
HAND PUMP STANDARD	PAGE 8
SAFETY HOOK	PAGE 9
REPLACING PLATFORM TORSION SPRING	PAGE 10
PLATFORM ADJUSTMENT	PAGE 12
HINGE PIN LOCATION	PAGE 13
72-25/30LM ASSEMBLY	PAGE 14
GRAVITY DOWN SECTION	PAGE 17
HYDRAULIC ASSEMBLY, OLD STYLE PUMP	PAGE 18
HYDRAULIC ASSEMBLY, SLIMLINE PUMP	PAGE 19
PUMP ASSEMBLY, GRAVITY DOWN, OLD STYLE	PAGE 20
PUMP ASSEMBLY, GRAVITY DOWN, NEW STYLE	PAGE 22
CONTROL SWITCH, GRAVITY DOWN, OLD STYLE PUMP	PAGE 24
CONTROL SWITCH, GRAVITY DOWN, SLIMLINE PUMP	PAGE 25
HARNESS ASSY., GRAVITY DOWN, OLD STYLE PUMP	PAGE 26
HARNESS ASSY., GRAVITY DOWN, SLIMLINE PUMP	PAGE 27
WIRE CONNECTIONS, GRAVITY DN., OLD STYLE PUMP	PAGE 28
WIRE CONNECTIONS, GRAVITY DN., SLIMLINE PUMP	PAGE 29
PUMP ENCLOSURE, OLD STYLE PUMP	PAGE 30
POWER DOWN SECTION	PAGE 32
HYDRAULIC ASSEMBLY, POWER DOWN	PAGE 33
CONTROL SWITCH, POWER DOWN	PAGE 34
HARNESS & SWITCH ASSY. POWER DOWN	PAGE 35
WIRE CONNECTIONS POWER DOWN	PAGE 36
HAND PUMP, POWER DOWN	PAGE 37
PUMP ASSEMBLY, POWER DOWN	PAGE 38
ALUMINUM RETENTION RAMP	PAGE 40
TROUBLESHOOTING	PAGE 42
PLATFORM WILL NOT RAISE	PAGE 43
PLATFORM RAISES BUT LEAKS DOWN	PAGE 44
PLATFORM RAISES PARTIALLY AND STOPS	PAGE 45
LIFTGATE WILL NOT LIFT RATED CAPACITY	PAGE 46
PLATFORM RAISES SLOWLY	PAGE 47
PLATFORM WILL NOT LOWER	PAGE 48

INTRODUCTION

This publication contains the information required to maintain the **72-25B** and the **72-30B**. If there is any doubt regarding the suitability of these lifts being maintained on its intended vehicle, or any portion of these instructions that you do not understand, please contact the **MAXON Customer Service Department** for consultation.

Unauthorized modification to this equipment may cause premature failure or create hazards in its use that are not foreseen at the time of installation. These kinds of changes should be discussed with our Engineering Department before being undertaken.

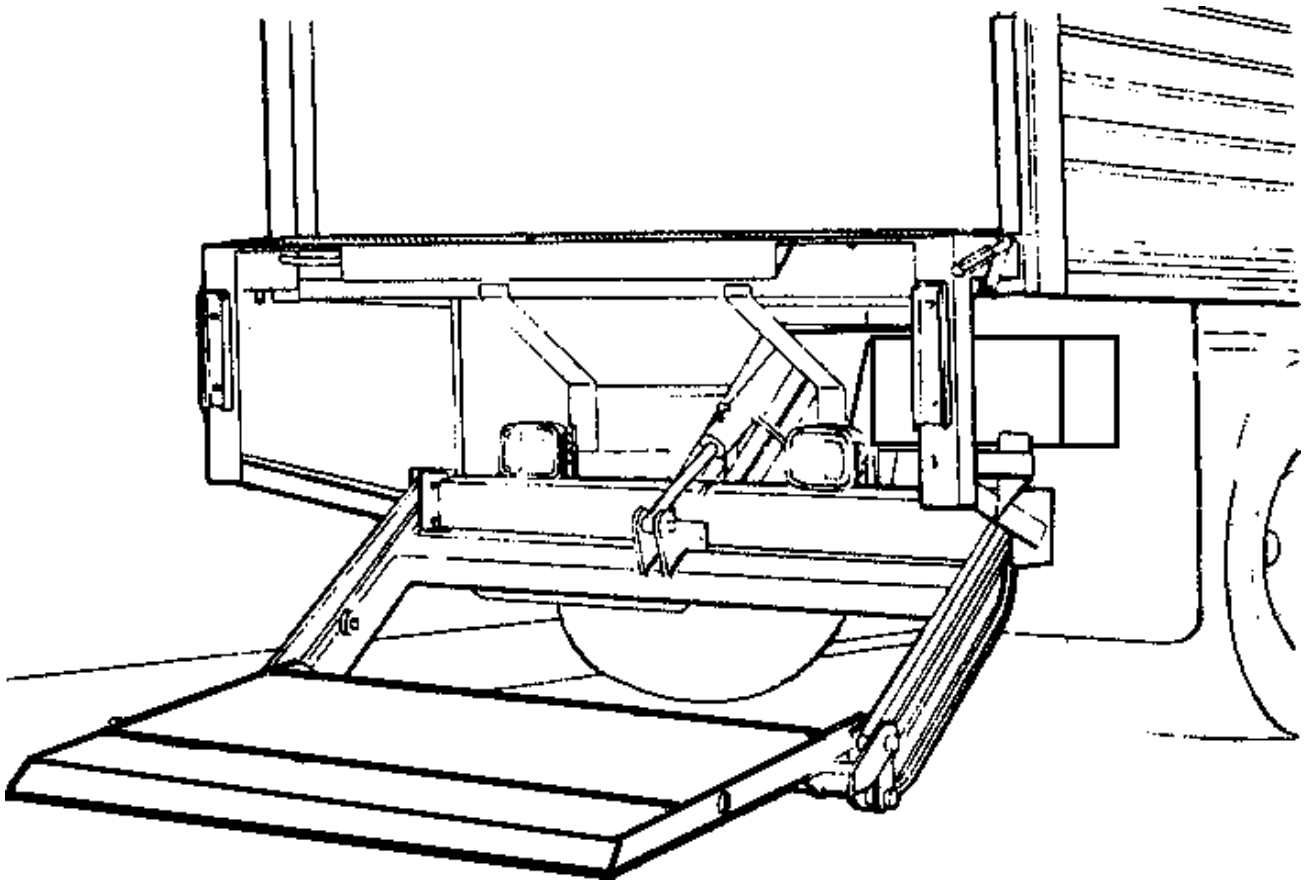

MAXON[®]

11921 Slauson Ave. Santa Fe Springs, CA. 90670 (800) 227-4116 FAX (888) 771-7713

WARNING

1. Read the **Maintenance Manual** and understand it thoroughly before any maintenance of this unit is done.
2. Read the **YELLOW** urgent warning decal on the side of the vehicle close to the unit before operating.
3. If decals are dirty, clean them. If decals are defaced or missing, replace them. **Free replacements** are available from the manufacturer. See information at the end of the Warnings
4. Be aware that the safety and location of other people or objects should be considered before operation of this unit. Stand to one side of platform while operating this unit.
5. Do not stand under, or have any foreign object under the Platform when lowering. **Be sure that the lowering of the Platform and/or Flipover will miss your feet!**
6. Keep fingers, hands, arms, legs, and feet clear of moving parts when operating this unit.
7. If during your maintenance procedure, it becomes necessary to ride the platform, keep your feet and any foreign objects clear of the rear edge of the platform. Otherwise your feet or the foreign objects could become trapped between the edge of the platform and the vehicle bed.
8. Inspect all Roll Pins monthly, to insure that they are not broken. Replace if broken.
9. Inspect all hydraulic hoses and fittings annually. Check for cracks and deterioration, and replace if necessary.
10. **Disconnect battery** when replacing parts or servicing.
11. Do not allow children to ride, play with, or operate this unit.
12. In the event of an emergency while operating the unit, release the toggle switch and the unit will stop immediately.
13. A properly installed Lift should operate smoothly and the only noise during the operation of this unit should be from the Pump Unit during the raising of the Platform. Any scraping, grating or audible indications of rough operation will need investigating. The cause will need resolving before any further deterioration of performance occurs.
14. Use only **Maxon Authorized Parts** for replacement. Replacement parts should be ordered from:

MAXON LIFT CORP. Parts Department
11921 Slauson Ave., Santa Fe Springs, Ca. 90670
Phone: (800) 227-4116

PERIODIC MAINTENANCE CHECKLIST

Annually

Visually check the complete unit for excessive wear, worn parts or broken welds. Check all Hinge Pins for excessive wear or broken welds. For parts replacement, see the Assembly Breakdown Drawings.

Six Months

Visually check the Platform Hinge Pins for excessive wear or broken welds. For parts replacement, see the Assembly Breakdown Drawings.

Quarterly

Check the oil in the Pump Reservoir. The oil should be Grade ISO-(32) Hydraulic Fluid. ***See below for Cold Weather operation.**

Check Hoses and Fittings for scuffing and leaks. Replace if necessary.

Check the electrical wiring for worn insulation, and the terminals for corrosion and secure fit.

Check all bolts for tightness.

Check that all Warning Decals are in place and readable.

Check that all roll pins are properly installed. Replace if necessary.

Inspect the Hook & Chain Assembly for proper operation.

* COLD WEATHER OPERATION

OIL SPECIFICATIONS:

Grade ISO-(32)
Gravity, API - 29.5 Degrees
Pour Point, F- (-54 Degrees)

VISCOSITY:

@ 40 Degrees C - 31.2 cSt
@100 Degrees C - 6.2 cSt
VISCOSITY INDEX - 154 VI
Flash Point, F - 325 Degrees

MAXON[®]

11921 Slauson Ave. Santa Fe Springs, CA. 90670 (800) 227-4116 FAX (888) 771-7713

DECALS

These Decals are located on the rear corner post of the vehicle, at the control position. They should be read completely and understood before operating the Lift Gate. They should also be kept clean and readable at all times. If any decal should become detached from the vehicle, or defaced, it must be replaced. Free replacements are available from: **MAXON Lift Corp.**, Parts Dept.

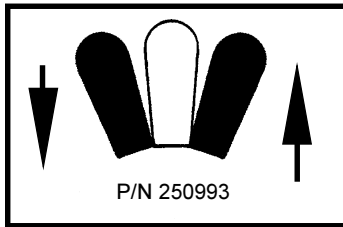
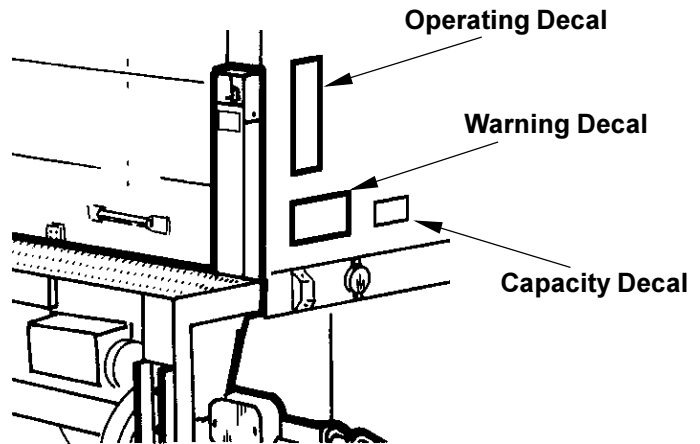

WARNING

READ CAREFULLY

- Improper operation of this Lift can result in serious personal injury. Do not operate unless you have been properly instructed and have read, and are familiar with the operating instructions. If you do not have a copy of the instructions, please obtain them from your employer, distributor, or lessor, before you attempt to operate Lift.
- Be certain that the vehicle is properly and securely braked before using the Lift.
- Always inspect this Lift for maintenance or damage before using it. If there are signs of improper maintenance, damage to vital parts, or slippery Platform surface, do not use the Lift until these problems have been corrected.
- Do not overload the Lift. The load limit is based on evenly distributed cargo over the entire Platform surface. If you are using a pallet jack, be sure it can be maneuvered safely. Do not operate a forklift on the Platform or travel with the platform in an open position at any time.
- Load should be placed in a stable position close to the edge of the Platform nearest the truck. The heaviest portion of the load should never be placed beyond the center of the Platform away from the truck.
- Never allow yourself, a helper, or bystander to stand in a position where a falling load could land on either of you. Also do not allow any part of yours or your helper's body to be placed under, within, or around any portion of the moving liftgate, or its mechanisms, or in a position that would trap them between the platform and the ground or truck when the liftgate is operated.
- If a helper is riding the Platform with you, make sure you are both doing so safely and that you are not in danger of coming in contact with any moving or potentially moving obstacles. USE GOOD COMMON SENSE. If load appears to be unsafe, do not lift or lower it.

MAXON LIFT CORP.
PART NO. 264081

Operating Instructions
TUK-A-WAY® Units

Depress handle & activate Toggle Switch to lower stowed liftgate. This point must touch ground. ①

Open Platform ②

Open Flipover ③

Activate toggle switch to Raise or Lower platform ④

To Tuck unit away, reverse steps 1,2,& 3. ⑤

MAXON
LIFT CORP.
P/N 251867

HAND PUMP STANDARD

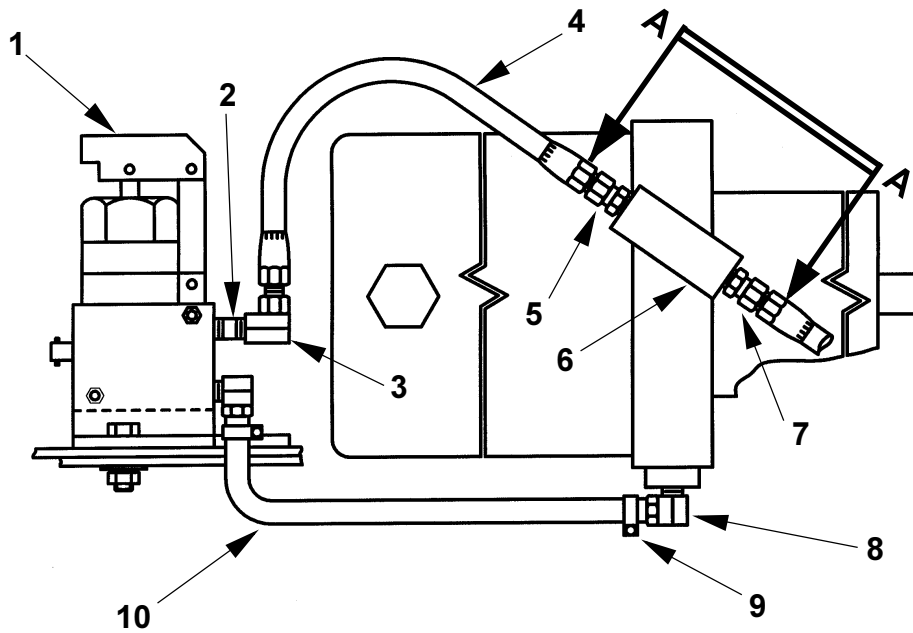

VIEW A-A

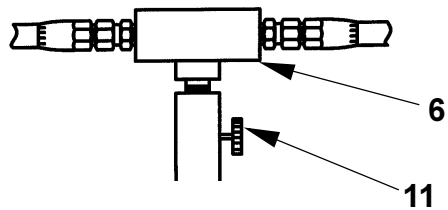

ITEM	QTY.	PART NO.	DESCRIPTION
1	1	251407	HAND PUMP WITH HANDLE
2	1	030282	NIPPLE, 1/4" x 1-1/2" LG.
3	1	226063	ELBOW, 90 DEG. 1/4 F-F
4	1	226948-09	HOSE ASSEMBLY H.P. 1/4" x 18-1/2 LG.
5	1	251852	FITTING STRAIGHT, 3/8 M x 1/4 F SWIVEL
6	1	251851	TEE 3/8 M - 3/8 F SWIVEL
7	1	228151	FITTING STRAIGHT, 3/8 M x 3/8 F SWIVEL
8	2	251853	ELBOW, 90 DEG. 1/4" M x 3/8" PUT ON
9	2	251854	CLAMP, GEAR TYPE
10	1	251856	HOSE, 3/8" L.P. x 20" LG.
11	1	251850	VALVE, NEEDLE 3/8" M - F

SAFETY HOOK

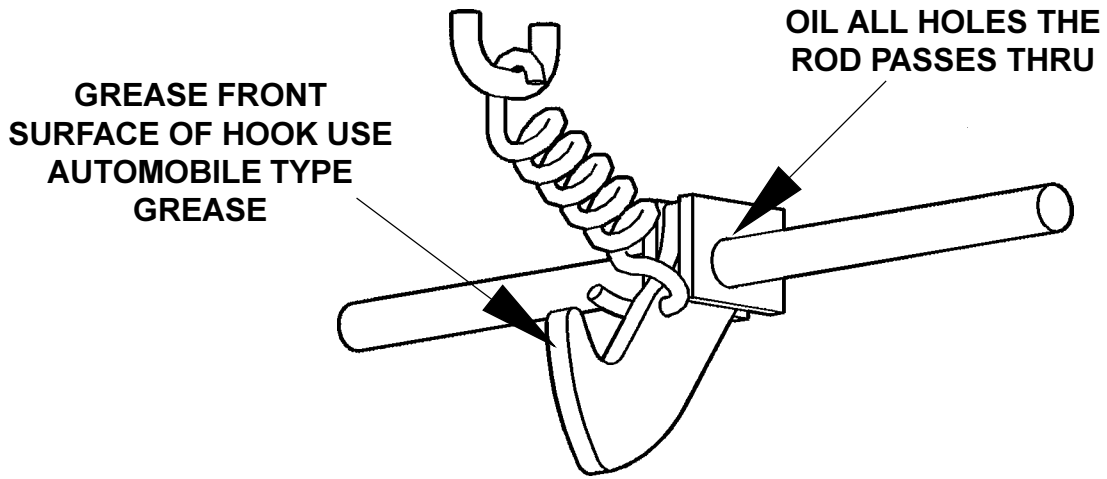

When the Platform is raised to full "Stowed" position, there should be an audible snap of the **Safety Hook** engaging the **Platform Loop**. Visually check to see that the loop is positioned over the Safety Hook.

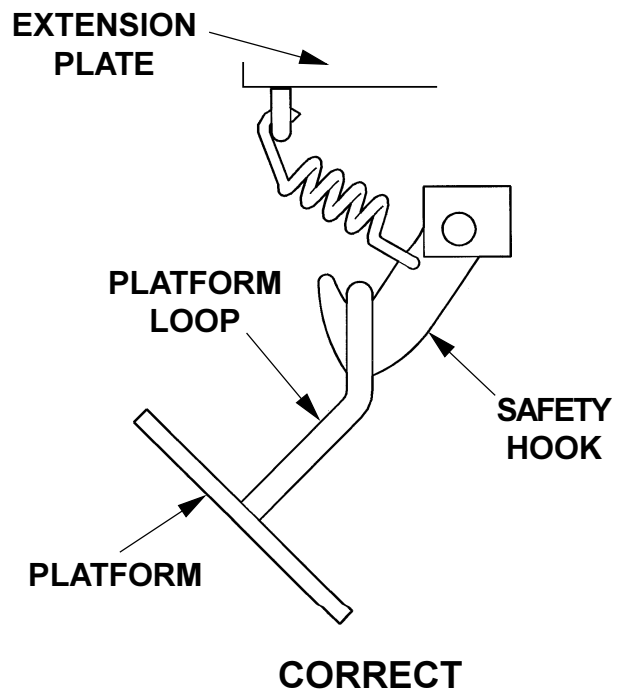
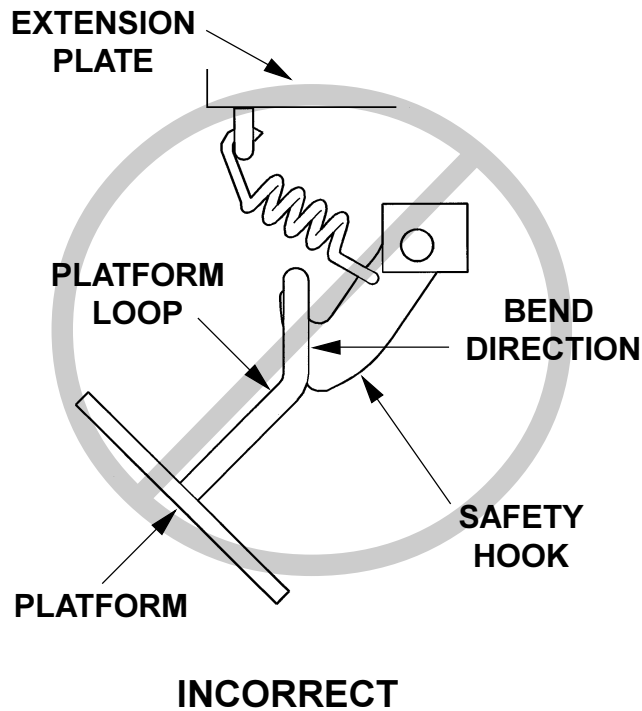

To insure that the Hook is seated as described, test by activating the Toggle Switch in the "Down" mode. Gate should not go down. If it does, adjust the loop as shown in, to achieve adjustment shown.

REPLACING PLATFORM TORSION SPRING

Fold Flipover onto Platform. Lift Platform until Flipover is resting on rollers on lift arms.

Raise unit about 6" off ground. Place a 4" x 4" wood block under right hand Shackle. Lower unit onto block.

Remove Roll Pin from pin collar on Platform Hinge Bracket. Using a hammer and a punch, drive the Platform Hinge Pin out of the Shackle just enough to allow the Torsion spring to drop loose. Remove Spring.

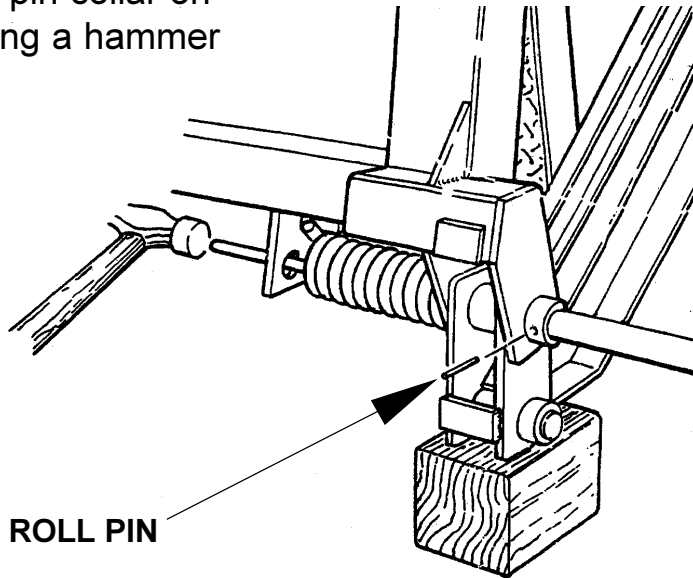

When installing the Spring, be sure the long leg of the spring is inserted into the hole in the bracket on the side of the Shackle. Short leg of Spring will rest against the block, which is welded to the Platform Hinge Bracket.

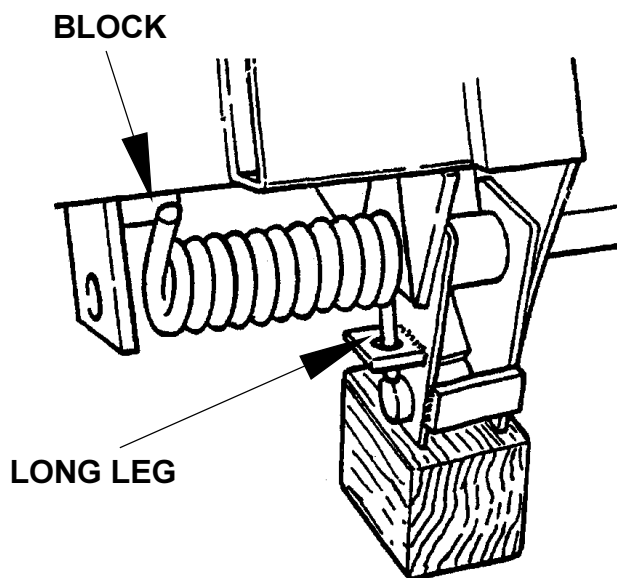

MAXON[®]

11921 Slauson Ave. Santa Fe Springs, CA. 90670 (800) 227-4116 FAX (888) 771-7713

REPLACING PLATFORM TORSION SPRING

Drive Hinge Pin thru the Spring into the hole in the Platform Hinge Bracket. Align the Roll Pin hole with the Pin hole in the Pin Collar. Install Roll Pin.

Raise unit to allow wood block to be removed. The Platform and Flipover can now be lowered to the ground or raised into the Tuk-A-Way position.

See M-91-10 Operating Instructions for operating the unit. This manual should be in the cab of the vehicle.

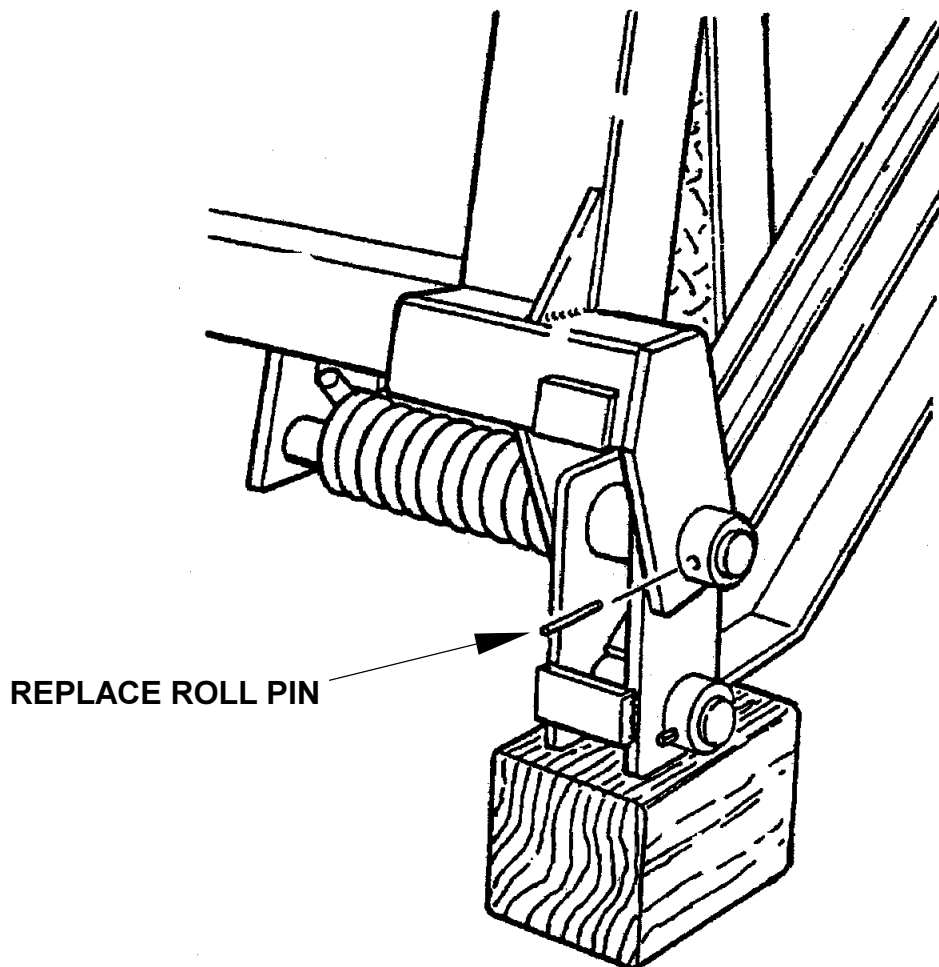

PLATFORM ADJUSTMENT

Before adjusting platform, remove and inspect each of the hinge pins for wear. (Ref. Hinge Pin Location Sheet) If any are worn, replace them. Also check for structural damage. Either condition could make the platform appear in need of adjustment. The Platform should reflect the **YES** illustrations below with the Platform as much as 2-1/2" higher than the extension plate or floor bed. There should be **NO SAG** in the Platform as pictured below.

YES

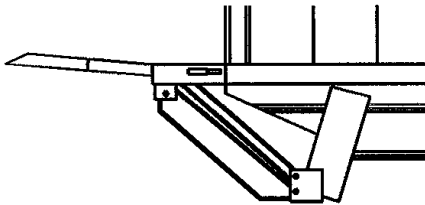

NO

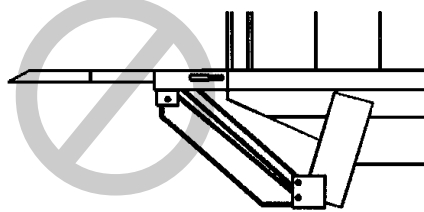

YES

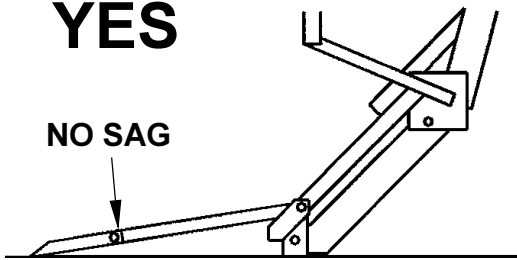

NO

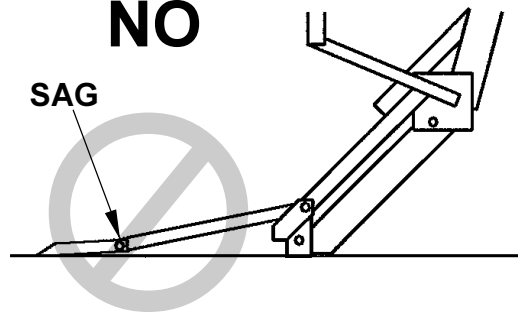

Shackles also rest on the ground. If Platform is straight, no shimming is required. If Platform sags, appropriate shims must be added to both sides. **Shims** can be placed in either or both positions.

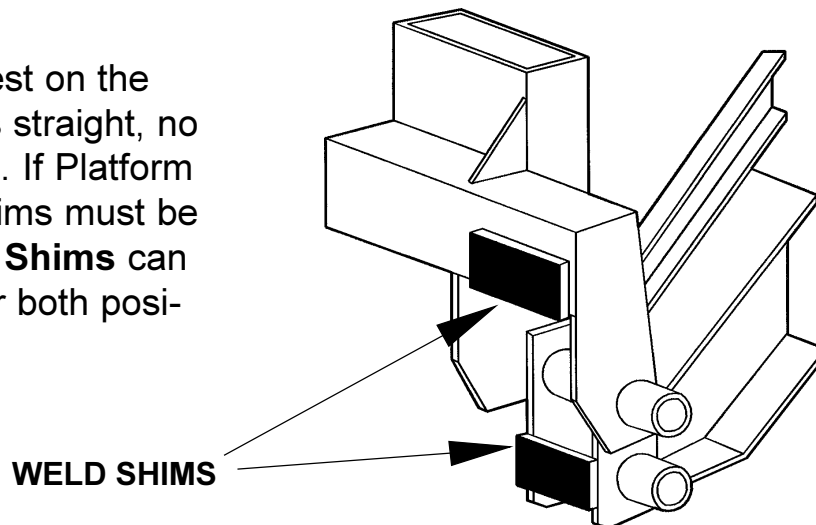

MAXON[®]

11921 Slauson Ave. Santa Fe Springs, CA. 90670 (800) 227-4116 FAX (888) 771-7713

HINGE PIN LOCATION

Annually inspect both Hinge Pins and Bearings for excessive wear. If Pins or Bearings are worn, replace with **MAXON** authorized parts. See Pin & Bearing part list below for Part Numbers.

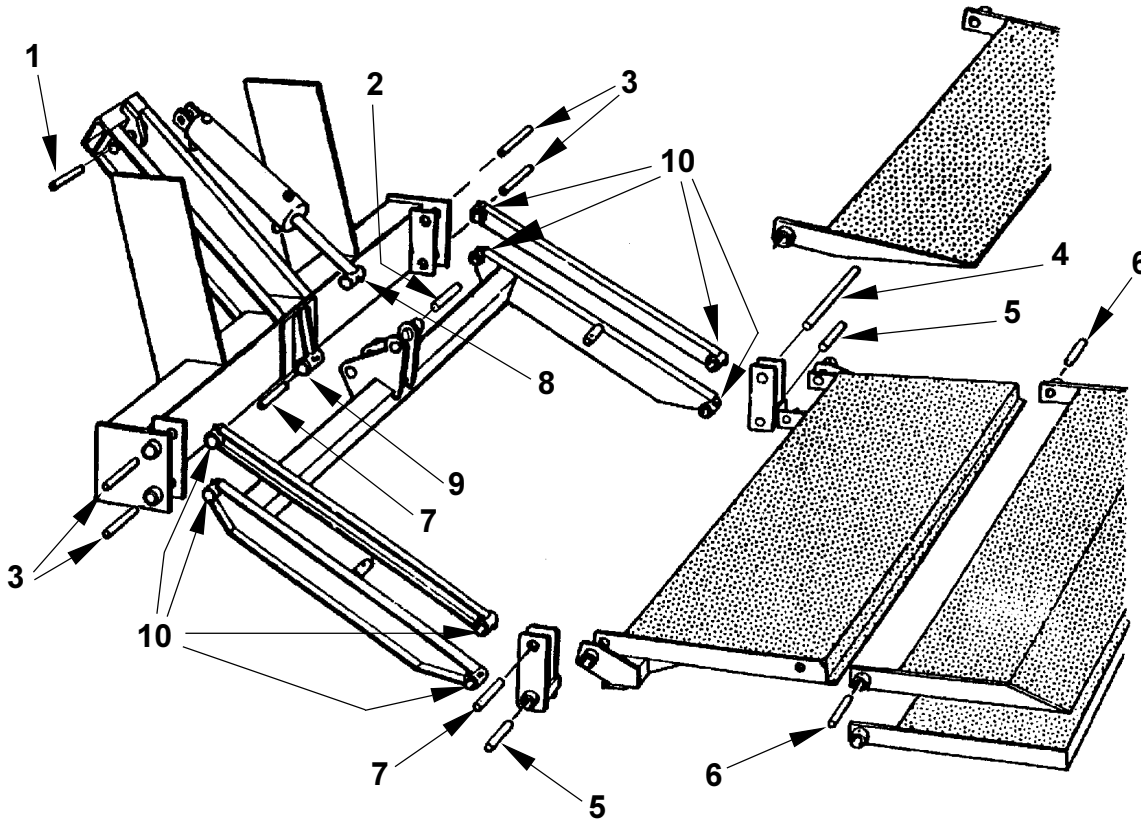

PINS				BEARINGS			
ITEM	QTY.	PART NO.	DESCRIPTION	ITEM	QTY.	PART NO.	DESCRIPTION
1	1	203405-09	PIN x 4"	8	1	260373	BEARING SELF LUBE 1 x 2"
2	1	203405-08	PIN x 5"	9	1	260369	BEARING SELF LUBE 1-1/8 x 2"
3	4	203405-06	PIN x 3-1/2"	10	8	260363	BEARING SELF LUBE 1 x 1-1/2"
4	1	203405-03	PIN x 11-1/4"				
5	2	201633	PIN & COLLAR WELDMENT				
6	2	203405-05	PIN x 3-1/4"				
7	2	203405-07	PIN x 4-1/2"				

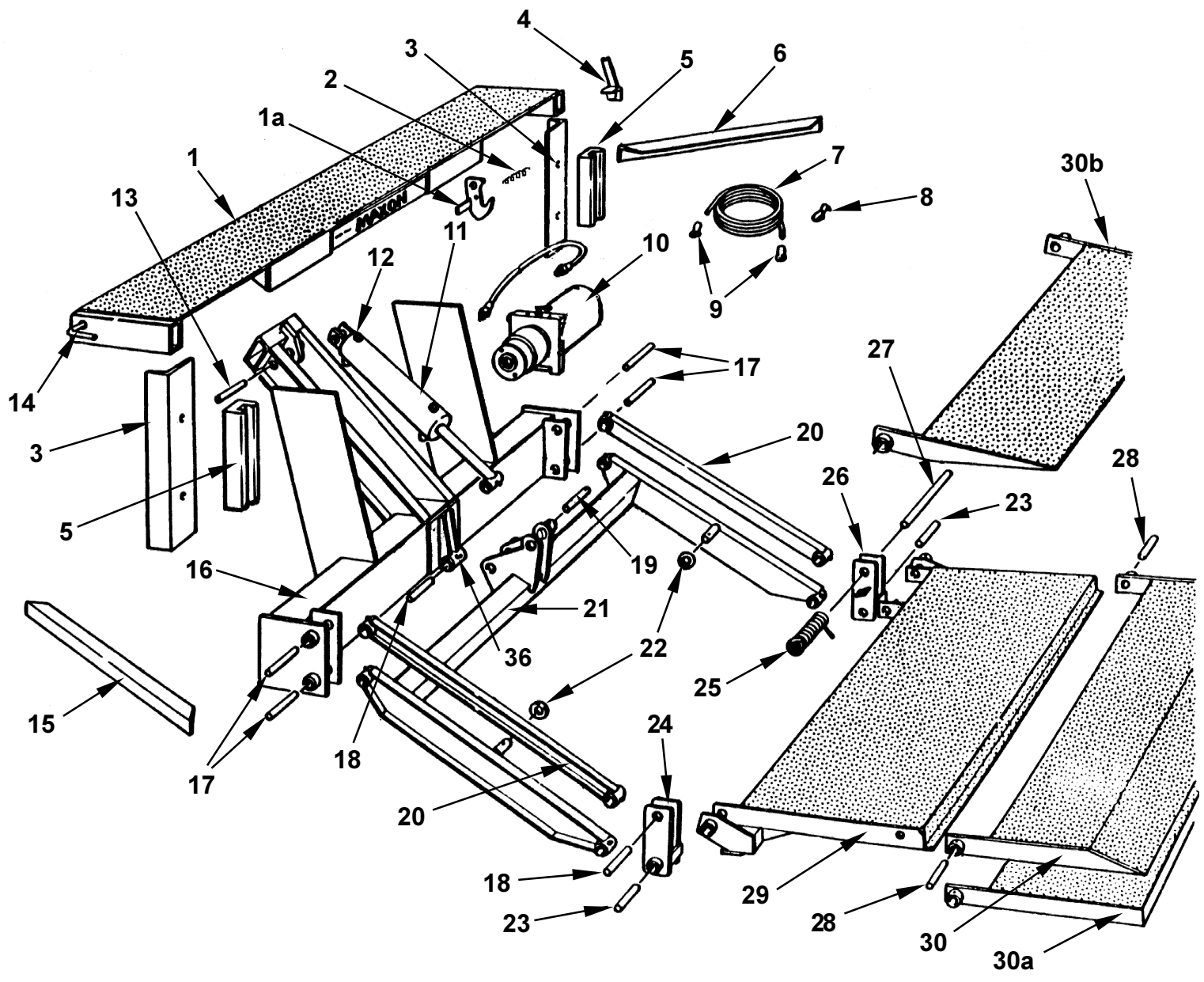

72-25/30LM ASSEMBLY

ITEM	QTY.	PART NUMBER	DESCRIPTION
1	1	207914-100	EXTENSION PLATE WELDMENT
1a	1	215341	SAFETY HOOK WELDMENT
2	1	215345	SPRING SAFETY HOOK
3	2	201638	DOCK BUMPER
4	1	203412	RENTAL LOCK DEVICE
5	2	222988	RUBBER BUMPER
6	1	201637-02	ANGLE, DOCK BUMPER SUP. R.H.
7	1	251871	CABLE, 32 FEET LONG, 2 GAUGE
8	7	050079	CABLE FRAME CLIP #2
9	1	226778	CABLE END #2
10	1	250100	PUMP ASSY. (STD.)
		253473	PUMP ASSY. (POWER DOWN)
11	1	260372	CYLINDER, 3" x 10" (72-25)
		260392	CYLINDER, 3-1/2" x 10" (72-30)
11a	1	260372-SK	SEAL KIT (72-25)
		260392-SK	SEAL KIT (72-30)
12	1	201695	BREATHER, CYLINDER
13	1	203405-09	PIN x 4"
14	1	203411	STREET SIDE CNTL ROD ASSEMBLY
15	1	201637-01	ANGLE, DOCK BUMPER SUPPORT
16	1	260436	MAIN FRAME ASSEMBLY
17	4	260368-03	PIN, x 3-1/2"
18	2	260368-04	PIN, x 4-1/2"
19	1	260368-05	PIN, x 5"

CONTINUED NEXT PAGE

72-25/30LM ASSEMBLY

ITEM	QTY.	PART NUMBER	DESCRIPTION
20	2	260370	PARALLEL ARM ASSEMBLY
21	1	260315	LIFT FRAME ASSEMBLY
22	2	221867	ROLLER x 3/4"
23	2	260367	PIN & COLLAR WELDMENT
24	1	201625-02	SHACKLE WELDMENT LH
25	1	201640	TORSION SPRING
26	1	201625-01	SHACKLE WELDMENT RH
27	1	260368-02	PIN, x 11"
28	2	203405-05	PIN, x 3-1/4"
29	1	207910	PLATFORM ASSEMBLY
30	1	201629	FLIPOVER ASSY. RAMP TYPE (STD.)
OPTIONAL 30a		201680	FLIPOVER ASSY. BUTT END TYPE
30b		213085	FLIPOVER ASSY. WEDGE TYPE
30c		253874-01	FLIPOVER ASSY. w/10" A.R.R. (Not Shown)
31	1	M-91-08	INSTALLATION MANUAL (Not Shown)
32	1	M-91-10	OPERATION MANUAL (Not Shown)
33	1	M-95-09	MAINTENANCE MANUAL (Not Shown)
34	1	251867	DECAL, OPERATING (Not Shown)
35	1	260008	DECAL, WARNING (Not Shown)
36	1	260369	BEARING SELF-LUBRICATING 1-1/8 x 2"LG.

MAXON[®]

11921 Slauson Ave. Santa Fe Springs, CA. 90670 (800) 227-4116 FAX (888) 771-7713

GRAVITY DOWN SECTION

TUK-A-WAY[®]
LIFT GATE SERIES

72-25 LM

72-30 LM

HYDRAULIC ASSEMBLY, OLD STYLE PUMP

MAXON[®]

11921 Slauson Ave. Santa Fe Springs, CA. 90670 (800) 227-4116 FAX (888) 771-7713

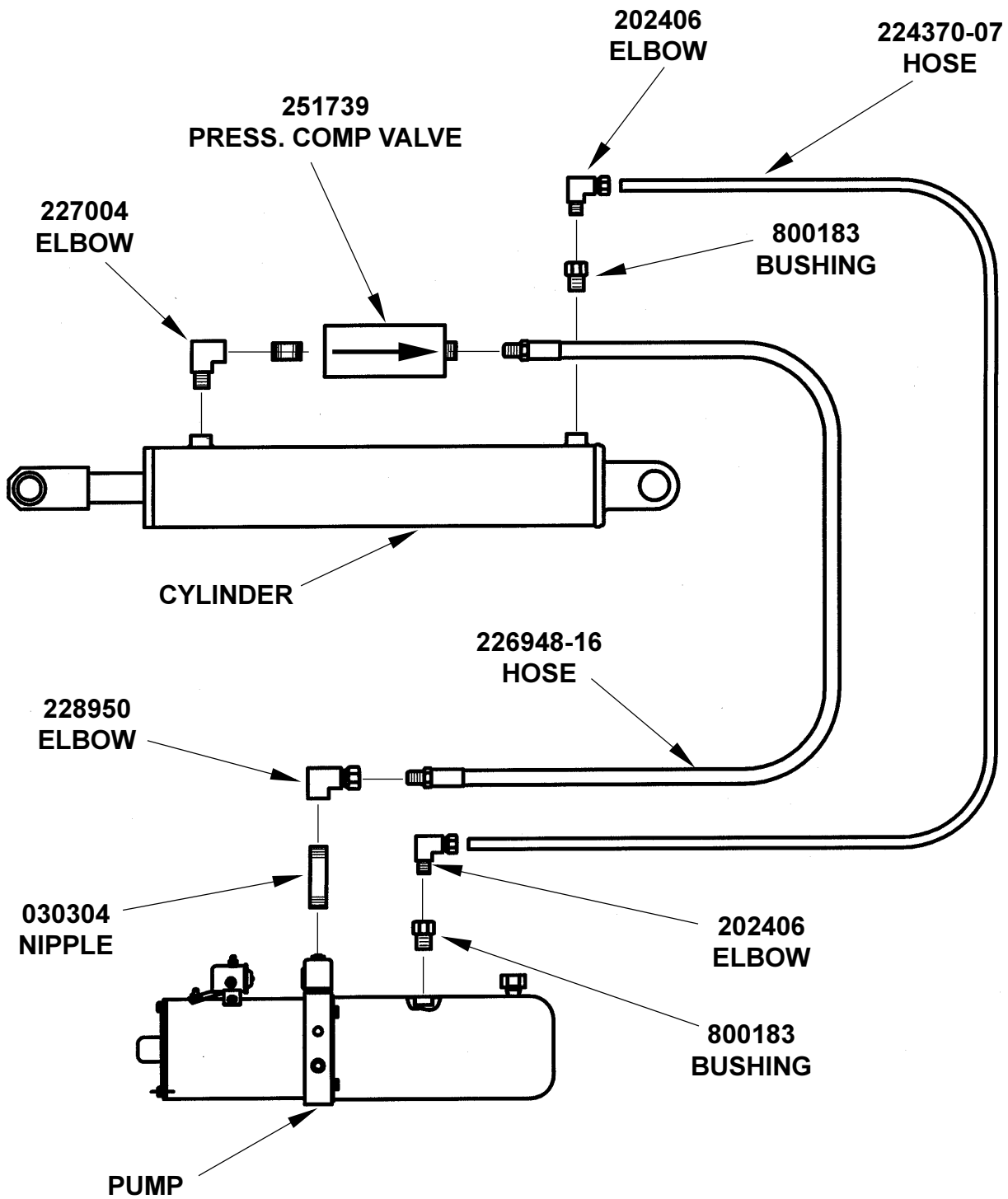

HYDRAULIC ASSEMBLY, SLIMLINE PUMP

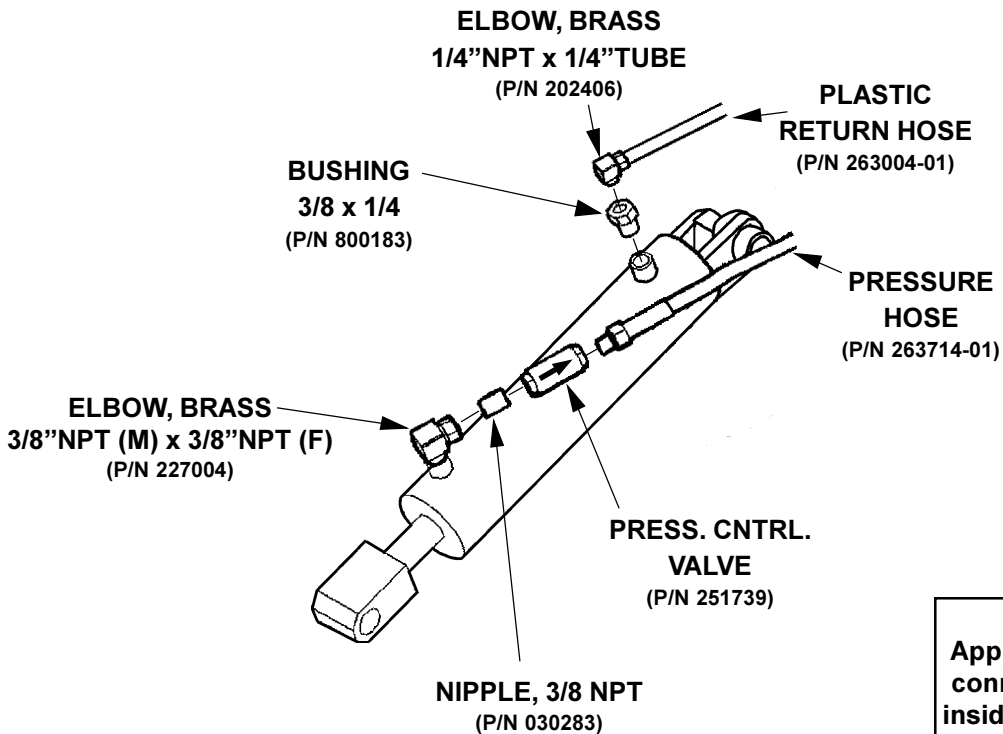
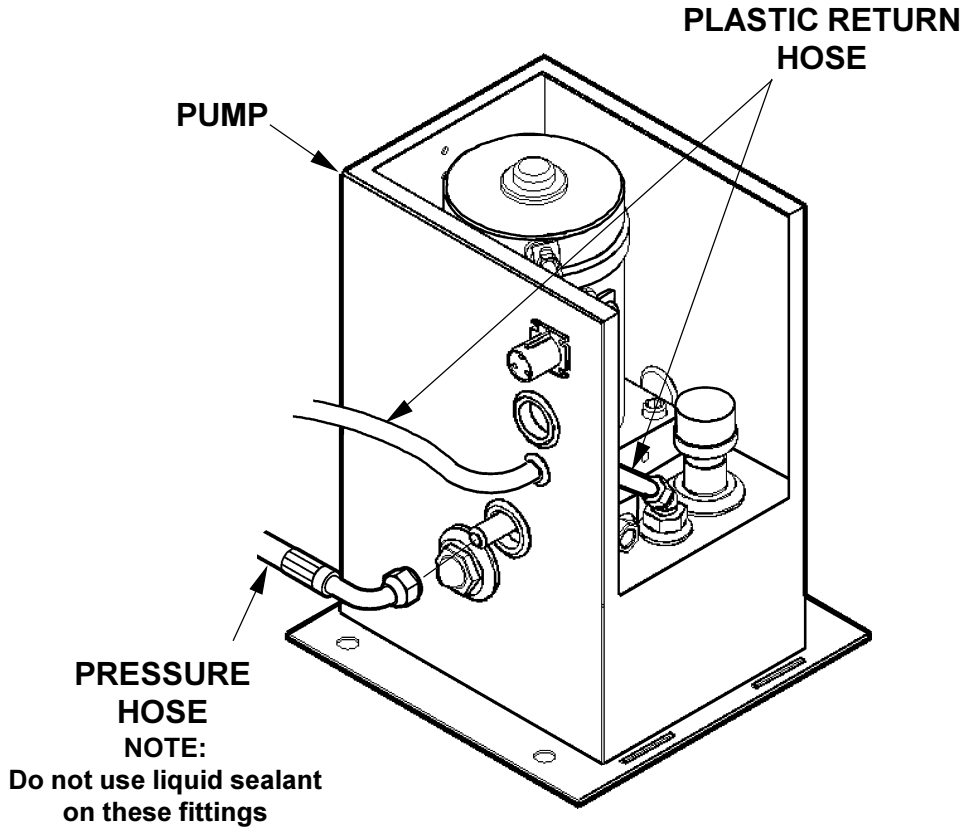

NOTE:
Apply Sealant to connections per inside back cover of this manual

PUMP ASSEMBLY, GRAVITY DOWN, OLD STYLE

MAXON®

11921 Slauson Ave. Santa Fe Springs, CA. 90670 (800) 227-4116 FAX (888) 771-7713

ITEM	QTY.	PART NUMBER	DESCRIPTION
1	1	229272	MOTOR, 12 VOLTS DC
2	1	253353	VALVE, SOLENOID 2-WAY
*2a	1	226594	O-RING KIT, 2-WAY VALVE
3	1	229200	COUPLING
4	1	260261	OIL SEAL
5	1	251885	CHECK VALVE KIT
5a	1	260234	VALVE CAP
5b	1	260255	RETAINER
5c	1	260231	SPRING
5d	1	260257	STEEL BALL
5e	1	260256	SOCKET HEAD CAPSCREW
6	1	260229	RELIEF VALVE KIT
6a	1	260232	ADJUSTING SCREW
6b	1	260234	VALVE CAP
6c	1	260235	O-RING
6d	1	260231	SPRING
6e	1	260233	SPRING GUIDE
6f	1	260230	STEEL BALL
7	1	229193	FILLER/BREATHER CAP
8	1	251882	RESERVOIR, 3 QT.
9	1	260250	FILTER
10	1	260272	PUMP ASSEMBLY
11	1	251884	O-RING
12	1	260273	DRIVEPLATE ASSEMBLY 5"
13	1	262866	BUS BAR
14	1	262939	SOLENOID SWITCH
*15	4	229202	CAPSCREW, HEX. WASHER HD.

* NOT SHOWN

PUMP ASSEMBLY, GRAVITY DOWN, OLD STYLE

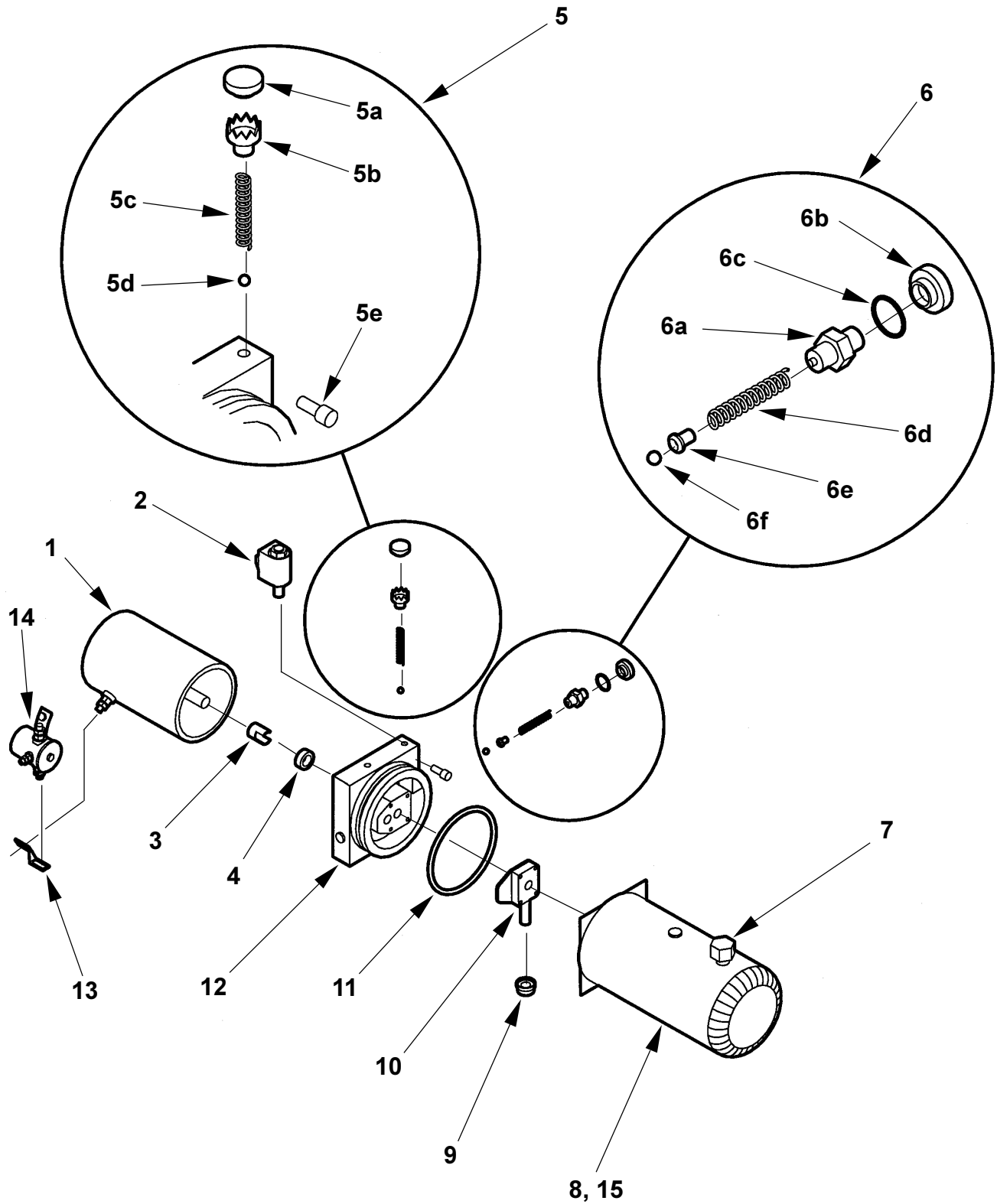

PUMP ASSEMBLY, GRAVITY DOWN, NEW STYLE

ITEM	QTY.	PART NO.	DESCRIPTION
1	1	263612	SLIMLINE PUMP ASSEMBLY 12 VDC
2	1	262966	BUS BAR
3	1	262939	MOTOR SOLENOID
4	1	253353	VALVE, SOLENOID, 2-WAY
4a	1	226594	O-RING KIT, 2-WAY VALVE
5	1	263779	PLUG
6	1	263369	FILLER
7	1	263811	ELBOW, MALE 45°
8	1	800183	BUSHING, 3/8" x 1/4"
9	1	263500	BOX ASSEMBLY
9a	1	263497	COVER
9b	1	263499	BOX WELDMENT
9c	1	263791	LATCH
10	1	030937	HEX PLUG, 1/4"
11	1	263370	FLOW SIGHT
12	2	263814	GROMMET, 1" DIA.
13	1	263795	GROMMET, 1/2" DIA.
14	1	263798	PUMP BOX HARNESS
14a	1	263802	GASKET
15	1	260250	FILTER
16	1	905100	BULKHEAD, MALE, JIC #6
17	2	030039	BOLT, 3/8-16 x 1-3/4" LG.
18	2	030555	WASHER, LOCK, 3/8"
19	2	030556	WASHER, FLAT, 3/8"

MAXON[®]

11921 Slauson Ave. Santa Fe Springs, CA. 90670 (800) 227-4116 FAX (888) 771-7713

PUMP ASSEMBLY, GRAVITY DOWN, NEW STYLE

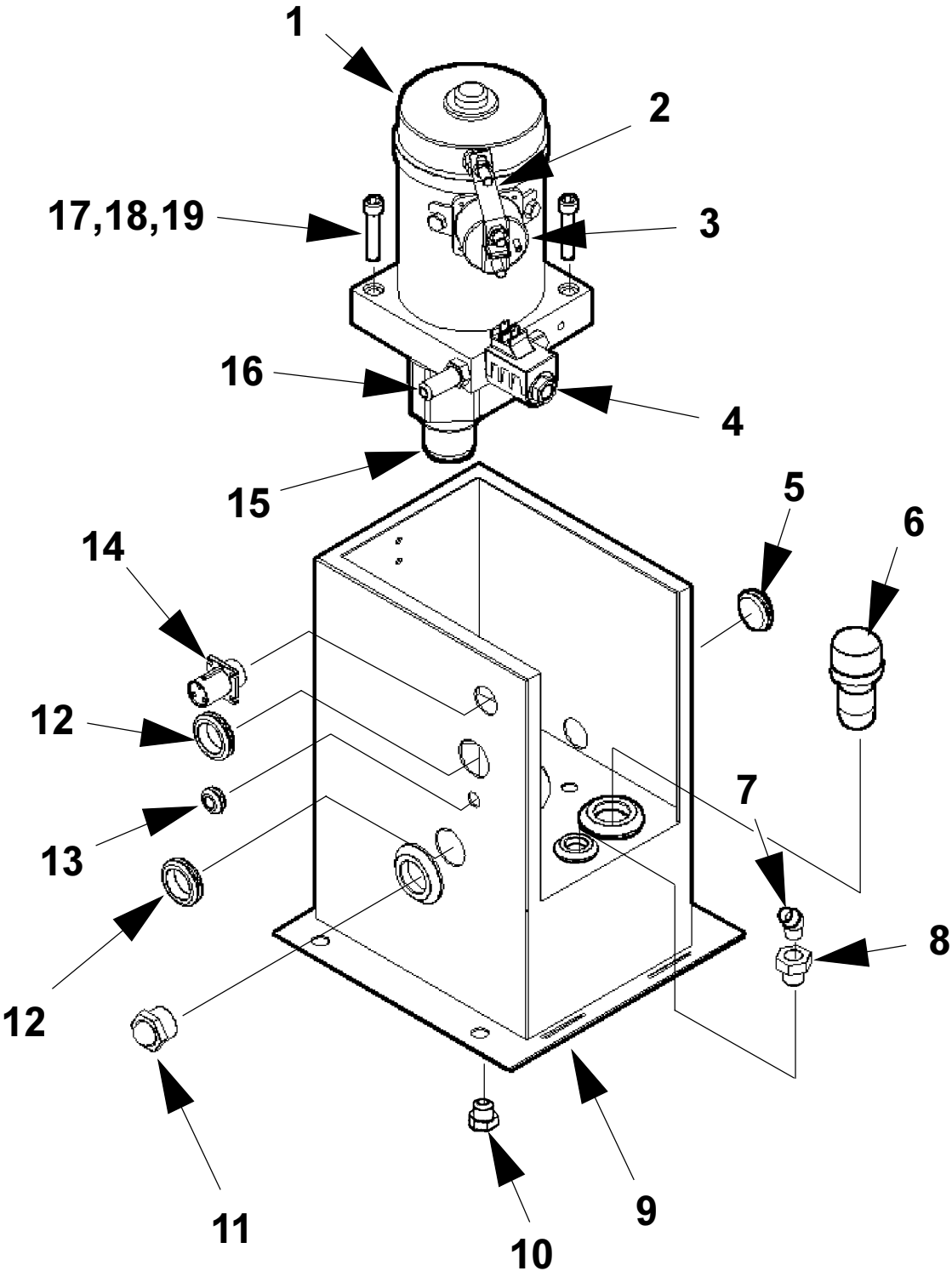

CONTROL SWITCH, GRAVITY DOWN, OLD STYLE PUMP

MAXON[®]

11921 Slauson Ave. Santa Fe Springs, CA. 90670 (800) 227-4116 FAX (888) 771-7713

Assemble Switch in Mount Bracket as shown. When mounting the bracket to the Channel, note the location of the Wht. & Blk. wires to ensure proper wiring to match the "UP/DOWN" Decal.

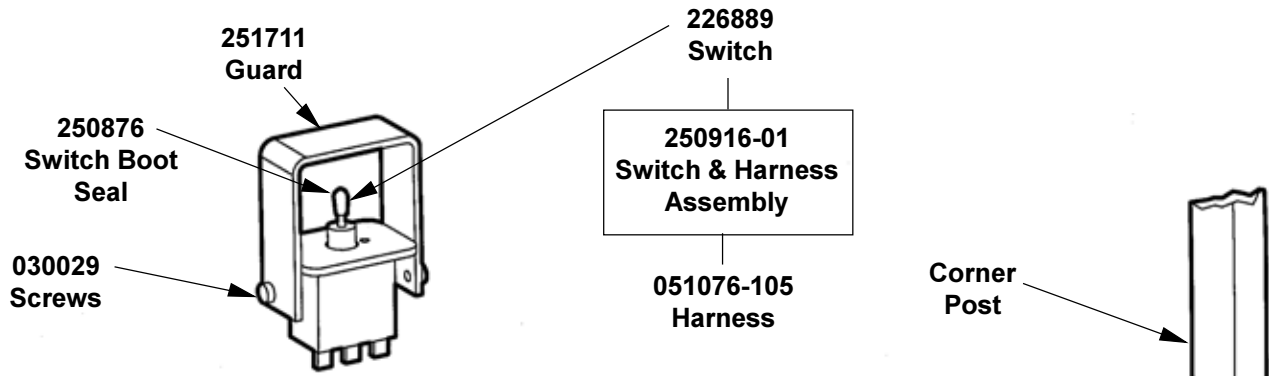

Looking at Switch from the Platform, the Wht. Wire must be on the left or "Door" side.

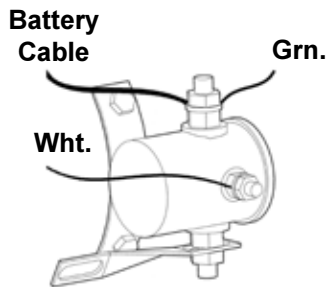
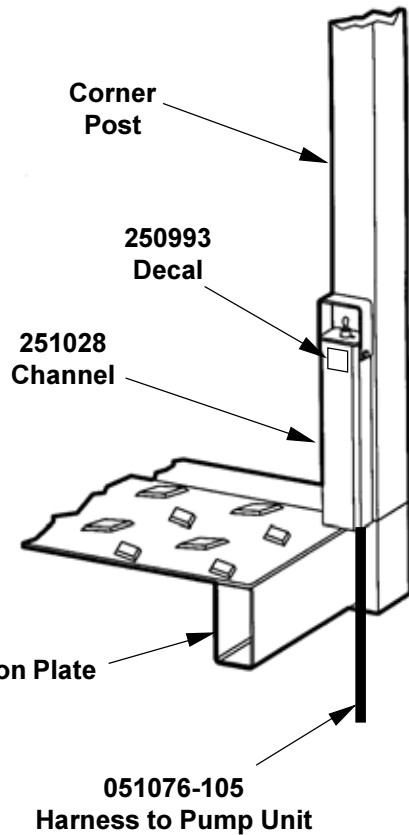
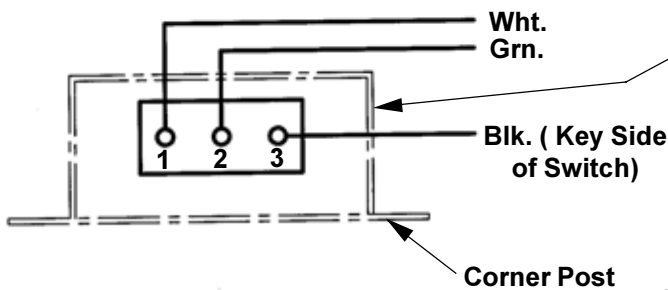

Old Motor Solenoid

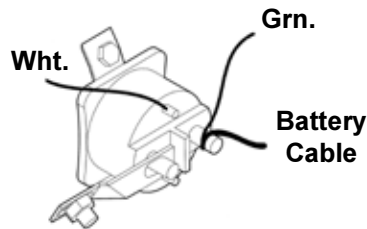

New Motor Solenoid



CONTROL SWITCH, GRAVITY DOWN, SLIMLINE PUMP

Assemble Switch in Mount Bracket as shown. When mounting the bracket to the Channel, note the location of the Wht. & Yel. wires to ensure proper wiring to match the "UP/DOWN" Decal.

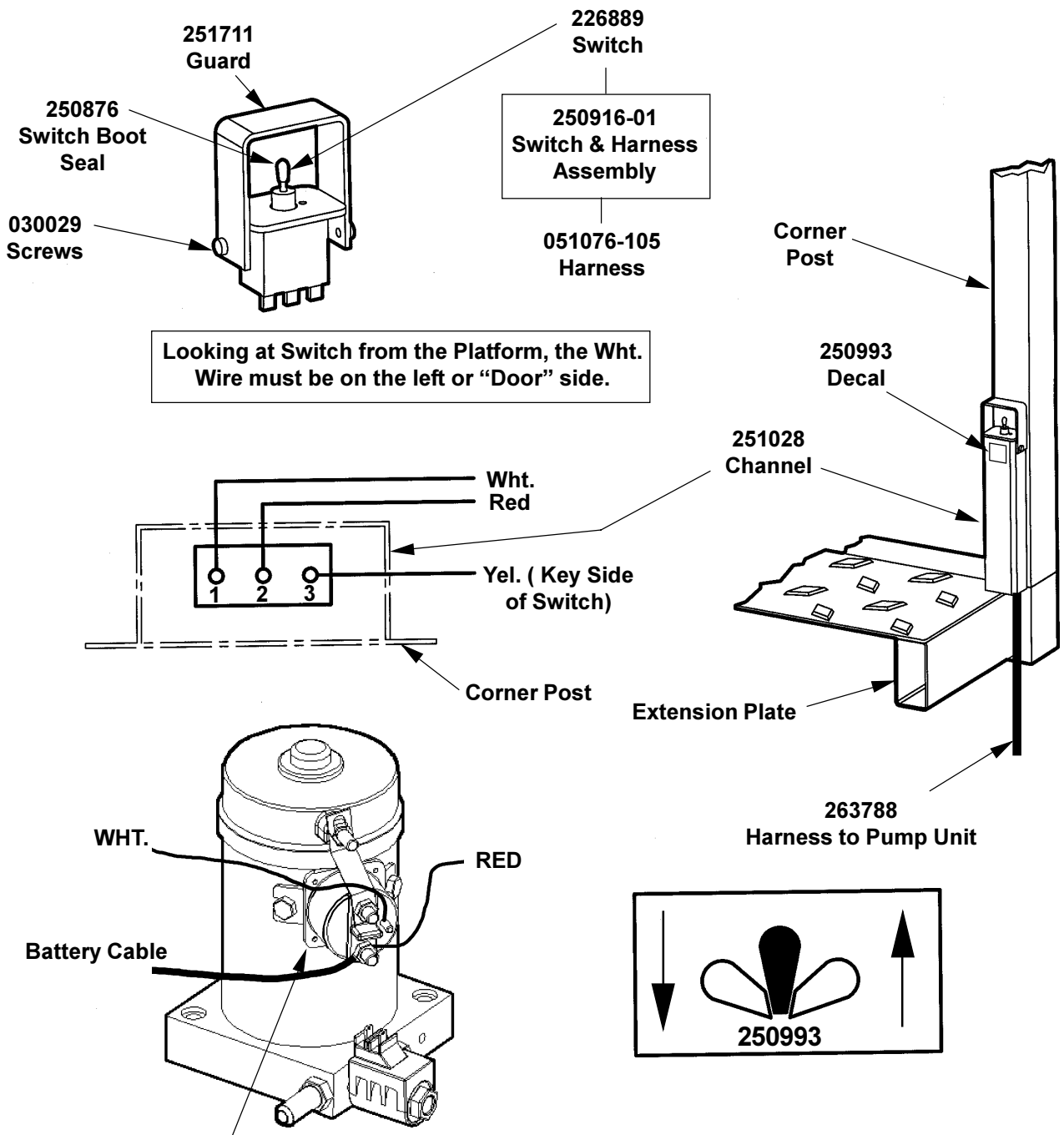

Pump Unit Motor Solenoid

HARNESS ASSY., GRAVITY DOWN, OLD STYLE PUMP

MAXON[®]

11921 Slauson Ave. Santa Fe Springs, CA. 90670 (800) 227-4116 FAX (888) 771-7713

226889
TOGGLE SWITCH

RAISE

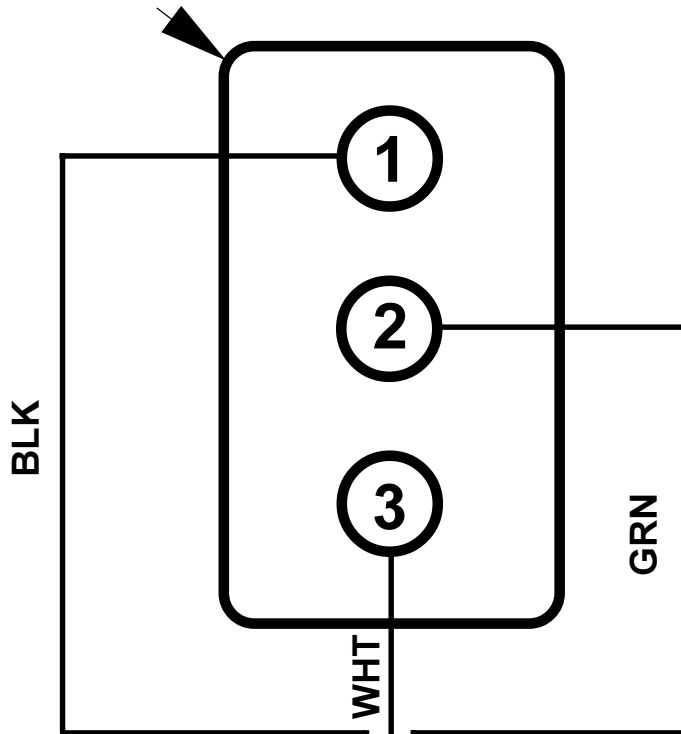

LOWER

051076-101
CABLE ASSEMBLY

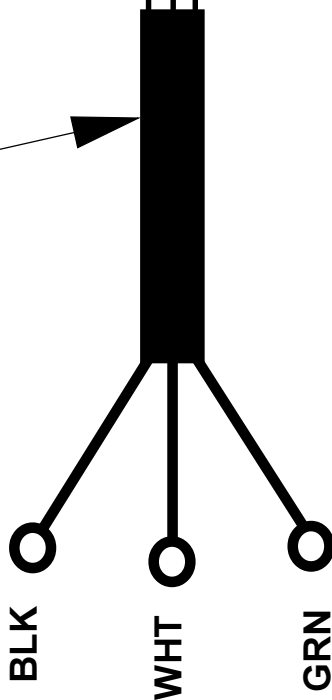

HARNESS ASSY., GRAVITY DOWN, SLIMLINE PUMP

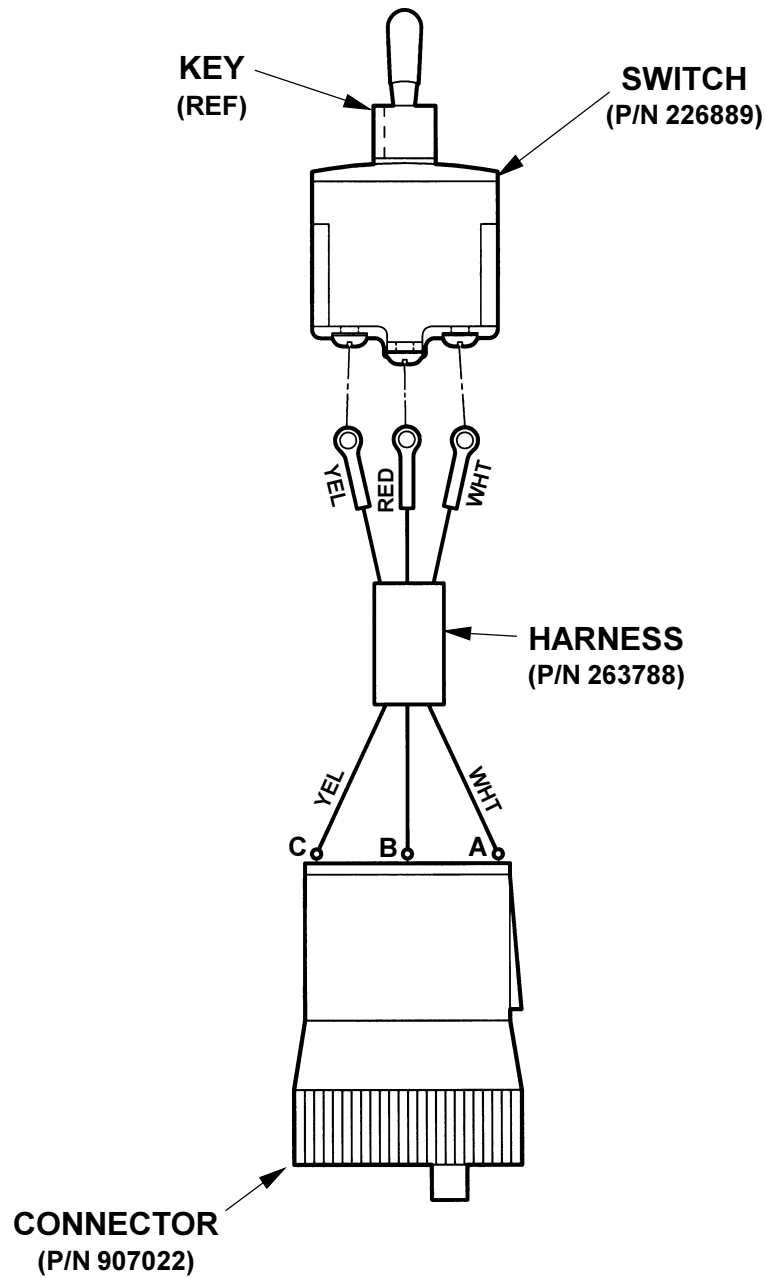

WIRE CONNECTIONS, GRAVITY DN., OLD STYLE PUMP

MAXON[®]
 11921 Slauson Ave. Santa Fe Springs, CA. 90670 (800) 227-4116 FAX (888) 771-7713

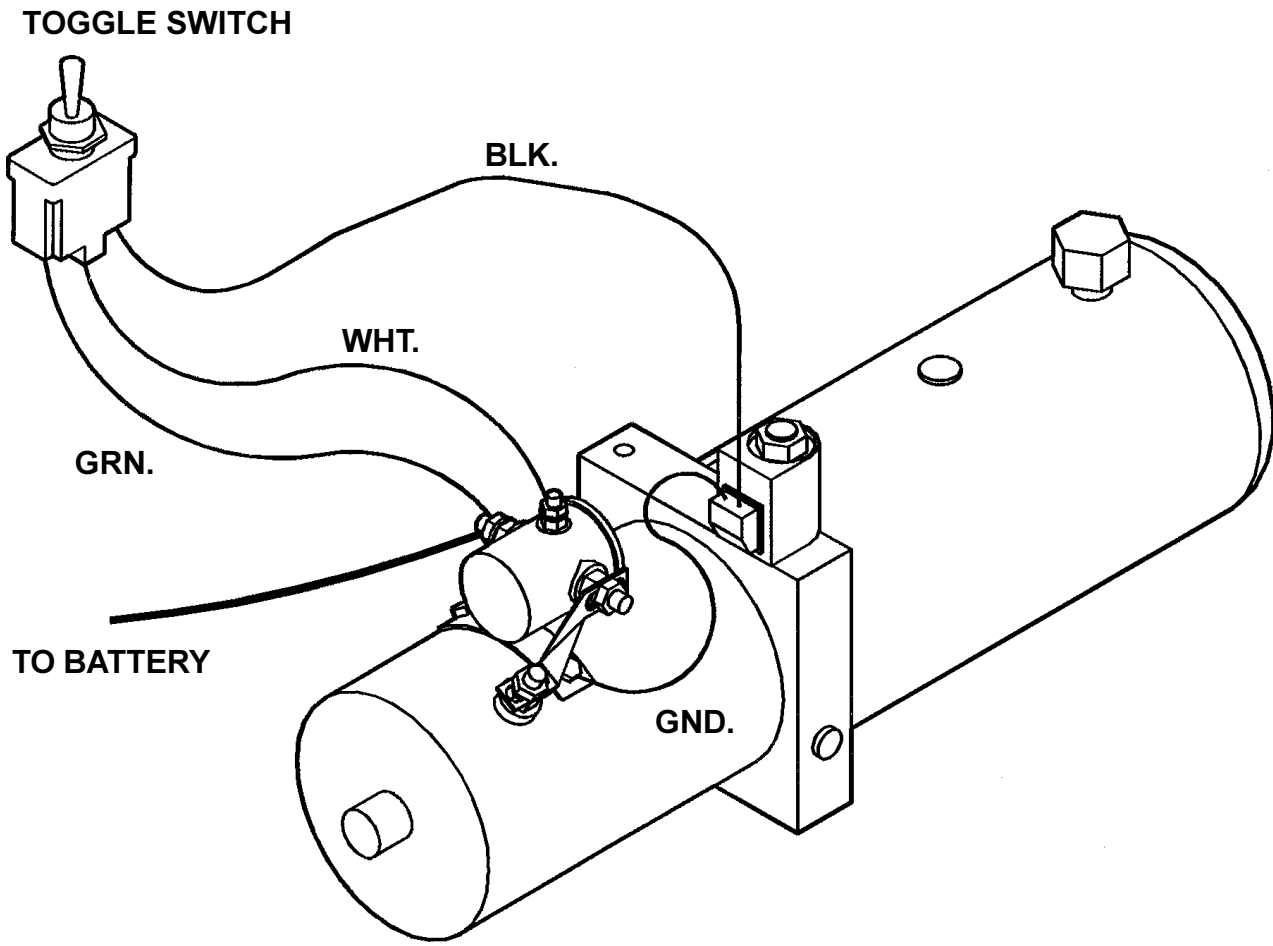

	POWER TO
UP	GREEN & WHITE
DOWN	GREEN & BLACK

WIRE CONNECTIONS, GRAVITY DN., SLIMLINE PUMP

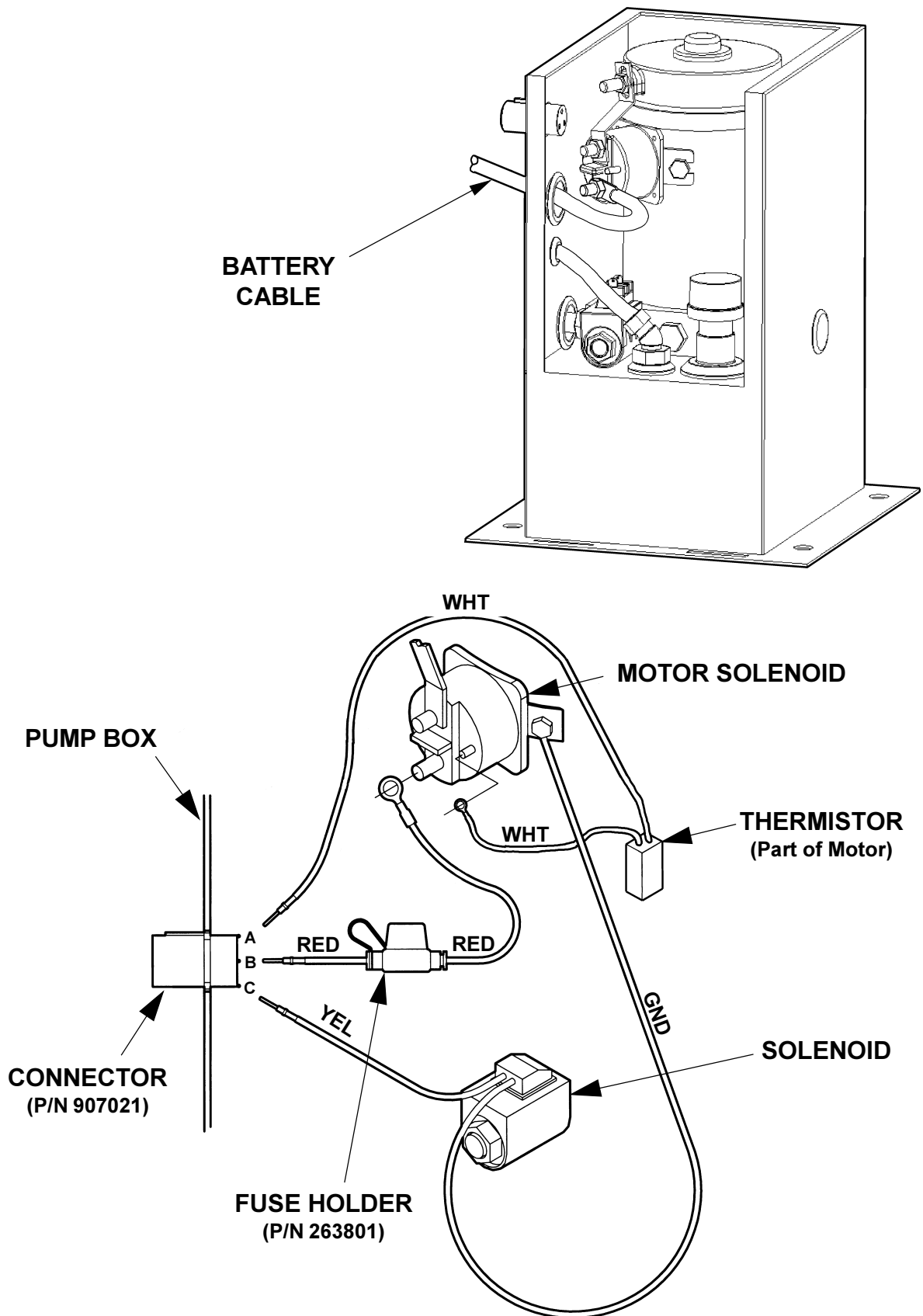

PUMP ENCLOSURE, OLD STYLE PUMP

MAXON[®]

11921 Slauson Ave. Santa Fe Springs, CA. 90670 (800) 227-4116 FAX (888) 771-7713

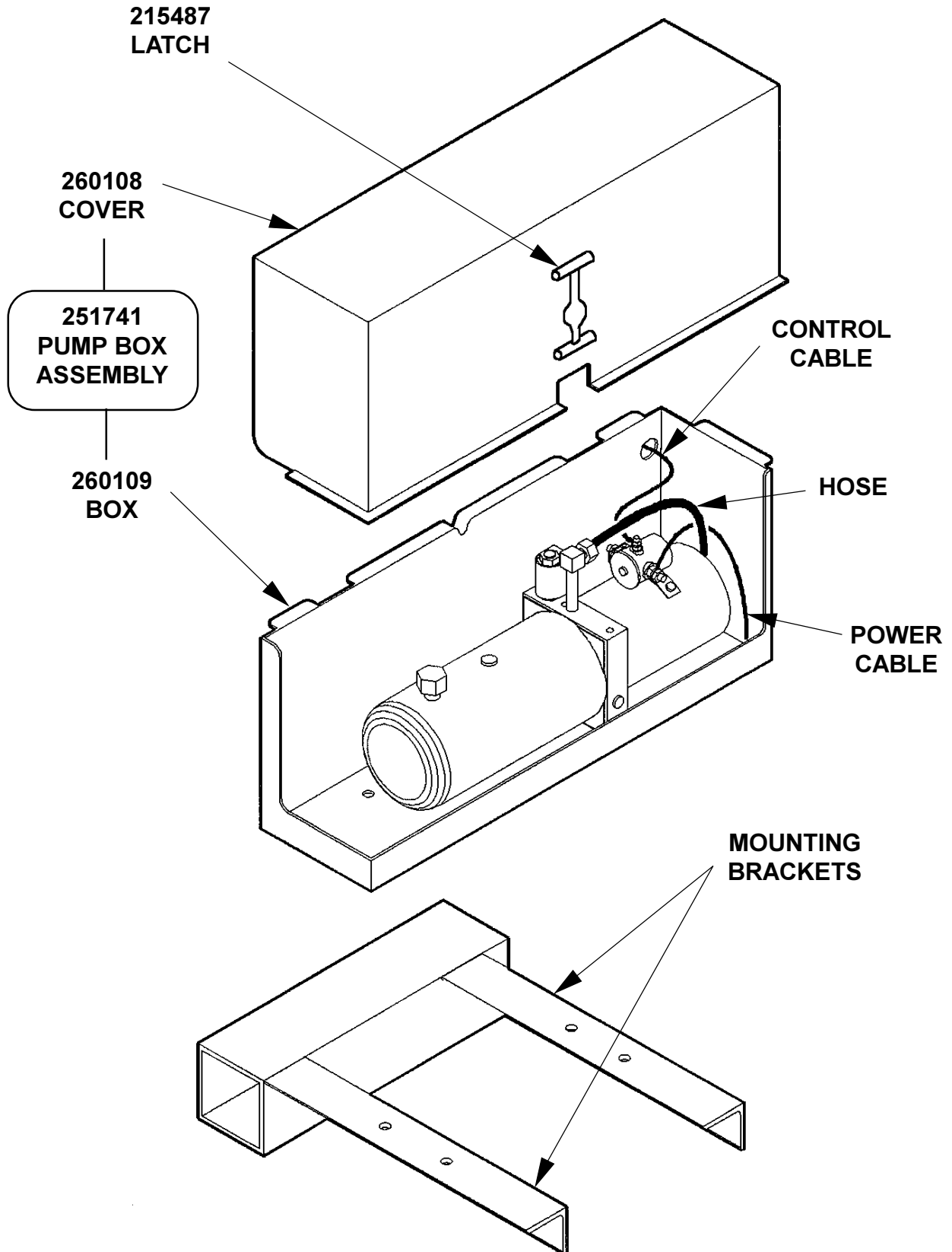

MAXON[®]

11921 Slauson Ave. Santa Fe Springs, CA. 90670 (800) 227-4116 FAX (888) 771-7713

POWER DOWN SECTION

TUK-A-WAY[®] **LIFT GATE SERIES**

72-25 LM

72-30 LM

HYDRAULIC ASSEMBLY, POWER DOWN

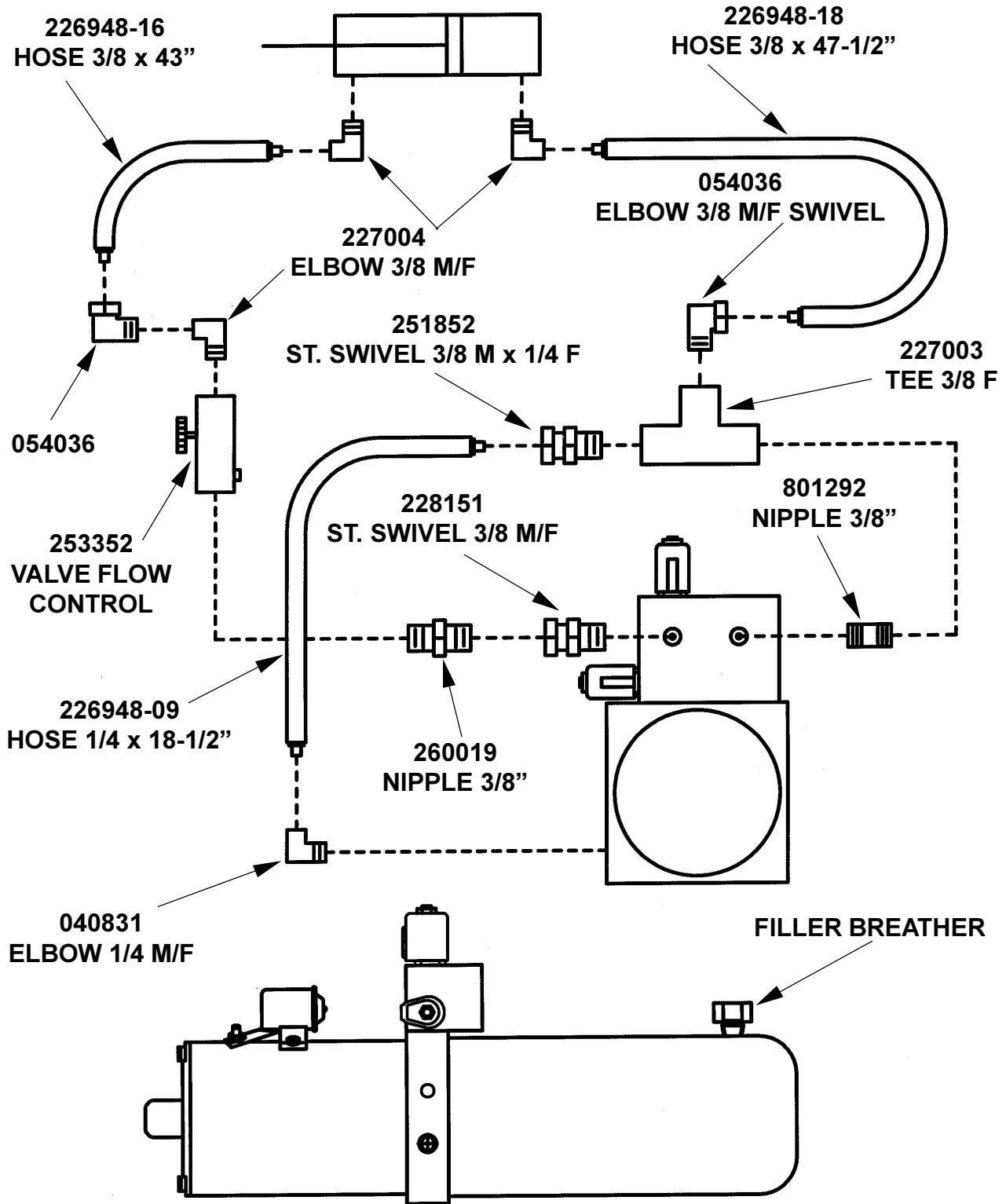

CONTROL SWITCH, POWER DOWN

MAXON[®]

11921 Slauson Ave. Santa Fe Springs, CA. 90670 (800) 227-4116 FAX (888) 771-7713

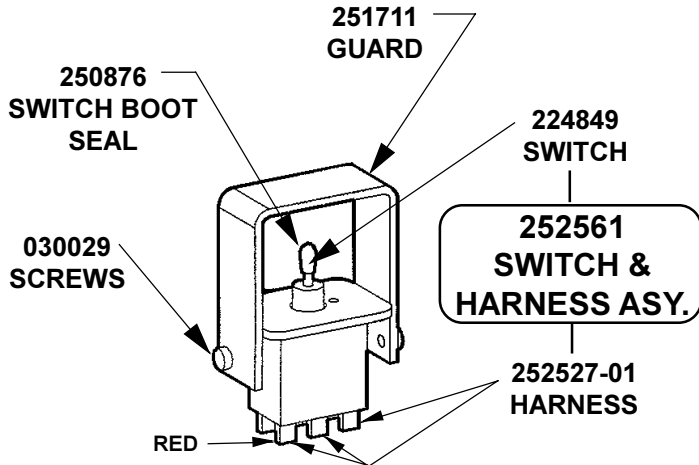

LOOKING AT SWITCH FROM THE PLATFORM, THE RED WIRE MUST BE ON THE LEFT OR DOOR SIDE.

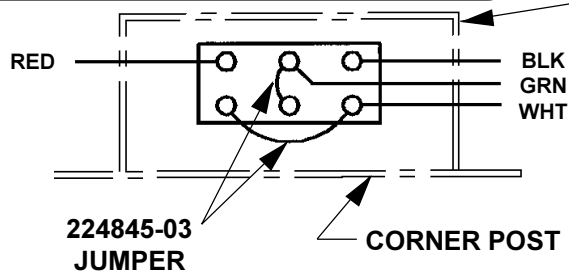

251868 CHANNEL

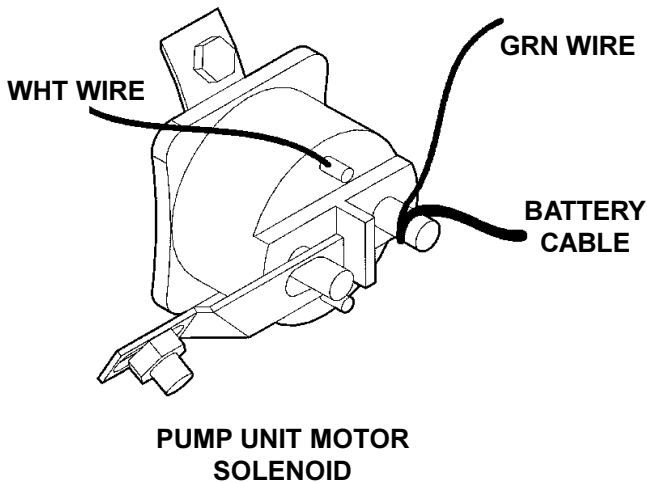
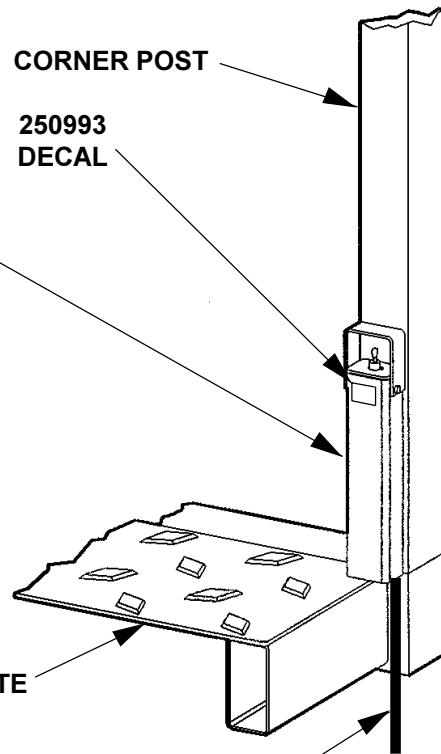

HARNESS & SWITCH ASSY. POWER DOWN

224849 SWITCH
DP-DT 6 CON.

224845-03
WIRE ASY. 2"

229068-01
CABLE ASY.

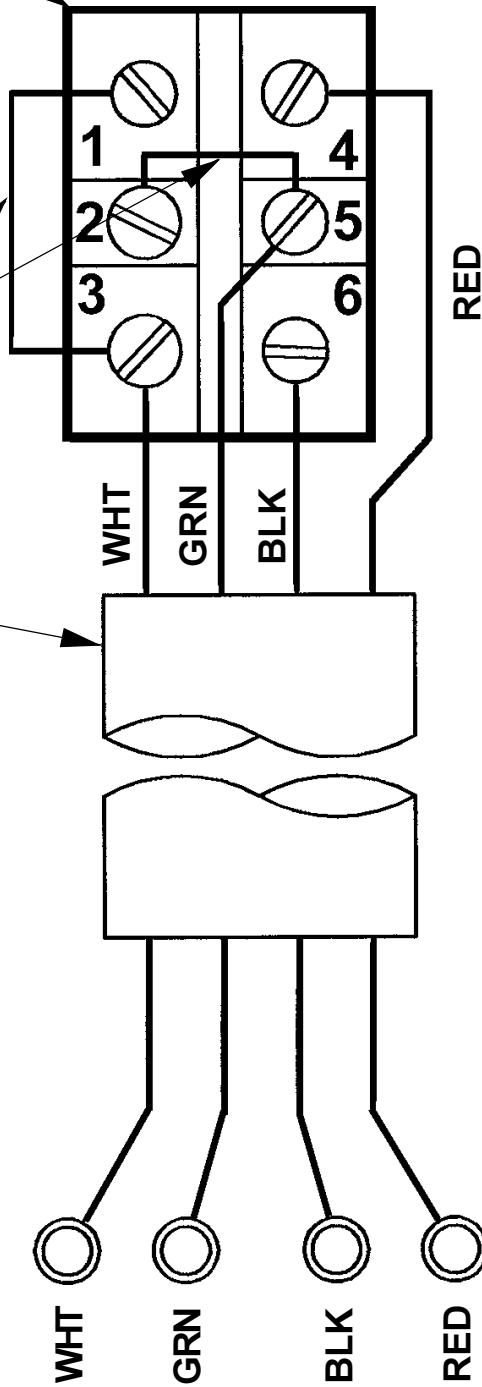

LOWER

RAISE

WIRE CONNECTIONS POWER DOWN

MAXON[®]
 11921 Slauson Ave. Santa Fe Springs, CA. 90670 (800) 227-4116 FAX (888) 771-7713

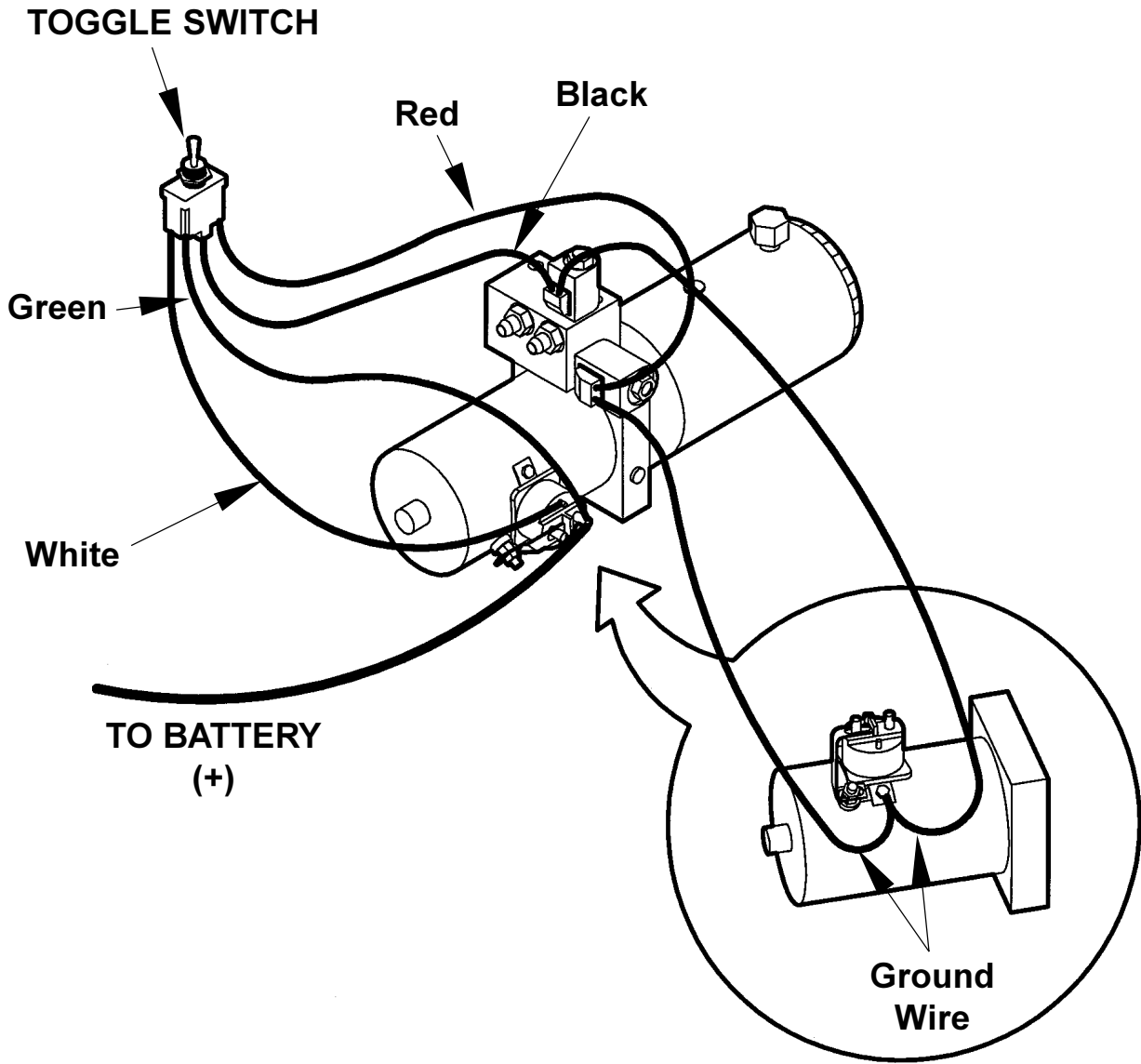

	POWER TO
UP	GREEN, WHITE & RED
DOWN	GREEN, WHITE & BLACK

HAND PUMP, POWER DOWN

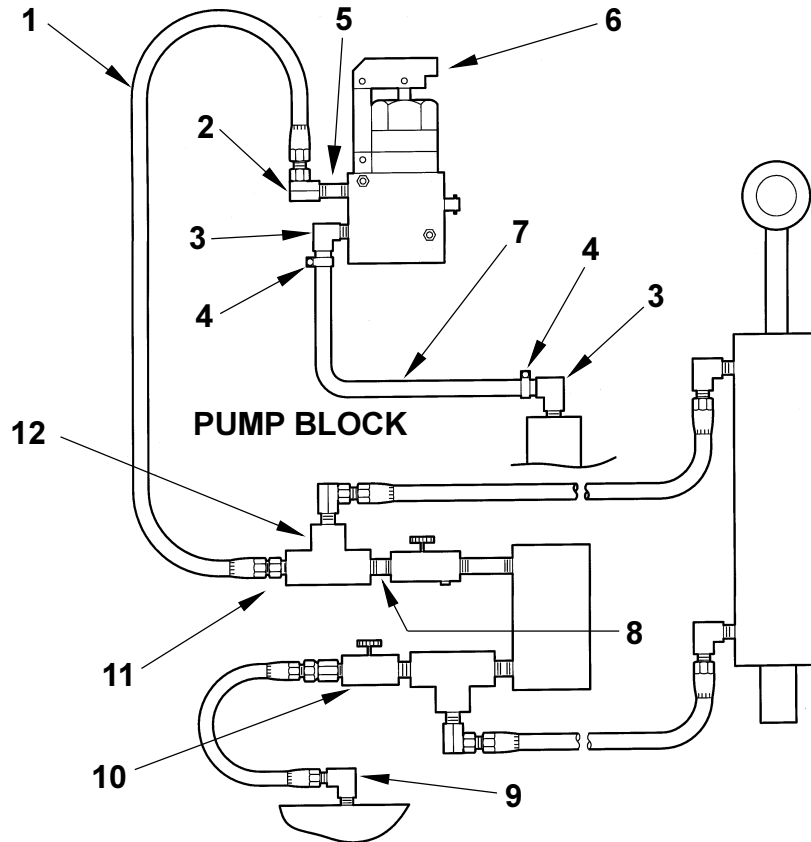

ITEM	QT-Y	PART NO.	DESCRIPTION
1	1	226948-09	HOSE ASY. H.P. 1/4" x 18-1/2" LG.
2	1	226063	ELBOW, 90 DEG. 1/4" (F-F) SWIVEL
3	2	251853	ELBOW, 90 DEG. 1/4M x 3/8 PUT-ON
4	2	251854	CLAMP, GEAR TYPE
5	1	030282	NIPPLE, 1/4" x 1-1/2" LG.
6	1	251407	HAND PUMP WITH HANDLE
7	1	251856	HOSE, 3/8" L.P. 20" LG.
8	1	801292	NIPPLE, CLOSE 3/8" NPT
9	1	050206	ELBOW, 90 DEG. 3/8M x 1/4F
10	1	251850	VALVE, NEEDLE 3/8" (M-F)
11	1	800183	BUSHING, 3/8" x 1/4"
12	1	227003	TEE, 3/8" (F-F)

PUMP ASSEMBLY, POWER DOWN

MAXON[®]

11921 Slauson Ave. Santa Fe Springs, CA. 90670 (800) 227-4116 FAX (888) 771-7713

ITEM	QTY.	PART NO.	DESCRIPTION
1	1	229272	MOTOR 12 VOLTS DC (39200388)
2	1	260276	VALVE, SOLENOID 4 WAY (38500040)
	1	226595	O-RING KIT, 4-WAY VALVE
3	1	253353	VALVE, SOLENOID (2 WAY) (38502407)
4	1	260280	MANIFOLD BLOCK ASSEMBLY (28600354)
5	1	260229	RELIEF VALVE KIT (10901282)
5a	1	260230	STEEL BALL (63800250)
5b	1	260231	SPRING (37502092)
5c	1	260235	O-RING (60108905)
5d	1	260234	VALVE CAP (35901127)
5e	1	260232	ADJUSTING SCREW (36101080)
5f	1	260233	SPRING GUIDE (34301061)
6	1	229193	FILLER / BREATHER CAP (69420006)
7	1	251882	RESERVOIR, 3QT. (32301171)
8	1	260250	FILTER (37201037)
9	1	260281	PUMP ASSEMBLY (20001815)
10	1	251884	O-RING (60120041)
11	1	260274	DRIVEPLATE ASSEMBLY 5" (20002923)
12	1	260261	OIL SEAL (60200077)
13	1	229200	COUPLING (37901000)
14	1	229199	BUS BAR (38901061)
	1	260270	SOLENOID SWITCH (39002122)
*16	4	229202	HEX WASHER HD. CAPSCREW (66700900)

* NOT SHOWN

PUMP ASSEMBLY, POWER DOWN

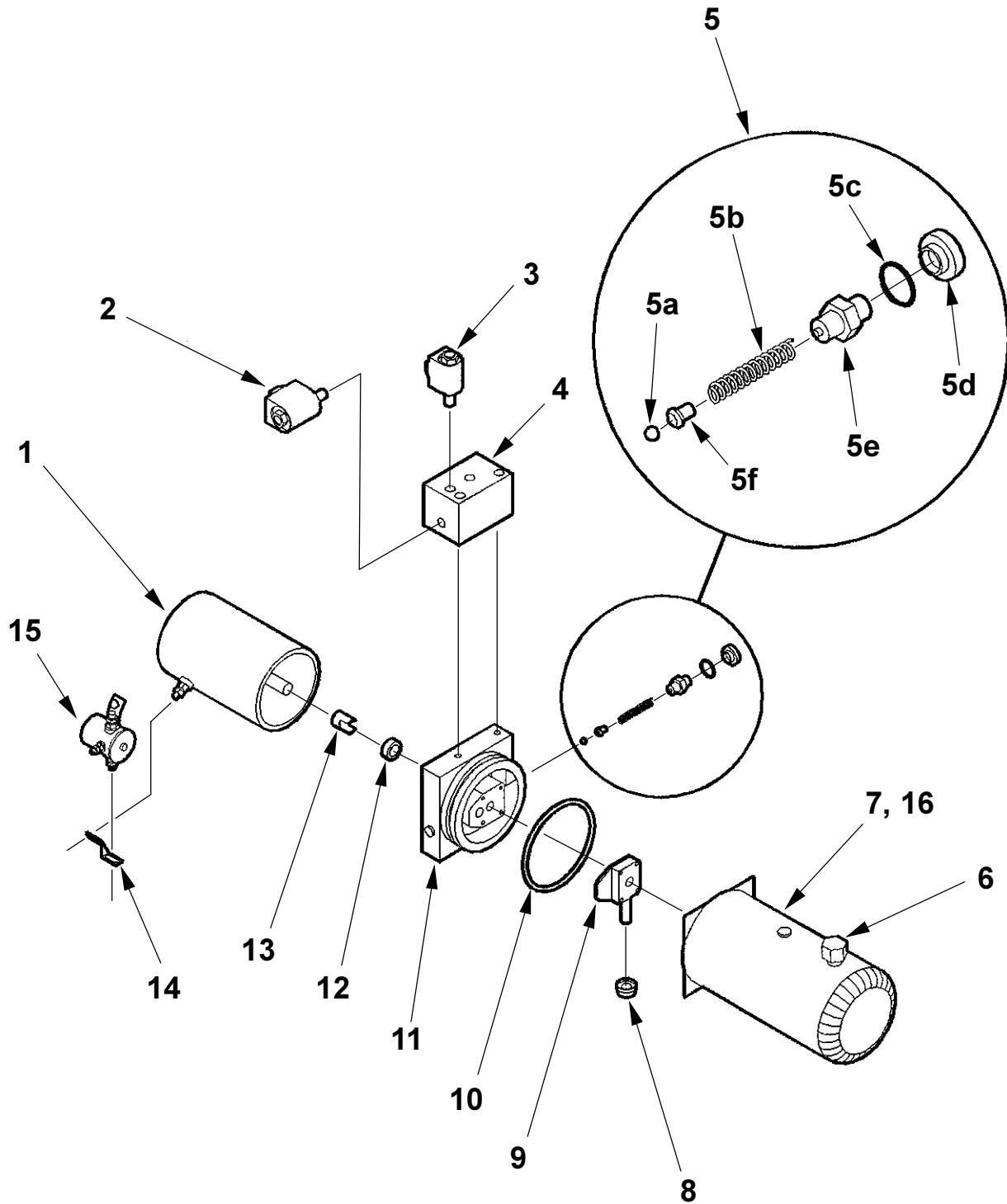

ALUMINUM RETENTION RAMP (SPECIAL PROFILE OPTION)

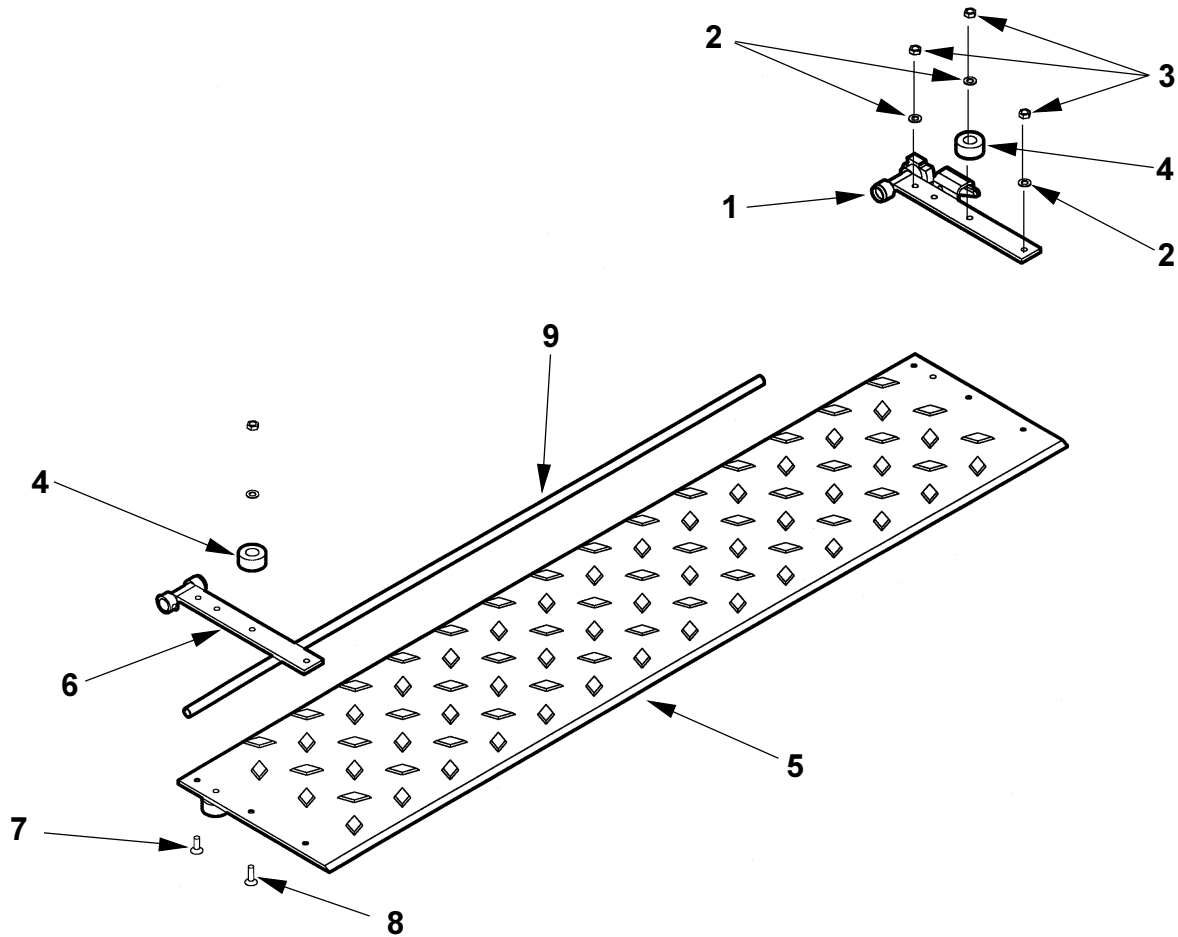

ITEM	QT-Y	PART NO.	DESCRIPTION
1	1	253877	HINGE ASSEMBLY R.H
2	6	030556	WASHER FLAT 3/8"
3	6	030955	LOCK-NUT 3/8-16 UNC
4	2	253516	BUMPER 2" x 1" HIGH
5	1	253875	RAMP, ALUMINUM 3/8" x 10" x 69"
6	1	253876	HINGE ASSEMBLY L.H
7	4	040504	BOLT 3/8-16 UNC x 1-1/4" FLAT HEAD
8	2	030036	BOLT 3/8-16 UNC x 1-1/2" FLAT HEAD
9	1	225985	PIPE, 3/4" SCH. 80 x 60" LG

ALUMINUM RETENTION RAMP (SPECIAL PROFILE OPTION)

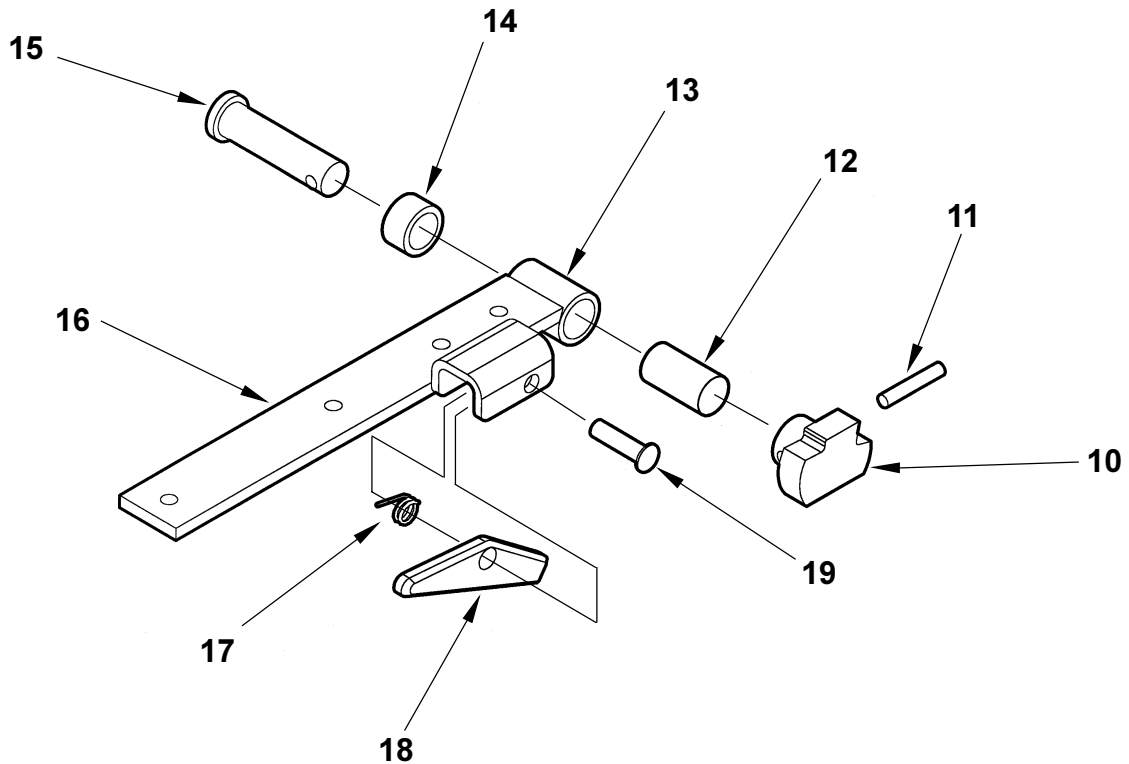

ITEM	QT-Y.	PART NO.	DESCRIPTION
10	1	221416	ROLL PIN 3/8" x 2"
11	1	253532	LOCK AND BUSHING WELDMENT
12	1	078202	PIN COLLAR x 3/4 LG
13	1	253541	BEARING, SELF-LUBE 1" DIA. x 2" LG
14	1	253517	BUSHING x 3/4"
15	1	253528	PIN WELDMENT
16	1	253879	HINGE ARM WELMENT R.H
17	1	252460	TORSION SPRING
18	1	260147	LOCKING ARM ASSEMBLY
19	1	253538	PIN WELDMENT
20	1	030406	ROLL PIN 1/8" x 1" ZINC PLT. (NOT SHOWN)

MAXON[®]

11921 Slauson Ave. Santa Fe Springs, CA. 90670 (800) 227-4116 FAX (888) 771-7713

TROUBLESHOOTING

PLATFORM WILL NOT RAISE

1. Verify that power is being supplied to the Solenoid Terminal "A". Recharge the battery if less than 12 volts.
2. Fill Reservoir to within 1/2" below the top with the recommended hydraulic fluid.
3. Touch a jumper wire to terminals "A" & "C". If motor runs, check Switch, Switch connections, and White wire. Correct the connections or replace the Switch.
4. Touch heavy jumper cables to terminals "A" & "B".
 - a. If motor runs, replace the motor solenoid.
 - b. If motor does not run, repair or replace the pump motor.
5. Check for structural damage. Replace worn parts.
6. Check filter in the pump Reservoir. Replace if necessary.
7. Check for a broken motor-to-pump coupler. Replace if necessary. A worn pump is extremely noisy, and needs replacement.

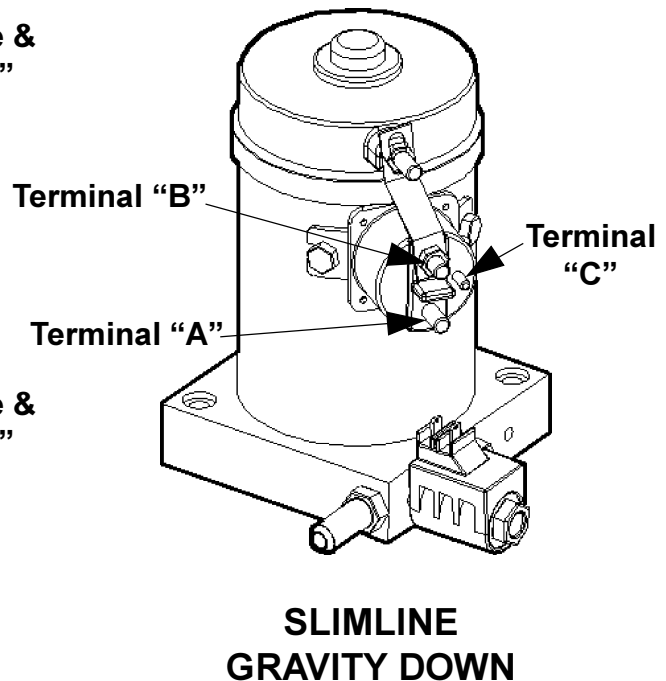
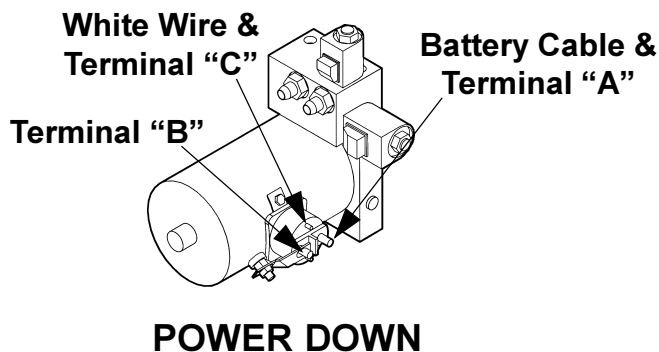
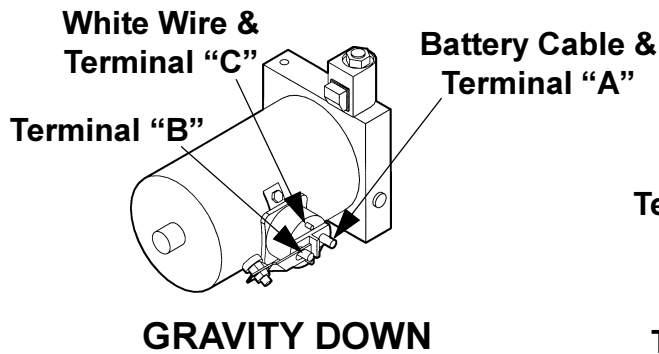

PLATFORM RAISES BUT LEAKS DOWN

MAXON[®]

11921 Slauson Ave. Santa Fe Springs, CA. 90670 (800) 227-4116 FAX (888) 771-7713

1. Check Solenoid Valves for electrical shorts by holding a screwdriver approximately 1/4" from the top nut of the Solenoid. (See Fig. 1). The solenoid should not draw the screwdriver to the nut with a magnetic force, unless the toggle switch is actuated. The Coil can be replaced by removing the Nut and Wires.

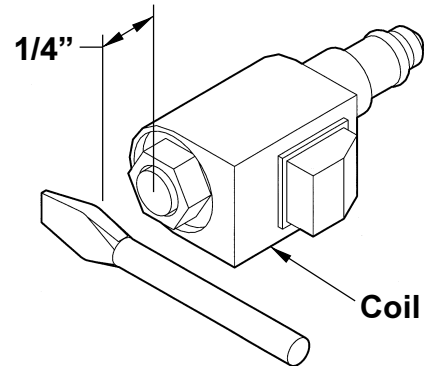

FIGURE 1

2. Check the Valve Stem by removing the Coil Assembly, (Item 1, Fig. 2). Unscrew the Valve Stem, (Item 2, Fig. 2), from the Pump. Push on the plunger that is located inside the Valve Stem by inserting a paper clip in the end. If the Plunger does not move freely approximately 1/8", replace the Valve Stem.

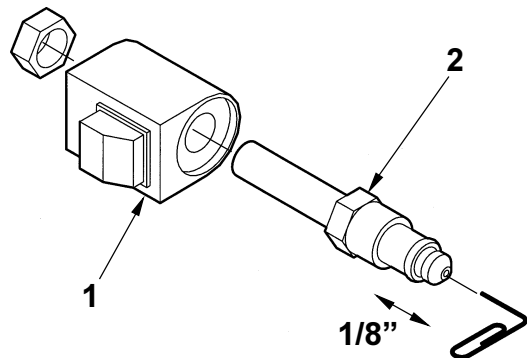

FIGURE 2

3. Check the Hydraulic Cylinder. With the Platform on the ground, remove the Breather Plug or Vent Line from the Vent Port of the Cylinder. Raise the Platform to be level with the bed. If hydraulic fluid streams from the Vent Port, the Piston Seals are worn. Replace the Seals. (See Fig. 3).

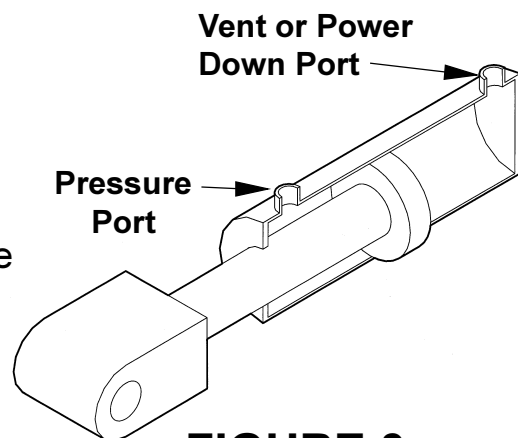

FIGURE 3

PLATFORM RAISES PARTIALLY AND STOPS

- 1.** Lower the opened Platform to the ground. Fill the Reservoir to within 1” from the top with the recommended Hydraulic Fluid.
- 2.** Verify that the Battery shows 12 volts or better under load from pump motor. The use of a voltage load tester is recommended.
- 3.** Check for Structural damage, or lack of lubrication. Replace worn parts.
- 4.** Check Filter in the Pump Reservoir. Replace if necessary.
- 5.** Check for a broken motor-to-pump coupler. Replace if necessary. A worn pump is extremely noisy, and needs replacement.

LIFTGATE WILL NOT LIFT RATED CAPACITY

1. Verify that the Battery shows 12 volts or better under load from pump motor. The use of a voltage load tester is recommended.
2. Check for Structural damage or lack of lubrication. Replace worn parts.
3. Check the Hydraulic Cylinder.

GRAVITY DOWN UNITS: With the Platform on the ground, remove the Breather Plug or Vent Line from the Vent Port of the Cylinder. Raise the Platform. If hydraulic fluid streams from the Vent Port, the Piston Seals are worn. Replace the Seals.

POWER DOWN UNITS: Remove the Power Down Hose from the cylinder. Raise the Platform. If hydraulic fluid streams from the Power Down Port, the Piston Seals are worn. Replace the Seals.

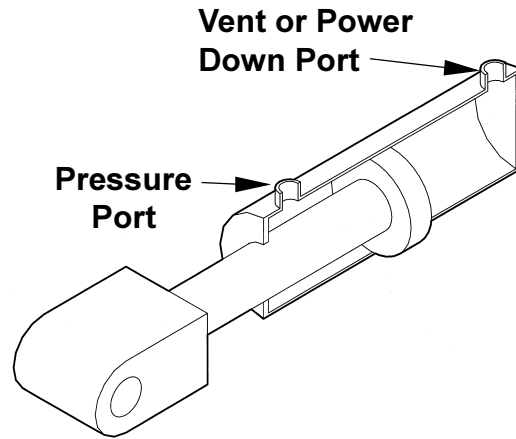

FIGURE 1

4. With Platform on the ground, remove the pressure hose and fitting from the Pump and replace it with a 0-3000 PSI Pressure Gauge. Hold the switch in the "UP" position. Adjust the Relief Valve on the side of the Pump until the gauge shows 2800 to 3000 PSI . (See Fig. 2)

5. If Pump cannot produce 2800-3000 PSI with a minimum of 12 Volts available, the Pump is worn and needs to be replaced.

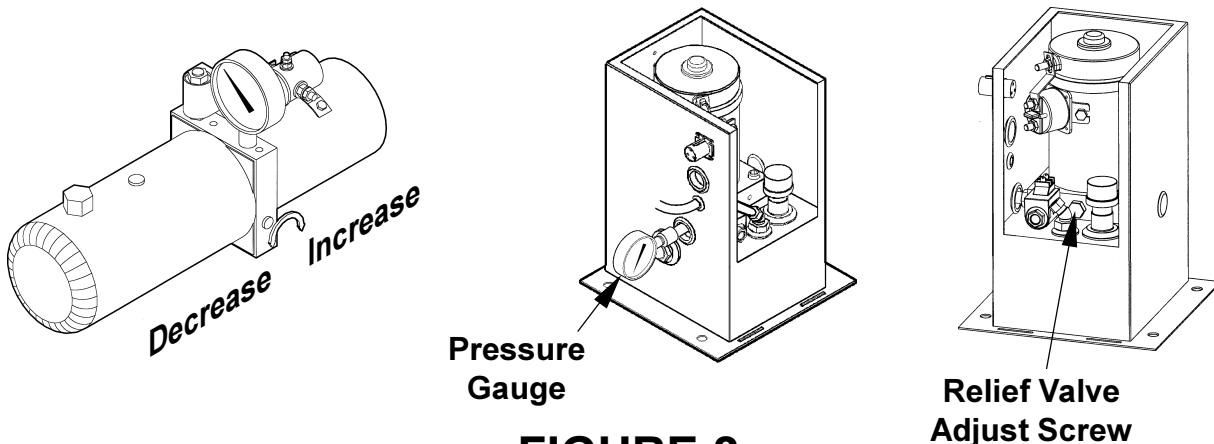

FIGURE 2

PLATFORM RAISES SLOWLY

1. Verify that power is being supplied to Terminal "A". Recharge the battery if less than 12 Volts registers on the Voltage Tester. **(See Fig. 1)**

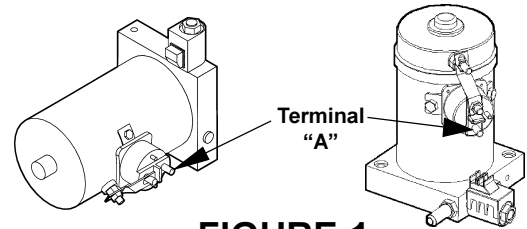

FIGURE 1

2. Lower the opened Platform to the ground. Fill the Pump Reservoir to within 1" from the top with the recommended hydraulic fluid **(for Gravity Down Units only)**.

3. Verify the Pump Motor is grounded to the vehicle frame.

4. Check for leaking hoses and fittings. Tighten or replace as required.

5. Check for structural damage or lack of lubrication. Replace worn parts.

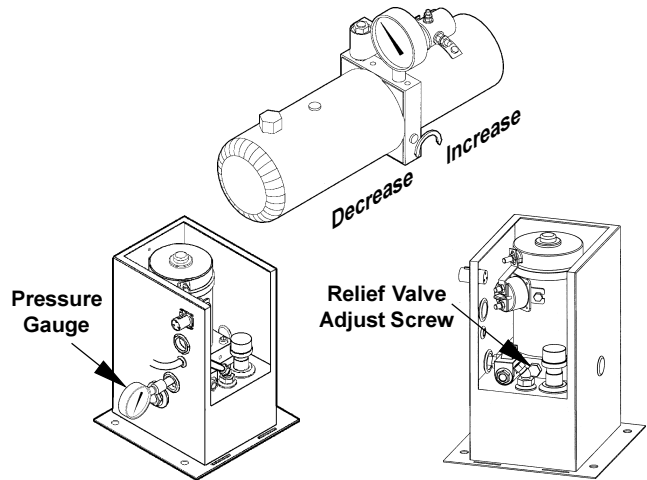

FIGURE 2

6. Check the Filter in the Pump Reservoir. Replace if necessary.

7. With Platform on the ground, remove the pressure hose and fitting from the Pump and replace it with a 0-3000 PSI Pressure Gauge. Hold the switch in the "UP" position. Adjust the Relief Valve on the side of the Pump until the gauge shows 2800 to 3000 PSI **(See Fig. 2)**.

8. With the Platform on the ground, remove breather plug or vent line from vent port of cylinder. Raise the Platform to bed level. If hydraulic fluid streams from the Vent Port, the Piston Seals are worn. **(See Fig. 3)** Replace the Seals.

9. Check the Flow Control Valve. The arrow on the valve shows the direction of flow that is restricted, and Must point back to the Pump. **(See Fig. 3)**

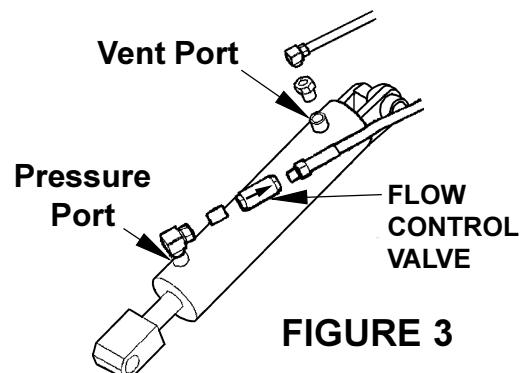

FIGURE 3

PLATFORM WILL NOT LOWER

MAXON[®]

11921 Slauson Ave. Santa Fe Springs, CA. 90670 (800) 227-4116 FAX (888) 771-7713

1. Verify that power is being supplied to the Solenoid Terminal "A" (Ref. Fig. 1). Recharge the battery if less than 12 volts.

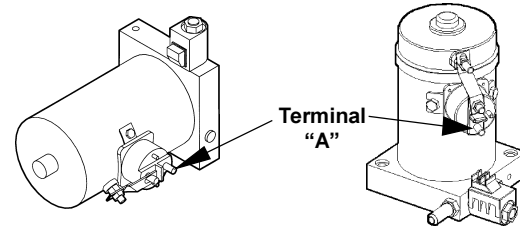

FIGURE 1

2. Check for structural damage or lack of lubrication. Replace worn parts.
3. Check Solenoid Valve for power by holding a screwdriver approximately 1/4" from the top nut of the Solenoid. Energize the unit. (See Fig. 2). A good solenoid will draw the screwdriver to the nut by a magnetic force. The Coil can be replaced by removing the Nut and Wires.
4. Check the Valve Stem by removing the Coil Assembly, (Item 1, Fig. 3). Unscrew the Valve Stem, (Item 2, Fig. 3), from the Pump. Push on the plunger that is located inside the Valve Stem by inserting a paper clip in the end. If the Plunger does not move freely approximately 1/8", replace the Valve Stem.

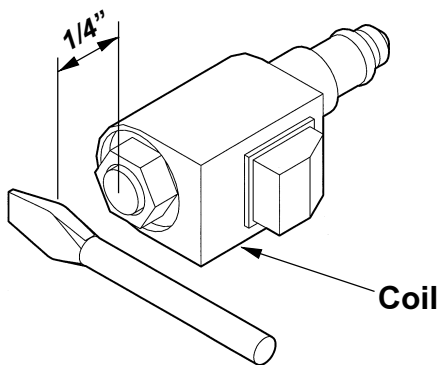

FIGURE 2

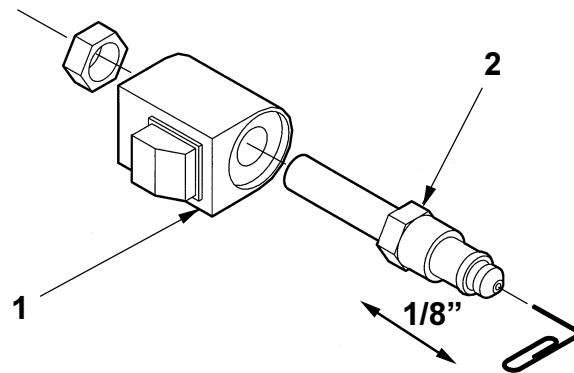
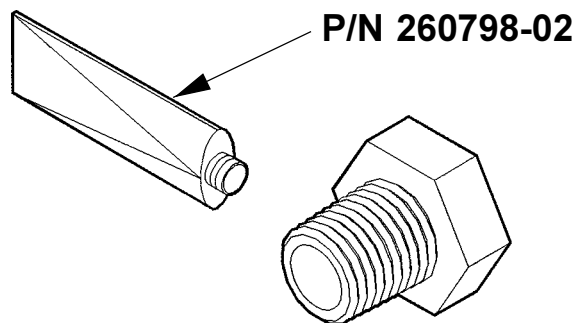

FIGURE 3

LIQUID SEALANT APPLICATION

1. Clean all threads with a soft brush and a suitable cleaning solvent.
2. Dry threads thoroughly with compressed air or shop towel.
3. Apply the Liquid Sealant (Compound PLS 2), to the external threads of the Male Connector.
4. Assemble the fitting and torque it to the prescribed value.
5. Check for leakage. If leakage exists, remove the fitting and return to Step # 1.
6. If fitting is loosened or removed, return to Step # 1.



CAUTION

Due to the 80% lead content in PLS 2, follow these safety and first aid precautions:

Eye Contact - Flush eyes immediately with large quantities of water, lifting the upper and lower eyelids occasionally. If irritation persists, consult a physician.

Skin Contact - Flush the contaminated skin and wash with soap and water.

Ingestion - If person is conscious, give large quantities of water to drink and induce vomiting. Consult a physician immediately.